

# INSTRUCTION MANUAL

Model: Metropole pendel ø15cm

**halo  
design**

COPENHAGEN

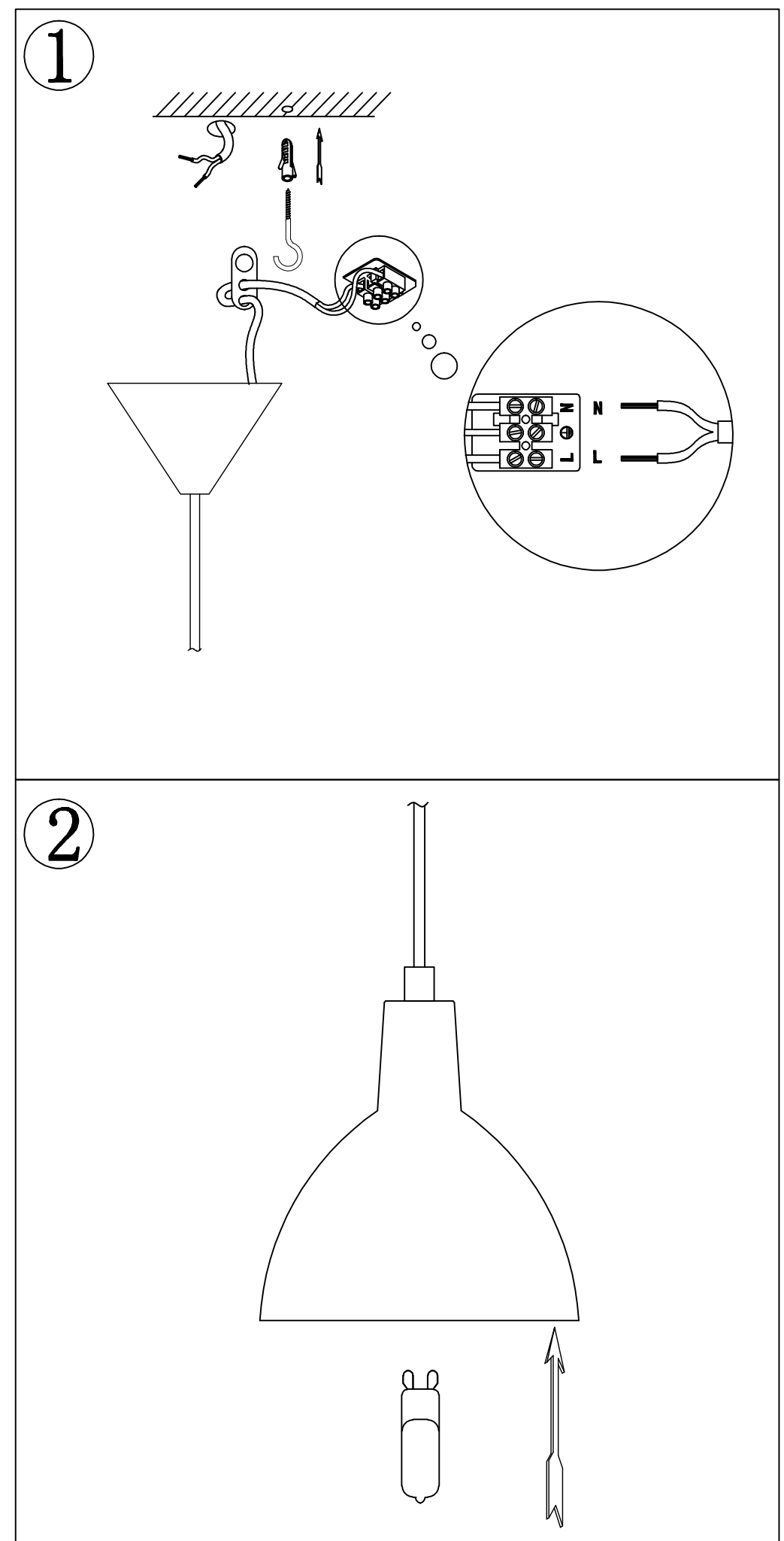
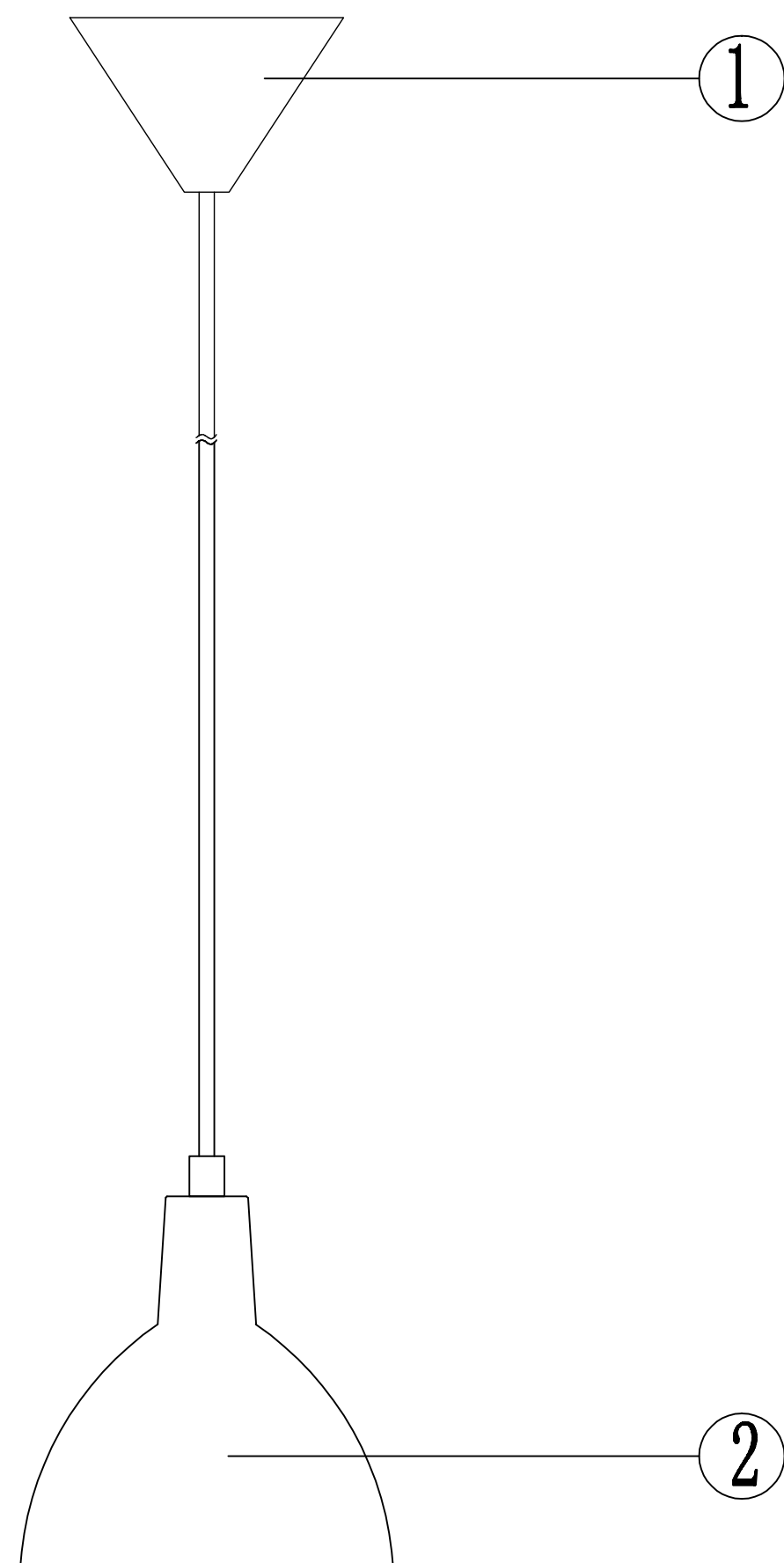

# INSTRUCTION MANUAL

**1** Follow the instruction sketch.

**2** Make sure power is OFF on the outlet, before beginning the installation.

**3** Insert the light bulb.

**4** Go through point 1 to 2 before connecting the lamp to the power.

230V .G9. MAX LED 28W

