



## CARE AND USE GUIDE

### STAINLESS STEEL VACUUM INSULATED BEVERAGE BOTTLE

#### GENERAL CARE

- Before first use, and as soon as possible after each use, wash all parts with warm, soapy water. Rinse all parts thoroughly and allow to dry.
- As soon as possible after each subsequent use, wash all parts with warm, soapy water. Rinse all parts thoroughly and allow time to dry.
- This product is top-rack dishwasher safe; however, washing by hand is recommended as the dishwasher uses harsher detergents and hot water that may affect the appearance of your product.
- Residual liquids, foods, or other contents may become trapped between product components, such as lid parts, container parts, gaskets (flexible band around lid and/or stopper), or straws (if present in the product). Although this product is top-rack dishwasher safe, washing by hand is recommended to ensure that all parts of the product are thoroughly cleaned.
- To help maximize thermal retention, pre-chill the product just prior to use. Fill with warm or ice cold tap water, attach cap, and let stand 5 to 10 minutes before emptying water. After filling container with contents, immediately re-cover with cap to increase thermal efficiency. Never use a microwave, conventional oven, or other heat source for this purpose.
- DO NOT leave contents in the container for longer than 24 hours.
- DO NOT use abrasive cleaners or scrubbers since they may dull the finish.
- DO NOT use bleach or cleaners containing chlorine on any parts of the product.

**TO USE:**

**Stainless Steel Vacuum Insulated Bottle with Sport Lid:**

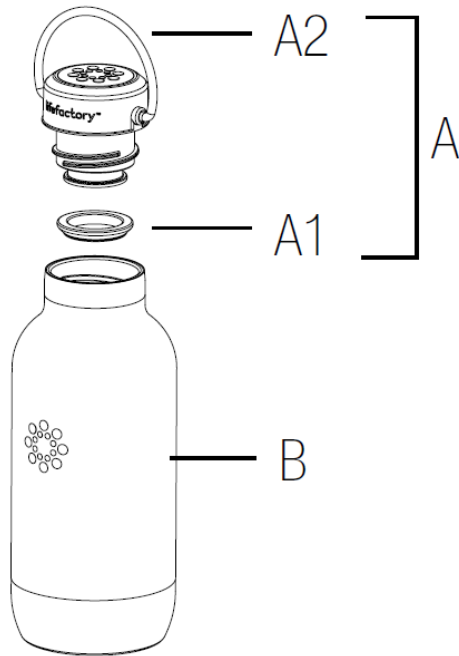

1. Remove lid (A) by twisting counterclockwise.
2. Remove gasket (A1).
3. Wash all parts separately and dry completely before re-assembling.
  - a. Ensure gasket (A1) is properly seated to minimize leaking.
4. Fill container (B) with contents.

Do not overfill: Leave space for lid (A) to avoid overflow.

5. Replace the lid (A) by twisting it clockwise.
6. To drink, remove lid (A) by twisting counterclockwise.
7. When finished drinking, replace the lid (A) by twisting it clockwise.
8. Raise carry loop (A2) to transport bottle.
9. If attaching carry loop (A2) onto a bag or equipment, make sure lid is fully tightened on bottle.
  - a. Note: Bottle must be secured to equipment meant to withstand the weight of the bottle when filled. Misuse of the bottle may result in breakage or injury.
10. DO NOT carry or transport product other than in an upright position. Liquid contents may leak and scald user or cause property damage.
11. Always use care to maintain product in an upright position when transporting or carrying product.
12. DO NOT place product in a bag, backpack or other container in which product may shift from an upright position. Liquid contents may leak and scald user or cause property damage.

**WARNING**

**NOT RECOMMENDED FOR USE BY CHILDREN:** Keep out of the reach of children, especially when product contains hot contents, which may burn or scald user.

- Always test temperature of contents before consuming. Hot liquids may burn or scald user.
- DO NOT use product in microwave, on stove top, or in any type of oven.
- DO NOT overfill the container: Leave space at top of container for lid to avoid overflow.
- DO NOT use tools or devices to force container to open. If you are unable to open container by hand, do not open it and dispose of it at your local waste facility.

- DO NOT use to store or carry carbonated drinks or dry ice. This may cause lid/stopper and contents to eject forcefully or leak.
- Check periodically to make sure any gasket (flexible band around lid and/or stopper) is present and properly positioned to prevent contents from passing through stopper when stopper is closed (if applicable to product). Missing, worn or misaligned gaskets may cause product to leak.
- In general, contents should not be left in container for longer than 24 hours. However, the rate at which contents spoil depends on several factors. Certain contents that include, for example, dairy and/or tomato may start to spoil sooner. Proceed with caution when using the product with quick spoiling contents.
- If contents are left in container longer than 24 hours, or you suspect spoilage, use caution when opening container. Contents spoilage can cause pressure inside container to build, possibly leading to forceful ejection of stopper or contents. In such circumstances, before attempting to open container, ENSURE THE OPENING IS POINTED AWAY FROM THE USER OR OTHER PERSONS TO AVOID INJURY.

### **LIMITED WARRANTY**

Thermos L.L.C. warrants this product to be free from defects in material or workmanship for 5 years from date of purchase. This warranty does not cover ordinary wear and tear or color fading, or any condition affected by abuse, neglect, alteration, accident or improper use or maintenance.

We will, at our option, repair or replace any product component part that fails to conform to this warranty within 30 days after its receipt by our factory service department.

**IN NO EVENT WILL THERMOS BE LIABLE FOR INCIDENTAL, CONSEQUENTIAL OR SPECIAL DAMAGES.**

Some jurisdictions do not allow the exclusion of incidental, consequential, or special damages, so the preceding exclusion may not apply to you.

This is a factory guarantee.

Please do not return this product to the retailer.

Send defective unit or component along with written explanation of defect directly to:

Thermos L.L.C. - Warranty Service  
355 Thermos Road  
Batesville, MS 38606, USA  
1-800-831-9242  
[www.lifefactory.com](http://www.lifefactory.com)

This warranty gives you specific legal rights and you may also have other rights, which vary from state to state or province to province.

**THE FOREGOING WARRANTY IS EXCLUSIVE AND IN LIEU OF ALL OTHER WARRANTIES, REPRESENTATIONS OR CONDITIONS OF QUALITY AND PERFORMANCE, WHETHER WRITTEN, ORAL OR IMPLIED, INCLUDING ANY IMPLIED WARRANTIES OF MERCHANTABILITY OR FITNESS FOR A PARTICULAR PURPOSE. SUCH IMPLIED WARRANTIES, REPRESENTATIONS AND CONDITIONS ARE HEREBY DISCLAIMED. THE REMEDIES STATED HEREIN CONSTITUTE PURCHASER'S EXCLUSIVE REMEDIES AND THERMOS'S ENTIRE LIABILITY FOR ANY BREACH OF WARRANTY.**

© 2021 Thermos L.L.C. All rights reserved.

LIFEFACTORY is a registered trademark of Thermos L.L.C. in the U.S. and other countries.