



PETERSON

HEAVY DUTY LIGHTING CATALOGUE



**NEW ZEALAND
4TH EDITION**



















ABOUT THIS CATALOG

CDL Autoparts is one of New Zealand's foremost supplier of Heavy Duty LED Trailer Lighting and Accessories. The head office and distribution centre is near Auckland International Airport. Founded in 1967, CDL today imports and markets a comprehensive range of wholesale automotive components throughout New Zealand. CDL Autoparts is a preferred supplier to motor companies, trailer manufacturers

and leading automotive stores. Peterson Manufacturing is one of the world's leading and innovative manufacturers of automotive lighting solutions supplying the world's leading OEM manufacturers. CDL Autoparts is proud to be the New Zealand distributor of this iconic brand. 100% New Zealand owned and operated and has been in business for over 50 years. Visit www.cdlaautoparts.co.nz to learn more.

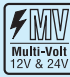
Guide to Quick-Reference Icons In This Catalog

A series of handy, quick-reference icons runs down the centre of nearly every product page in this catalog. These icons allow you to determine the major features of a particular Peterson product at a glance and compare similar products to determine which one is right for you. Below is a complete index of all the icons, along with a description of what each one means to you.

 	Indicates the number of diodes in LED lights. Diode counts may vary among related products.		One or more versions of this LED light feature a clear lens with diodes that light up in the appropriate colour.		Indicates that a light has integrated retro-reflector functionality that meets applicable legal requirements.
	Product is part of our new LumenX® line of premium LED lights.		Product is manufactured in the United States of America.		One or more versions of this product are available with a quick-mount magnetic base.
	LED product equipped with integrated hardwired leads, eliminating connection at light housing.	 	Product is designed for use with <i>either</i> 12-volt or 24-volt electrical systems.		Indicates that a product meets ECE lighting requirements.
	LED warning light with high-intensity strobing diodes.		Indicates that a product is multi-volt compatible for use with <i>both</i> 12-volt and 24-volt electrical systems.		Indicates that a product meets U.S. DOT requirements.
	Premium LED product with integrated voltage regulation circuitry for consistent output and long life.		Indicates clearance / marker lights that are U.S. DOT "PC" rated.		Indicates that a product meets ADR lighting requirements.

LED MARKER/OUTLINE LIGHTS

1268 – surface mount.....	2
2268 – surface mount.....	2
163 – 64mm round	4
165 – 51mm round	4
388 – slimline surface mount.....	4
1200 – surface mount w/reflex	6
1203 – surface mount w/reflex	6
181 – 19mm round	6
203 – surface mount.....	7
178 – oval surface mount	7
166 – beehive grommet mount.....	7

LED REAR POSITION & STOP LIGHTS

817/818 – 100mm round LumenX®	8
1217/1218 – 100mm round LumenX®	8
820/823 – oval LumenX®	11
1220/1223 – oval LumenX®	11
1223-4 – oval surface mount.....	13
850 – rectangular.....	14
338 – double-face round pedestal mount	18
339 – single-face round pedestal mount	18

LED TURN INDICATORS

817/818 – 100mm round LumenX®	9
1217/1218 – 100mm round LumenX®	9
820/823 – oval LumenX®	11
1220/1223 – oval LumenX®	11
1223-4 – oval surface mount.....	13
850 – rectangular.....	14
327 – double-face square pedestal mount	18
339 – single-face round pedestal mount	18

SUPPLEMENTARY TURN INDICATORS

1268A-MTC – supplementary side indicator	2
818WTA-9 – mid-trailer wide turn indicator.....	10
350 – mid-trailer turn indicator w/ reflex.....	12

LED REVERSE LIGHTS

817/818 – 100mm round LumenX®	10
1217/1218 – 100mm round LumenX®	10
820/823 – oval LumenX®	12
1220/1223 – oval LumenX®	12
850 – rectangular.....	14

LED COMBINATION LIGHTS

882/883 – 100mm round LumenX®	10
880/881 – oval LumenX®	12
1223 – oval surface mount	13
851 – rectangular.....	16
2217/2218/2219 – 100mm round	16
1288 – stud mount.....	17
2290 – surface mount.....	17
2291 – surface mount.....	17

LED NUMBER PLATE LIGHTS

153C-MV	19
290-MV	19

BACK-UP ALARMS

780 – 97 dB	20
781 – 102 dB	20
782 – 107 dB	20
784 – 112 dB	20
784C – 112 dB.....	20

TURN INDICATOR ACCESSORIES

5000 – Flasher unit.....	21
500 – Turn Indicator Switch.....	21

LED SPECIALTY LIGHTS

179 – oval accessory tunnel lights.....	21
1217G-R – traffic/loading dock light.....	29
920B-MV – blue pedestrian warning light.....	38

LED WARNING STROBES

850SA – rectangular.....	15
817/818 – 100mm round LumenX®.....	22
820/823 – oval LumenX®.....	22
253SA – rectangular surface mount with sync.....	23
1191SA – 64mm round.....	26
4153SA – surface mount programmable.....	26
4154SA – bracket mount programmable.....	26
4155SA – low profile programmable.....	26
4156SA – low profile programmable.....	26

LED MULTI-FUNCTION STROBES

860SA – 100mm round LumenX®.....	23
867SA – oval LumenX®.....	23

LED HAZARD WARNING LIGHT BARS

779-1 – programmable arrow stick.....	27
751A – programmable light bar.....	27
752A – programmable light bar.....	27

LED STROBE BEACONS

744.....	28
745.....	28
762.....	28
791.....	28
764.....	29
797.....	29
316 – battery-operated magnetic mount.....	29

LED DOME/UTILITY LIGHTS

358 – surface mount.....	30
359 – cove mount.....	30
360 – flush mount.....	31
365 – flush mount motion-sensing.....	31
368 – surface mount.....	31
388 – slimline surface mount.....	31
1223-4W – oval surface mount.....	32
397 – step well courtesy light.....	32
398 – alloy surface mount.....	32
178W – oval surface mount.....	33
369 – rotating with switch.....	33
817W/818W – 100mm round LumenX®.....	33

LED WORK LIGHTS

905 – 500 lumen square.....	34
906 – 1000 lumen rectangular.....	34
711 – 900 lumen PAR36.....	34
903 – 2000 lumen rectangular.....	35
904 – 750 lumen square.....	35
908S – 900 lumen round w/switch.....	35
921 – 1350 lumen round.....	36
910 – 1350 lumen square.....	36
910M - 1350 lumen square w/magnetic base.....	36
912 – 900 lumen round.....	37
913 – 1400 lumen square.....	37
915 – 3200 lumen rectangular.....	37
919 – 1900 lumen swivel-head.....	38
928 – 2520 lumen square.....	38

LED LIGHT BARS

931 – 13300 lumen 1 metre (39").....	39
930 – 19300 lumen 1 metre (39").....	39
932 – 3000 lumen 360mm (14").....	39
933 – 3600 lumen 360mm (14").....	39
934 – 6000 lumen 560mm (22").....	39

RUBBER MOUNTING GROMMETS & GASKETS

Fits 1268 series.....	3, 44
Fits 2268 series.....	3, 44
Fits 51mm round lights.....	5, 41
Fits 64mm round lights.....	5, 41
Fits 100mm round lights.....	41
Fits 165mm oval lights.....	41

MOUNTING BRACKETS & BEZELS

Fits 1268 series.....	3, 44
Fits 2268 series.....	3, 44
Fits 388 series.....	4, 31
Fits 51mm round lights.....	5, 41
Fits 51mm round lights – right-angle bracket.....	43
Fits 64mm round lights.....	5, 41
Fits 64mm round lights – right-angle bracket.....	43
Fits 1200 series.....	6
Fits 153C, 203, 253S series.....	7, 19, 23
Fits 178 series.....	7, 33
Fits 850 – surface mount modules.....	15
Fits 359 series – snap-in channel clip.....	30
Fits 100mm round lights – surface mount.....	43
Fits 100mm round lights – decorative bezel.....	40
Fits 100mm round lights – surface mount modules.....	42
Fits 100mm round lights – metal bolt-on modules.....	42
Fits 100mm round lights – right-angle bracket.....	43
Fits 165mm oval lights – surface mount.....	43
Fits 165mm oval lights – decorative bezel.....	40
Fits 165mm oval lights – right-angle bracket.....	43
Fits 1223-4 series & 1223A-R-MV.....	41

THEFT DETERRENT RINGS

Fits 51mm round lights.....	5, 40
Fits 64mm round lights.....	5, 40
Fits 100mm round lights.....	40
Fits 165mm oval lights.....	40

ELECTRICAL WIRING

Marker lamp plug.....	5, 45
5600 –timer box switch.....	30
2-wire hardshell plug.....	45
3-wire hardshell plug.....	45
3-wire molded plugs.....	45
Single wire hardshell plug.....	45

CONSPICUITY

Spitfire® pressure-sensitive adhesive reflectors.....	46
ECE-compliant triangular reflector.....	46
Rigid acrylic reflectors.....	47
1000-candlepower conspicuity tape rolls.....	48
High Intensity Prismatic conspicuity tape rolls.....	48
600-candlepower Daybright conspicuity tape rolls.....	48

Non-Peterson trade names appearing in this catalog are used for descriptive purposes only. Peterson & CDL acknowledge that these trademarks remain the property of their respective owners.

Dimensional illustrations and schematics shown in this catalog are intended to provide general marketing information only. Details and measurements may be approximate, and should not be relied on for engineering purposes.

1268A-MV mounted in 168-09 bracket



1268R-MV mounted in 168-10 bezel

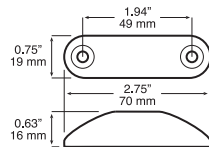
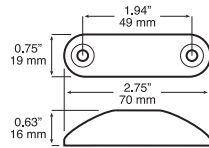

**LED With Clear Lens
Lights Up Half Red and
Half Amber**

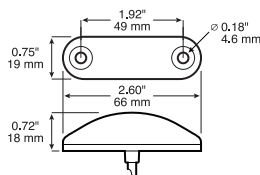

1268 Series LED ECE Compliant Side Marker / Outline Lights



- Compatible with 12V & 24V electrical systems.
- Certified to applicable ECE and ADR regulations.
- Hardwire design features sheathed, stripped leads.
- Refer to page 3 for mounting brackets.

Order Code	Description
1268A-MV	amber, 2 m leads
1268A-MVC	amber w / clear lens, 2 m leads
1268A-MVC-BT2	amber w / clear lens, 2 m leads w / .180 bullets.
1268R-MV	red, 2 m leads
1268R-MVC	red w / clear lens, 2 m leads
1268W-MV	white w / clear lens, 2 m leads

1268A-MTC LED ECE Compliant Side Marker / Auxiliary Side Direction Indicator



- Compatible with 12V & 24V electrical systems.
- Meets ECE Reg 6, Cat 5 for supplementary side direction indicator
- Equipped with 2.5 meter sheathed, stripped leads.
- Refer to page 3 for mounting brackets.

Order Code	Description
1268A-MTC	amber w / clear lens, 2.5 m (98.5")

2268 LED ADR Compliant Combination Side Marker Light



- **Certified to applicable ADR (Australian Design Rules) regulations. NOT ECE COMPLIANT**
- Welded rear housing, advanced surface-mount diodes, and more precise separation between red and amber illumination.
- Amber and red diodes behind clear lens
- Low profile, narrow surface-mount design suits narrow rails.
- Meets IP67 ingress rating.
- Hardwired design features 18-gauge leads.
- 2268A-R-MV has 2.5 meter leads. 2268A-R-MV-BT2 has 200 mm leads.
- Flat-wire sheathed cable for simplified crimp connections, less bulk.
- Multiple mounting hardware options.
- Compatible with 12V & 24V electrical systems.
- Recommended fastening: 4 mm screw.
- Refer to page 3 for mounting brackets.

Order Code	Description
2268A-R-MV	2.5 m (98.5") w / stripped leads
2268A-R-MV-BT2	200 mm (8") w / .180 bullets.
B2268-18	gasket for use w / o bracket

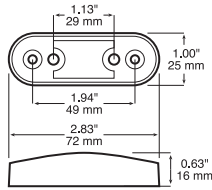

168

Surface Mount Bracket

- Enhances appearance of 1268 and 2268 series lights.
- Attractive black finish.
- May also be used to adapt mounting centres from 49mm to 29mm.

Order Code	Description
------------	-------------

B168-09	black
---------	-------

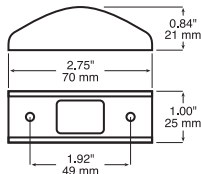

168-092

Aluminium Brush Guard

- Enhances durability and longevity of 1268 and 2268 series lights.
- Rugged, stamped aluminium construction for extra protection.
- Black powdercoat version available.
- Optional mounting gasket use B168-181.

Order Code	Description
------------	-------------

B168-092	aluminium finish
B168-092B	black powdercoat
B168-181	thinline mounting gasket

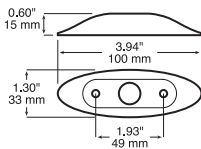

168-10

Decorative Chrome Bezel

- Enhances appearance of 1268 series lights.
- Attractive chrome finish.
- ABS construction.
- Optional mounting gasket use B168-182.

Order Code	Description
------------	-------------

B168-10	chrome
B168-182	thinline mounting gasket



168-18

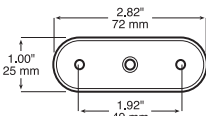

168-181

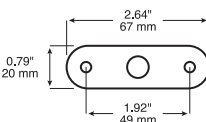

168-182

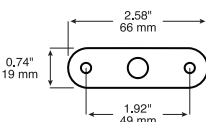

168

Mounting Gasket

- Fits 1268 series LED lights.
- Flexible rubber protects mounting surfaces.
- Use 168-18 when mounting 1268 light without brush guard or bezel.
- 168-181 for use with 168-092 aluminium brush guard.
- 168-182 for use with 168-10 chrome bezel.
- Use 2268-18 when mounting 2268A-R without bracket

Order Code	Description
------------	-------------

B168-18	black rubber
B168-181	mounting gasket for 168-092
B168-182	mounting gasket for 168-10
B2268-18	mounting gasket for 2268A-R-MV



2268-18

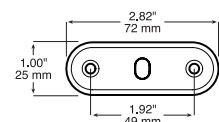

MARKER/OUTLINE LIGHTS

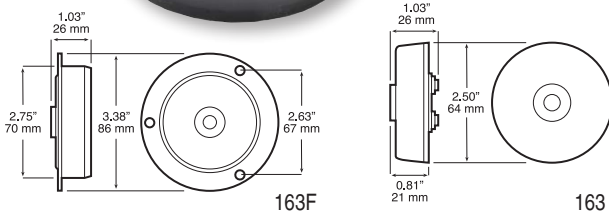

163 LED

64mm/2.5" PC-Rated Clearance & Side Marker Light



- Functions as both clearance and side marker light when mounted at a 45° angle. Use 143-18 rubber mounting grommet for PC-rated installation.
- Accepts industry standard 2-prong plug.
- Compatible with 12V & 24V electrical systems.
- Does not require "top" mounting.

Order Code	Description
M163A-MV	amber multi-volt
M163R-MV	red, multi-volt
M163FA-MV	amber, flange mount, multi-volt
M163FR-MV	red, flange mount, multi-volt

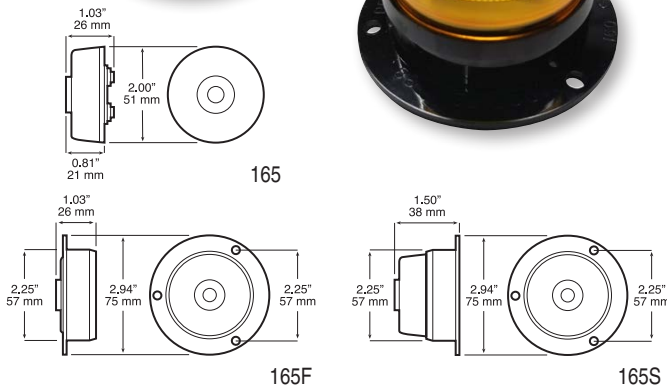

165 LED

51mm/2" PC-Rated Clearance & Side Marker Light



- Functions as both clearance and side marker light when mounted at a 45° angle.
- Does not require "top" mounting.
- Accepts industry standard 2-prong plug.
- Compatible with 12V & 24V electrical systems.
- Available in rubber mounting grommet, flange and surface-mount versions.

Order Code	Description
M165A-MV	amber, multi-volt
M165R-MV	red, multi-volt
M165FA-MV	amber, flange mount, multi-volt
M165FR-MV	red, flange mount, multi-volt
M165SA-MV	amber, surface mount, multi-volt
M165SR-MV	red, surface mount, multi-volt

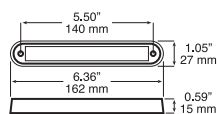

Optional 388-09X chrome bracket

388 LED

Clearance & Side Marker Light



- Meet DOT side marker / clearance light requirements.
- Includes black bracket for surface mounting, or can be recess-mounted without bracket.
- Optional chrome accessory bracket available.
- Compatible with 12V & 24V electrical systems.
- Low amp draw.

Order Code	Description
M388A	amber w/ black bracket
M388R	red w/ black bracket
B388-09X	chrome bracket

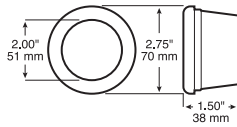

146

51mm/2" Rubber mounting grommet

- Allows 51mm (2") diameter sealed units to be flush mounted.
- Fits 59mm (2 5/16") mounting hole in panels up to 6.3mm (1/4") thick.

Order Code	Description
------------	-------------

146-182	closed back
---------	-------------

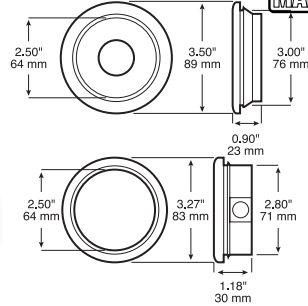

142/143

64mm/2.5" Rubber mounting grommets

- Fit 64mm (2 1/2") diameter sealed units.
- 142-18 allows rubber mounting grommet-mount lights to be flush mounted.
- 142-18 fits 76mm (3") mounting hole.
- 143-18 fits 71mm (2.78") mounting hole.

Order No.	Description
-----------	-------------

142-18	open back
--------	-----------

143-18	open back
--------	-----------

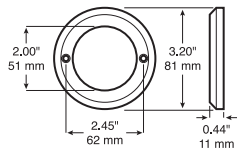

7005/7007

Decorative Bezels for Grommet mount Lights

- Chrome-plated plastic enhances appearance.
- Attaches to rubber mounting grommet with two tapered screws.
- Fits grommet-mounted 51mm (2") & 64mm (2 1/2") round vehicle lights.
- Includes stainless steel mounting screws.
- Attractive visual packaging.

Order No.	Description
-----------	-------------

V7005	51mm round bezel
-------	------------------

V7007	64mm round bezel
-------	------------------

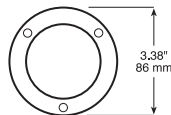
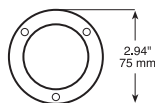
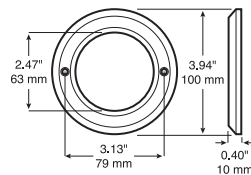

7005S/7007S

Theft Deterrent Rings for Flange Mount Lights

- 7005S fits 165 Series 51mm (2") round flange-mounted lights.
- 7007S fits 163 Series 64mm (2 1/2") round flange-mounted lights.
- Designed to work with flange for added theft protection.
- Attractive stainless-steel finish resists corrosion.
- Embossed with PM logo.
- Not compatible with "S" suffix surface-mount lights.

Order Code	Description
------------	-------------

V7005S	51mm dia. flange mount lights
--------	-------------------------------

V7007S	64mm dia. flange mount lights
--------	-------------------------------



162-49

LED Marker Lamp Plug

- Right-angle TRIPLE SEAL, two-wire plug for use with 162 and 163 series LED clearance/markers.
- 200mm (8") stripped hot wire; ground wire provided with #10 ring terminal and heat shrink tubing for additional corrosion protection.
- Use with 163, 165, & 166 series lights.

Order No.	Description
-----------	-------------

B162-49	stripped/ring for use with 163, 165, & 166 series
---------	---

MARKER/OUTLINE LIGHTS

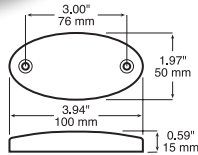

1200-09H



B1200-09X bezel

Optional mounting bracket and chrome bezel are shown with 1200A lights installed; sold separately.

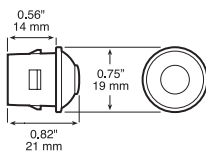
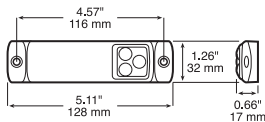

1200 LED ECE Compliant Oval Marker / Outline Lights w/ Reflex



- Low-profile, sealed design with integral reflex function.
- 1200C has two diodes, 1200A and 1200R have three diodes.
- Certified to applicable ECE regulations.
- Side marker meets ECE regulations mounted horizontally or vertically.
- Compatible with 12V & 24V electrical systems.
- Meets IP67 ingress protection level.
- Hardwired design has 300mm (12") sheathed leads.

Order Code	Description
1200A	amber side marker
1200C	white front outline marker
1200R	red rear outline marker
B1200-09H	horizontal mount bracket
B1200-09X	chrome bezel

1203 LED ECE+DOT Compliant Marker / Outline Lights w/ Integral Reflex



- LED marker lights feature 3 diodes and integral reflex.
- Red and amber lights meet both ECE and DOT requirements.
- White light certified to meet ECE front outline marker standard.
- Mounts on 116mm (4.5") centres to any flat, vertical surface.
- Hardwired design has 300mm (12") sheathed leads.
- Compatible with 12V & 24V electrical systems.

Order Code	Description
1203A	amber, stripped leads
1203C	white front outline marker
1203R	red rear outline marker

181 LED 19mm/0.75" PC-Rated Marker / Outline Lights



- Compact single diode design fits 19mm (3/4") hole.
- PC rated as both clearance and side marker light when mounted at a 45° angle with optical facets in lens running vertically.
- Hardwired 200mm (8") leads.
- Compatible with 12V & 24V electrical systems.
- Includes rubber mounting grommet.

Order Code	Description
M181A-MV	KIT amber, stripped leads
M181R-MV	KIT red, stripped leads

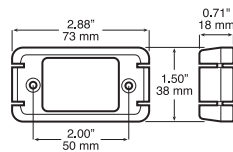
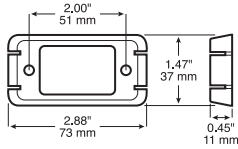
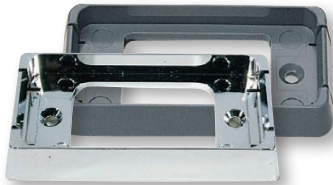
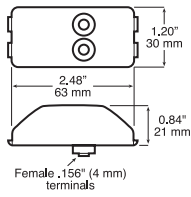
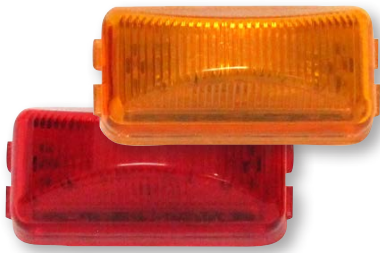

203 LED

PC-Rated Marker / Outline Lights Light



- Polycarbonate lens and base are welded together to form a single unit.
- Requires 162-49 plug for installation.
- 150-09 bracket allows lights to be surface mounted on 51mm centres.
- Compatible with 12 volt electrical systems.

Order Code	Description
M203A	amber
M203R	red
150-09	surface mount bracket, gray
150-10	surface mount bracket, chrome
150-095	surface mount bracket, black
B162-49	plug

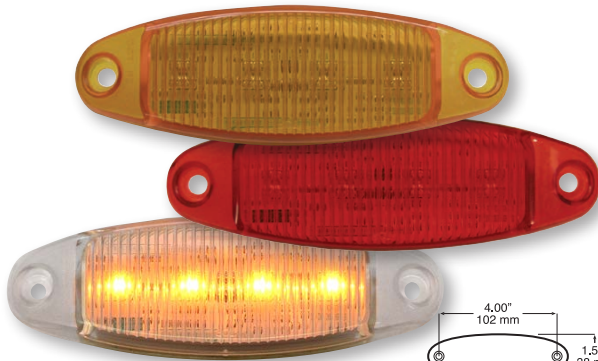

178A-MVC

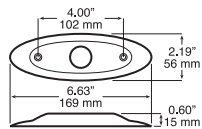
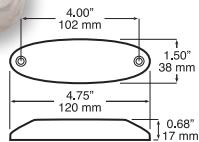

178 LED

Marker / Outline Lights



- Meets DOT requirements for clearance/side marker lights up to 20 degree tilt-back.
- Compatible with 12V & 24V electrical systems.
- Hardwired design with stripped leads.
- Optional chrome bezel available.
- Available amber diodes behind stylish clear lens.
- Mounts on 102mm centres.
- Eye-catching Class 8 look makes it a great retrofit choice.
- 178-10 bezel is corrosion-resistant ABS with chrome finish.

Order Code	Description
M178A-MV	amber
M178R-MV	red
M178A-MVC	amber w / clear lens
B178-10	chrome bezel

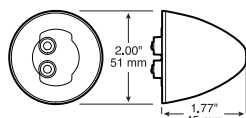

166 LED

51mm/2" Beehive Clearance/Side Marker Light



- 51mm (2") tapered beehive shape.
- Features sealed lens and housing.
- Requires 162-49 plug and 146-182 rubber grommet for installation.
- Compatible with 12 volt electrical systems.

Order Code	Description
M166A	amber
146-182	51mm/2" Rubber mounting grommet
B162-49	plug

ROUND LIGHTS

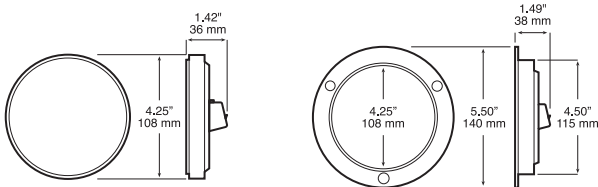
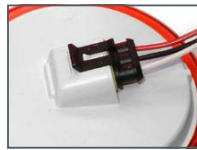

817-9/818-9/1217-9/1218-9 LumenX® LED 100mm/4" Round Stop, Turn & Tail Light



- White diodes behind red lens.
- Advanced optics fully illuminate lens.
- AMP-compatible connector integrated into housing.
- Regulated design provides voltage protection and consistent light output over a wide voltage range.
- Grommet mount version fits 114 mm hole in material up to 6 mm.
- Grommet mount version has skirted weld joint for added protection.
- Flange mount version has flange integrated into the housing.
- Compatible with 12V & 24V electrical systems. Does not require "Top" positioning to meet FMVSS 108 standard.

Order Code Description

817R-9	grommet mount	DOT
818R-9	flange mount	DOT
1217R-9	red, grommet mount	ADR/ECE
1218R-9	red, flange mount	ADR/ECE
426-18	rubber mounting grommet — use with 817 & 1217	
B817-49	molded plug, 3-wire, 200 mm	
B817-49S	3-wire molded plug, 305 mm, flat wire	
B817-49L	3-wire molded plug, 2.5 metres	
V7009	decorative chrome bezel — use with 817 & 1217	
V7009S	stainless theft-deterrent ring — use with 818 & 1218	

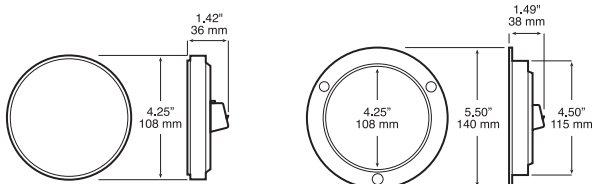

817/818CR-9 LED

100mm/4" Round Stop/Turn/Tail Light



- Features red diodes behind clear lens.
- AMP-compatible connector integrated into housing.
- Compatible with 12V & 24V electrical systems.
- Reverse voltage protection prevents damage if mis-installed.
- Grommet mount version fits 114 mm hole in material up to 6 mm.
- Grommet mount version has skirted weld joint for added protection.
- Flange mount version has flange integrated into the housing.
- Does not require "Top" positioning to meet FMVSS 108 standard.

Order Code Description

817CR-9	red, grommet mount	DOT
818CR-9	red, flange mount	DOT
426-18	rubber mounting grommet — use with 817	
B817-49	molded plug, 3-wire, 200 mm	
B817-49S	3-wire molded plug, 305 mm, flat wire	
B817-49L	3-wire molded plug, 2.5 metres	
V7009	decorative chrome bezel — use with 817	
V7009S	stainless theft-deterrent ring — use with 818	

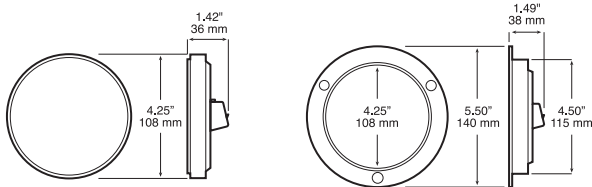

817-9/818-9/1217-9/1218-9 LumenX® LED 100mm/4" Round Front & Rear Direction Indicator



- White diodes and advanced optics fully illuminate amber lens.
- AMP-compatible connector integrated into housing.
- Regulated design provides voltage protection and consistent light output over a wide voltage range.
- 817/818 Series meet DOT standards for both **FRONT** and **REAR** turn signal use.
- 817/818 Series meet DOT side marker requirements.
- 817/818 Series include both turn signal and low intensity marker circuits.
- Grommet mount version fits 114 mm hole in material up to 6 mm.
- Grommet mount version has skirted weld joint for added protection.
- Flange mount version has flange integrated into the housing.
- Compatible with 12V & 24V electrical systems.
- Does not require "Top" positioning to meet FMVSS 108 standard.

Order Code Description

817A-9	grommet mount	DOT
818A-9	flange mount	DOT
1217A-9	grommet mount	ADR/ECE
1218A-9	flange mount	ADR/ECE
426-18	rubber mounting grommet — use with 817 & 1217	
B817-49	molded plug, 3-wire, 200 mm	
B817-49S	3-wire molded plug, 305 mm, flat wire	
B817-49L	3-wire molded plug, 2.5 metres	
V7009	decorative chrome bezel — use with 817 & 1217	
V7009S	stainless theft-deterrent ring — use with 818 & 1218	

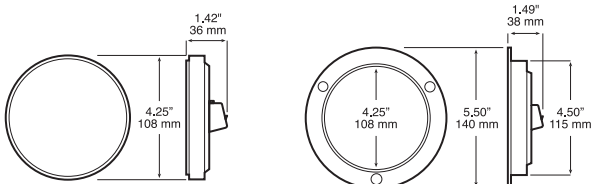

817/818CA-9 LED 100mm/4" Round Amber Rear Direction Indicator



- Features amber diodes behind clear lens.
- AMP-compatible connector integrated into housing.
- Compatible with 12V & 24V electrical systems.
- Reverse voltage protection prevents damage if mis-installed.
- Grommet mount version fits 114 mm hole in material up to 6 mm.
- Grommet mount version has skirted weld joint for added protection.
- Flange mount version has flange integrated into the housing.
- Does not require "Top" positioning to meet FMVSS 108 standard.

Order Code Description

817CA-9	amber, grommet mount	DOT
818CA-9	amber, flange mount	DOT
426-18	rubber mounting grommet — use with 817	
B817-49	molded plug, 3-wire, 200 mm	
B817-49S	3-wire molded plug, 305 mm, flat wire	
B817-49L	3-wire molded plug, 2.5 metres	
V7009	decorative chrome bezel — use with 817	
V7009S	stainless theft-deterrent ring — use with 818	

ROUND LIGHTS

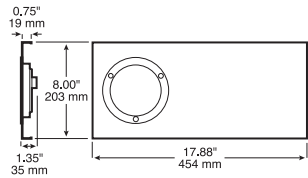
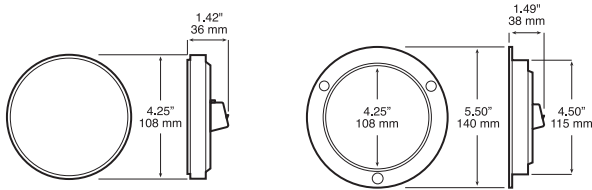

LumenX[®]
IBL
2-in-1 PATENTED

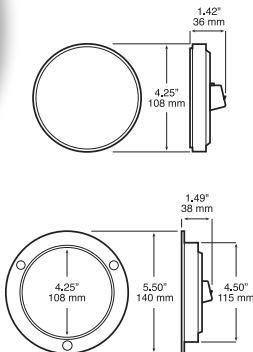

817-9/818-9/1217-9/1218-9 LumenX[®] LED 100mm/4" Round Reverse Light



- White diodes fully illuminate advanced optics lens.
- AMP-compatible connector integrated into housing.
- A single 817C-9 or 818C-9 meets FMVSS 108 req. when properly mounted.
- Regulated design provides voltage protection and consistent output.
- Compatible with 12V & 24V electrical systems.
- Grommet mount version fits 114 mm hole in material up to 6 mm.
- Grommet mount version has skirted weld joint for added protection.
- Flange mount version has flange integrated into the housing.
- Does not require "Top" positioning to meet FMVSS 108 standard.

Order Code Description

817C-9	grommet mount	DOT
818C-9	flange mount	DOT
1217C-9	grommet mount	ADR/ECE
1218C-9	flange mount	ADR/ECE
426-18	rubber mounting grommet	— use with 817 & 1217
B817-49	molded plug, 3-wire, 200 mm	
V7009	decorative chrome bezel	— use with 817 & 1217
V7009S	stainless theft-deterrent ring	— use with 818 & 1218

818WTA LED

Mid-Trailer, Wide-Turn Auxiliary Indicator



- Designed to improve visibility on tractor/trailer applications.
- Features 9-diode LumenX[®] light in L-bracket with bright graphics.
- Commonly used in mid-turn applications.
- Can be configured for either right- or left-side application.
- Compatible with 12V & 24V electrical systems.
- Kit includes sign, light, and instruction sheet.
- Requires B817-49 AMP-compatible plug to complete installation.

Order Code Description

818WTA-9	KIT	9-diode LumenX [®]
B817-49		molded plug

882-7/883-7 LumenX[®] LED 100mm/4" Round Combo Stop, Turn, Tail, & Back-Up Light



- Cyclops-style design integrates back-up light into stop/turn/tail light.
- Single bright white diode meets legal back-up light req. used in pairs.
- Integral AMP receptacles built into housing.
- Compatible with 12V & 24V electrical systems.
- Meets FMVSS 108 req. in horizontal, vertical or any 360° position.



Order Code Description

882-7-MV	grommet mount
883-7-MV	flange mount
426-18	rubber mounting grommet — use with 882
B817-49	molded plug, 3-wire, 200 mm
B880-49	hardshell plug, single lead

820-10/823-10/1220-10/1223-10 LumenX® LED 165mm/6.5" Oval Stop, Rear Turn & Tail Light



- White diodes fully illuminate red lens.
- AMP-compatible connector integrated into housing.
- Regulated design provides voltage protection and consistent output.
- Compatible with 12V & 24V electrical systems.
- Sealed lens and housing meets IP67 ingress level.
- Grommet mount version fits material up to 6 mm.
- 820R-10/823R-10 meet FMVSS 108 requirements in horizontal, vertical or any 360° position.
- 1220R-10/1223R-10 certified to meet ECE requirements in horizontal or vertical position.

Order Code Description

820R-10	grommet mount	DOT
823R-10	flange mount	DOT
1220R-10	grommet mount	ADR/ECE
1223R-10	flange mount	ADR/ECE
421-18	rubber mounting grommet	— use with 820 & 1220
B817-49	molded plug, 3-wire, 200 mm	
B817-49S	3-wire molded plug, 305 mm, flat wire	
B817-49L	3-wire molded plug, 2.5 metres	
V7011	decorative chrome bezel	— use with 820 & 1220
V7011S	stainless theft-deterrent ring	— use with 823 & 1223

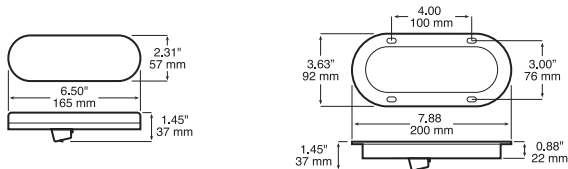

820-10/823-10/1220-10/1223-10 LumenX® LED 165mm/6.5" Oval Front & Rear Turn Signal



White diodes fully illuminate amber lens.

- AMP-compatible connector integrated into housing.
- Regulated design provides voltage protection and consistent output.
- Compatible with 12V & 24V electrical systems.
- Sealed lens and housing meets IP67 ingress level.
- Grommet mount version fits material up to 6 mm.
- 820A-10/823A-10 meet FMVSS 108 standards for both **FRONT** and **REAR** turn signal use in horizontal, vertical or any 360° position.
- 820A-10/823A-10 meet FMVSS 108 side marker requirements.
- 820A-10/823A-10 include turn indicator & low intensity marker functions.
- 1220A-10/1223A-10 certified to meet ECE requirement for front & rear turn indicator when mounted in vertical or horizontal orientation.

Order Code Description

820A-10	grommet mount	DOT
823A-10	flange mount	DOT
1220A-10	grommet mount	ADR/ECE
1223A-10	flange mount	ADR/ECE
421-18	rubber mounting grommet	— use with 820 & 1220
B817-49	molded plug, 3-wire, 200 mm	
B817-49S	3-wire molded plug, 305 mm, flat wire	
B817-49L	3-wire molded plug, 2.5 metres	
V7011	decorative chrome bezel	— use with 820 & 1220
V7011S	stainless theft-deterrent ring	— use with 823 & 1223

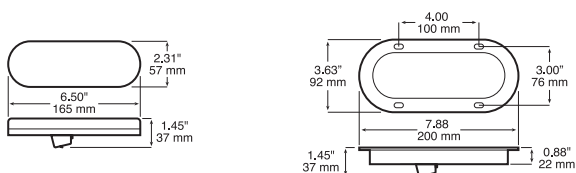

OVAL LIGHTS

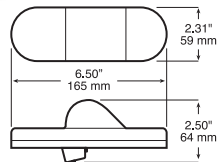
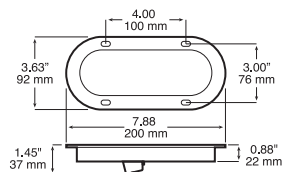
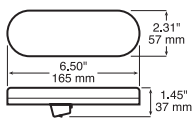

LumenX
I B L
2-in-1 PATENTED

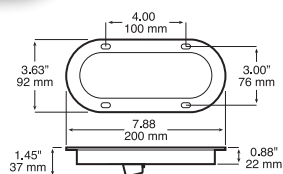
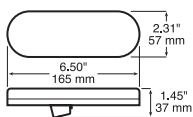

820-10/823-10/1220-10/1223-10 LumenX® LED 165mm/6.5" Oval Reverse Light



- White diodes fully illuminate advanced optics lens.
- AMP-compatible connector integrated into housing.
- Regulated design provides voltage protection and consistent output.
- Compatible with 12V & 24V electrical systems.
- Sealed lens and housing meets IP67 ingress level.
- Grommet mount version fits material up to 6 mm.
- A single 820C-10/823C-10 meet FMVSS 108 req. in horizontal, vertical or any 360° position.
- 1220C-10/1223C-10 certified to meet ECE req. in horizontal or vertical position.

Order Code Description

820C-10	grommet mount	DOT
823C-10	flange mount	DOT
1220C-10	grommet mount	ADR/ECE
1223C-10	flange mount	ADR/ECE
421-18	rubber mounting grommet	— use with 820 & 1220
B817-49	molded plug, 3-wire, 200 mm	
V7011	decorative chrome bezel	— use with 820 & 1220
V7011S	stainless theft-deterrent ring	— use with 823 & 1223

350 LED 165mm/6.5" Oval Amber Auxiliary/Mid-Turn Light w/ Reflex



- Two-function, 6-diode LED light that may be used as auxiliary mid-turn, while providing intermediate side marker light and side reflector.
- Hardwired leads are terminated with hardwired AMP connector.
- Compatible with 12V & 24V electrical systems.

Order Code Description

350A	grommet mount
421-18	rubber mounting grommet
V7011	decorative chrome bezel

880-7/881-7 LumenX® LED 165mm/6.5" Oval Combo Stop, Turn, Tail, & Back-Up Light



- Cyclops-style design integrates back-up light into stop/turn/tail light.
- Single bright white diode meets legal back-up light req. used in pairs.
- Integral AMP-compatible receptacles built into housing.
- Compatible with 12V & 24V electrical systems.
- Meets FMVSS 108 req. in horizontal, vertical or any 360° position.

Order Code Description

880-7-MV	grommet mount	
881-7-MV	flange mount	
421-18	rubber mounting grommet	— use with 880
B817-49	molded plug, 3-wire, 200 mm	
B880-49	hardshell plug, single lead	
V7011	decorative chrome bezel	— use with 880
V7011S	stainless theft-deterrent ring	— use with 881



Shown with 423-11 chrome bezel installed, available separately.

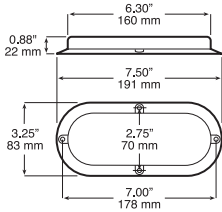

1223-4 LED ECE Compliant Surface Mount Rear Tail & Stop Light

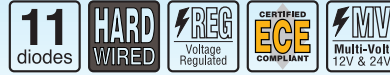

- Oval design w/ black surface-mount housing & optional chrome bezel.
- Certified to meet ECE requirements in horizontal or vertical position.
- Sealed lens and housing meets IP67 ingress level.
- Compatible with 12V & 24V electrical systems.
- Hardwired design with 200mm (8") lead wires.
- Convenient surface mounting with four screws.
- See matching amber rear turn signal below.
- Attractive chrome bezel available separately.

Order Code	Description
1223R-4	red tail & stop
B423-11	chrome bezel

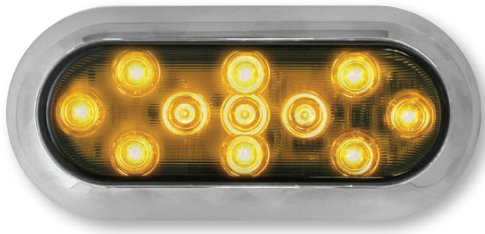

Shown with 423-11 chrome bezel installed, available separately.

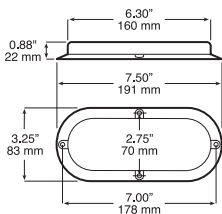

1223-4 LED ECE Compliant Surface Mount Rear Turn Signal Light



- Oval design w/ black surface-mount housing & optional chrome bezel.
- Certified to meet ECE requirements in horizontal or vertical position.
- Sealed lens and housing meets IP67 ingress level.
- Compatible with 12V & 24V electrical systems.
- Hardwired design with 200mm (8") lead wires.
- Convenient surface mounting with four screws.
- See matching red rear stop and tail light above.
- Attractive chrome bezel available separately.

Order Code	Description
1223A-4	amber rear turn signal
B423-11	chrome bezel

Clear lens with clear diodes that light up red and amber.



Shown with 423-11 chrome bezel installed, available separately.

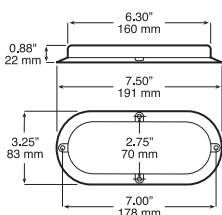

1223 LED ECE Compliant Surface Mount Combination Stop, Rear Turn & Tail Light



- Oval design w/ black surface-mount housing & optional chrome bezel.
- Clear lens with clear diodes that light up red and amber.
- Certified to meet ECE requirements for all functions in horizontal or vertical position.
- Meets IP67 ingress level.
- Compatible with 12V & 24V electrical systems.
- Hardwired design with 200mm (8") lead wires.
- Convenient surface mounting with four screws.
- See matching red rear stop and tail light above.

Order Code	Description
1223A-R-MV	red/amber combo, multi-volt
B423-11	chrome bezel

RECTANGULAR LIGHTS

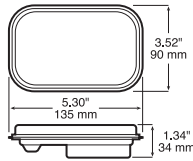

850R LED ECE Compliant Rectangular Tail & Stop Light



- Certified to both FMVSS 108 & ECE requirements in horizontal or vertical position.
- Available with 300mm (12") or 2 meter (6½-ft.) hardwired leads.
- Sealed lens and housing meets IP67 ingress protection level.
- Compatible with 12V & 24V electrical systems.
- Rubber mounting grommet fits material up to 6 mm.
- May be surface mounted using cluster pods on opposite page.

Order Code	Description
850R	red, 2 meter leads
850R-1	red, 300mm leads
B850-18	rubber mounting grommet

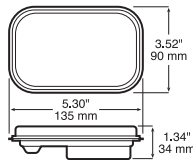

850A LED ECE Compliant Rectangular Rear Turn Signal Light



- Certified to both FMVSS 108 & ECE requirements in horizontal or vertical position.
- Available with 300mm (12") or 2 meter (6½-ft.) hardwired leads.
- Sealed lens and housing meets IP67 ingress protection level.
- Compatible with 12V & 24V electrical systems.
- Rubber mounting grommet fits material up to 6 mm.
- May be surface mounted using cluster pods on opposite page.

Order Code	Description
850A	amber, 2 meter leads
850A-1	amber, 300mm leads
B850-18	rubber mounting grommet

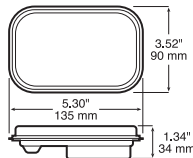

850C LED ECE+DOT Compliant Rectangular Reverse Light



- Certified to both FMVSS 108 & ECE requirements mounted vertically.
- Compatible with 12V & 24V electrical systems.
- Available with 300mm (12") or 2 meter (6½-ft.) hardwired leads.
- 850C-1P has hardwired PL3 plug.
- Rubber mounting grommet fits material up to 6 mm.
- May be surface mounted using cluster pods on opposite page.

Order Code	Description
850C	vertical, 2m leads
850C-1	vertical, 300mm leads
B850-18	rubber mounting grommet

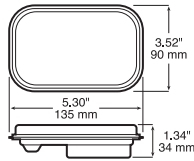

850SA LED

Rectangular Auxiliary Strobing Light



- LED light functions as auxiliary strobe or warning light.
- Two separate hot leads for selectable dual flash or quad flash strobe.
- Strobing function meets SAE J595 Class 2 specification.
- Compatible with 12V & 24V electrical systems.
- Ideal for emergency, construction and refuse vehicles.
- Potted, hardwired 300mm (12") sheathed leads.
- Sealed lens and housing meets IP67 ingress protection level.
- Rubber mounting grommet fits material up to 6 mm, or can alternately be surface mounted using cluster pods listed below.

Order Code	Description
850SA	amber
B850-18	rubber mounting grommet



850-1



850-092V



850-092H



850-093H



850-093V

Shown with light installed, sold separately

**CONVENIENT
TWO-PIECE DESIGN**

850

Stud Mount Light Modules

- High-strength, corrosion-free, UV-resistant, black glass-filled nylon.
- All 850 series rectangular LED lights snap in easily.
- Not compatible with incandescent lights.
- No rubber mounting grommets required.
- Separate backing plate has 25 mm (1") cable exit hole and integral mounting studs, plus 30 mm (1.20") long, black stainless, self-cutting #10 pozi-drive screws.

Order Code	Description
850-1	single light w/ back plate
850-092H	double light, horizontal
850-092V	double light, vertical
850-093H	triple light, horizontal
850-093V	triple light, vertical

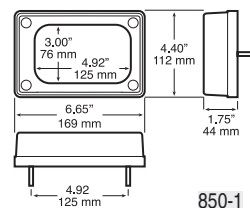

850-1

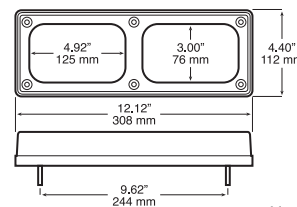

850-092H

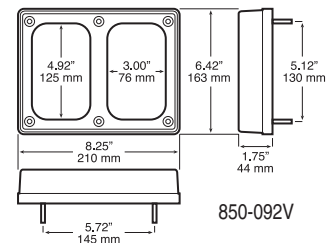

850-092V

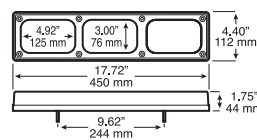

850-093H

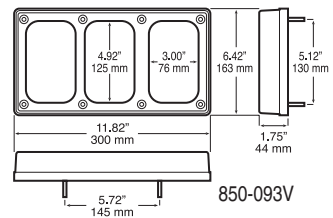

850-093V



Clear lens with diodes that light up red and amber.

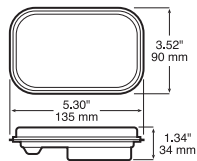

851A-R LED ECE Compliant Combination Stop, Rear Turn & Tail Light



- Turn function in upper half, tail and stop functions in lower half.
- Clear lens with diodes that light up red and amber.
- Certified to meet ECE requirements for all functions.
- Sealed lens and housing meets IP67 ingress protection level.
- Compatible with 12V & 24V electrical systems.
- Available with 300mm (12") or 2 meter (6½-ft.) hardwired leads.
- Rubber mounting grommet fits material up to 6 mm.
- May be surface mounted using cluster pods on opposite page.

Order Code	Description
851A-R	amber / red combo, 2m leads
851A-R-SW	amber / red combo, 300mm leads
B850-18	rubber mounting grommet

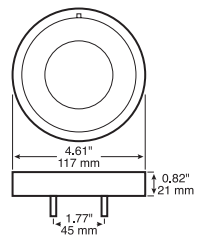
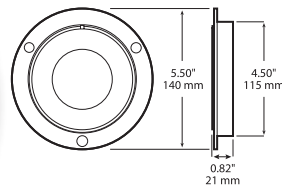
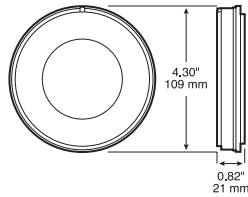

2217A-R/2218A-R/2219A-R LED ECE Compliant 100mm/4" Combo Stop, Rear Turn & Tail Light



- Rear combination light has turn function in centre, tail and stop functions in outer ring.
- Certified to meet ECE requirements for all functions.
- Compatible with 12V & 24V electrical systems.
- Hardwired design features 300mm (12") leads.
- Sealed lens and housing meets IP67 ingress protection level.
- Grommet mount version fits 114 mm hole in material up to 6 mm.

Order Code	Description
2217A-R	red / amber combo, grommet mount
2218A-R	red / amber combo, flange mount
2219A-R	red / amber combo, stud mount
426-18	rubber mounting grommet
V7009	decorative chrome bezel — use with 2217
V7009S	stainless theft-deterrent ring — use with 2218



2219A-R features two mounting studs on rear

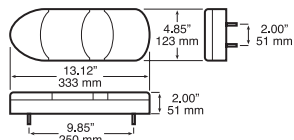
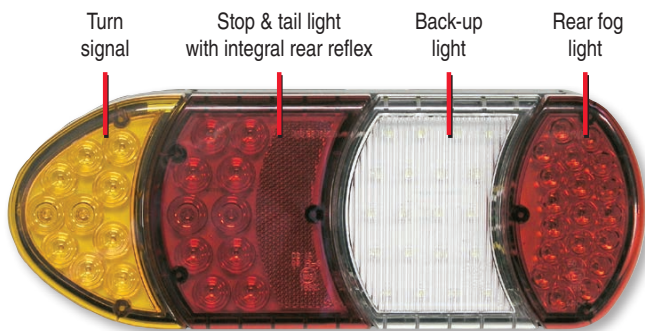

End-positioned side marker light standard



AMP plug
Integral mounting studs



Two receptacles on either side accept optional license light
Two standard receptacle covers keep debris out



1288 LED ECE-Compliant Stud-Mount Rear Cluster Light



- Combination side marker, tail, stop, rear fog, turn signal and back-up light.
- Integral rear reflex.
- Certified to applicable ECE regulations.
- Surface mounts with four studs.
- Universal design mounts on left or right side of vehicle.
- Compatible with 12V & 24V electrical systems.
- Hardwired design features 300mm (12") sheathed cable with a single 6-pole AMP plug for all wiring connections.
- Sealed components meet IP67 ingress protection level.
- Optional snap-in rear license plate light (not included with 1288 light).
- Individual replacement light modules sold separately.
- Replacement modules come with adhesive-filled heat-sealable connectors for corrosion resistant butt-splices to existing wiring.

Order Code	Description
1288	cluster light assy, stud mount
1288C	optional white license plate module

All component modules available separately for replacement of individual components.

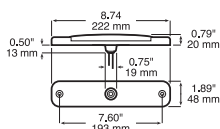
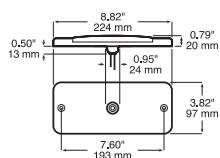
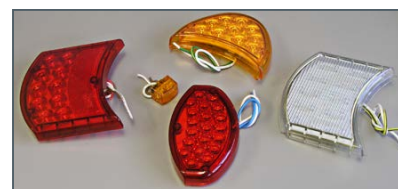

2290A-R LED ECE Compliant Combination Stop, Rear Turn & Tail Light



- Advanced lens design with new Fresnel-style optics.
- Light appears clear when unlit.
- Compatible with 12V & 24V electrical systems.
- Compliant to ECE/ADR requirements for all functions when mounted vertically or horizontally with amber diodes on top or to outside of vehicle.
- Convenient, low-profile surface mounting.
- Sealed lens and housing meets IP67 ingress protection level.
- 100,000 hour rated life.
- 2 metre (78") sheathed wires.

Order Code	Description
2290A-R	amber & red, 40 diode

2291A-R LED ECE Compliant Combination Stop, Rear Turn & Tail Light



- All the great features of 2290A-R above in a slimmer 24-diode version.

Order Code	Description
2291A-R	amber & red, slimline

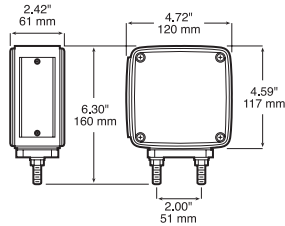

327 LED

Double-Face Park & Turn Light w/Side Marker



- Available with two amber lenses or with amber lens facing front of vehicle and red lens facing to rear.
- 327L for roadside use, 327R for curbside.
- Includes side marker function and reflex.
- 2-stud pedestal mount.
- 3-wire electrical connection.
- Two 120mm (4.5") square acrylic lenses.
- Chrome plated plastic housing.
- Compatible with 12 volt electrical systems.

Order Code	Description
------------	-------------

V327AA	amber / amber
V327L	amber / red, roadside
V327R	amber / red, curbside

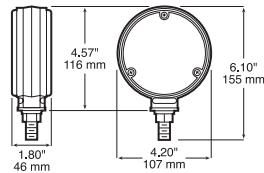

338-2 LED

Double-Face Round Park & Turn Light



- Has amber lens facing front of vehicle, red lens facing to rear.
- Reversible for use on either side of vehicle.
- Single stud pedestal mount.
- 3-wire electrical connection.
- Two 100mm round acrylic lenses.
- Chrome die-cast housing.
- Compatible with 12 volt electrical systems.

Order Code	Description
------------	-------------

V338-2	amber / red
--------	-------------

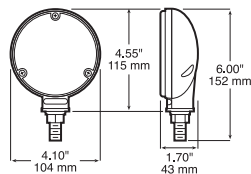

339 LED

Single-Face Round Park & Turn or S/T/T Light



- 339A amber (front-facing) and 339R red (rear-facing) versions.
- Single stud pedestal mount.
- 3-wire electrical connection.
- Single 100mm round acrylic lens.
- Chrome die-cast housing.
- Compatible with 12 volt electrical systems.

Order Code	Description
------------	-------------

V339A	amber
V339R	red

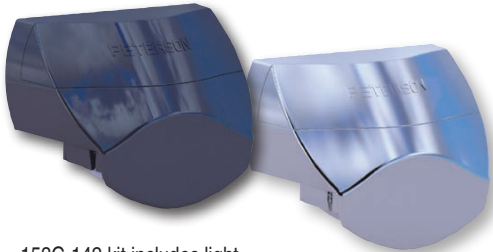
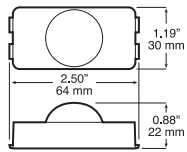

153C-142 kit includes light plus 150-142 hooded bracket

150-143 hooded bracket

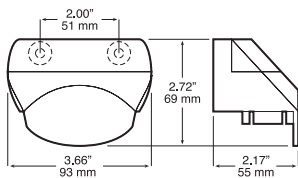

153C LED

Number Plate & Utility Light



- Meets FMVSS 108 and ECE requirements.
- Also suitable for use as compartment or utility light.
- Compatible with 12V & 24V electrical systems.
- Ideal for utility applications when used with surface-mount bracket.

Order Code Description

M153C-MV	white
M153C-142	KIT white light in black hooded housing
M153C-143	KIT white light in chrome hooded housing
150-09	surface mount bracket, gray
150-10	surface mount bracket, chrome
150-095	surface mount bracket, black
B150-142	black hooded bracket
B150-143	chrome hooded bracket



150-095



150-10 150-10

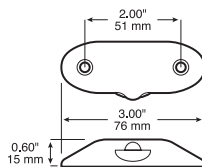
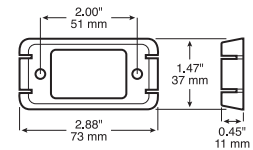
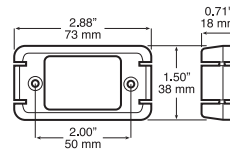

UTILITY
290-MV



TOP MOUNT
290C-MV



SIDE MOUNT
290C-MV-SM

290 Single Diode LED

Number Plate & Utility Light



- Compact, efficient design.
- Advanced optics for bright, even illumination.
- Compatible with 12V & 24V electrical systems.
- Surface-mounts on 51mm centres.

Order Code Description

290-MV	utility light
290C-MV	number plate light, single top mount – 2 req. for side mount
290C-MV-SM	number plate light, single side mount

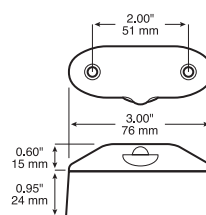

290C-MV

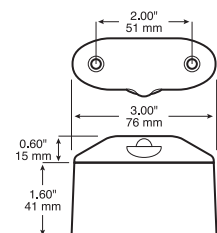

290C-MV-SM

UL APPROVED

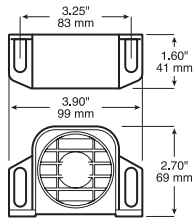

780/781 97 dB & 102 dB Back-Up Alarms



- 97 decibel and 102 decibel versions.
- Compatible with 12V & 24V electrical systems.
- Less than 0.6 amp draw.
- -40° to +185° F temperature range.
- ABS housing and epoxy-sealed inside for vibration & moisture protection.
- Unit may be grounded through mounting screw.
- 780 meets SAE J994 Type C requirements.
- 781 meets SAE J994 Type F requirements.
- Meets IP65 ingress protection standard.

Order No.	Description
780	97 dB
781	102 dB

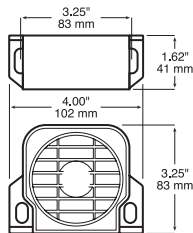

782 107 dB Back-Up Alarm



- Meets SAE J994 Type B specifications.
- 12-24 volt operating range.
- Can be mounted to horizontal or vertical surfaces.
- Less than 0.8 amp draw.
- ABS housing and epoxy-sealed inside for vibration & moisture protection.
- Unit may be grounded through mounting screw.

Order Code	Description
782	107 dB, stripped leads

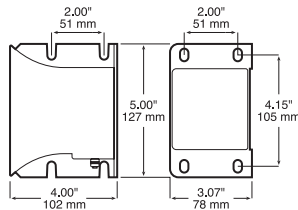

784 112 dB Back-Up Alarm



- Meets SAE J994 Type A specifications.
- 12-24 volt operating range.
- Less than 0.8 amp draw.
- Can be mounted to horizontal or vertical surfaces.

Order Code	Description
784	112 dB

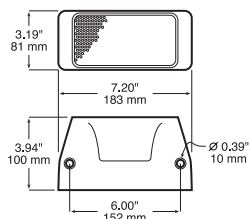

784-C Back-Up Alarm



- 112 dB volume
- 12-24V voltage range
- Less than 0.8 amp average current draw
- Rugged full-coverage housing & epoxy-encapsulated circuit board

Order Code	Description
784-C	112 dB

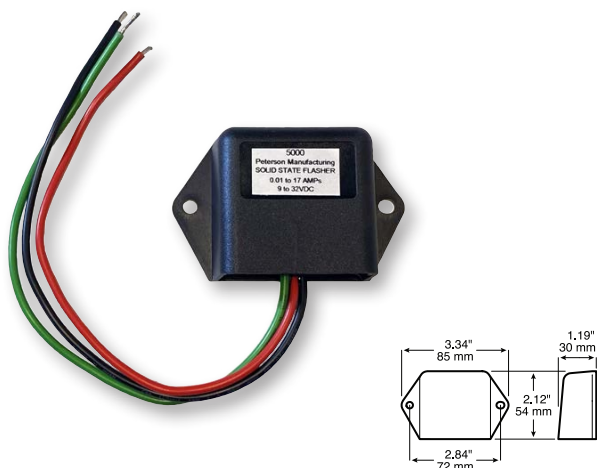

5000

Solid-State LED Flasher



- Resolves flash rate issues caused by reduced resistance LED lights.
- Surface-mount, fully encapsulated, solid-state flasher.
- For use with LED and/or incandescent lamps.
- Operates at .01 to 17 amps.
- Compatible with 12V & 24V electrical systems.
- Retrofit standard 2- and 3- prong flashers using included hardware.
- Complete kit includes 1 jumper wire, 1 tie-down, 2 mounting screws, 3 blade terminals, 1 #10 ring terminal, and instruction sheet.
- Meets FMVSS 108 and SAE J590, J945 & J2068 specifications.

Order Code	Description
5000	solid-state flasher

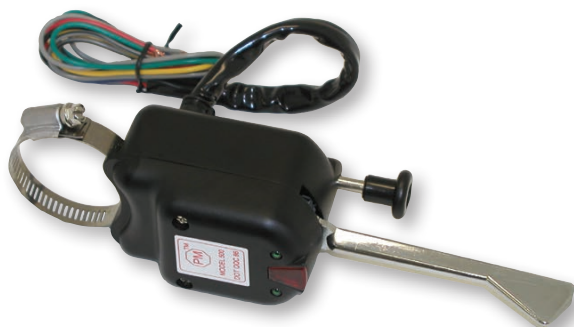

500

Turn Signal Switch



- 7-wire unit for vehicles with combination stop and turn signal lamps requiring brake light circuit.
- Includes built-in pilot lights to indicate left and right turn.
- Heavy diecast flat black enamel housing w/ chrome-plated lever.
- Hazard warning switch with hazard pilot light.
- Supplied with universal steering column clamp and in-line fuse.
- Flasher not included.
- Compatible with 12 volt electrical systems. *May be made compatible with 24 volt systems by replacing the indicator bulb with a suitable 24V version.*

Order Code	Description
500	7-wire

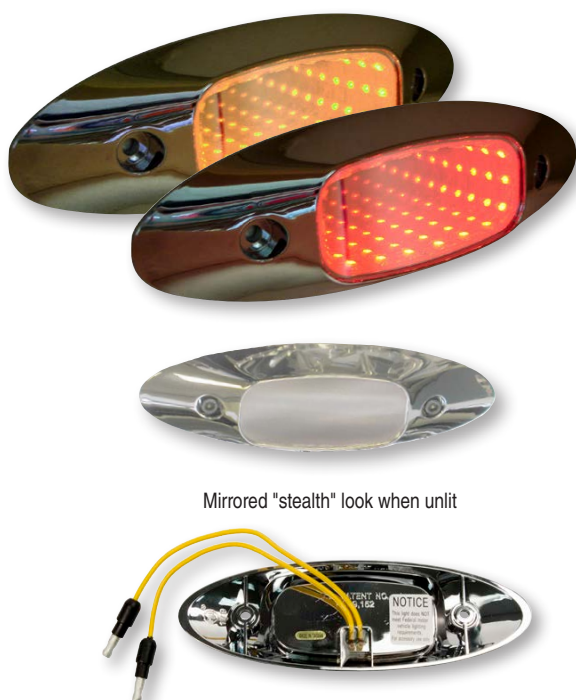

Mirrored "stealth" look when unlit

179 LED Oval

Accessory Tunnel Lights™



- Chrome stealth look when off, stunning 3D tunnel effect when on!
- Illuminate and beautify stainless steel air cleaners, headache racks, bumpers, door panels, & running boards.
- For off-road or accessory use; not to replace legally required lighting.
- Mounts on 4" centers using #10 screws
- Reversible leads w/ .180 bullets. Terminals can be removed for hard-wiring connection to vehicle harness.
- Compatible with all 12 volt systems.

Order Code	Description
M179A	amber
M179R	red

LED STROBING LIGHTS

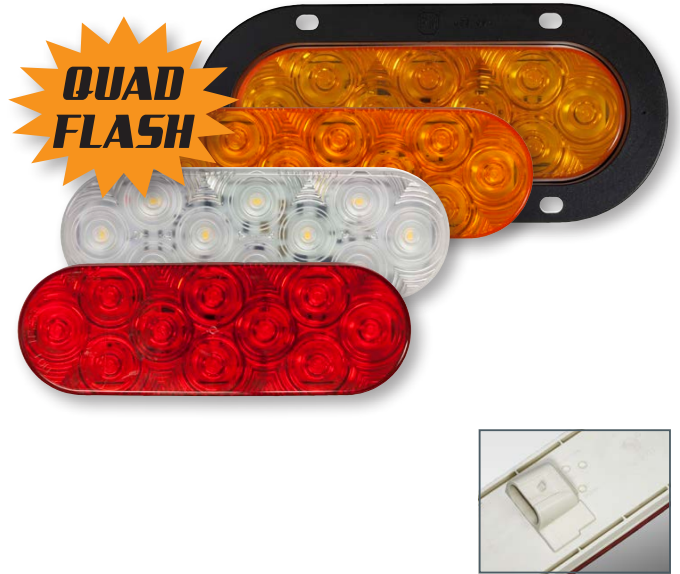

817S/818S LumenX® LED 100mm/4" Round Auxiliary Round Strobing Lights



- Meets SAE J595 Class 1
- Strobing light functions as auxiliary strobe or warning light.
- Ideal for emergency, construction and refuse vehicles.
- New white diodes behind white or coloured lenses.
- Advanced optics fully illuminate lens.
- AMP-compatible connector integrated into housing.
- Regulated design provides voltage protection and consistent light output.
- 818-9 has flange integrated into the housing.
- Grommet mount version may be surface mounted using 817-09 bracket.
- Compatible with 12V & 24V electrical systems.

Order Code	Description
817SA-9	amber, grommet mount
818SA-9	amber, flange mount
817SR-9	red, grommet mount
818SR-9	red, flange mount
817SW-9	white, grommet mount
818SW-9	white, flange mount
426-18	rubber mounting grommet — use with 817
817-09	round surface mount bracket
B817-49	molded plug, 3-wire, 200 mm

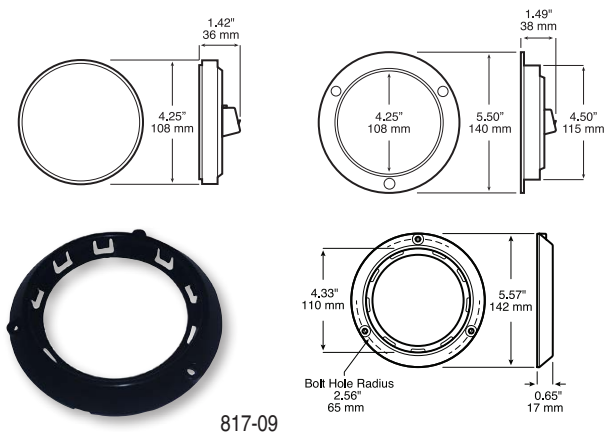

817-09

820S/823S LumenX® LED 165mm/6.5" Oval Auxiliary Oval Strobing Lights



- Meets SAE J595 Class 1
- Strobing light functions as auxiliary strobe or warning light.
- Ideal for emergency, construction and refuse vehicles.
- New white diodes behind white or coloured lenses.
- Advanced optics fully illuminate lens.
- AMP-compatible connector integrated into housing.
- Regulated design provides voltage protection and consistent light output.
- 823-10 has flange integrated into the housing.
- Grommet mount version may be surface mounted using 820-09 bracket.
- Compatible with 12V & 24V electrical systems.

Order Code	Description
820SA-10	amber, grommet mount
823SA-10	amber, flange mount
820SR-10	red, grommet mount
823SR-10	red, flange mount
820SW-10	white, grommet mount
823SW-10	white, flange mount
421-18	rubber mounting grommet — use with 820
820-09	oval surface mount bracket
B817-49	molded plug, 3-wire, 200 mm

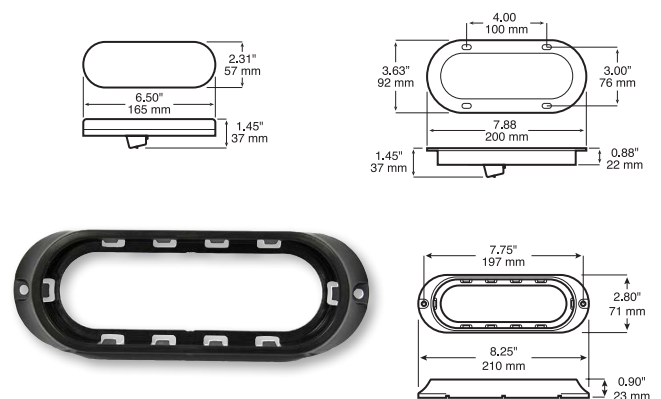

820-09

MULTI-FUNCTION LED LIGHTS FUNCTION AS SYNCHRONIZED STROBES AND DIRECTION INDICATORS!

Each lamp has electronic strobe and turn signal functions built-in, with no external strobe controller. Activating turn signal automatically overrides strobe function. Two power wires allow strobes to be activated with cab switch and automatically when shifted into reverse.

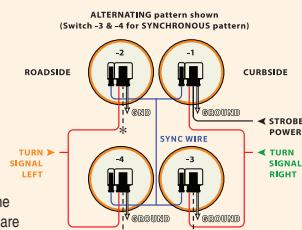
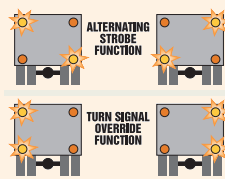
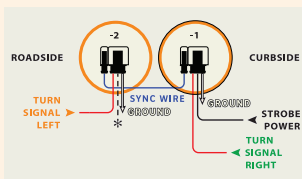

* Centre terminal provides power to -1 lamp only; the sync wire provides power to other lamps in the system. Two-wire AMP plugs are recommended for -2, -3, and -4 lamps. If three-wire AMP plug are used with these lamps, all unused wires must be properly sealed against moisture / corrosion.

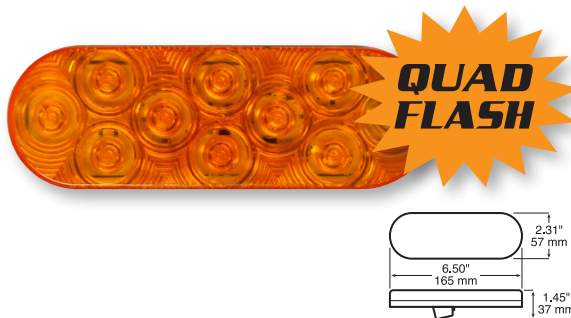

860SA LumenX® LED 100mm/4" Round Strobe & Rear Turn Signal w/Sync



- 2- or 4-lamp system functions as strobes and as DOT rear turn signals.
- Activating turn signal automatically overrides strobe function.
- No external strobe controller needed. (Requires standard vehicle flasher.)
- Compatible with 12V & 24V electrical systems.
- Meets SAE J595 Class 2 specifications rotated in any orientation.
- Requires 426-18 rubber mounting grommet, B817-49 3-wire plug, & 880-49 single wire plug.



Order Code	Description
860SA-1	amber, curbside high
860SA-2	amber, roadside high
860SA-3	amber, curbside low
860SA-4	amber, roadside low
426-18	rubber mounting grommet
B817-49	molded plug, 3-wire, 200 mm
B880-49	plug, sync wire, stripped lead

867SA LumenX® LED 165mm/6.5" Oval Strobe & Rear Turn Signal w/Sync



- 2- or 4-lamp system functions as strobes and as DOT rear turn signals.
- Activating turn signal automatically overrides strobe function.
- No external strobe controller needed. (Requires standard vehicle flasher.)
- Compatible with 12V & 24V electrical systems.
- Meets SAE J595 Class 2 specifications rotated in any orientation.
- Requires 421-18 rubber mounting grommet, B817-49 3-wire plug, & 880-49 single wire plug.



Order Code	Description
867SA-1	amber, curbside high
867SA-2	amber, roadside high
867SA-3	amber, curbside low
867SA-4	amber, roadside low
421-18	rubber mounting grommet
B817-49	molded plug, 3-wire, 200 mm
B880-49	plug, sync wire, stripped lead



Shown in 150-095 surface mount bracket. Bracket or grommet required for mounting, available separately.

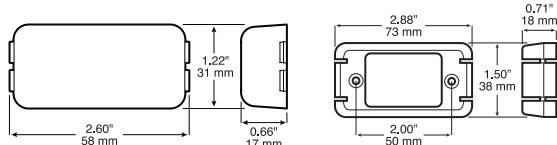

150-095

253S LED Ultra-Mini Strobing Lights w/Sync



- Meets SAE J595 Class 1
- 60 triple-flashes per minute.
- "Sync wire" lets 2 strobes to sync without external strobe controller.
- Compatible with 12V & 24V electrical systems.
- Ultra-compact size allows installation on nearly any vertical surface.

Order Code	Description
253SA-1	amber, type 1
253SA-2	amber, type 2
150-095	mounting bracket

CUSTOMER VEHICLES





LED STROBING LIGHTS

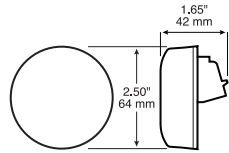

1197SA Single Diode LumenX® LED 64mm/2.5" Oval Round Auxiliary Strobing Light



- Round, 64mm diameter auxiliary strobe or warning light.
- Compatible with 12V electrical systems.
- Integral receptacle accepts industry-standard AMP plug.
- Sealed lens and housing meets IP67 ingress protection level.
- Rubber mounting grommet fits material up to 6 mm.

Order Code	Description
1197SA	amber
143-18	rubber mounting grommet
B192-492	AMP plug w/ .180 bullets



4153SA
Surface Mount

PROGRAMMABLE!



4154SA
Bracket Mount

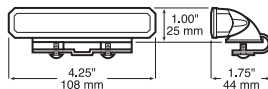

4154SA

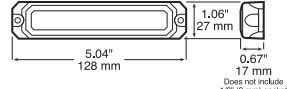

4153SA
Does not include 1/8" (3 mm) gasket

4153SA/4154SA LED Programmable Compact Strobe



- **Meets SAE J595 Class 1**
- Compatible with 12V & 24V electrical systems.
- 19 programmable flash patterns
- 4153SA features screw-on surface mounting. Includes foam base gasket.
- 4154SA comes with adjustable, clamp-on/adhesive mounting bracket.
- All mounting hardware included.

Order Code	Description
4153SA	amber, surface mount
4154SA	amber, bracket mount

PROGRAMMABLE!

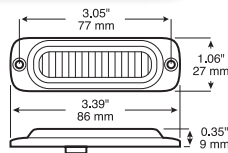

4155SA LED Programmable Low-Profile Surface-Mount Strobe



- **Meets SAE J595 Class 1**
- Low-profile LED amber warning strobe mounts on 3-inch centres.
- 12 programmable flash patterns.
- Compatible with 12V & 24V electrical systems.
- Aluminium base for heat dissipation.
- Multiple units can synchronize for simultaneous or alternating flash.

Order Code	Description
4155SA	surface mount

PROGRAMMABLE!

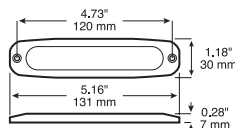

4156SA LED Programmable Surface-Mount Strobe Pad

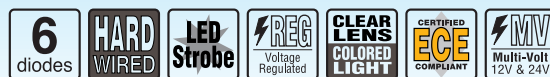

- **Meets SAE J595 Class 1 & ECE Reg 10**
- Low-profile LED amber warning strobe with pad mount.
- Mounting screws and high-strength self-adhesive backing included.
- 23 programmable flash patterns.
- Compatible with 12V & 24V electrical systems.
- Aluminium base for heat dissipation.
- Multiple units can synchronize for simultaneous or alternating flash.

Order Code	Description
4156SA	surface mount

LED STROBING LIGHT BARS



Includes three-switch control box.

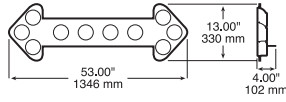

779-1 LED 1.4m/55" Arrow Stick



- Ten bright LED lamps.
- Four flash modes—left arrow, right arrow, centre only, and all flash.
- Alloy housing with black powdercoat finish & horizontal mounting flange.
- Compatible with 12V & 24V electrical systems.
- Includes 25' cable and power control box.

Order Code Description

779-1A	amber
817A-9	replacement lamp

PROGRAMMABLE!



752MA magnetic version includes flash pattern selector switch on plug

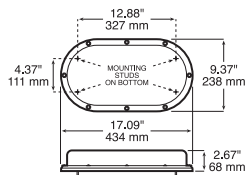

752 LED Low Profile Strobing Mini-Bar



- SAE J845 Class 2A light output
- Compatible with 12V & 24V electrical systems.
- 68mm low profile dome, 434mm wide
- Low 1.4 amp maximum current draw
- Select from three different flash patterns.
- 752MA Magnetic mount version includes 15' straight cord and plug with on/off switch and flash mode selector button.
- 752 permanent mount version includes extra lead wire for flash pattern selection. Momentarily connecting this to the positive (+) lead advances the flash pattern. This can be done prior to installation or wired to a momentary switch (not included).

Order Code Description

752A	permanent mount
752MA	w/ cord, plug & switch

PROGRAMMABLE!



Quick-disconnect cord standard



Magnetic mount kit available

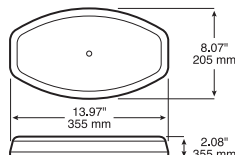

751A LED Programmable Low Profile Strobing Mini Light Bar



- 360° display with 23 user-selectable patterns.
- Output meets SAE J845 Class 1A & ECE R10-04 in flash modes 10,12,13, & 15.
- Compatible with 12V & 24V electrical systems.
- Mounts permanently, or use optional magnetic mount kit that includes dual-switch standard accessory plug and twin suction/magnet mounting cups.
- Integral reverse polarity protection.
- Current draw is 3.8 amps @ 12V, 1.9 amps @ 24V.
- 6 amp fuse recommended.

Order Code Description

751A	amber, permanent mount
751-24K	magnetic mount kit

LED STROBE BEACONS

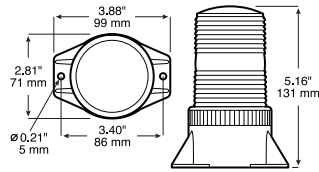

744 LED 360° Micro Strobing Beacon



- High-performance LED strobe with compact dimensions.
- Meets SAE J845, Class 3 specifications.
- 60 quad flashes per minute.
- Six super bright diodes.
- Rugged polycarbonate lens and base.
- Low 0.5 amp maximum current draw.
- 12-80 volt operating range.
- Surface mounts with two screws or bolts.

Order Code	Description
744A	amber

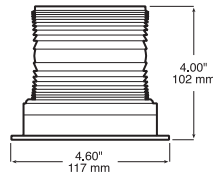

745 LED 360° Strobing Beacon



- Designed for applications where a small, bright warning light is required.
- Meets SAE J845, Class 2A specifications.
- 72 quad flashes per minute.
- Four (4) super bright diodes on sq. extrusion (1 per side).
- Polycarbonate lens and base are sonic welded.
- Low 1.2 amp maximum current draw.
- Compatible with 12V & 24V electrical systems.
- Standard 3-hole mounting.

Order Code	Description
745A	amber

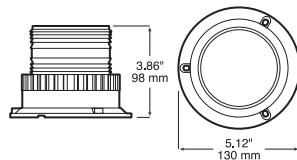

762 LED 360° Strobing Beacon



- 65 "double-quad" flashes per minute.
- Meets SAE J845 Class 3A specifications.
- Ideal for material handling equipment.
- Polycarbonate lens and base.
- 11-110 volt operating range.
- 280mm (11") lead wires.
- Reverse voltage protected.
- Low amp draw: 0.15@12v, .13 @48v.
- Standard 3-hole mounting on 116mm (4.57") bolt circle.

Order Code	Description
762A	amber

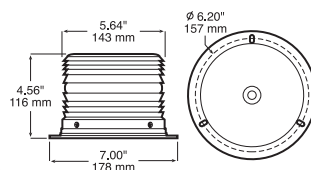

791 LED Low Profile 360° Strobing Beacon



- Four super-high output 2.5W LEDs.
- Meets SAE J845 Class 2A specifications.
- 360° display and 4 User-selectable patterns.
- Compatible with 12V & 24V electrical systems.
- Low 0.8 amp maximum current draw.
- Polycarbonate lens and flange base.

Order Code	Description
791A	flange mount

LED STROBE BEACONS/DOCK LIGHT

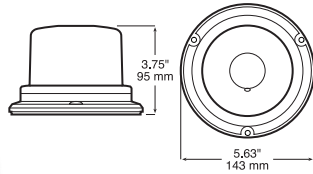

797 LED 360° Strobing Beacon



- Meets SAE J845 Class 2A specifications.
- Ideal for material handling equipment.
- 65 quad flashes per minute.
- Polycarbonate lens and base.
- Compatible with 12V & 24V electrical systems.
- 450mm (18") wire lengths with stripped leads.
- Low amp draw: 0.56@12v, 0.25 @28v.
- Standard 3-hole mounting.

Order Code	Description
797A	amber

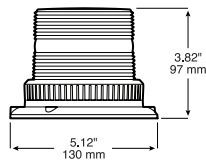

764 LED Micro-Strobe Light

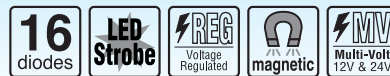

- 16 super bright diodes provide 65 triple flashes per minute.
- Compatible with 12V & 24V electrical systems.
- Meets SAE J845, Class 2A specifications.
- Screw-on fresnel lens design with weather-resistant O-ring seal.
- Mounts on 3-hole, 116mm (4.57") bolt circle, or screws onto central pipe.

Order Code	Description
764A	amber



Twin magnets and push-button switch on rear

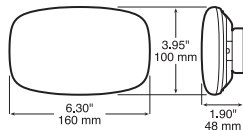

316 LED Battery-Operated Hazard Light w/Magnetic Mount



- 160mm x 100mm battery-powered, portable LED flashing light.
- Magnetic mount attaches securely to back of vehicle or trailer.
- 3-way switch for 180 flashes per minute or steady-on operation.
- Requires four AA batteries (not included).
- Can flash for 36 hours or more on 4 alkaline AA batteries (not included).
- Can be optionally configured as self-standing easel.

Order Code	Description
V316MA	amber
V316MR	red



LEDs light up both RED & GREEN

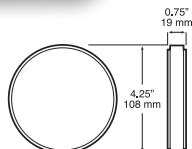

1217G-R LED Traffic Indicator/Loading Dock Light



- Dual-colour diodes provide red and green indicators in a single lens.
- Ideal for loading bays, car parks, barriers and gates.
- Includes 4 meter co-extruded three-core cable.
- 18-28 volt operating range.
- IP67 ingress protection rating.
- Requires 426-18 mounting grommet or 417-1 bracket, available separately.

Order Code	Description
1217G-R	red/green bi-colour
417-1	surface mount bracket
426-18	rubber mounting grommet

LED DOME/UTILITY LIGHTS

**300
to 1,000
Lumens**

**SEALED
Suitable for
exterior use**



**300
to 1,000
Lumens**

**SEALED
Suitable for
exterior use**



358 Great White® LED Dome/Interior Light



- Available in three lengths.
- More effective than recessed dome lights.
- Easy and versatile surface screw mounting to any flat surface.
- Ideal for centre ceiling mount in step vans and service bodies.
- -30°C to 50°C (-22°F to 122°F) operating range.
- No mounting pan, so the R-value of insulated cargo areas is not reduced.
- Compatible with 12V & 24V electrical systems.
- Lead wires are available stripped or terminated with .180 bullets.
- Accessory cove molding facilitates easy wiring for retrofits.

• **IP68 rated – Integral molded seal resists dust, moisture and vapors.**

Order Code	Description	Lumens
358-1	150mm (6") long, stripped leads	300
358-2	300mm (12") long, stripped leads	500
358-3	450mm (18") long, stripped leads	1000
358-4	450mm (18") long, dual-end stripped leads	1000

359 Great White® LED Dome/Interior Light



- Available in three lengths.
- More effective than recessed dome lights.
- Mounts with screws to vertical or horizontal surfaces in inside corners.
- -30°C to 50°C (-22°F to 122°F) operating range.
- No mounting pan, so the R-value of insulated cargo areas is not reduced.
- Compatible with 12V & 24V electrical systems.
- Accessory cove molding facilitates easy wiring for retrofits.

• **IP68 rated – Integral molded seal resists dust, moisture and vapors.**

Order Code	Description	Lumens
359-1	150mm (6"), stripped leads	300
359-2	300mm (12"), stripped leads	500
359-3	450mm (18"), stripped leads	1000
359-4	450mm (18"), dual-end stripped leads	1000
B359-10	snap-in channel clip	

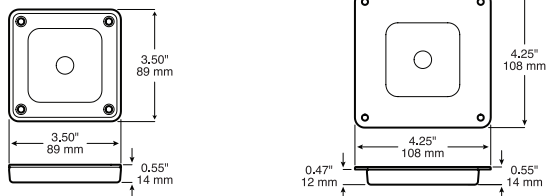

5600 Timer Box Switch

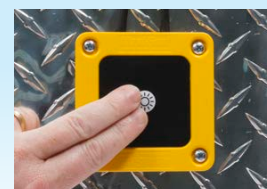

- Pre-programmed for 30 minutes of ON time per button push. May be programmed for up to 2 hours of constant ON time by pressing the button up to 4 times (30 min added per push). Lights flash to indicate that command is received.
- Additional time can be added at any time, up to maximum.
- Pushing and holding button turns off lights at any time.
- "2 minute warning" slowly dims and raises light level prior to shut-off.
- Compatible with 12V & 24V electrical systems.
- IP68 ingress rating. Suitable for installation inside or outside of vehicle.
- Must be used in conjunction with 10 amp fuse for circuit protection.

Order Code	Description
5600	surface
5600-1	recessed

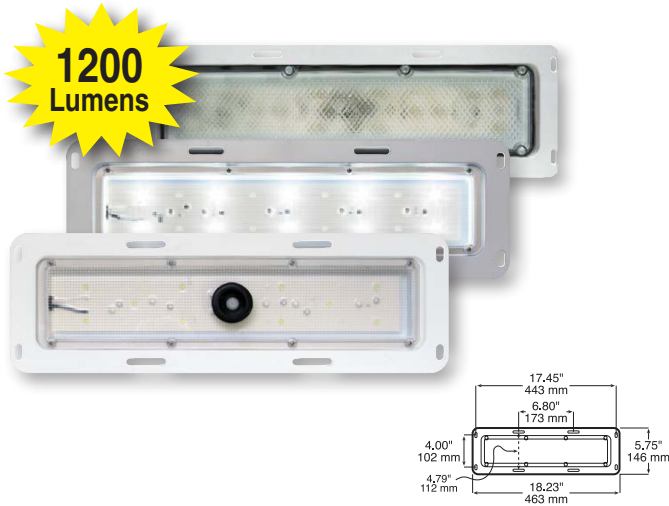

360/365 Great White® LED Rectangular Dome Light



- LED dome and interior light is perfect for dry van trailer applications.
- Mounts flush; thin design extends only 22mm (0.86") below mounting surface.
- Compatible with 12V & 24V electrical systems.
- Fully potted circuit board.
- Available with polycarbonate or aluminium housing.
- Hardwired with dual 200mm long, 14 gauge leads w/ .180 bullet terminals.
- 365 version features motion sensor that automatically activates light and stays illuminated for approx. 5 minutes unless new motion occurs.

Order Code	Description
M360-1	polycarbonate, stripped leads
M360-BT2	aluminium, .180 bullets
M365	motion-sensing, stripped leads

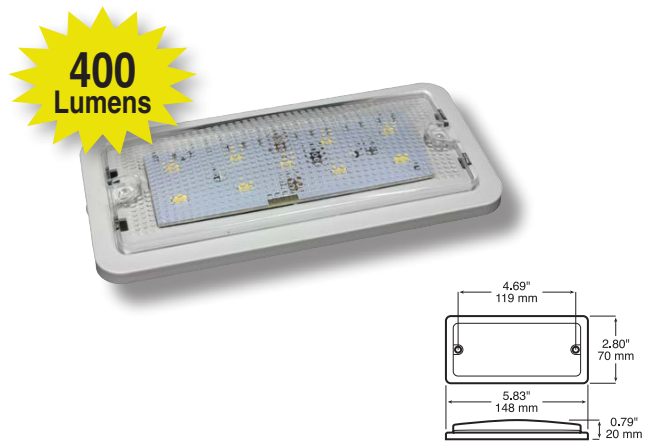

368 Great White® LED Dome/Interior Light



- 5.8" x 2.8" rectangular LED dome and interior light.
- White plastic housing and clear lens.
- Separate lead and ground wires included.
- Available with stripped leads.
- Mounts on 4-11 / 16" (119 mm) centres.
- For interior use only.
- Compatible with 12V & 24V electrical systems.

Order Code	Description
368	white, stripped leads



388C Great White® LED Int/Ext Aisle & Utility Light



- Includes bracket for surface mounting, or can be recess-mounted.
- 388C features Great White® diodes and black bracket.
- 388WB features blue diodes and white bracket; great for marine use!
- Optional chrome accessory bracket available.
- Recessed or surface mount LED strip light.
- Compatible with 12V & 24V electrical systems.
- Low amp draw.
- Perfect for aisle lighting.

Order Code	Description
M388C	white w / black bracket
M388WB	blue w / white bracket
B388-09X	chrome bracket

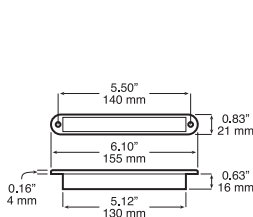

Optional 388-09X chrome bracket



Can be flush-mounted without bracket

50 Lumens



Shown with 423-11 chrome bezel installed, available separately.

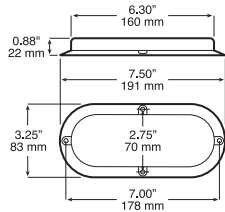

1223W-4 Great White® LED Int/Ext Dome & Utility Light



- Features 10 bright Great White® diodes behind clear lens.
- Sealed lens and housing.
- Compatible with 12V & 24V electrical systems.
- Hardwired design.
- Easy surface mounting.
- Attractive accessory chrome bezel available.

Order Code	Description
1223W-4	white
B423-11	chrome bezel

130 Lumens

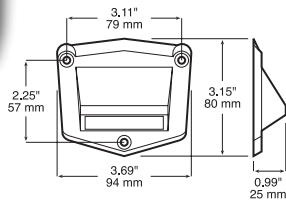

397 LED Step Well Courtesy Light



- Low profile, hardwired design meets ADA requirements for step well lighting.
- Perfect for transit, bus & RV use.
- Compatible with 12V & 24V electrical systems.
- Sealed circuit board with two hardwired leads.
- Includes mounting gasket, 3 mounting screws and 3 matching screw covers.

Order Code	Description
M397C	white light, black housing

500 Lumens

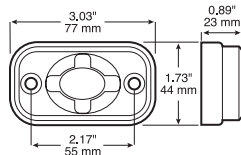

398 LED 3" x 1.75" Rectangular Work Light



- White diodes behind clear lens.
- Cast alloy housing.
- Wide even flood pattern with 500 lumen output.
- Two 20" jacketed lead wires terminated with .180 bullet connectors
- Compatible with 12V & 24V electrical systems.
- -22° F–120° F operating temperature range.
- Includes rubber mounting base.
- IP67/IP69K ingress protection rating.
- Draws 0.39 amps @ 12V, 0.20 amps @ 24V.

Order Code	Description
M398-BT2	white light, black housing



B178-10 Bezel

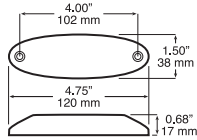

178W Great White® LED Oval Dome & Utility Light



- Can be surface mounted almost anywhere as a courtesy or dome light.
- Compatible with 12V & 24V electrical systems.
- Hardwired with separate lead and ground wires.
- Mounts on 102mm centres.
- Optional chrome bezel available.

Order Code Description

M178W-MV	clear
B178-10	chrome bezel

**230
Lumens**

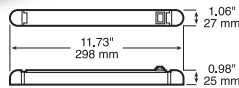

369 Great White® LED Rotating Interior Light w/Switch



- Accessory light swivels to adjust illumination.
- Equipped with on-off switch.
- White plastic housing & clear lens.
- Hardwired with separate lead and ground wire.
- For interior use only.
- Compatible with 12V and 24V electrical systems.

Order Code Description

V369S	white
-------	-------

**450
Lumens**

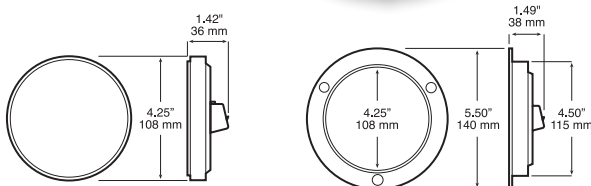

817-9 LumenX® LED 100mm/4" Round Work Light



- New white diodes behind clear lens.
- Flood pattern for broad illumination.
- Also suitable for dome or utility light.
- Regulated design provides voltage protection and consistent light output.
- 817W features skirted weld joint for added protection.
- Compatible with 12V and 24V electrical systems.
- 817/818 series draws 0.29A @ 12V, 0.22A @ 24V.
- 817W-9 requires rubber mounting grommet or surface-mount bracket.
- 818W-9 has integral mounting flange.

Order Code Description

817W-9	grommet mount
818W-9	flange mount
417-1	surface mount bracket
426-18	rubber mounting grommet — use with 817
B817-49	molded plug, 3-wire, 200 mm



500 Lumens

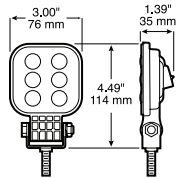
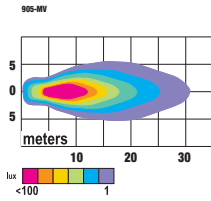

905 LED

75mm x 75mm / 3" x 3" Pedestal-Mount Work Light



- Low profile, light-weight design is just 35mm thin.
- Optimized work light beam pattern for even general area illumination.
- Reinforced mounting insert and stainless steel mounting hardware.
- Rugged textured polymer housing and lens.
- High vibration resistance and low amp draw.
- Stainless steel mounting hardware.
- Compatible with 12V & 24V electrical systems.
- IP67 ingress rating
- Draws 0.40 amps @12V, 0.21 amps @24V.
- Two hardwired, stripped leads.

Order Code	Description
------------	-------------

905-MV	stripped leads
--------	----------------



1000 Lumens

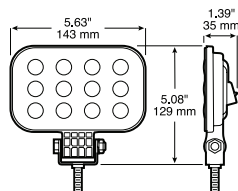
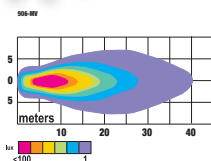

906 LED

75mm x 125mm / 3" x 5" Pedestal-Mount Work Light



- Low profile, light-weight design is just 35mm thin.
- Optimized work light beam pattern for even general area illumination.
- Reinforced mounting insert and stainless steel mounting hardware.
- Rugged textured polymer housing and lens.
- High vibration resistance and low amp draw.
- Stainless steel mounting hardware.
- Compatible with 12V & 24V electrical systems.
- IP67 ingress rating
- Draws 0.81 amps @12V, 0.41 amps @24V.
- Two hardwired, stripped leads.

Order Code	Description
------------	-------------

906-MV	stripped leads
--------	----------------

900 Lumens



Cast aluminium housing

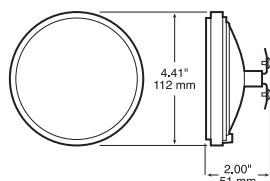
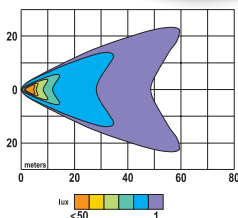

711 Great White® LED

PAR 36 LED Replacement Beam



- High-output Great White® diodes for a bright general illumination.
- Fits all standard Par 36 incandescent sealed beam applications.
- Impact-resistant polycarbonate lens.
- Cast aluminium body with matte black finish.
- Compatible with 12V & 24V electrical systems.
- See pedestal-mount 908S version on next page.

Order Code	Description
------------	-------------

V711	round
------	-------

2000 Lumens

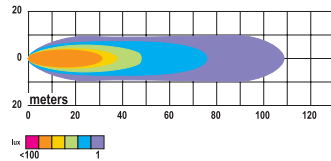
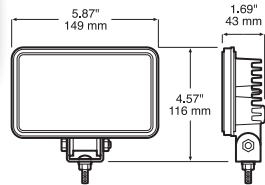

750 Lumens

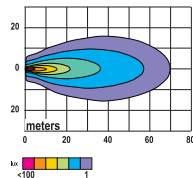
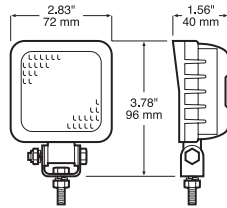

900 Lumens

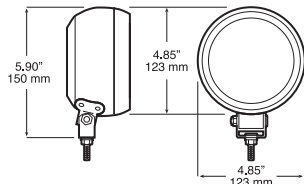
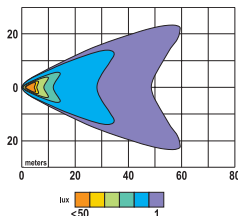

903 Great White® LED

75mm x 125mm / 3" x 5" Rectangular Work Light



COMMERCIAL GRADE

- Bright, even flood pattern.
- Extra-rugged, commercial-grade construction.
- Impact-resistant polycarbonate lens.
- Die-cast aluminium body with black finish.
- Heat dissipating fins for durability and longevity.
- High vibration resistance and low amp draw.
- Compatible with 12V & 24V electrical systems.
- Reverse voltage protection.
- Draws 2.65A @ 12V, 1.0A @ 24V.
- 2-Conductor black PVC jacketed harness.
- IP67 rated.
- Stainless steel mounting hardware.
- Certified to ECE Reg 10.

Order Code	Description
------------	-------------

903-MV	rectangular, stripped leads
--------	-----------------------------

904 Great White® LED

75mm x 75mm / 3" x 3" Square Work Light



- Bright, even flood pattern.
- Impact-resistant polycarbonate lens.
- Die-cast aluminium body with matte black finish.
- Heat dissipating fins for durability and longevity.
- High vibration resistance and low amp draw.
- Compatible with 12V & 24V electrical systems.
- Reverse voltage protection.
- Draws 0.98A @ 12V, 0.43A @ 24V.
- 2-Conductor black PVC jacketed harness 20 GA GPT.
- Operating temperature: -40° – +65° C.
- Colour temperature: 6300k.
- Certified to ECE Reg 10.
- IP67 rated.
- Stainless steel mounting hardware.

Order Code	Description
------------	-------------

V904-MV	square
---------	--------

908S Great White® LED

Rubber Housing Work Light



Weatherproof, push-on/push-off switch

- 711 LED sealed beam installed in rubber housing.
- High-output Great White® diodes for a bright general illumination.
- Convenient on-off switch located on rear of housing.
- Two lead wires terminated with .180 bullets.
- Compatible with 12V & 24V electrical systems.
- Draws 1.45A @ 12V, 0.72A @ 24V.

Order Code	Description
------------	-------------

M908S-MV-BT2	900 lumen, multi-volt, rubber housing with switch
--------------	---

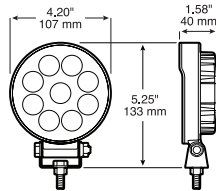
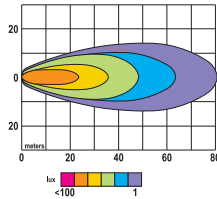

921 Great White® LED Pedestal-Mount Work Light

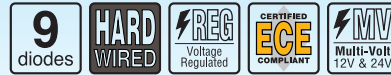

- High-output Great White® diodes for a bright, even, flood pattern.
- Die-cast aluminium body with heat-dissipating fins for durability & longevity.
- High vibration resistance.
- Compatible with 12V & 24V electrical systems.
- Draws 1.2A @ 13.5V, 0.59A @ 28V.
- Operating temperature: -40° – +65° C.
- Comes complete with stainless steel mounting hardware.
- IP67 / IP69K Rated.
- RoHS compliant.
- Certified to ECE Reg 10.

Order Code	Description
V921-MV	stripped leads

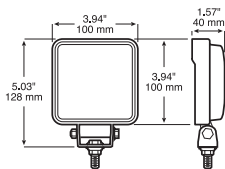
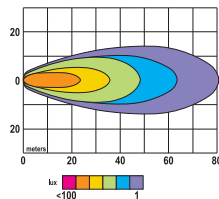

910 Great White® LED Pedestal-Mount Work Light

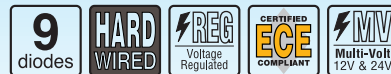

- High-output Great White® diodes for a bright, even, flood pattern.
- Die-cast aluminium body with heat-dissipating fins for durability & longevity.
- High vibration resistance.
- Compatible with 12V & 24V electrical systems.
- Draws 1.2A @ 13.5V, 0.59A @ 28V.
- Operating temperature: -40° – +65° C.
- Comes complete with stainless steel mounting hardware.
- IP67 / IP69K Rated.
- RoHS compliant.
- Certified to ECE Reg 10.

Order Code	Description
V910-MV	stripped leads

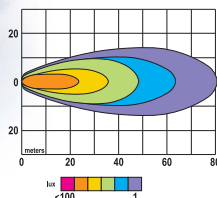
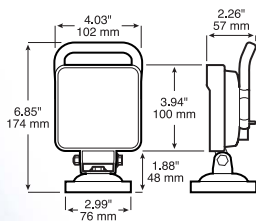

910M Great White® LED Magnetic-Mount Work Light with Switch

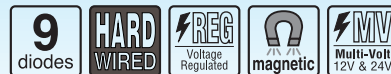

- Same great features as 910-MV, but in a magnetic, temporary-mount light.
- Strong magnetic-mount base has no-scratch, rubberized face.
- Rear-mounted on / off toggle switch.
- 8-foot, quick-disconnect coil cord with 12V accessory plug.
- Handy grab handle makes carrying and repositioning light easy.



Order Code	Description
V910M-MV	stripped leads

900 Lumens

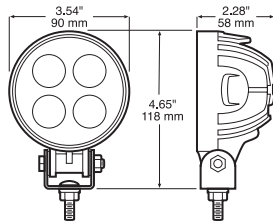
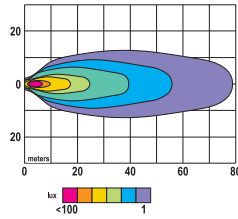

912 Great White® LED 75mm/3" Round Work Light

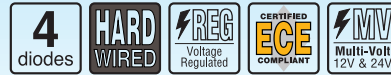

- High-output Great White® diodes for a bright, even flood pattern.
- Impact-resistant polycarbonate lens.
- Cast alloy body and Impact-resistant polycarbonate lens are IP67 rated.
- High vibration resistance and low amp draw.
- Compatible with 12V & 24V electrical systems.
- Reverse voltage protection.
- Draws 1.11A @ 12V, 0.61A @ 24V.
- 2-Conductor black PVC jacketed harness 18 GA GPT.
- Operating temperature: -40° – +65° C.
- Colour temperature: 6500k.
- Certified to ECE Reg 10.
- Stainless steel mounting hardware.

Order Code	Description
V912-MV	round

1400 Lumens

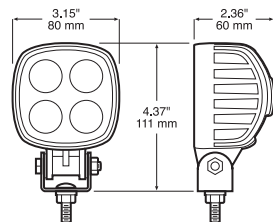
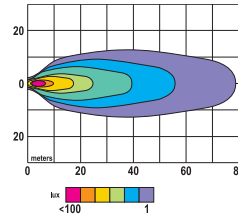

913 Great White® LED 75mm x 75mm/3" x 3" Compact Work Light



- High-output Great White® diodes for a bright, even flood pattern..
- Cast alloy body and Impact-resistant polycarbonate lens are IP67 rated.
- Heat-dissipating fins for durability and longevity.
- High vibration resistance and low amp draw.
- Compatible with 12V & 24V electrical systems.
- Reverse voltage protection.
- Draws 1.3A @ 12V, 0.65A @ 24V.
- 2-Conductor black PVC jacketed harness 18 GA GPT.
- Operating temperature: -40° – +65° C.
- Colour temperature: 6500k.
- Certified to ECE Reg 10.
- Stainless steel mounting hardware.

Order Code	Description
V913-MV	square

3200 Lumens

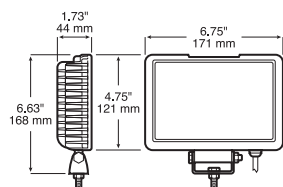
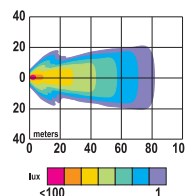

915 Great White® LED 120mm x 170mm/5" x 7" Rectangular Work Light



- High-output Great White® diodes for a bright, even flood pattern.
- Impact-resistant polycarbonate lens.
- Cast aluminium body with heat-dissipating fins for durability and longevity.
- High vibration resistance and low amp draw.
- Compatible with 12V & 24V electrical systems.
- Reverse voltage protection.
- Draws 3.2A @ 12V, 1.6A @ 24V.
- 2-Conductor black PVC jacketed harness.
- Colour temperature: 6000k.
- CE & EMC Certified.
- IP67 Rated.
- Stainless steel mounting hardware.

Order Code	Description
915-MV	rectangular



1900 Lumens



Head mounts vertically or horizontally

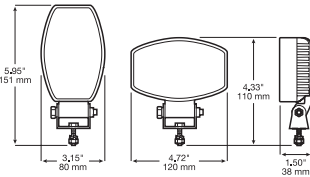
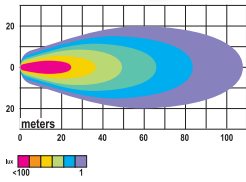

919 Great White® LED Swivel-Head Work Light

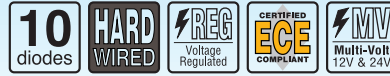

- High-output Great White® diodes for a bright, even, wide spot pattern.
- Die-cast aluminium body with matte black finish.
- Swiveling head can be mounted horizontally or vertically.
- Compatible with 12V & 24V electrical systems.
- Operating temperature: -30° – +50° C.
- Operating current: 1.64A @ 12VDC, 0.83A @ 24VDC.
- Stainless steel mounting hardware.
- RoHS compliant.
- IP67 / IP69K rated.
- Certified to ECE Reg 10.

Order Code	Description
V919-MV	oval

928 Great White® LED 75mm x 75mm / 3" x 3" Square Work Light



- High-output Great White® diodes for a bright, even flood pattern.
- Compatible with 12V & 24V electrical systems.
- Draws 2.15A @ 12V, 1.03A @ 24V.
- Impact-resistant polycarbonate lens.
- Die-cast aluminium body with matte black finish.
- Operating temperature: -30° – +50° C.
- Stainless steel mounting hardware.
- IP67 and IP69K Rated.
- RoHS compliant.
- Certified to ECE Reg 10.

Order Code	Description
928-MV	square



2520 Lumens

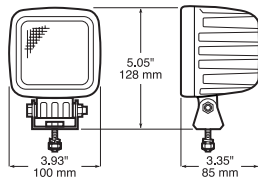

920B-MV Great White® LED Blue Pedestrian Warning Light



- Two 5 watt blue diodes for a bright spot pattern.
- Impact-resistant polycarbonate lens.
- Die-cast aluminium body with matte black finish.
- Heat dissipating fins for durability and longevity.
- High vibration resistance and low amp draw.
- Compatible with 12V, 24V, & 48V DC electrical systems.
- Operating current: 0.6A @ 12.8VDC, 0.3A @ 28VDC.
- PVC jacketed, partially stripped, 450mm lead wires.
- Operating temperature range: -40°F - +149°F (-40°C - +65°C).
- IP67 rated.
- Stainless steel mounting hardware.

Order Code	Description
920B-MV	blue, oval



Perfect for FORK LIFTS

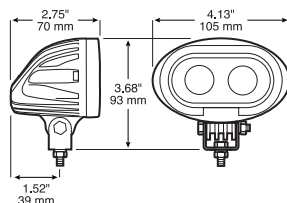
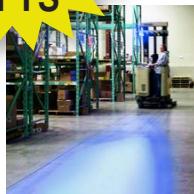

SINGLE ROW

3000 Lumens

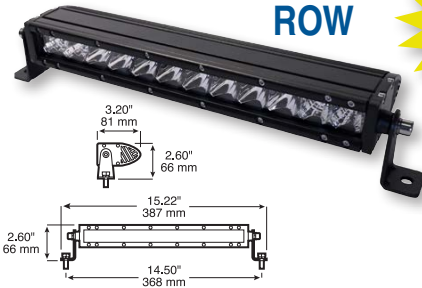

12
diodes

HARD WIRED

MV
Multi-Volt
12V & 24V

932 Nightwatcher® LED 360mm/14" Rectangular Light Bar

- Extruded alloy housing with powder-coated finish and polycarbonate lens.
- Combination 60° flood/30° spot beam. 6000–6500K colour temp.
- 9–32 VDC range. 3.54A @ 13.5V, 1.77A @ 28V.
- Incl. mounting hardware & 18" sheathed leads.
- Deutsch-style connector with pigtail included.
- IP68 ingress rating.



Order Code Description

V932-MV single row flood/spot

DOUBLE ROW

3600 Lumens

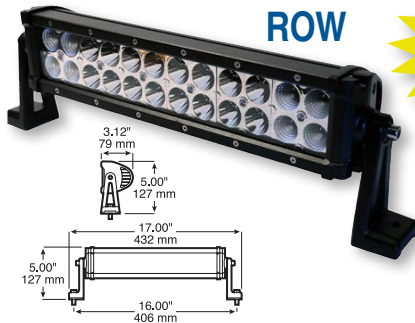

24
diodes

HARD WIRED

MV
Multi-Volt
12V & 24V

933 Nightwatcher® LED 360mm/14" Rectangular Light Bar

- Extruded alloy housing with powder-coated finish and polycarbonate lens.
- Combination 60° flood/30° spot beam. 6000–6500K colour temp.
- 10–30 VDC range. 3.36A @ 13.5V, 1.53A @ 28V.
- Incl. mounting hardware & 18" sheathed leads.
- Deutsch-style connector with pigtail included.
- IP68 ingress rating.



Order Code Description

V933-MV double row flood/spot

DOUBLE ROW

6000 Lumens

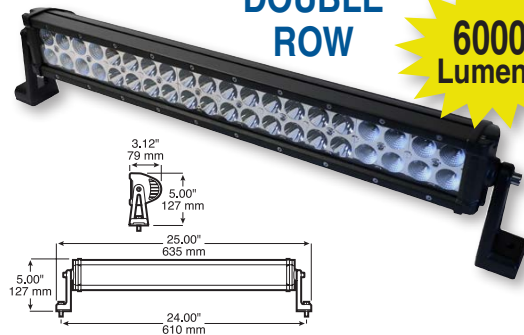

40
diodes

HARD WIRED

MV
Multi-Volt
12V & 24V

934 Nightwatcher® LED 560mm/22" Rectangular Light Bar

- Extruded alloy housing with powder-coated finish and polycarbonate lens.
- Combination 60° flood/30° spot beam. 6000–6500K colour temp.
- 10–30 VDC range. 7.98A @ 13.5V, 3.14A @ 28V.
- Incl. mounting hardware & 18" sheathed leads.
- Deutsch-style connector with pigtail included.
- IP67 ingress rating.



Order Code Description

V934-MV double row flood/spot

SINGLE ROW

13,300 Lumens

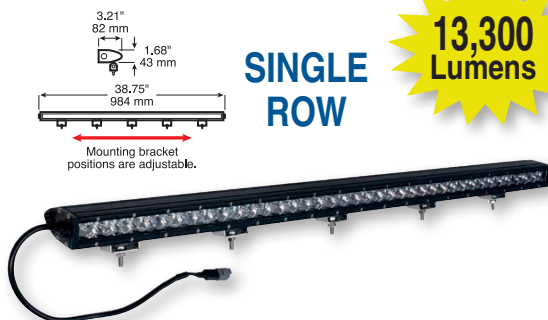

38
diodes

HARD WIRED

MV
Multi-Volt
12V & 24V

931 Nightwatcher® LED 1 Metre/39" Rectangular Light Bar

- Extruded alloy housing with powder-coated finish and polycarbonate lens.
- 60° flood beam pattern with 6000K–6500K daylight colour temperature.
- Infinitely adjustable mounting pedestal locations.
- 10–30 volt operating range. Draws 11.6A @ 13.5V, 5.2A @ 28V.
- IP66 ingress protection rating.
- Includes mounting hardware & 18" sheathed leads.

Order Code Description

931-MV single row flood

DOUBLE ROW

19,300 Lumens

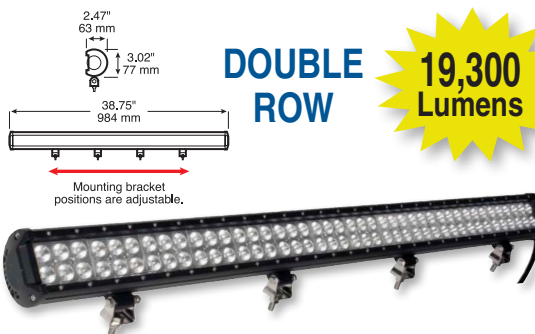

84
diodes

HARD WIRED

MV
Multi-Volt
12V & 24V

930 Nightwatcher® LED 1 Metre/39" Rectangular Light Bar

- Extruded alloy housing with powder-coated finish and polycarbonate lens.
- Flood beam pattern with 6000K–6500K daylight colour temperature.
- Infinitely adjustable mounting pedestal locations.
- 10–30 volt operating range. Draws 15A @ 13.5V, 6.6A @ 28V.
- IP66 ingress protection rating.
- Includes 18" sheathed leads, 20 amp ATC fuse, hardware, & butt connectors.

Order Code Description

930-MV double row flood

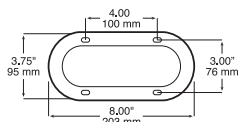
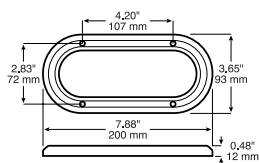
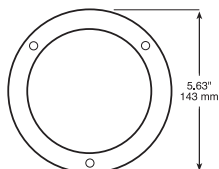
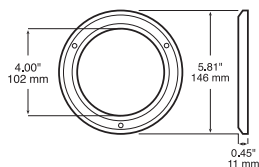
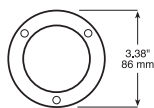
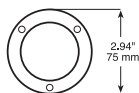
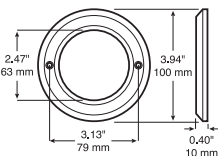
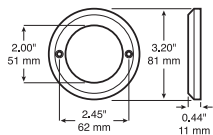

7005/7007

Decorative Bezels for Grommet mount Lights

- Chrome-plated plastic enhances appearance.
- Attaches to rubber mounting grommet with two tapered screws.
- Fits grommet-mounted 51mm (2") & 64mm (2 1/2") round vehicle lights.
- Includes stainless steel mounting screws.

Order No.	Description
V7005	51mm round bezel
V7007	64mm round bezel

7005S/7007S

Theft Deterrent Rings for Flange Mount Lights

- 7005S fits 165 Series 51mm (2") round flange-mounted lights.
- 7007S fits 163 Series 64mm (2 1/2") round flange-mounted lights.
- Designed to work with flange for added theft protection.
- Attractive stainless-steel finish resists corrosion.
- Not compatible with "S" suffix surface-mount lights.

Order Code	Description
V7005S	51mm dia. flange mount lights
V7007S	64mm dia. flange mount lights

7009

100mm/4" Round Decorative Bezel

- **Fits grommet-mounted 100mm round vehicle lights.**
- Chrome-plated plastic enhances appearance.
- Attaches to rubber mounting grommet with three tapered screws.
- Includes stainless steel mounting screws.

Order Code	Description
V7009	100mm round bezel

7009S

100mm/4" Round Theft Deterrent Rings

- **Fits 100mm round flange-mounted lights.**
- Designed for added theft protection of flange-mount lights.
- Attractive stainless-steel finish resists corrosion.

Order Code	Description
V7009S	100mm round

7011

165mm/6.5" Oval Decorative Bezels

- **Fits grommet-mounted 165mm oval vehicle lights.**
- Chrome-plated plastic enhances appearance.
- Attaches to rubber mounting grommet with four tapered screws.
- Includes stainless steel mounting screws.

Order Code	Description
V7011	oval bezel

7011S

165mm/6.5" Oval Theft Deterrent Rings

- **Fits 165mm oval flange-mounted lights.**
- Designed for added theft protection of flange-mount lights.
- Attractive stainless-steel finish resists corrosion.

Order Code	Description
V7011S	oval

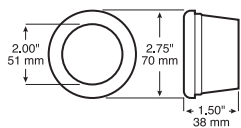

146 51mm/2" Rubber mounting grommet

- Allows 51mm (2") diameter sealed units to be flush mounted.
- Fits 59mm (2 5/16") mounting hole in panels up to 6.3mm (1/4") thick.

Order Code	Description
------------	-------------

146-182	closed back
---------	-------------

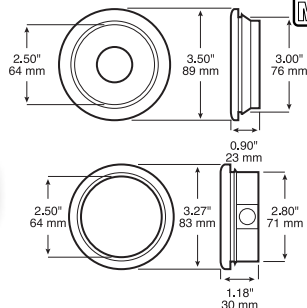

142/143 64mm/2.5" Rubber mounting grommets

- Fit 64mm (2 1/2") diameter sealed units.
- 142-18 allows rubber mounting grommet-mount lights to be flush mounted.
- 142-18 fits 76mm (3") mounting hole.
- 143-18 fits 71mm (2.78") mounting hole.

Order No.	Description
-----------	-------------

142-18	flush mount
--------	-------------

143-18	open back
--------	-----------

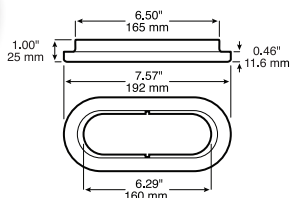

421 165mm/6.5" Oval Rubber Grommet

- Black PVC rubber mounting grommet flush mounts oval style lamps.
- For use with PM standard 165mm oval rubber mounting grommet-mount oval lights, as well as similar competitors' lights.
- Provides additional shock absorption to extend lamp life.

Order Code	Description
------------	-------------

421-18	black oval
--------	------------

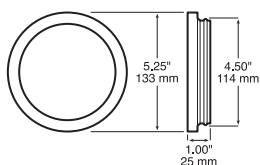

426 100mm/4" Oval Round Rubber Grommet

- Black PVC rubber mounting grommet flush mounts 100mm diameter round lamps in 114mm (4 1/2") hole.
- For use with 100mm round stop/turn/tail and accessory lights.
- Provides additional shock absorption to extend lamp life.

Order Code	Description
------------	-------------

426-18	black
--------	-------

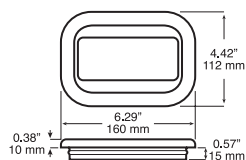

850 Rectangular Rubber Grommet

- Black rubber grommet fits 850 series lights.
- UV-resistant PVC stays flexible and prevents cracking for extended service life.

Order Code	Description
------------	-------------

B850-18	black
---------	-------

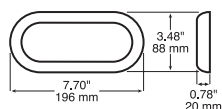

423 Decorative Chrome Bezel

- Fits surface-mount oval 1223 Series.
- Bright chrome decorative bezel snaps on without tools.
- Covers black flange and mounting screws.

Order Code	Description
------------	-------------

B423-11	chrome oval
---------	-------------

417-1



**CONVENIENT
TWO-PIECE DESIGN**



417-2



417-3



417

Surface Mount Brackets

- Available in 1, 2, and 3 light versions.
- Compatible with all current Peterson rubber mounting grommet-mount 100mm round LED lights.
- Lights snap in easily, with no rubber mounting grommet required.
- Brackets feature separate backing plate with 25mm (1") cable exit hole and integral mounting studs, plus attachment screws.

Order Code	Description
417-1	single light
417-2	double light
417-3	triple light

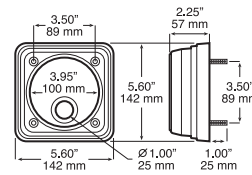

417-1

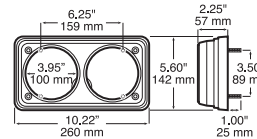

417-2

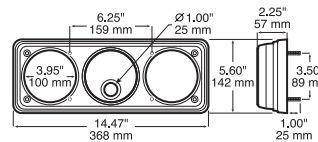

417-3

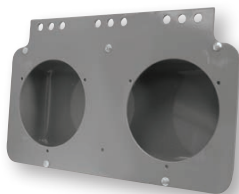

426-10

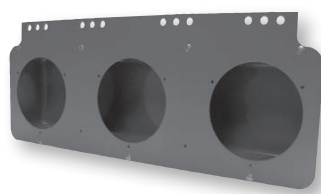
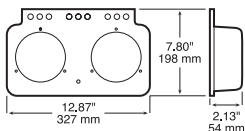

426-11

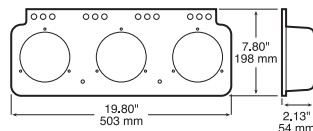

426

2 or 3 Light Metal Module

- For use with PM 100mm round lights, as well as similar competitors' lights.
- Designed as replacement for many OE trailer light modules.
- Fits all grommet-mounted and most flange-mounted 100mm dia. lamps.
- 426-10 has openings for two lights, 426-11 has three.

Order Code	Description
426-10	2 light
426-11	3 light



Shown with lights installed, sold separately

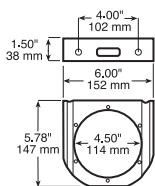

426

Round Steel Right-Angle Mounting Bracket

- Black, powder-coated steel.
- Fits all grommet-mounted and most flange-mounted 100mm dia. lamps.
- Pre-drilled mounting holes for mounting flanged lights.
- May be bolted or welded in place.
- Grommet-mount lights require 426-18 rubber grommet for installation.

Order Code	Description
426-09	black steel

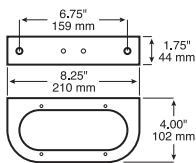

421

Oval Steel Right-Angle Mounting Bracket

- Black, powder-coated steel.
- Fits standard 165mm oval mounting grommet and flange-mount lights
- Pre-drilled mounting holes for mounting flanged lights.
- May be bolted or welded in place.
- May be used horizontally or vertically.
- Grommet-mount lights require 421-18 rubber grommet for installation.

Order Code	Description
421-09	black oval

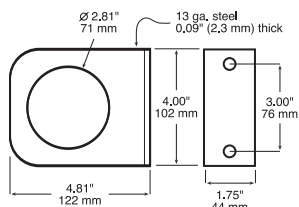

143-092

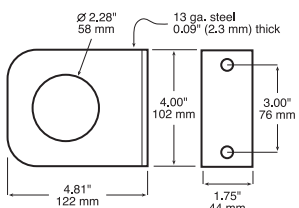

146-092

143/146

Round Steel Right-Angle Mounting Brackets

- Brackets mount either 2-inch diameter or 2.5-inch diameter rubber mounting grommet-mount lights perpendicular to any flat surface.
- Heavy-gauge steel construction.
- Rugged black power coated finish.

Order Code	Description
143-092	accepts 64mm lights
146-092	accepts 51mm lights



817-09

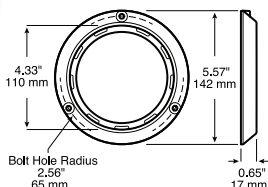

817-10

817

100mm/4" Round Surface Mount Bracket

- Allows grommet-style 100mm round lights to be surface mounted.
- Constructed of UV and corrosion resistant plastic
- Available in black or chrome finish.
- Compatible with LumenX "-7" and "-9" series 100mm round lights.

Order No.	Description
817-09	black
817-10	chrome



820-09

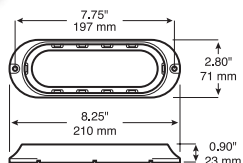

820-10

Light shown installed available separately.

820

165mm/6.5" Oval Surface Mount Bracket

- Allows grommet-style oval lights to be surface mounted.
- Constructed of UV and corrosion resistant plastic
- Available in black or chrome finish.
- Compatible with LumenX "-7" and "-10" series oval lights.

Order Code	Description
820-09	black
820-10	chrome

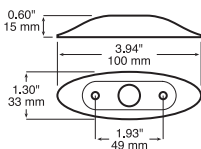
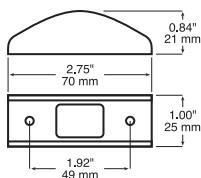
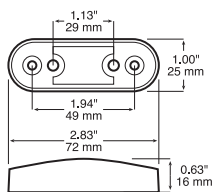

168-18

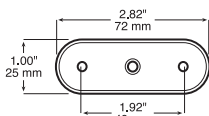

168-181

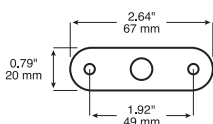

168-182

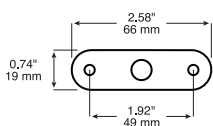

168 Surface Mount Bracket

- Enhances appearance of 1268 and 2268 series lights.
- Attractive black finish.
- May also be used to adapt mounting centres from 49mm to 29mm.

Order Code	Description
B168-09	black

168-092 Aluminium Brush Guard

- Enhances durability and longevity of 1268 and 2268 series lights.
- Rugged, stamped aluminium construction for extra protection.
- Black powdercoat version available.
- Optional mounting gasket use B168-181.

Order Code	Description
B168-092	aluminium finish
B168-092B	black powdercoat
B168-181	thinline mounting gasket

168-10 Decorative Chrome Bezel

- Enhances appearance of 168 and 1268 series lights.
- Attractive chrome finish.
- ABS construction.
- Optional mounting gasket use B168-182.

Order Code	Description
B168-10	chrome
B168-182	thinline mounting gasket

168 Mounting Gasket

- Fits 1268 series LED lights.
- Flexible rubber protects mounting surfaces.
- Use 168-18 when mounting 1268 light without brush guard or bezel.
- 168-181 for use with 168-092 aluminium brush guard.
- 168-182 for use with 168-10 chrome bezel.
- Use 2268-18 when mounting 2268A-R without bracket

Order Code	Description
B168-18	black rubber
B168-181	mounting gasket for 168-092
B168-182	mounting gasket for 168-10
B2268-18	mounting gasket for 2268A-R-MV



2268-18

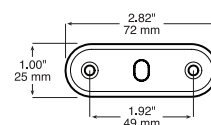



162-49



162-49 LED Marker Lamp Plug

- Right-angle TRIPLE SEAL, two-wire plug for use with 162 and 163 series LED clearance / marker lights.
- 200mm (8") stripped hot wire; ground wire provided with #10 ring terminal and heat shrink tubing for additional corrosion protection.
- Use with 163, 165, & 166 series lights.

Order No.	Description
B162-49	stripped / ring for use with 163, 165, & 166 series



192-492



192-492 / 493 LED 2-Wire Plug

- 2-wire hard-shell, weatherproof plug.
- For use with 1197SA auxiliary strobing light.
- Terminated with two .180 bullet terminals.
- Grease is not recommended on AMP-style connections.

Order No.	Description
B192-492	hardshell, .180 bullets

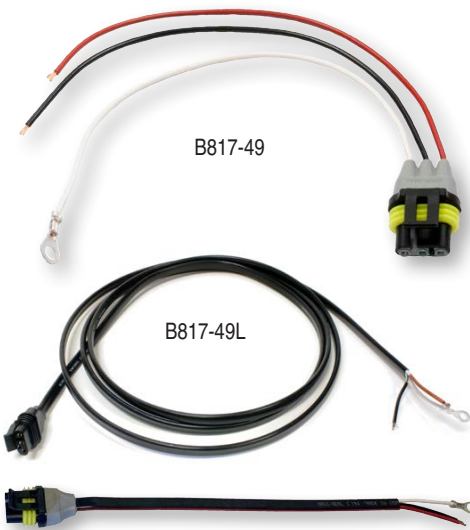

B817-49

B817-49L

B817-49S



B817-49 Molded LED 3-Wire Plugs

- 3-wire weatherproof plug with molded plug housing for use with AMP-style LED lights.
- Stripped hot wires; ground wire provided w / #10 ring terminal and heat-shrink tubing for additional corrosion protection.
- B817-49L & B817-49S have jacketed flat cable.
- Grease is not recommended on AMP-style connections.

Order Code	Description
B817-49	stripped lead / ring terminal
B817-49L	98.5" overall, jacketed leads
B817-49S	12" overall, jacketed leads



880-49



880-49 AMP-Compatible Plug

- Connects back-up light function on 880 / 881 / 882 / 883 series lights.
- Connects sync wire on 860SA, 861SA, 866SA and 867SA series multi-function LED strobes.
- Grease is not recommended on AMP-style connections.

Order Code	Description
B880-49	stripped wire

WHAT MAKES SPITFIRE® WIDE ANGLE REFLECTORS SO SUPERIOR?

- 50% wider reflectivity angle than conventional reflectors
- 47,000 microprisms per square inch for superior candle power
- Ultra-thin design—just .012" thick
- Hermetically sealed and unbreakable
- Industrial strength adhesive
- Easy to install on flat or curved surfaces

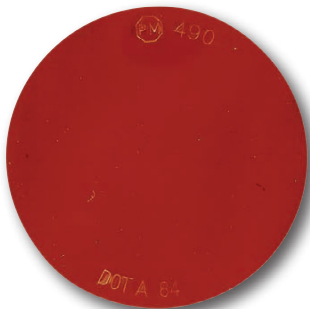
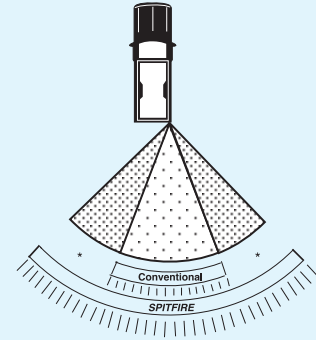

490 Spitfire® Pressure-Sensitive Round Reflector



- Round reflector measures 2.88" (73 mm) diameter.
- High-strength, pressure-sensitive backing adhesive.
- Meets FMVSS 108 requirements.
- Sold in package of two reflectors.

Order Code	Description
------------	-------------

B490R	red
-------	-----



491 Spitfire® Pressure-Sensitive Rectangular Reflector



- Rectangular reflector measures 4.31" x 1.69" (110 mm x 43 mm).
- High-strength, pressure-sensitive backing adhesive.
- Meets FMVSS 108 requirements.
- Sold in package of two reflectors.

Order Code	Description
------------	-------------

B491R	red
-------	-----

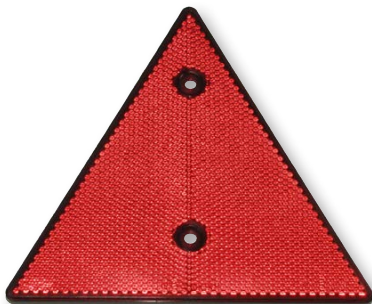

1274 ECE-Compliant Triangular Rear Reflector



- Meets applicable ECE requirements for trailer use.
- High-strength foam adhesive backing plus two screw holes.
- Sold in package of two reflectors.

Order Code	Description
------------	-------------

B1274R	triangular reflector
--------	----------------------

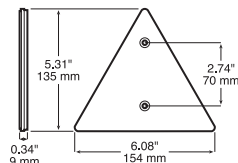

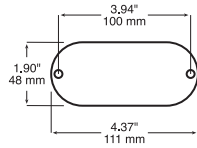
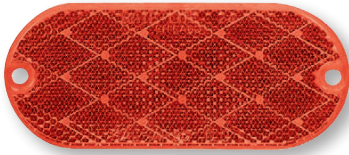

479/480 Oblong Reflector

- Hermetically sealed acrylic lens.
- Mounts on 3 15/16" centres.
- Meets FMVSS 108 standards.
- 480R includes high-strength, pressure-sensitive adhesive backing.
- Sold in package of two reflectors.

Order Code	Description
B479R	red, screw mount
B480R	red, screw and/or adhesive mount

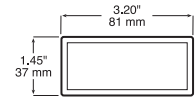

1284 ECE-Compliant Reflector

- Meets applicable ECE requirements.
- Available in amber, red, and white.
- Sold in package of two reflectors.

Order Code	Description
B1284A	amber
B1284R	red
B1284W	white

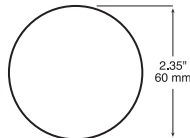

481 Round Quick-Mount Reflector

- 2 3/8" acrylic reflector.
- Permanent adhesive backing.
- Ideal for applications where space is minimal.
- Meets FMVSS 108 standards.
- Sold in package of two reflectors.

Order Code	Description
B481R	red

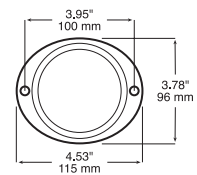

472 Aluminium Oval Reflector

- 3" diameter acrylic lens.
- Low-profile, oval housing constructed of rustproof aluminium.
- Meets FMVSS 108 standards.
- Sold in package of two reflectors.

Order Code	Description
B472R	red

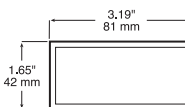
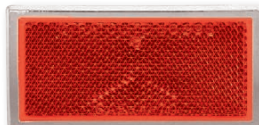
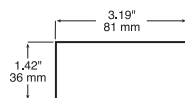
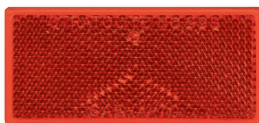

483/484 Rectangular Quick-Mount Reflector

- Adhesive back for quick and permanent mounting.
- Meets FMVSS 108 standards.
- 484R features attractive chrome bezel.
- Sold in package of two reflectors.

Order Code	Description
B483R	red
B484R	red, chrome

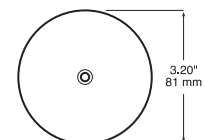
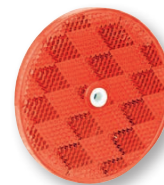

476 Round Centre-Mount Reflector

- 3 3/16" diameter hermetically sealed lens.
- 3/16" diameter centre screw mounting hole.
- Meets FMVSS 108 standards.
- Sold in package of two reflectors.

Order Code	Description
B476R	red

CONSPICUITY TAPE

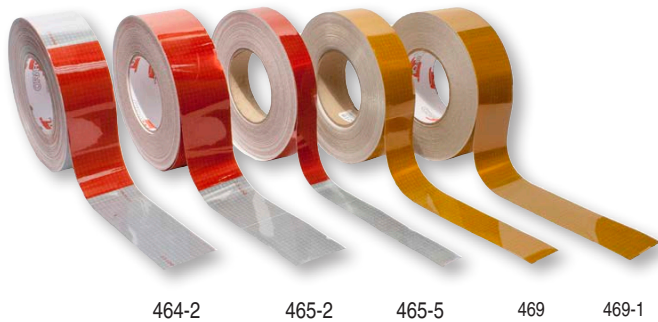

464-2 465-2 465-5 469 469-1

10-Year, 1000 Candlepower Polyester Film Tape Rolls



- Ten year warranty.
- UV-stabilized and weather resistant high performance polyester film.
- No edge sealing requirement and can be riveted through.
- Single layer prismatic construction maintains reflectivity after impact.
- Industrial-strength adhesive to mount on flat or curved surfaces.

Order Code	CP	Width	Lgth	Style	Pattern
464-2	1000	51mm	150'	V82	6" white x 6" red
465-2	1000	51mm	150'	V82	7" white x 11" red
465-5	1000	25.4mm	150'	V82	7" white x 11" red
469	1000	37mm	150'	V82	yellow
469-1	1000	51mm	150'	V82	yellow

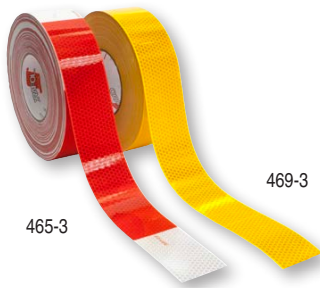

465-3

469-3

10-Year, High Intensity Prismatic (HIP) Tape Rolls



- High Intensity Prismatic Tape is whiter in daylight than traditional polyester.
- Air-backed, two-layer tape is sealed at edges.
- Industrial-strength adhesive to mount on flat or curved surfaces.

Order Code	CP	Width	Lgth	Style	Pattern
465-3	HIP	51mm	150'	V59	7" white x 11" red
469-3	HIP	51mm	150'	V59	yellow

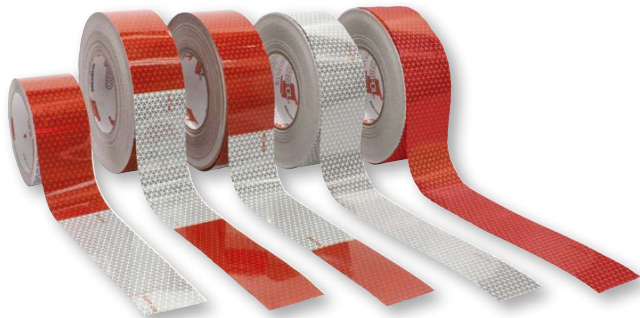

463-1 464-1 465-1 467-1 468-1C

5-Year, 600 Candlepower DAYBRIGHT Tape Rolls



- White lines in pattern for maximum DAYTIME visibility.
- Five year warranty.
- UV-stabilized and weather resistant high performance polyester film.
- No edge sealing requirement and can be riveted through.
- Single layer prismatic construction maintains reflectivity after impact.
- Industrial-strength adhesive to mount on flat or curved surfaces.
- Each roll contains 150 feet of tape, except 463-1 (which has 30').
- 468-1C is for auxiliary use only in USA.

Order Code	CP	Width	Lgth	Style	Pattern
463-1	600	51mm	30'	V92	7" white x 11" red
464-1	600	51mm	150'	V92	6" white x 6" red
465-1	600	51mm	150'	V92	7" white x 11" red
467-1	600	51mm	150'	V92	all white
468-1C	600	51mm	150'	V92	all red

PART NUMBER INDEX

Order Code	Page	Order Code	Page	Order Code	Page	Order Code	Page
142-18	5, 41	M365	31	817SA-9	22	928-MV	38
143-092	43	368	31	817SR-9	22	930-MV	39
143-18	5, 41	V 369S	33	817SW-9	22	931-MV	39
146-092	43	B 388-09X	4, 31	817W-9	33	932-MV	39
146-182	5, 41	M388A	4	818A-9	9	933-MV	39
150-09	7, 19	M388C	31	818C-9	10	934-MV	39
150-095	7, 19	M388R	4	818CA-9	9	1197SA	26
150-10	7, 19	M388WB	31	818CR-9	8	B 1200-09H	6
B 150-142	19	M397C	32	818R-9	8	B 1200-09X	6
B 150-143	19	M398-BT2	32	818SA-9	22	1200A	6
M153C-142	19	417-1	42	818SR-9	22	1200C	6
M153C-143	19	417-2	42	818SW-9	22	1200R	6
M153C-MV	19	417-3	42	818W-9	33	1203A	6
B 162-49	5, 45	421-09	43	818WTA-9	10	1203C	6
M163A-MV	4	421-18	41	820-09	43	1203R	6
M163FA-MV	4	B 423-11	41	820-10	43	1217A-9	9
M163FR-MV	4	426-09	43	820A-10	11	1217C-9	10
M163R-MV	4	426-10	42	820C-10	12	1217G-R	29
M165A-MV	4	426-11	42	820R-10	11	1217R-9	8
M165FA-MV	4	426-18	41	820SA-10	22	1218A-9	9
M165FR-MV	4	463-1	48	820SR-10	22	1218C-9	10
M165R-MV	4	464-1	48	820SW-10	22	1218R-9	8
M165SA-MV	4	464-2	48	823A-10	11	1220A-10	11
M165SR-MV	4	465-1	48	823C-10	12	1220C-10	12
M166A	7	465-2	48	823R-10	11	1220R-10	11
B 168-09	3, 44	465-3	48	823SA-10	22	1223A-10	11
B 168-092	3, 44	465-5	48	823SR-10	22	1223A-4	13
B 168-092B	3, 44	467-1	48	823SW-10	22	1223A-R-MV	13
B 168-10	3, 44	468-1C	48	850-092H	15	1223C-10	12
B 168-18	3, 44	469	48	850-092V	15	1223R-10	11
B 168-181	3, 44	469-1	48	850-093H	15	1223R-4	13
B 168-182	3, 44	469-3	48	850-093V	15	1223W-4	32
B 178-10	7, 33	B 472R	47	850-1	15	1268A-MTC	2
M178A-MV	7	B 476R	47	B 850-18	41	1268A-MV	2
M178A-MVC	7	B 479R	47	850A	14	1268A-MVC	2
M178R-MV	7	B 480R	47	850A-1	14	1268A-MVC-BT2	2
M178W-MV	33	B 481R	47	850C	14	1268R-MV	2
M179A	21	B 483R	47	850C-1	14	1268R-MVC	2
M179R	21	B 484R	47	850R	14	1268W-MV	2
M181A-MV	6	B 490R	46	850R-1	14	B 1274R	46
M181R-MV	6	B 491R	46	850SA	15	B 1284A	47
B 192-492	45	500	21	851A-R	16	B 1284R	47
M203A	7	V 711	34	851A-R-SW	16	B 1284W	47
M203R	7	744A	28	860SA-1	23	1288	17
253SA-1	23	745A	28	860SA-2	23	1288C	17
253SA-2	23	751-24K	27	860SA-3	23	2217A-R	16
290-MV	19	751A	27	860SA-4	23	2218A-R	16
290C-MV	19	752A	27	867SA-1	23	2219A-R	16
290C-MV-SM	19	752MA	27	867SA-2	23	B 2268-18	3, 44
V 316MA	29	762A	28	867SA-3	23	2268A-R-MV	2
V 316MR	29	764A	29	867SA-4	23	2268A-R-MV-BT2	2
V 327AA	18	779-1A	27	B 880-49	45	2290A-R	17
V 327L	18	780	20	880-7-MV	12	2291A-R	17
V 327R	18	781	20	881-7-MV	12	4153SA	26
V 338-2	18	782	20	882-7-MV	10	4154SA	26
V 339A	18	784	20	883-7-MV	10	4155SA	26
V 339R	18	784-C	20	903-MV	35	4156SA	26
350A	12	791A	28	V 904-MV	35	5000	21
358-1	30	797A	29	905-MV	34	5600	30
358-2	30	817-09	43	906-MV	34	5600-1	30
358-3	30	817-10	43	M908S-MV-BT2	35	V 7005	5, 40
358-4	30	B 817-49	45	V 910-MV	36	V 7005S	5, 40
359-1	30	B 817-49L	45	V 910M-MV	36	V 7007	5, 40
B 359-10	30	B 817-49S	45	V 912-MV	37	V 7007S	5, 40
359-2	30	817A-9	9	V 913-MV	37	V 7009	40
359-3	30	817C-9	10	915-MV	37	V 7009S	40
359-4	30	817CA-9	9	V 919-MV	38	V 7011	40
M360-1	31	817CR-9	8	920B-MV	38	V 7011S	40
M360-BT2	31	817R-9	8	V 921-MV	36		



PETERSON



Peterson Manufacturing is headquartered in a modern 670,000 square foot (62,245 sq. meters) facility located just outside Kansas City, Missouri, USA.

Since 1945, Peterson has grown from a small, family business to an international industry leader with state-of-the-art production and testing facilities, vast warehousing space, and 750-plus dedicated associates—many of them second and third-generation employees.

For over seventy-five years, company leadership has continually focused on creating

the highest quality product possible. This core value is perhaps best reflected in the fact that Peterson was one of the first 40 manufacturers in North America to obtain ISO registration and is currently ISO 9001:2015 certified.

Examine Peterson products closely, and you'll see the extra measure of quality that led such legendary U.S. manufacturers as Harley-Davidson, Caterpillar, and John Deere to specify Peterson lights.

Peterson's line of LED lights is unsurpassed in optics, manufacturing technique and state-of-the-art design.



Visit us at www.pmlights.com to learn more.



Address **9a Earl Richardson Avenue
Manukau, Auckland 2104**

Tel **09 262 1417**

Email **sales@cdlautoparts.co.nz**

Web **www.cdlautoparts.co.nz**