

Hēima

Loveseat Sleeper
Instruction Manual

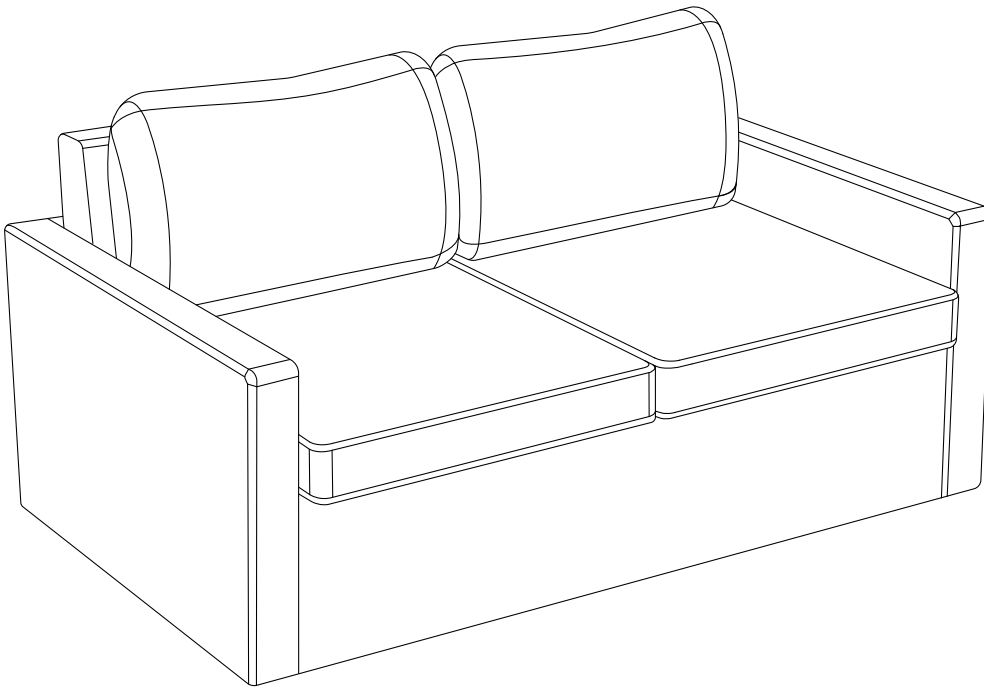

ZTCZZ

TOGETHER IS ALWAYS BETTER

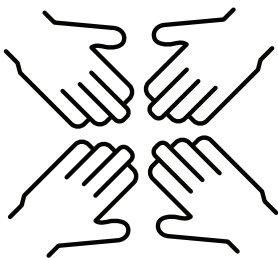

It's not a secret that each of us can pull out all the stops! But two of us together are capable of doing much more. Turn this routine assembly work into fun activity with your family or friends!

OUR ADVICE: IT'S TWICE AS NICE WITH A PARTNER!



Scan for
assembly instruction
ztozz.com/ai

WHAT YOU HAVE

1 Tools

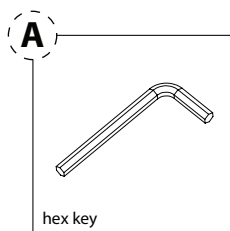

2 Hardware

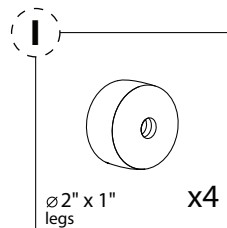
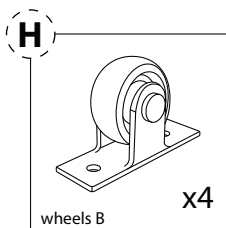
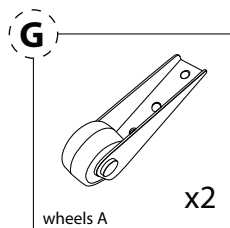
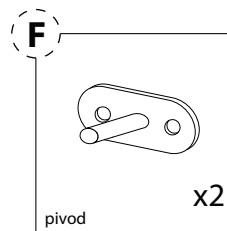
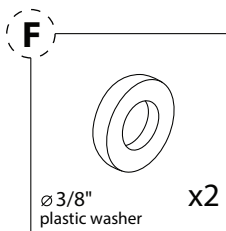
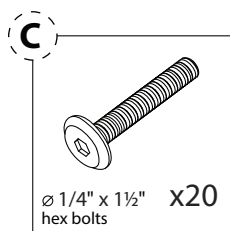

3 Frameset

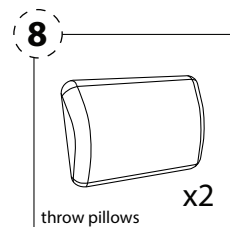
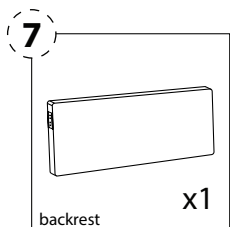
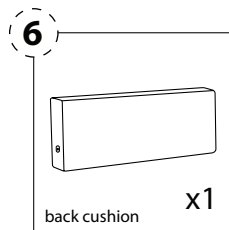
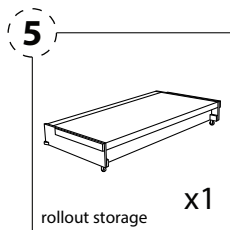
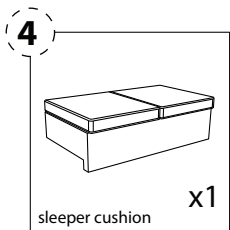
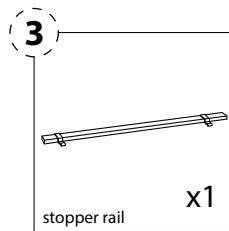
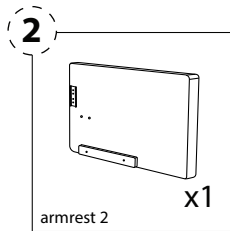
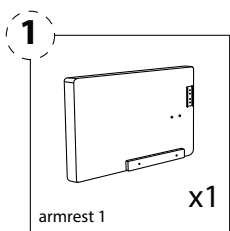

LET'S
MAKE
IT WORK!

WHAT YOU HAVE

GOOD LUCK!

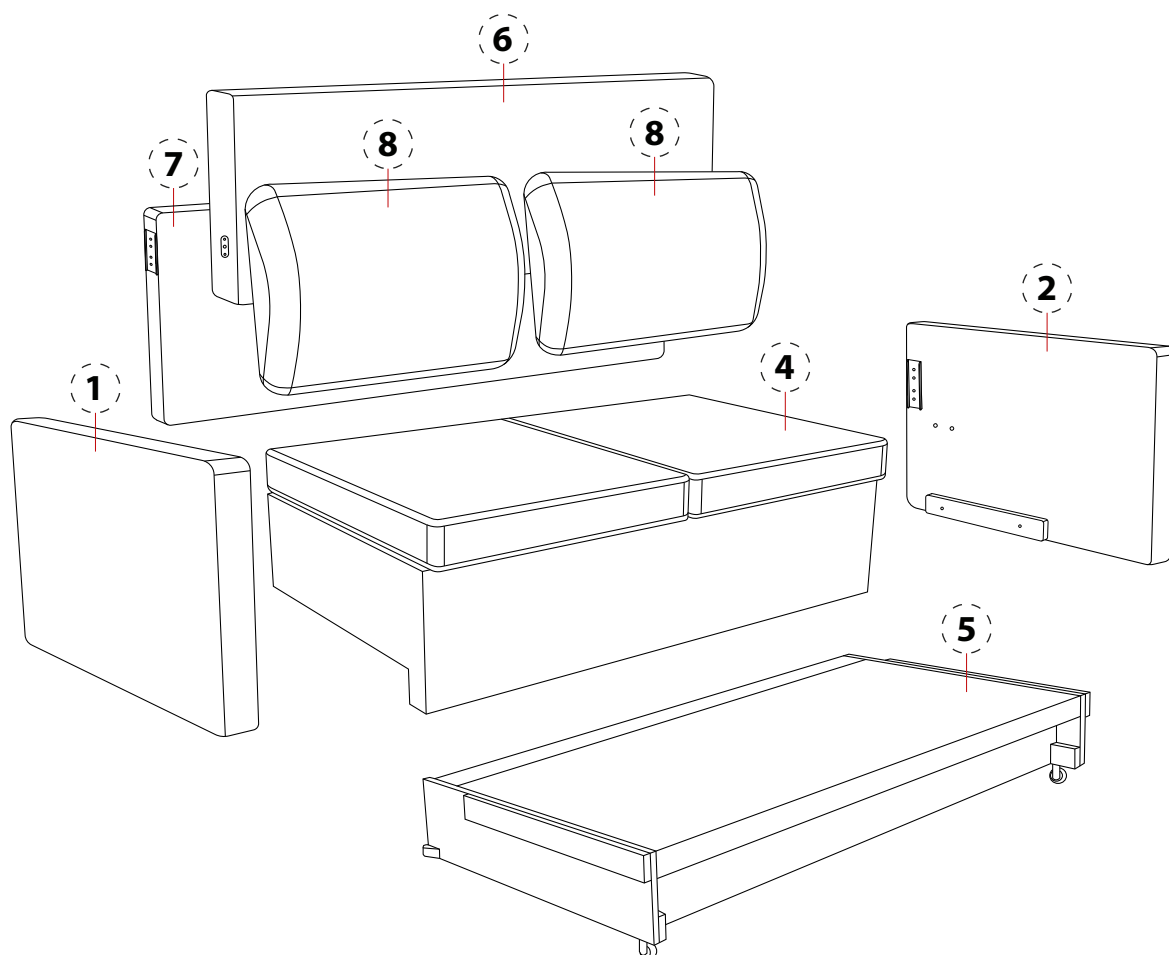

YOU WILL DO IT!

1

Take the pre-assembled rollout drawer and sleeper cushion out of the carton. Follow the red string and you'll find the hardware pack and the throw pillows inside the drawer. Fold the drawer back into the original position and place the assembly vertically as shown.

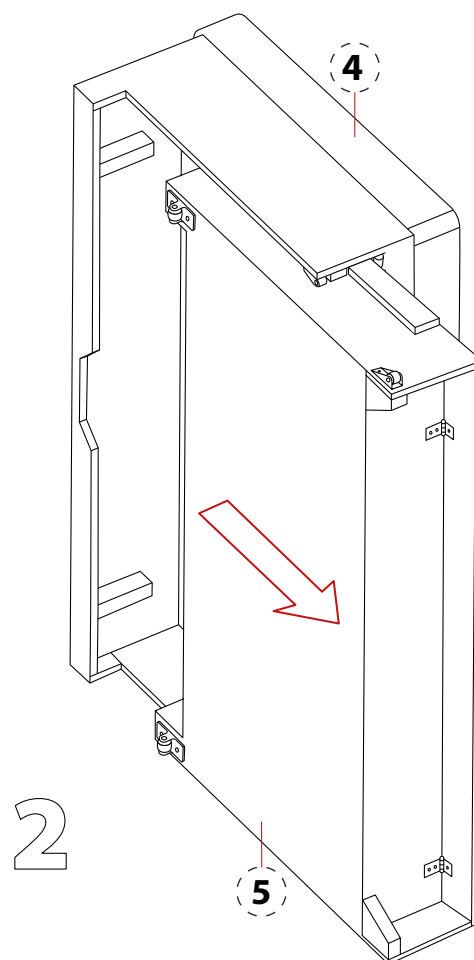
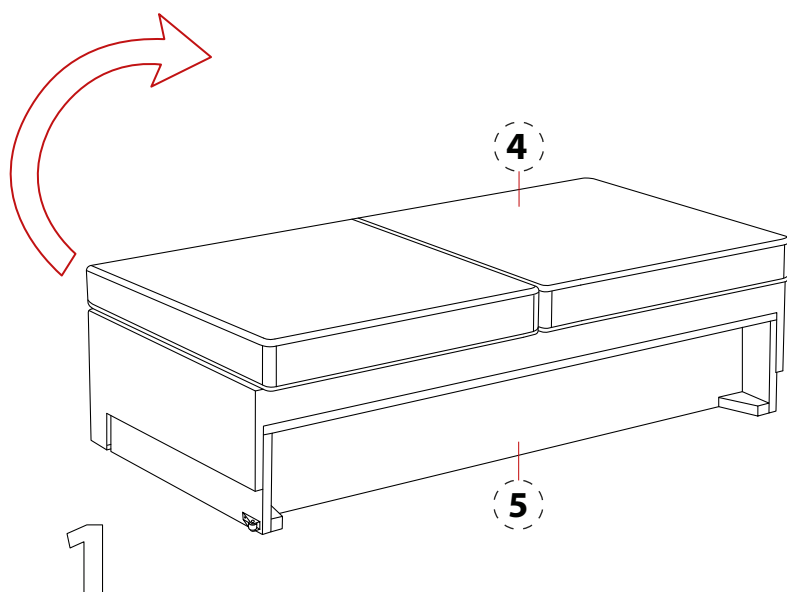

2

Screw in the wheels A (part G) using 2x hex bolts with the hex key.

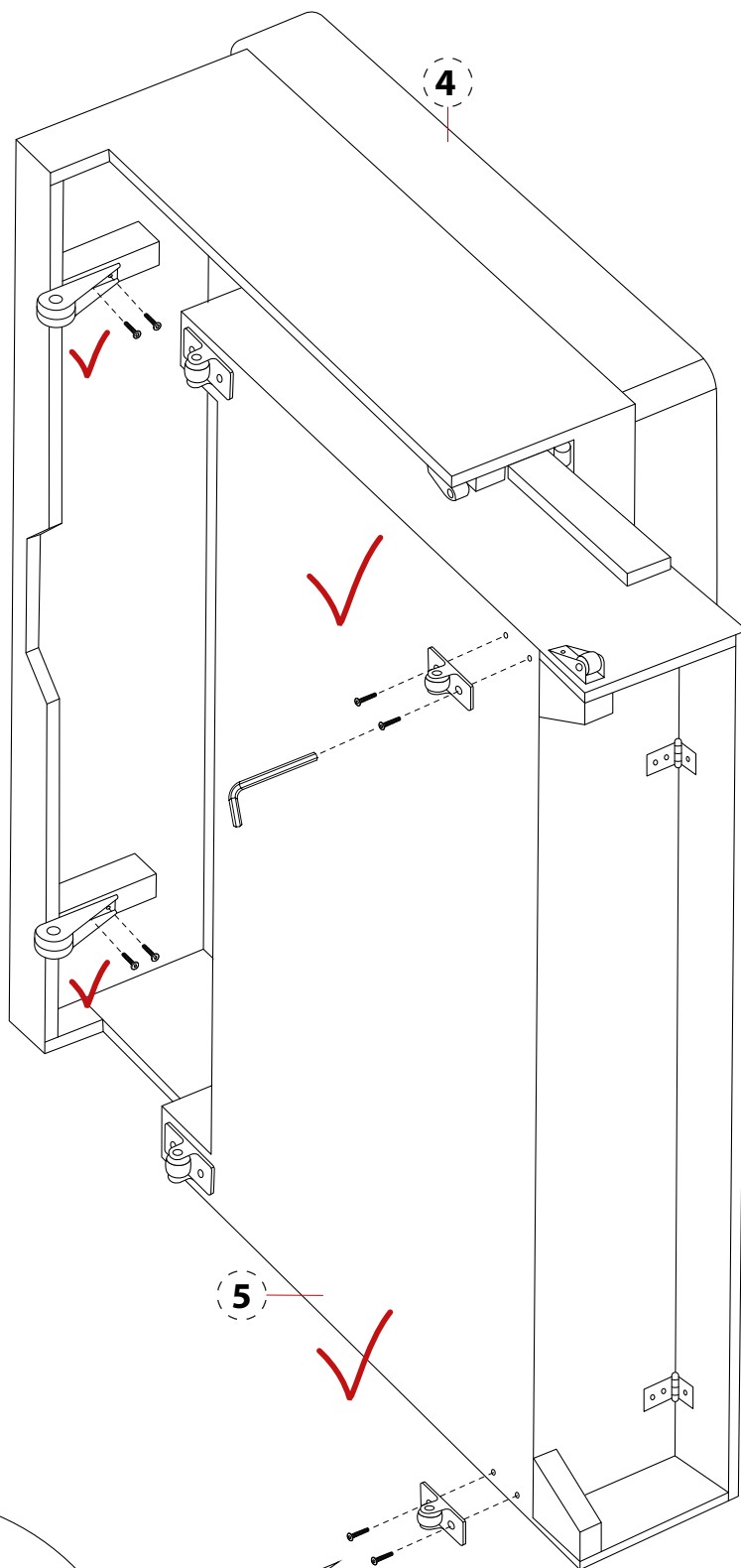
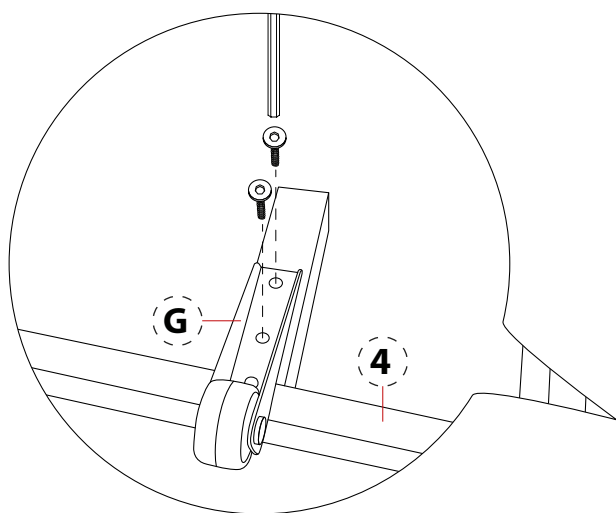

3

Screw in the wheels B (part H) using 2x hex bolts with the hex key.

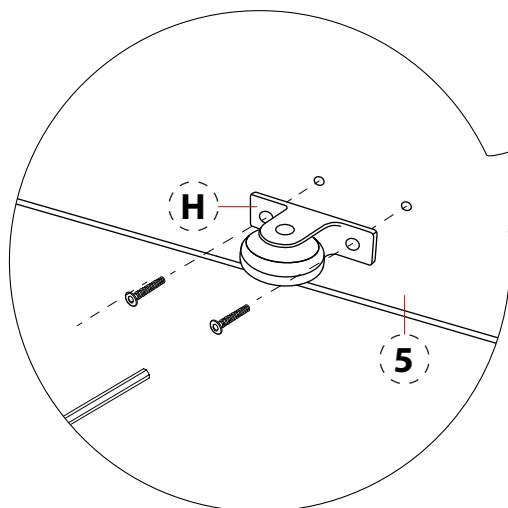

4

Make sure to fold the drawer into a sleeper cushion and place the assembly so that the wheels are facing downward.

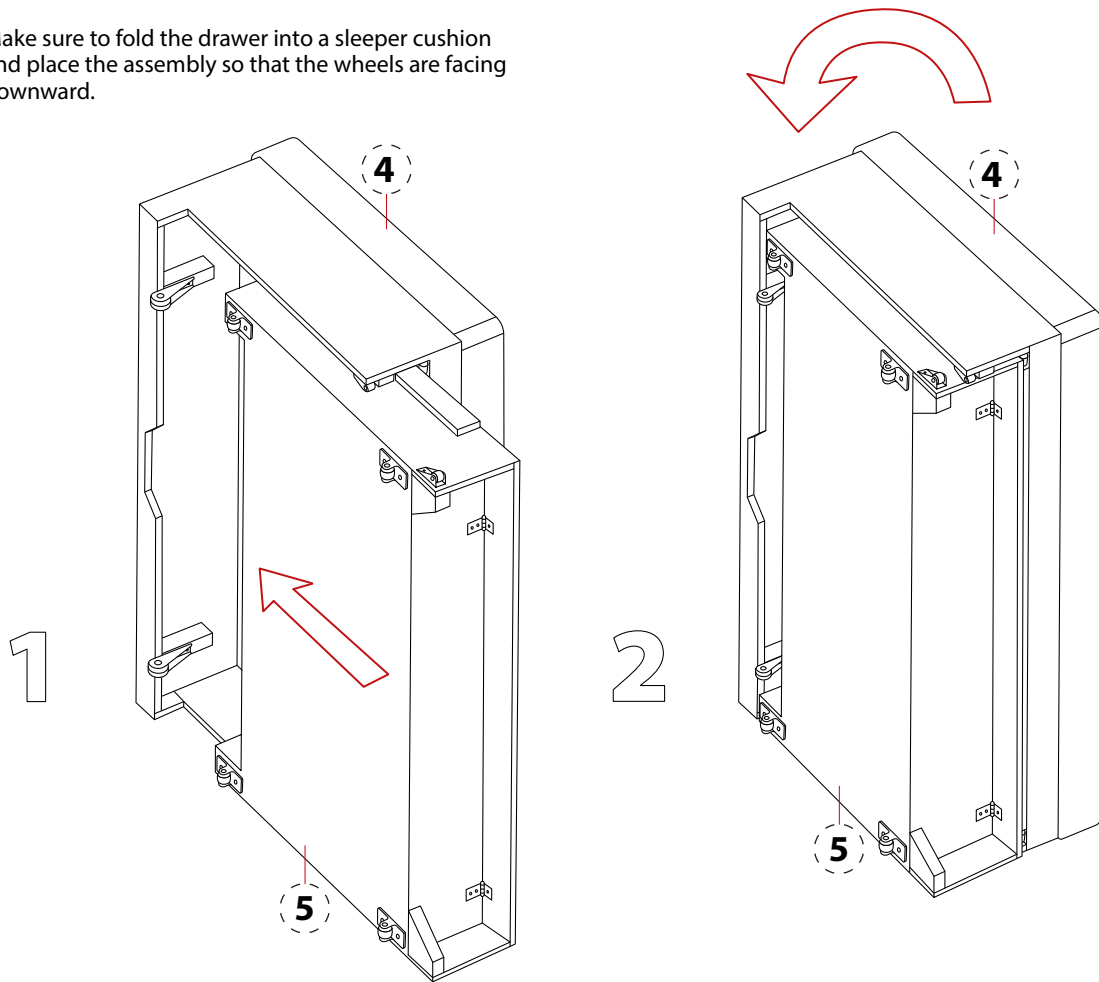

5

Take out both armrests and place them as pictured. Please position the center of the leg (part I) 1,6" from the edge of the armrest and attach the legs using the hex bolts as shown.

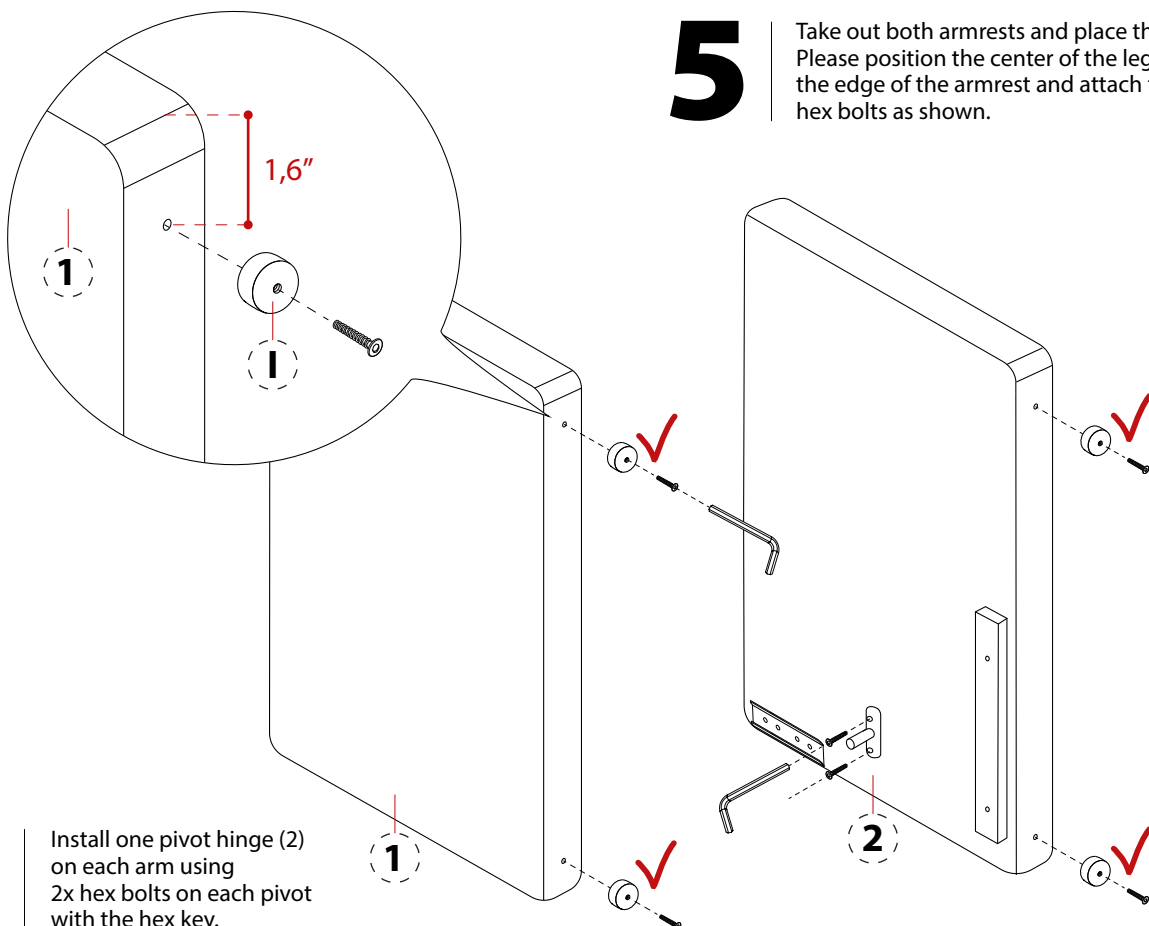

6

Install one pivot hinge (2) on each arm using 2x hex bolts on each pivot with the hex key.

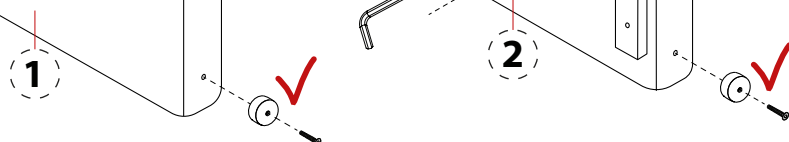

7

Attach the stopper rail onto the armrests using hex bolts on each armrest with the provided hex key. Please make sure the stopper hooks are positioned as in illustration.

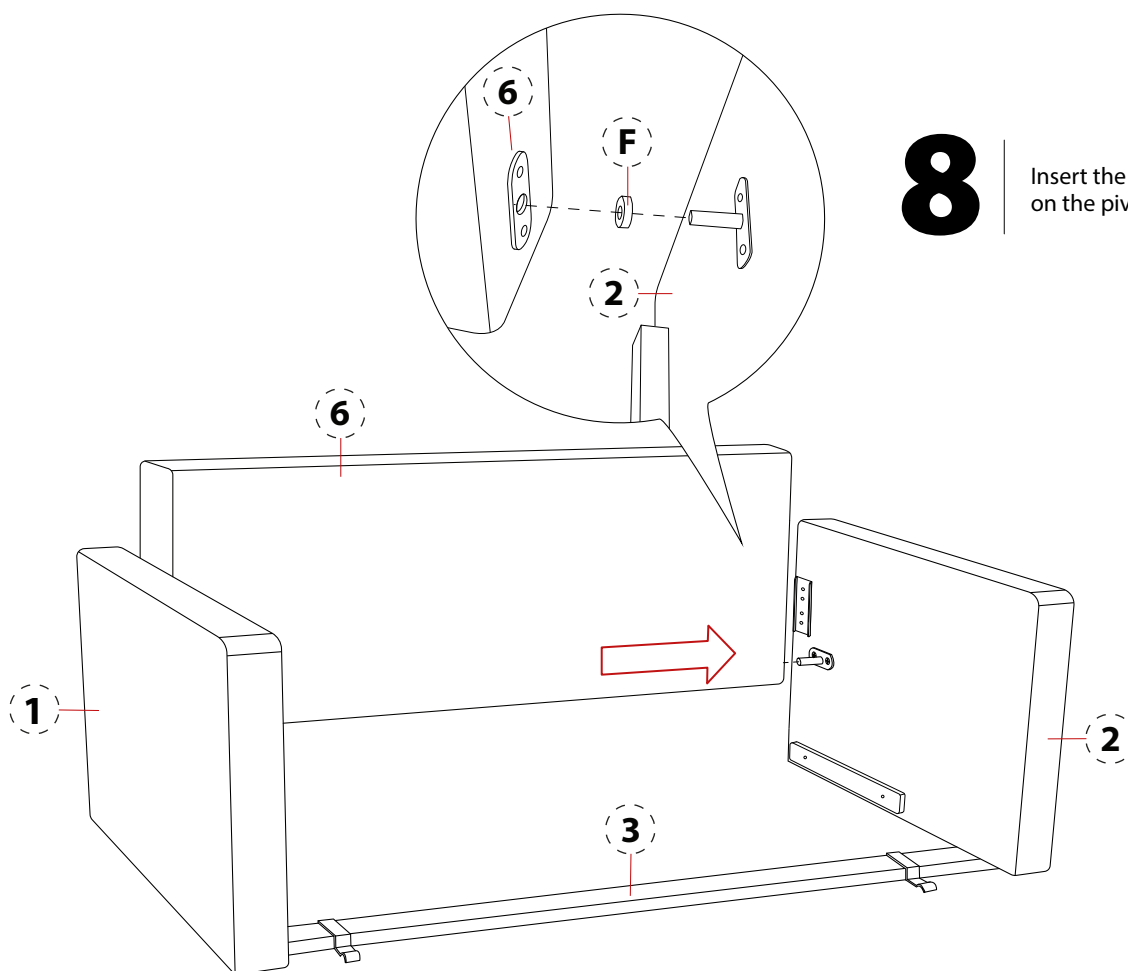
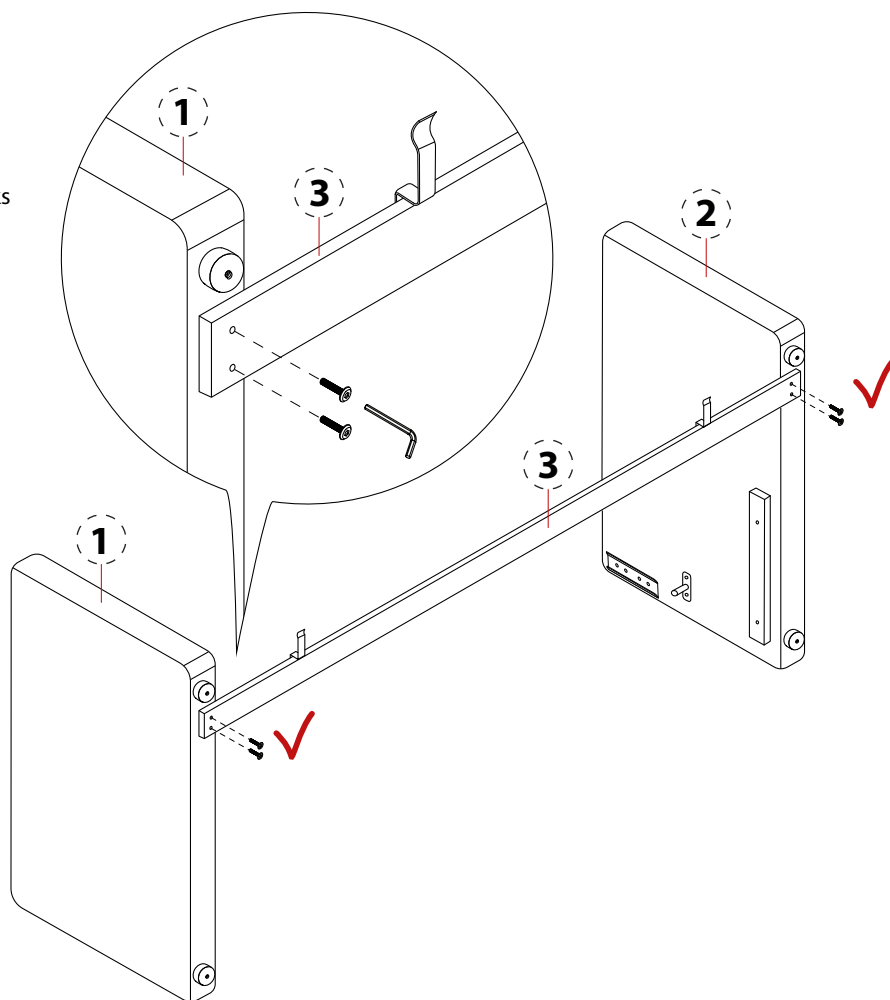

8

Insert the plastic washer (F) on the pivot hinges

9

Align the back cushion holes with the pivot hinges on armrests and insert it with the plastic washer in between.

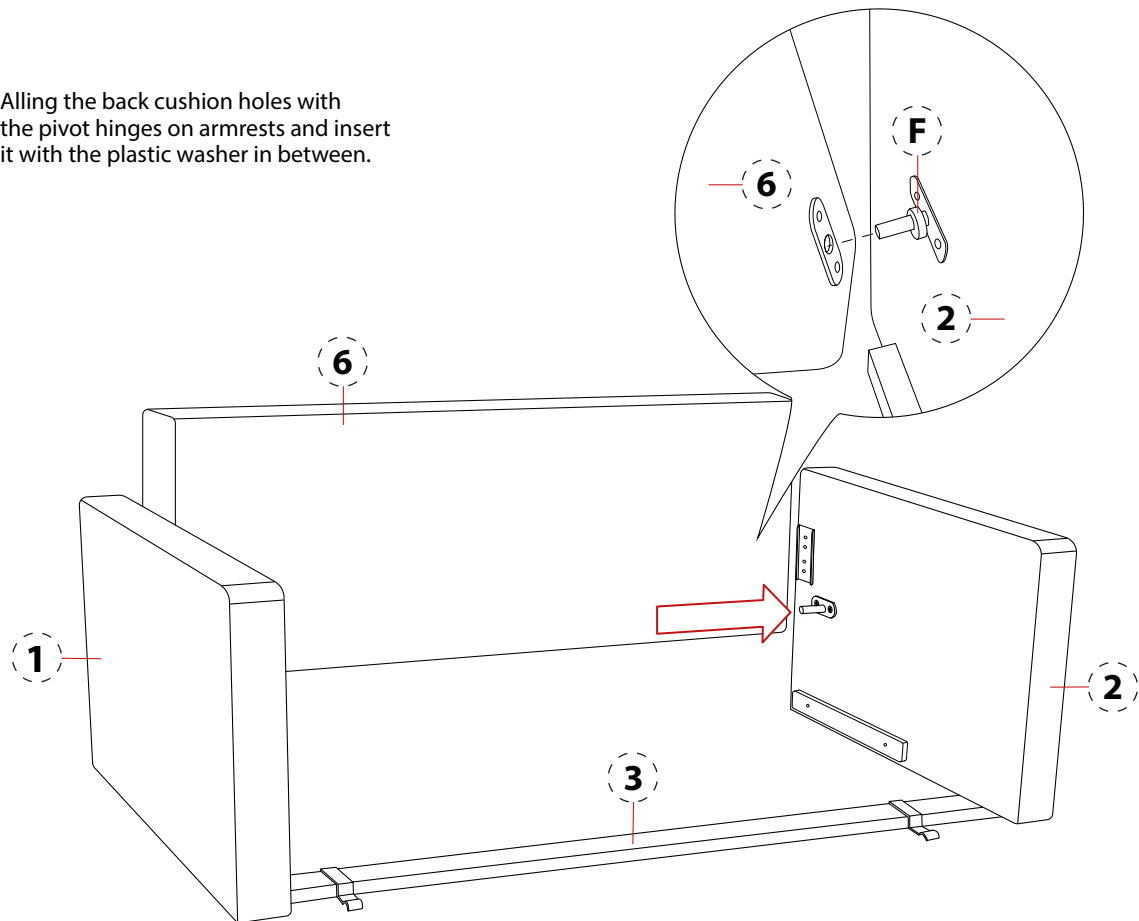

10

Center the backrest and align it with the connector hinge, then push it down. (make sure the facing area is facing out)

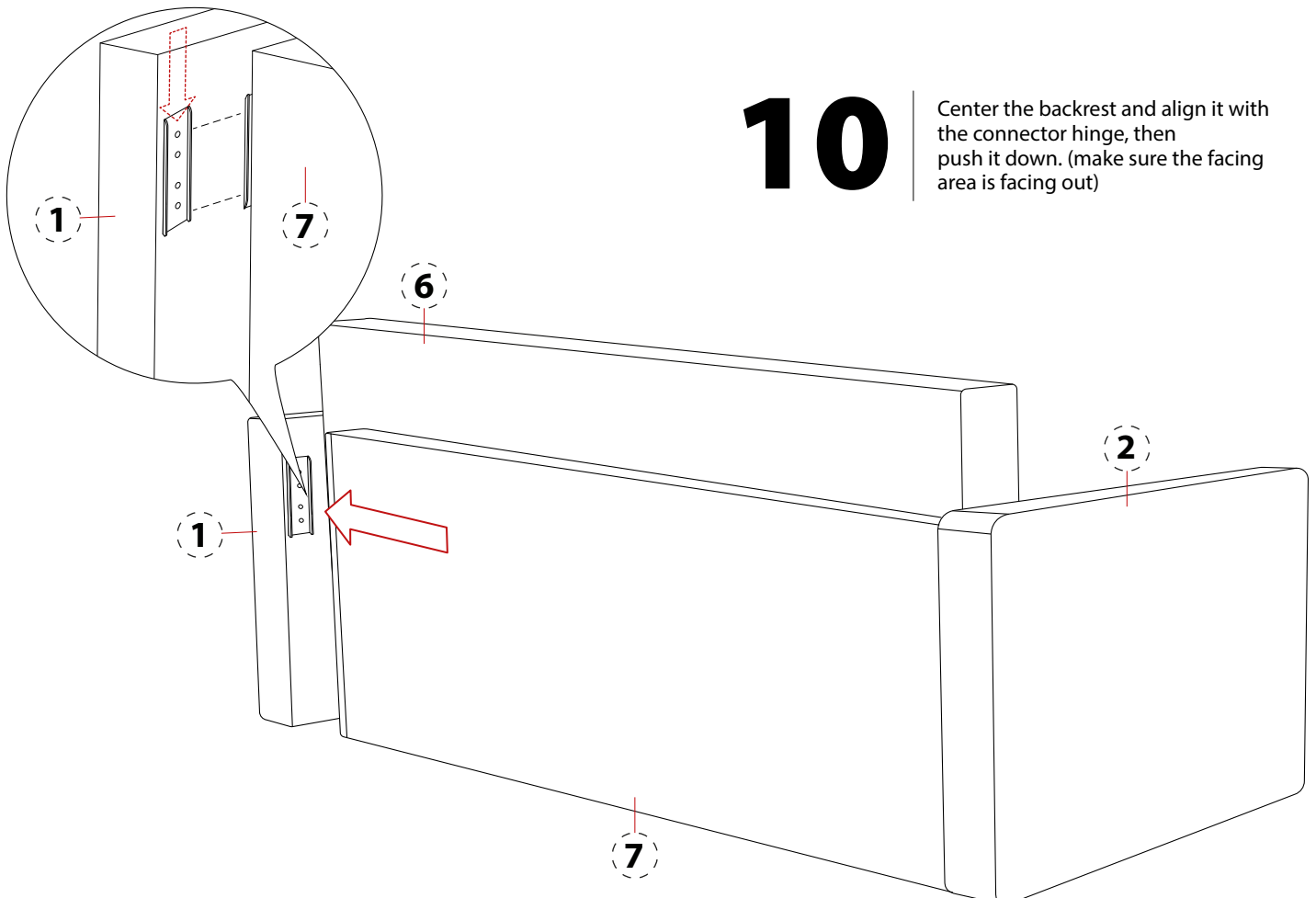

11

Place the sleeper assembly into the sofa base, gently roll it over the stopper rail until both wheels are on the inside of of stoppers, you'll hear a distinct "click" sound.

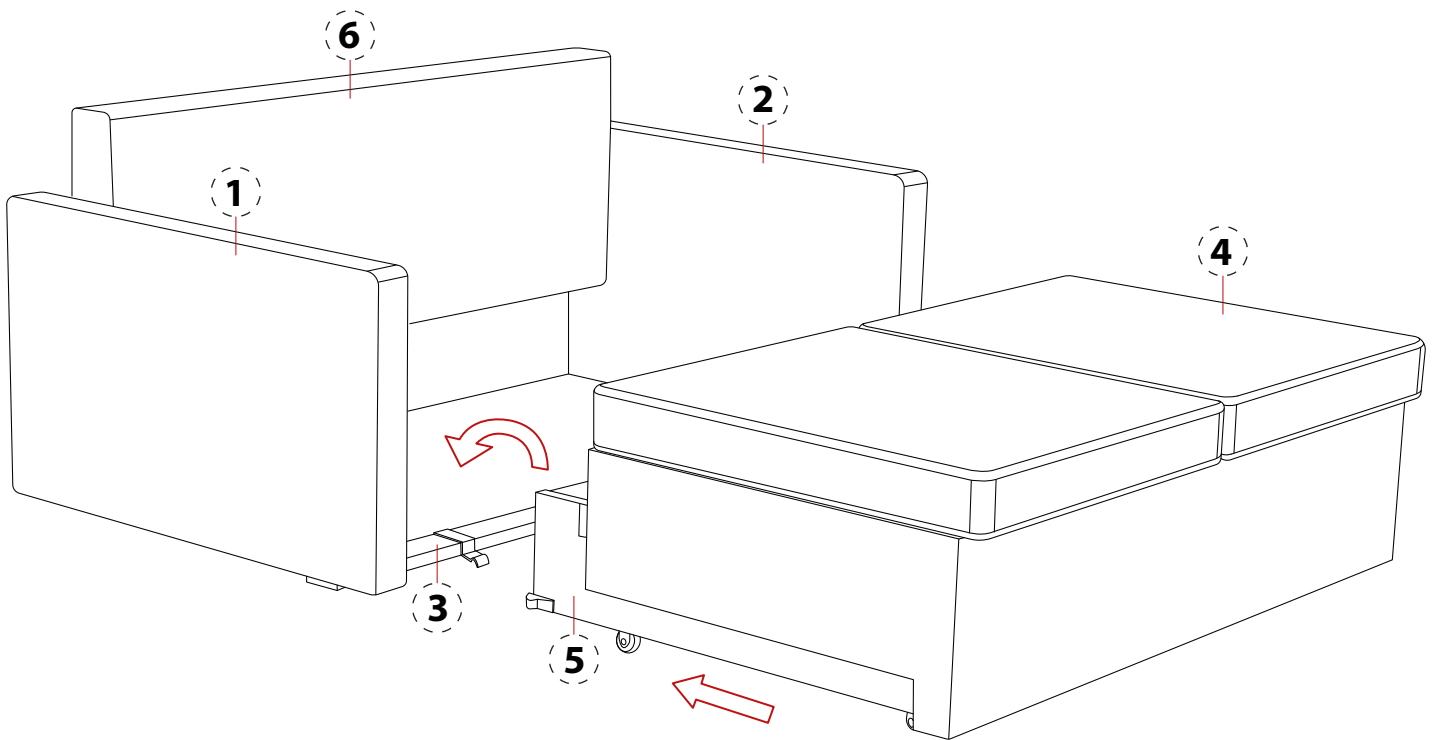

ENJOY YOUR LOVESEAT SLEEPER!

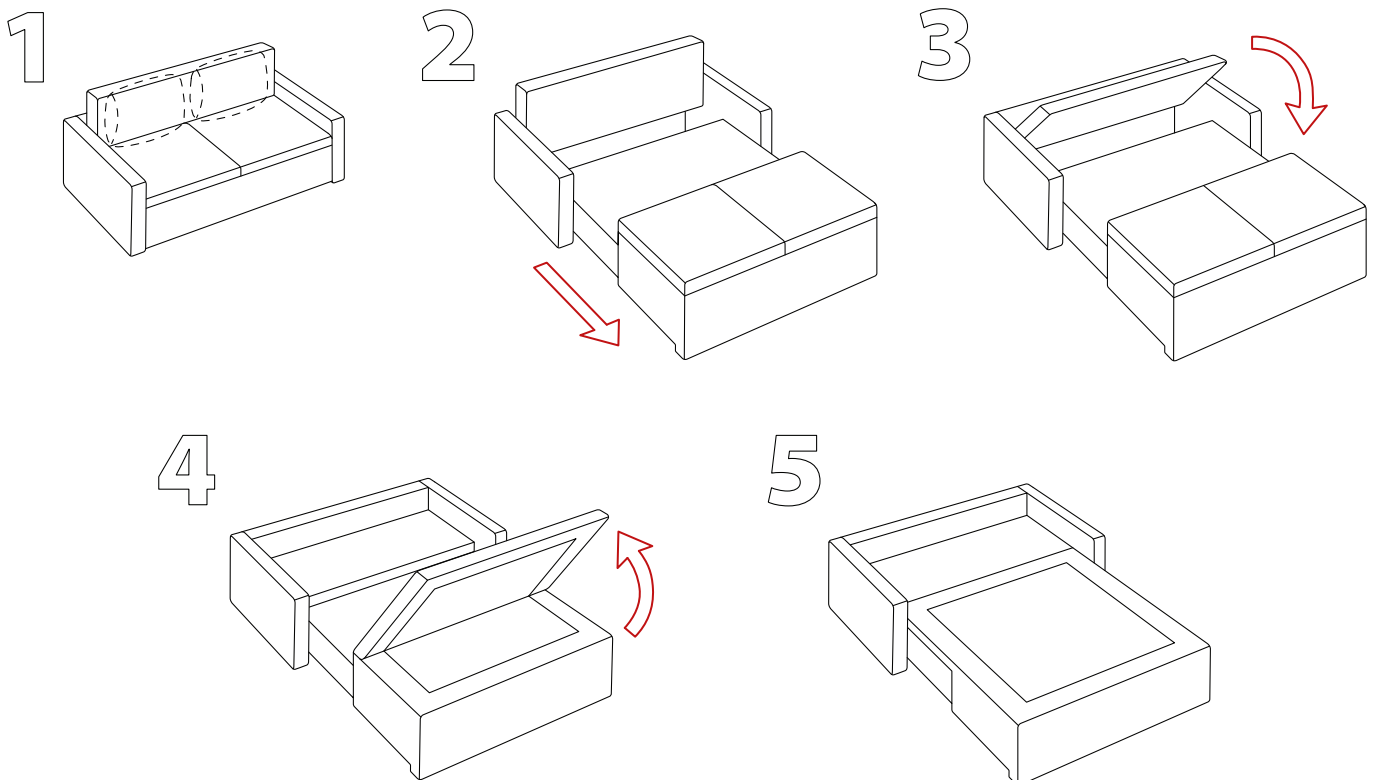

WELL DONE!

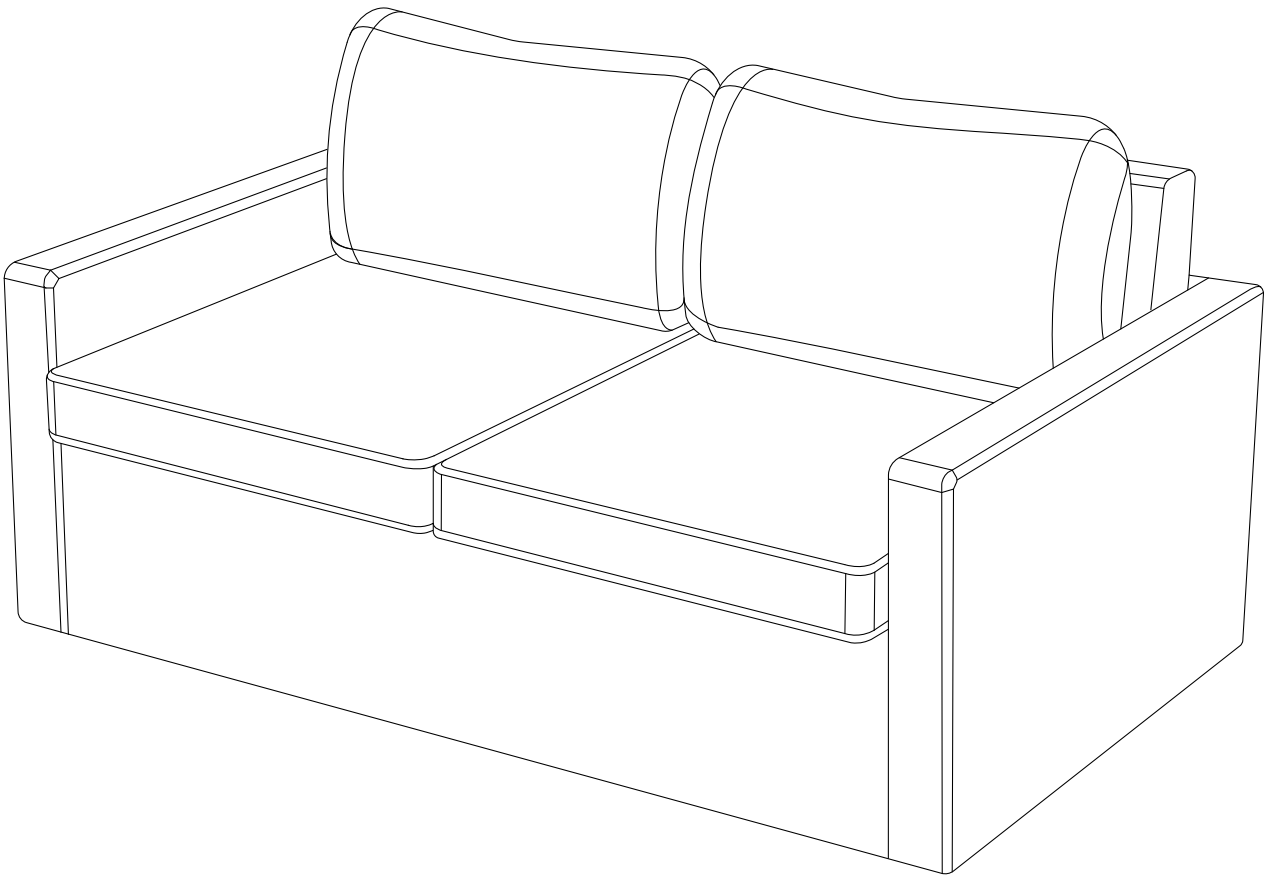

ZTCZZ