

Wiring Notice

EM Driver on LED UFO ≤ 300W (0-10V Dim)

Typical wiring diagram



ASSEMBLY and FIELD INSTALLATION WARNING: AC power must be off before proceeding with assembly or installation of emergency driver

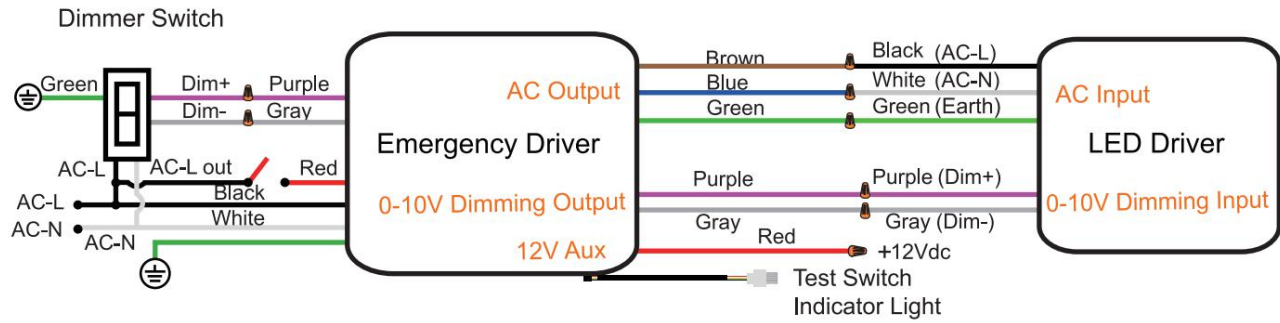

EM Output to UFO Driver

EM Driver Wires		Remarks
Color	Label	
Purple	Driver Dim+	Connect to UFO driver's Dim+
Gray	Driver Dim-	Connect to UFO driver's Dim-
Brown	Driver L	Connect to UFO driver's L
Blue	Driver N	Connect to UFO driver's N
Green	GND	Connect to UFO driver's GND

AC Input

EM Driver Wires		Remarks
Color	Label	
Black	AC-L	
White	AC-N	
Blue	AC-Lout(Wall Switch)	
Green	GND	

Dimmer Input

EM Driver Wires		Remarks
Color	Label	
Purple	Dim+	Connect to dimmer's Dim+
Gray	Dim-	Connect to dimmer's Dim-

Test Switch and Indicator(Remote Control Version)

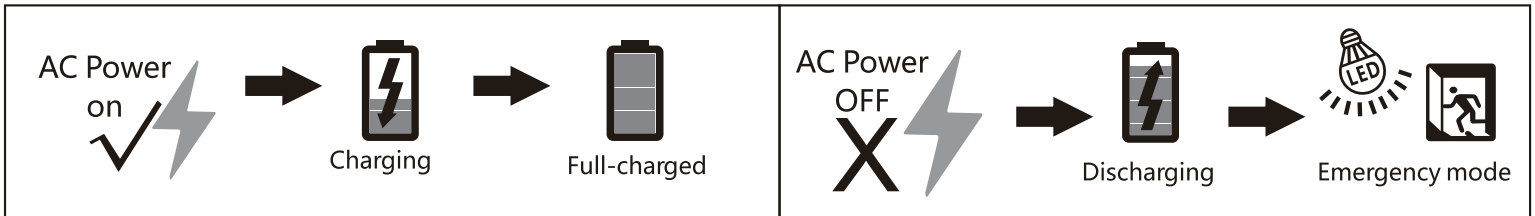

Indicator light introduction

- ① Red/flashing: Charging
- ② Red/on: Full-charged
- ③ Red/off: Discharging(emergency mode)



Remote control introduction

- ① Press ON button to test emergency function. The light will switch to emergency lighting and the Red indicator light will turn off. Press OFF button, the light will recover to normal mode.
- ② In emergency mode, double press the OFF button will turn off emergency function. The indicator light will flash one time.

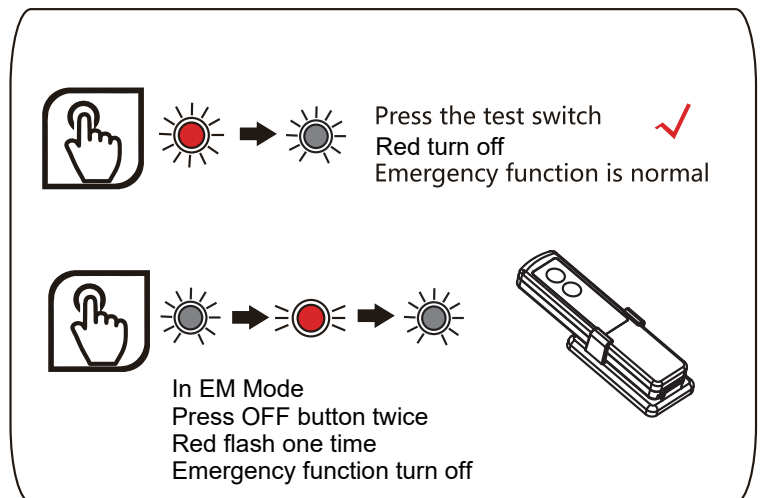

Please note:

Remote must be pointed at the indicator light and be within a 45 degree angle to receive a signal/command. Remote needs two AAA batteries to operate (not included).



- WARNING:**
- (1) To reduce the risk of electric shock, press OFF button twice to turn off emergency function if you disconnect wires between emergency led driver and normal led driver.
 - (2) Always remember do not touch wires in emergency mode

Test Switch and Indicator(Regular Version without remote control)

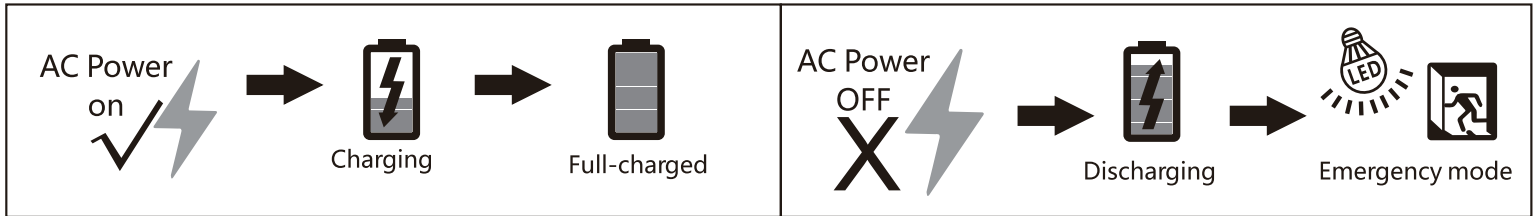

Indicator light introduction

- ① Green/flashing: Charging
- ② Green/on: Full-charged
- ③ Red/on: Discharging(emergency mode)
- ④ Red/flashing: Discharging(emergency mode) finished soon

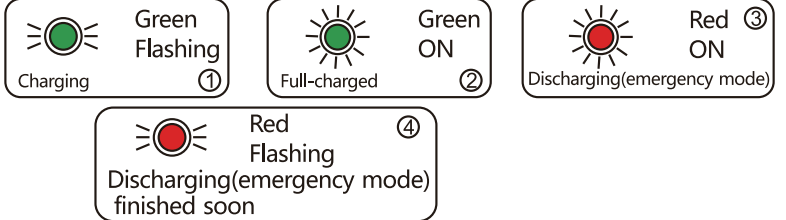

Test switch introduction

- ① Press the test switch to confirm whether the emergency function is normal
- ② In emergency mode, double-click the test switch to turn off emergency function.

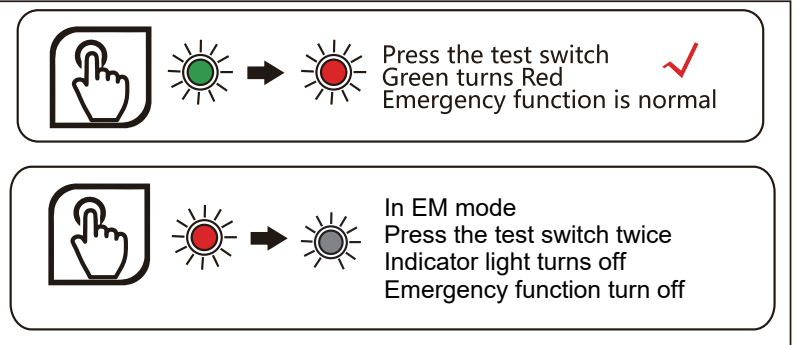



* Note: AC power on, click the test switch, switch to emergency mode and lasts 3S, then automatically back to the working mode of AC power supply

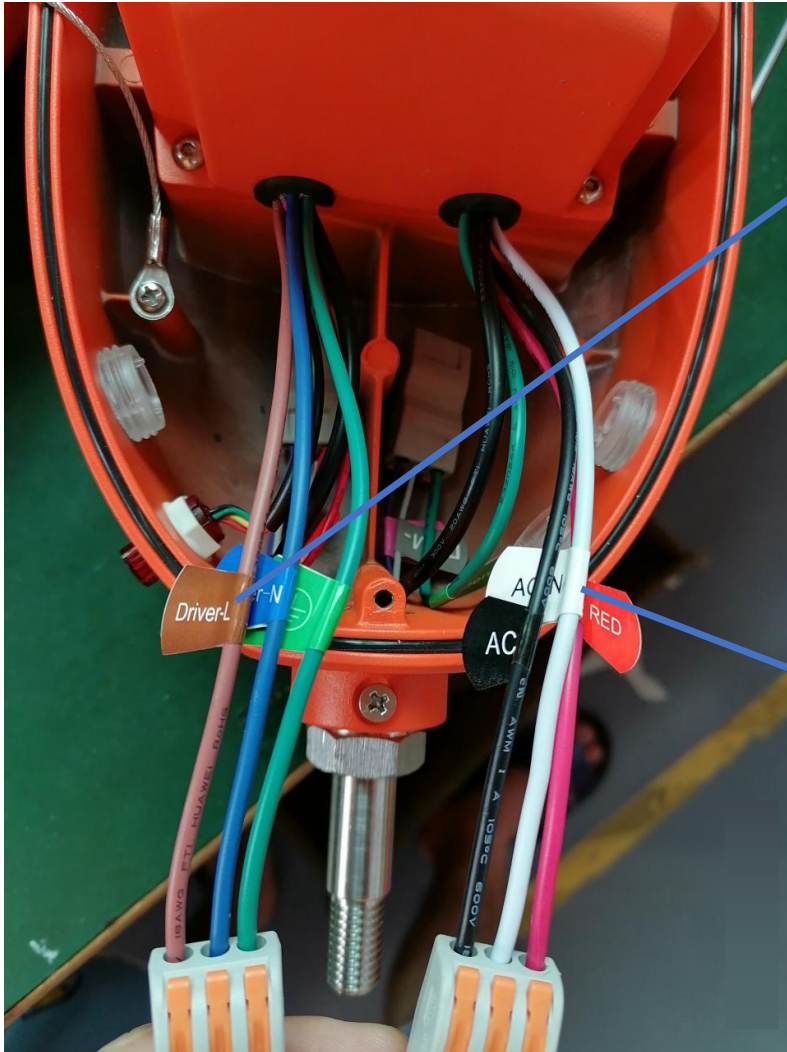

- WARNING:** (1) To reduce the risk of electric shock, double-click the test switch to turn off emergency function if you disconnect wires between emergency led driver and normal led driver.
 (2) Always remember do not touch wires when indicator light is illuminated.

Photos



Driver L(brown) → connect to UFO Driver's L
Driver N(blue)→connect to UFO Driver's N
 (CAN NOT CONNECT TO AC POWER)

AC-L,AC-N(black&white) →connect to AC power
Red(L-out)→ wall switch

Driver Dim+(purple) → connect to UFO driver's Dim+
Driver Dim-(gray) → connect to UFO driver's Dim-

