

T8 TUBE USER MANUAL & INSTALLATION

- Direct Install Type AB & Direct Wire Type B Tube Light_V001

WARNING

- Turn power off before inspection, installation, or removal.
- Risk of electric shock - Don't use where exposed to water or weather.
- Do not open – no user serviceable parts inside.
- Not intended with emergency exit luminaires or emergency exit lights.



CAUTION AND NOTICE

- Continuous arcing generates high temperature to melt socket plastic or tube cap;
- Continuous arcing damages LED driver circuit;
- Installed by licensed electrician;
- Test sample before mass installation;

NOTICE

- Sensor switch can activate dimming function, choose our non-dimming tube when sensor used on tube light fixture.

WIRING DIAGRAM

PLUG AND PLAY INSTALL

BEFORE LED TUBE INSTALLATION

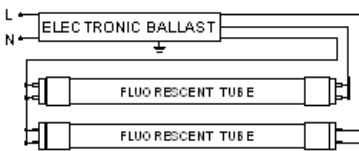

AFTER LED TUBE INSTALLATION

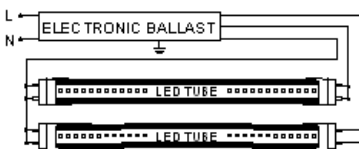

DOUBLE END POWER IN

BEFORE LED TUBE INSTALLATION

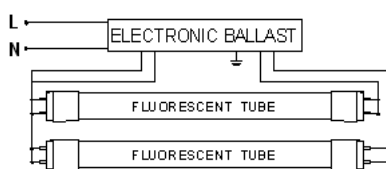

AFTER LED TUBE INSTALLATION

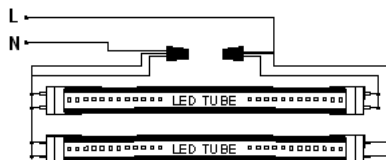

SINGLE END POWER IN

CUT WIRES AS SHOWN IN THE DIAGRAM

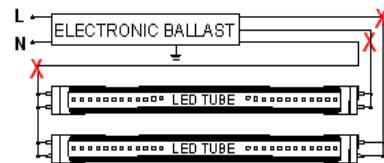

MAKE THE NEW WIRES CONNECT TO THE BRANCH CIRCUIT

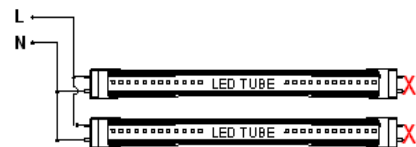

YOU CAN USE EITHER END TO MAKE SINGLE ENDED CONNECTION

***NANO T8N TUBE CAN BE SINGLE ENDED AT LABEL END ONLY.**

* For one ballast by three fluorescent tube fixture, at least to put TWO units of ballast compatible LED tube on.

* For one ballast by four fluorescent tube fixture, at least to put THREE units of ballast compatible LED tube on.

* Following right one for fixture rewiring from above three diagram, strictly refer to WIRING DIAGRAM on tube label.

INSTALLATION GUIDE AND USER MANUAL

A. Check WIRING DIAGRAM on tube label and wiring in the fixture, Tombstone and wiring must match tube wiring mode;

Safety Warning Label must be applied to fixture interior to inform of modification at direct wire mode, packed in carton box;

B. Regular Non Dimming tube installation:

1. Switch off power before tube installed in fixture;
2. Twist on the T8 tube in fixture and switch "ON".

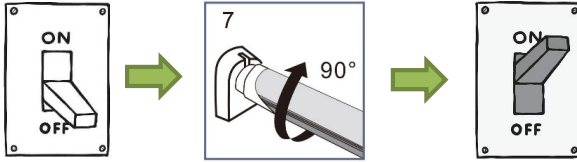

C. Dimming tube installation guide and user manual:

a. Type A dimming function: dimming works with dimming ballast only

b. Type B at ordinary FULL lumen mode: either single end power in (SEP) OR double end power in (DEP) works

1. Switch off power before tube installed in fixture;
2. Twist on the T8 tube in fixture and switch "ON", tube at 100% lumen condition and stay "ON" 100% as default like ordinary tube;

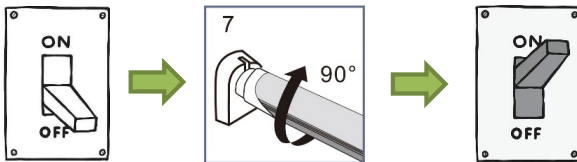

c. Type B dimming to LOWEST lumen mode: either single power in (SEP) OR double end power in (DEP) works

1. Switch off power and twist on the T8 tube in fixture;

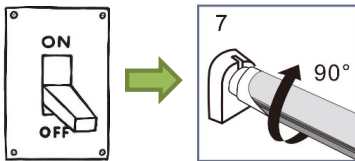

2. Switch "ON-OFF-ON" in 1.0-5.0 seconds, tube lumen starts dimming from 100% down to 10% and stay on 10% lumen;

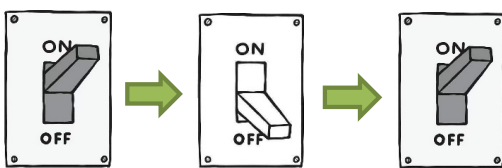

d. Type B dimming at a FAVORITE lumen mode: either single power in (SEP) OR double end power in (DEP) works

1. Switch off power and twist on the T8 tube in fixture;

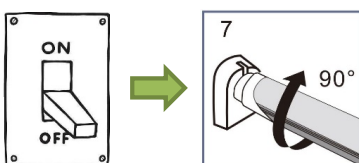

2. Switch "ON-OFF-ON" in 1.0-5.0 seconds, tube lumen starts dimming down from 100%, switch "OFF-ON" when tube dim to your FAVORITE lumen;

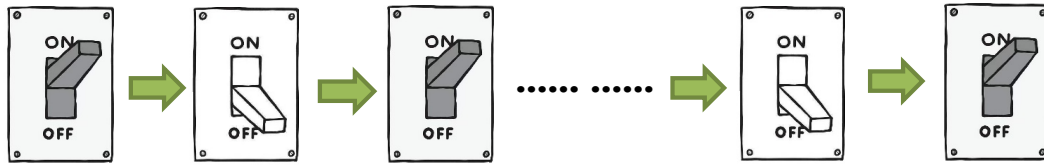

3. Repeat step "1-2" on your next FAVORITE experience;

ATTENTION

This product has a warranty for a period of 5 years from the date of purchase. Warranty is invalid in the case of improper installation, tampering, or removal of the Q.C. date. Installation in an improper working environment or installation not according to the current edition of the National Electric Code also invalidates the warranty. If this product fails during the warranty period, it will be replaced free of charge, subject to correct installation and return of the faulty unit. We do not take responsibility for any installation costs associated with the replacement of this product. This warranty is an addition to the statutory rights in the country of purchase. We reserve the right to alter specifications without prior notice.