

NEFLINTW-R4MPW

4" E-Series FLIN Round LED Downlight with Selectable CCT

Source: 10.5W
Up to 950lm

PRODUCT DESCRIPTION

E-Series FLIN is a thin recessed LED designed for easy installation into new construction or remodel applications. Luminaires include a selectable color temperature switch located on the junction box of each luminaire with a quick connect that allows for easy disconnect and mounting in the ceiling.

FEATURES

- No housing required and includes junction box with class 2 driver
- Quick installation and cost savings
- Junction box includes kelvin temperature switch
- IC Air-Tight rated
- Field selectable color temperature
- Triac or ELV dimming
- cETLus Listed for Wet Locations
- 5-year limited warranty

SPECIFICATION

Construction: Die-cast aluminum luminaire with spring clips for easy installation. Gasket included for air-tight and wet location listing without additional caulking.

Air Flow Restriction: Luminaire has factory installed gasket to restrict airflow from room into ceiling plenum to <2CFM (cubic feet per minute) in accordance with ASTM E283 Air-Tight requirements.

Lens: Regressed lens with sharp baffle cuts reduces aperture brightness. Special polymer lens produces more usable light and lumens per watt.

Junction Box: Prewired junction box includes quick connect to LED fixtures for ease of installation. Junction box includes two 1/2" trade size and two 3/8" trade size knockouts and snap on cover. Maximum of 4 No. 12 AWG through branch circuit conductor suitable for 90°C permitted in box.

[Fixture wire length: 5" and Junction box wire length: 9"]
Maximum length between luminaire and driver is 40'. For longer remote driver remote run length, consult factory.

Mounting: No housing is required, two tensions steel spring clips secure luminaires to the ceiling. Luminaires accept ceiling thicknesses from 3/8" to 5/16". New construction frame-in kits are available, see accessories.

Minimum clearance: "IC" Insulated ceiling housings are direct contact rated; no minimum clearance is required.

ELECTRICAL

Voltage: 120VAC or 120-277VAC
Lumens / Wattage: Up to 950lm / 10.5W
Color Temperature: Selectable CCT (2700K / 3000K / 3500K / 4000K / 5000K)
Color Rendering Index: 90+ CRI
Beam Spread: 115° Wide Flood
Operating Temperature: 0°C to 35°C
Lifetime: 50,000 hours @ L70

Dimming: Dimmable down to 10% with Triac or ELV dimmer
[Click Here](#) or check complete dimmer list at www.NoraLighting.com in the "Compatibility" page under "Resources" tab

OPTIONAL ACCESSORIES

NEFLINTW-4OR-MPW: Oversize Ring
NEFLINTW-EW-4: 4' Quick Connect Linkable Cable
NEFLINTW-EW-20: 20' Quick Connect Linkable Cable
NF-R246: Universal New Construction Frame-In
NFC-R430: New Construction Frame-In with Collar

LABELS AND LISTINGS

- cETLus Listed for Wet location
- ENERGY STAR certified
- Certified to the high efficacy requirements of California Title 24 JA8-2022
- [5-Year Limited Warranty](#)
- FCC Compliant



Type

Project

Catalog No.

Notes

Performance Data

Part Number	Lumens	CCT
NEFLINTW-R4MPW	861lm	2700K
NEFLINTW-R4MPW	894lm	3000K
NEFLINTW-R4MPW	943lm	3500K
NEFLINTW-R4MPW	964lm	4000K
NEFLINTW-R4MPW	966lm	5000K

PRODUCT IMAGES AND DIMENSIONS

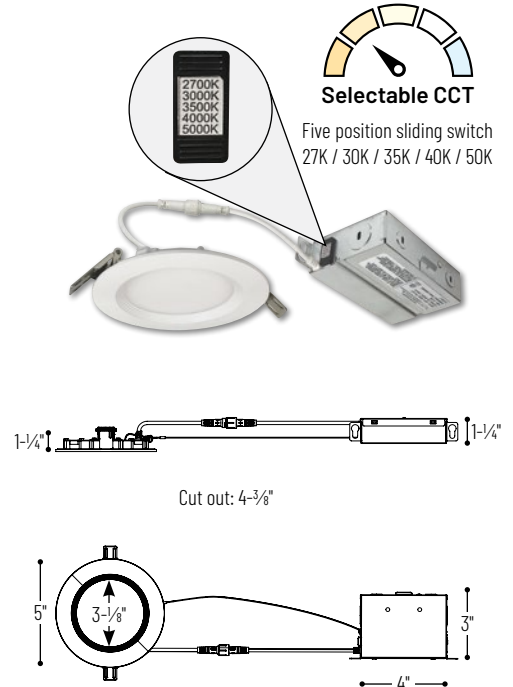

4" E-Series FLIN LED Round Downlight with Selectable CCT

Input Voltage

NEFLINTW-R4MPW = 120V input
NEFLINTW-R4MPWLE4 = 120-277V input

Optional Accessories

Description

NEFLINTW-4OR-MPW = Oversize Ring
NEFLINTW-EW-4 = 4' Quick Connect Extension Cable
NEFLINTW-EW-20 = 20' Quick Connect Extension Cable
NF-R246 = Universal New Construction Frame-In
NFC-R430 = New Construction Frame-In with Collar

NEFLINTW-R4

4" Round E-Series FLIN LED Downlight Accessories

Type	_____
Project	_____
Catalog No.	_____
Notes	_____



Oversize Ring for Round

NEFLINTW-40R-MPW

Oversize ring covers ceiling cut-outs up to 5-1/4"



Quick Connect Extension Cables

NEFLINTW-EW-4 NEFLINTW-EW-20

4'
20'

Use to extend the length between luminaire and driver box. Can be connected together to create custom lengths. Maximum length between luminaire and driver is 40'. For longer remote driver remote run length, consult factory.



Universal New Construction Frame-In NF-R246

Universal new construction frame-in can be used to assist installing can-less recessed downlighting.



New Construction Frame-In with Collar NFC-R430

New construction frame-in can be used to assist installing can-less recessed downlighting.

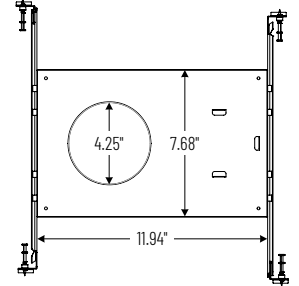
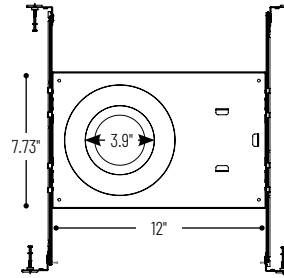

PHOTOMETRICS

4" E-Series FLIN Round LED Downlight with Selectable CCT

Type

Project

Catalog No.

Notes

Test Information

Test Number: NTR1918R1
 Part Number: NEFLINTW-R4MPW
 Beam Spread: 115° Wide Flood
 Lumens: 861lm
 Wattage: 10.12W
 Efficacy: 85lpw
 CCT / CRI: 2700K / 90 CRI
 Spacing Criteria (0°-180°): 1.28
 Spacing Criteria (90°-270°): 1.28

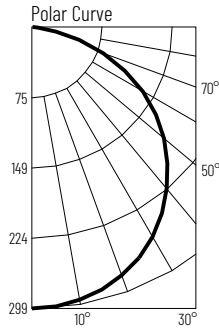

Illuminance at a Distance

Distance from Luminaire	FC at Nadir	Beam Diameter
4'	18.7fc	12'-7"
6'	8.3fc	18'-10"
8'	4.7fc	25'-1"
10'	3fc	31'-5"
12'	2.1fc	37'-8"

Zonal Lumen Summary

Zone	Lumens	% Luminaire
0-30	234	27.1
0-40	384	44.6
0-60	685	79.5
0-90	861	100
90-180	0	0
0-180	861	100

Candela Table

Vertical Angles	Candela
0	299
5	298
15	288
25	270
35	241
45	204

Test Information

Test Number: NTR1919R1
 Part Number: NEFLINTW-R4MPW
 Beam Spread: 115° Wide Flood
 Lumens: 894lm
 Wattage: 9.97W
 Efficacy: 90lpw
 CCT / CRI: 3000K / 90 CRI
 Spacing Criteria (0°-180°): 1.28
 Spacing Criteria (90°-270°): 1.28

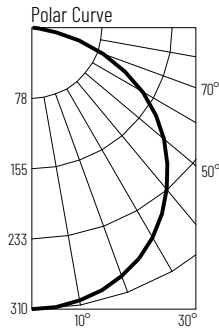

Illuminance at a Distance

Distance from Luminaire	FC at Nadir	Beam Diameter
4'	19.4fc	12'-6"
6'	8.6fc	18'-10"
8'	4.9fc	25'-1"
10'	3.1fc	31'-5"
12'	2.2fc	37'-7"

Zonal Lumen Summary

Zone	Lumens	% Luminaire
0-30	243	27.1
0-40	399	44.6
0-60	711	79.6
0-90	894	100
90-180	0	0
0-180	894	100

Candela Table

Vertical Angles	Candela
0	310
5	309
15	300
25	280
35	251
45	212

Test Information

Test Number: NTR1920R1
 Part Number: NEFLINTW-R4MPW
 Beam Spread: 115° Wide Flood
 Lumens: 943lm
 Wattage: 9.81W
 Efficacy: 96lpw
 CCT / CRI: 3500K / 90 CRI
 Spacing Criteria (0°-180°): 1.28
 Spacing Criteria (90°-270°): 1.28

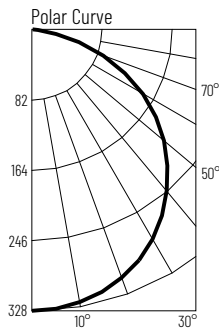

Illuminance at a Distance

Distance from Luminaire	FC at Nadir	Beam Diameter
4'	20.5fc	12'-7"
6'	9.1fc	18'-10"
8'	5.1fc	25'-1"
10'	3.3fc	31'-5"
12'	2.3fc	37'-8"

Zonal Lumen Summary

Zone	Lumens	% Luminaire
0-30	256	27.1
0-40	421	44.6
0-60	751	79.6
0-90	943	100
90-180	0	0
0-180	943	100

Candela Table

Vertical Angles	Candela
0	328
5	327
15	317
25	296
35	264
45	224

Test Information

Test Number: NTR1921R1
 Part Number: NEFLINTW-R4MPW
 Beam Spread: 115° Wide Flood
 Lumens: 964lm
 Wattage: 9.94W
 Efficacy: 97lpw
 CCT / CRI: 4000K / 90 CRI
 Spacing Criteria (0°-180°): 1.28
 Spacing Criteria (90°-270°): 1.28

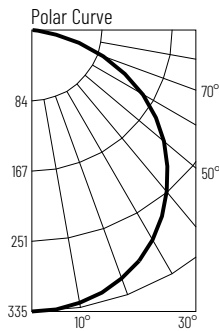

Illuminance at a Distance

Distance from Luminaire	FC at Nadir	Beam Diameter
4'	20.9fc	12'-6"
6'	9.3fc	18'-10"
8'	5.2fc	25'-1"
10'	3.4fc	31'-5"
12'	2.3fc	37'-7"

Zonal Lumen Summary

Zone	Lumens	% Luminaire
0-30	261	27.1
0-40	430	44.6
0-60	766	79.5
0-90	964	100
90-180	0	0
0-180	964	100

Candela Table

Vertical Angles	Candela
0	335
5	333
15	323
25	302
35	270
45	229

Test Information

Test Number: NTR1922R1
 Part Number: NEFLINTW-R4MPW
 Beam Spread: 115° Wide Flood
 Lumens: 966lm
 Wattage: 10.16W
 Efficacy: 95lpw
 CCT / CRI: 5000K / 90 CRI
 Spacing Criteria (0°-180°): 1.28
 Spacing Criteria (90°-270°): 1.28

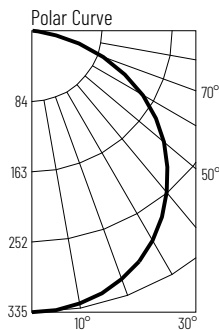

Illuminance at a Distance

Distance from Luminaire	FC at Nadir	Beam Diameter
4'	21fc	12'-6"
6'	9.3fc	18'-10"
8'	5.2fc	25'-1"
10'	3.4fc	31'-5"
12'	2.3fc	37'-7"

Zonal Lumen Summary

Zone	Lumens	% Luminaire
0-30	216	22.4
0-40	361	37.4
0-60	746	77.2
0-90	966	100
90-180	0	0
0-180	966	100

Candela Table

Vertical Angles	Candela
0	335
5	334
15	323
25	302
35	270
45	229

NEFLINTW-R6MPW

6" E-Series FLIN Round LED Downlight with Selectable CCT

Source: 13.5W

Up to 1300lm

PRODUCT DESCRIPTION

E-Series FLIN is a thin recessed LED designed for easy installation into new construction or remodel applications. Luminaires include a selectable color temperature switch located on the junction box of each luminaire with a quick connect that allows for easy disconnect and mounting in the ceiling.

FEATURES

- No housing required and includes junction box with class 2 driver
- Quick installation and cost savings
- Junction box includes kelvin temperature switch
- IC Air-Tight rated
- Field selectable color temperature
- Triac or ELV dimming
- cETLus Listed for Wet Locations
- 5-year limited warranty

SPECIFICATION

Construction: Die-cast aluminum luminaire with spring clips for easy installation. Gasket included for air-tight and wet location listing without additional caulking.

Air Flow Restriction: Luminaire has factory installed gasket to restrict airflow from room into ceiling plenum to <2CFM (cubic feet per minute) in accordance with ASTM E283 Air-Tight requirements.

Lens: Regressed lens with sharp baffle cuts reduces aperture brightness. Special polymer lens produces more usable light and lumens per watt.

Junction Box: Prewired junction box includes quick connect to LED fixtures for ease of installation. Junction box includes two 1/2" trade size and two 3/8" trade size knockouts and snap on cover. Maximum of 4 No. 12 AWG through branch circuit conductor suitable for 90°C permitted in box.

[Fixture wire length: 5" and Junction box wire length: 9"]
Maximum length between luminaire and driver is 40'. For longer remote driver remote run length, consult factory.

Mounting: No housing is required, two tensions steel spring clips secure luminaires to the ceiling. Luminaires accept ceiling thicknesses from 3/8" to 5/16". New construction frame-in kits are available, see accessories.

Minimum clearance: "IC" Insulated ceiling housings are direct contact rated; no minimum clearance is required.

ELECTRICAL

Voltage: 120VAC or 120-277VAC
Lumens / Wattage: Up to 1300lm / 13.5W
Color Temperature: Selectable CCT (2700K / 3000K / 3500K / 4000K / 5000K)
Color Rendering Index: 90+ CRI
Beam Spread: 115° Wide Flood
Operating Temperature: 0°C to 35°C
Lifetime: 50,000 hours @ L70
Dimming: Dimmable down to 10% with Triac or ELV dimmer
[Click Here](#) or check complete dimmer list at www.NoraLighting.com in the "Compatibility" page under "Resources" tab

OPTIONAL ACCESSORIES

NEFLINTW-60R-MPW: Oversize Ring
NF-R246: Universal New Construction Frame-In
NEFLINTW-EW-4: 4' Quick Connect Linkable Cable
NEFLINTW-EW-20: 20' Quick Connect Linkable Cable

LABELS AND LISTINGS

- cETLus Listed for Wet location
- ENERGY STAR certified
- Certified to the high efficacy requirements of California Title 24 JA8-2022
- [5-Year Limited Warranty](#)
- FCC Compliant



Type

Project

Catalog No.

Notes

Performance Data		
Part Number	Lumens	CCT
NEFLINTW-R6MPW	1199lm	2700K
NEFLINTW-R6MPW	1220lm	3000K
NEFLINTW-R6MPW	1289lm	3500K
NEFLINTW-R6MPW	1306lm	4000K
NEFLINTW-R6MPW	1323lm	5000K

PRODUCT IMAGES AND DIMENSIONS

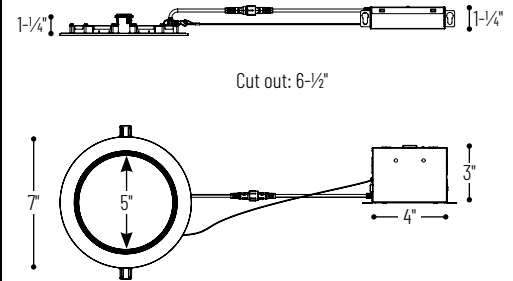
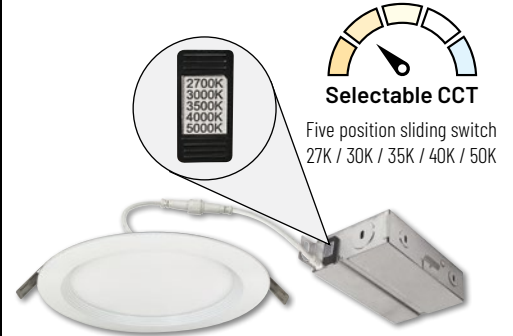

6" E-Series FLIN LED Round Downlight with Selectable CCT

Input Voltage

NEFLINTW-R6MPW = 120V input
 NEFLINTW-R6MPWLE4 = 120-277V input

Optional Accessories

Description

NEFLINTW-60R-MPW = Oversize Ring
 NF-R246 = Universal New Construction Frame-In
 NEFLINTW-EW-4 = 4' Quick Connect Extension Cable
 NEFLINTW-EW-20 = 20' Quick Connect Extension Cable

NEFLINTW-R6MPW

6" E-Series FLIN LED Downlight Accessories

Type _____

Project _____

Catalog No. _____

Notes _____



Oversize Ring for Round

NEFLINTW-60R-MPW

Oversize ring covers ceiling cut-outs up to 7-1/4"



Quick Connect Extension Cables

NEFLINTW-EW-4 NEFLINTW-EW-20

4'
20'

Use to extend the length between luminaire and driver box. Can be connected together to create custom lengths. Maximum length between luminaire and driver is 40'. For longer remote driver remote run length, consult factory.



Universal New Construction Frame-In

NF-R246

Universal new construction frame-in can be used to assist installing can-less recessed downlighting.

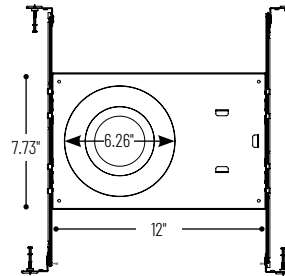

PHOTOMETRICS

6" E-Series FLIN Round LED Downlight with Selectable CCT

Type

Project

Catalog No.

Notes

Test Information

Test Number: NTR1923R1
 Part Number: NEFLINTW-R6MPW
 Beam Spread: 115° Wide Flood
 Lumens: 1199lm
 Wattage: 13.8W
 Efficacy: 87lpw
 CCT / CRI: 2700K / 90 CRI
 Spacing Criteria (0°-180°): 1.28
 Spacing Criteria (90°-270°): 1.28

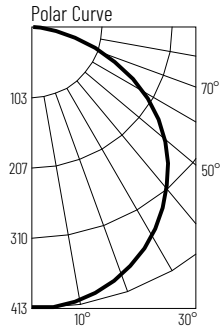

Illuminance at a Distance

Distance from Luminaire	FC at Nadir	Beam Diameter
4'	25.7fc	12'-6"
6'	11.4fc	18'-10"
8'	6.4fc	25'
10'	4.1fc	31'-4"
12'	2.9fc	37'-6"

Zonal Lumen Summary

Zone	Lumens	% Luminaire
0-30	266	22.2
0-40	444	37
0-60	921	76.8
0-90	1199	100
90-180	0	0
0-180	1199	100

Candela Table

Vertical Angles	Candela
0	411
5	408
15	395
25	370
35	331
45	282

Test Information

Test Number: NTR1924R1
 Part Number: NEFLINTW-R6MPW
 Beam Spread: 115° Wide Flood
 Lumens: 1220lm
 Wattage: 13.68W
 Efficacy: 89lpw
 CCT / CRI: 3000K / 90 CRI
 Spacing Criteria (0°-180°): 1.28
 Spacing Criteria (90°-270°): 1.28

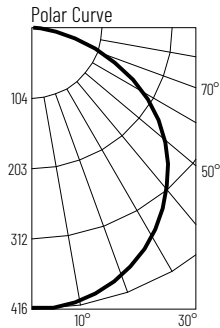

Illuminance at a Distance

Distance from Luminaire	FC at Nadir	Beam Diameter
4'	25.9fc	12'-10"
6'	11.5fc	19'-2"
8'	6.5fc	25'-8"
10'	4.2fc	32'-1"
12'	2.9fc	38'-6"

Zonal Lumen Summary

Zone	Lumens	% Luminaire
0-30	268	22
0-40	449	36.8
0-60	934	76.6
0-90	1220	100
90-180	0	0
0-180	1220	100

Candela Table

Vertical Angles	Candela
0	415
5	412
15	399
25	374
35	336
45	288

Test Information

Test Number: NTR1925R1
 Part Number: NEFLINTW-R6MPW
 Beam Spread: 115° Wide Flood
 Lumens: 1289lm
 Wattage: 13.37W
 Efficacy: 96lpw
 CCT / CRI: 3500K / 90 CRI
 Spacing Criteria (0°-180°): 1.28
 Spacing Criteria (90°-270°): 1.28

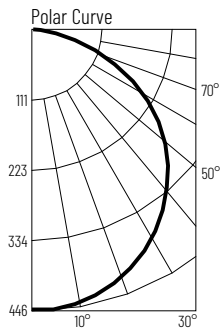

Illuminance at a Distance

Distance from Luminaire	FC at Nadir	Beam Diameter
4'	27.7fc	12'-6"
6'	12.3fc	18'-8"
8'	6.9fc	24'-11"
10'	4.4fc	31'-2"
12'	3.1fc	37'-5"

Zonal Lumen Summary

Zone	Lumens	% Luminaire
0-30	286	22.2
0-40	478	37.1
0-60	991	76.9
0-90	1289	100
90-180	0	0
0-180	1289	100

Candela Table

Vertical Angles	Candela
0	442
5	439
15	425
25	398
35	357
45	303

Test Information

Test Number: NTR1926R1
 Part Number: NEFLINTW-R6MPW
 Beam Spread: 115° Wide Flood
 Lumens: 1306lm
 Wattage: 13.43W
 Efficacy: 97lpw
 CCT / CRI: 4000K / 90 CRI
 Spacing Criteria (0°-180°): 1.28
 Spacing Criteria (90°-270°): 1.28

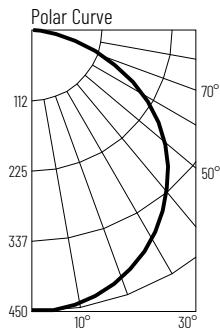

Illuminance at a Distance

Distance from Luminaire	FC at Nadir	Beam Diameter
4'	28fc	12'-6"
6'	12.5fc	18'-10"
8'	7fc	25'-1"
10'	4.5fc	31'-4"
12'	3.1fc	37'-7"

Zonal Lumen Summary

Zone	Lumens	% Luminaire
0-30	290	22.2
0-40	484	37.1
0-60	1004	76.9
0-90	1306	100
90-180	0	0
0-180	1306	100

Candela Table

Vertical Angles	Candela
0	449
5	445
15	431
25	403
35	361
45	308

Test Information

Test Number: NTR1927R1
 Part Number: NEFLINTW-R6MPW
 Beam Spread: 115° Wide Flood
 Lumens: 1323lm
 Wattage: 13.82W
 Efficacy: 96lpw
 CCT / CRI: 5000K / 90 CRI
 Spacing Criteria (0°-180°): 1.28
 Spacing Criteria (90°-270°): 1.28

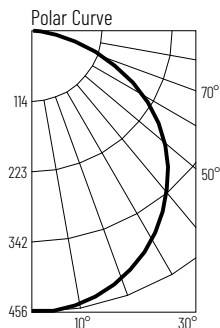

Illuminance at a Distance

Distance from Luminaire	FC at Nadir	Beam Diameter
4'	28.4fc	12'-6"
6'	12.6fc	18'-8"
8'	7.1fc	25'
10'	4.6fc	31'-2"
12'	3.2fc	37'-6"

Zonal Lumen Summary

Zone	Lumens	% Luminaire
0-30	356	26.9
0-40	586	44.3
0-60	1048	79.2
0-90	1323	100
90-180	0	0
0-180	1323	100

Candela Table

Vertical Angles	Candela
0	455
5	452
15	437
25	410
35	367
45	312