

## T8 TUBE INSTALL GUIDE

- Direct Install Type AB & Direct Wire Tube Light

### WARNING:

- Turn power off before inspection, installation, or removal.
- Risk of electric shock - Don't use where exposed to water or weather.
- Do not open – no user serviceable parts inside.
- Not intended with emergency exit luminaires or emergency exit lights.

### CAUTION AND NOTICES:

- Continuous arcing generates high temperature that can melt socket plastic or tube cap.
- Continuous arcing damages LED driver circuit.
- Installed by licensed electrician.
- Test sample before mass installation.



#### PLUG AND PLAY INSTALL

BEFORE LED TUBE INSTALLATION

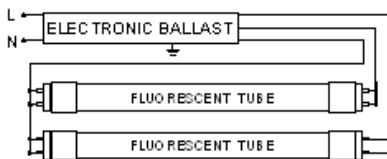

AFTER LED TUBE INSTALLATION

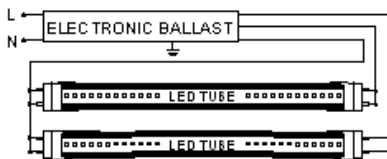

#### DOUBLE END POWER IN

BEFORE LED TUBE INSTALLATION

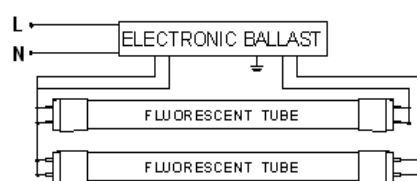

AFTER LED TUBE INSTALLATION

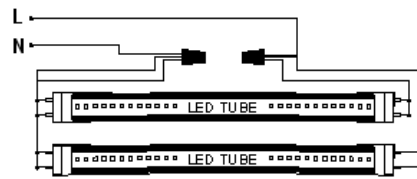

#### SINGLE END POWER IN

CUT WIRES AS SHOWN IN THE DIAGRAM

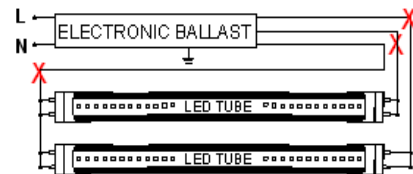

MAKE THE NEW WIRES CONNECT TO THE BRANCH CIRCUIT

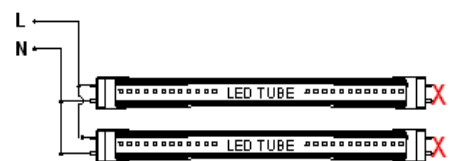

YOU CAN USE EITHER END TO MAKE SINGLE ENDED CONNECTION

\*NANO T8N TUBE CAN BE SINGLE ENDED AT LABEL END ONLY.

- \* For one ballast by three fluorescent tube fixture, put at least TWO units of ballast compatible LED tubes on.
- \* For one ballast by four fluorescent tube fixture, put at least THREE units of ballast compatible LED tubes on.
- \* Safety Warning Label (packed in box) must be applied to fixture interior to inform of modification at direct wire mode.

## DIMMING FUNCTION USER MANUAL:

A. Type A dimming function: works with dimming ballast and related dimmer.

B. Type B ordinary mode: works as either single end power in (SEP) OR double end power in (DEP).

1. Switch off power before the tube is installed in fixture;
2. Twist the T8 tube into fixture and switch "ON": tube will be at 100% lumen output as the default.

C. Type B dimming function at LOWEST lumen: either single power in (SEP) OR double end power in (DEP).

1. Switch off power and twist the T8 tube into fixture.

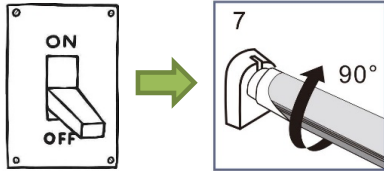

2. Switch "ON-OFF-ON" in 1.0-5.0 second intervals; tube lumen starts dimming from 100% down to 10% and stay on 10% lumen;

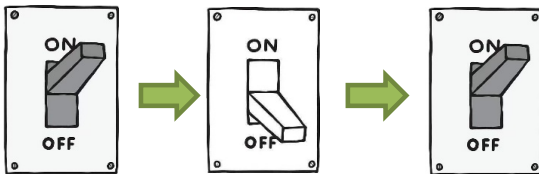

D. Type B dimming function at a selected lumen level: either single power in (SEP) OR double end power in (DEP).

1. Switch off power and twist the T8 tube into fixture;

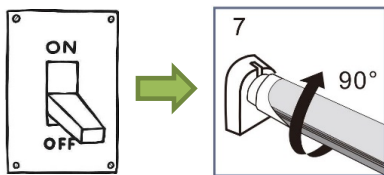

2. Switch "ON-OFF-ON" in 1.0-5.0 second intervals, tube lumen starts dimming down from 100%, switch "OFF-ON" until desired lumen level is reached.

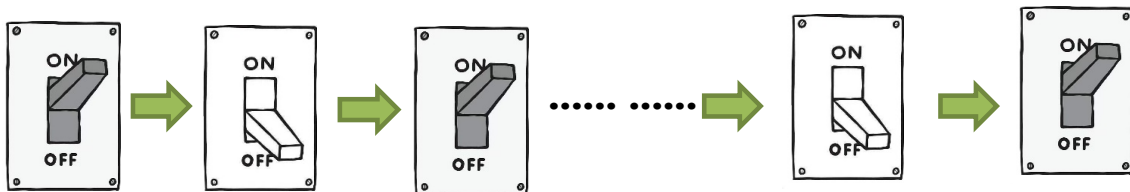

3. Repeat steps "1-2" on each fixture to select desired lumen level.

## ATTENTION:

This product has a warranty for a period of 5 years from the date of purchase. Warranty is invalid in the case of improper installation, tampering, or removal of the Q.C. date. Installation in an improper working environment or installation not according to the current edition of the National Electric Code also invalidates the warranty. If this product fails during the warranty period, it will be replaced free of charge, subject to correct installation and return of the faulty unit. We do not take responsibility for any installation costs associated with the replacement of this product. This warranty is an addition to the statutory rights in the country of purchase. We reserve the right to alter specifications without prior notice.