

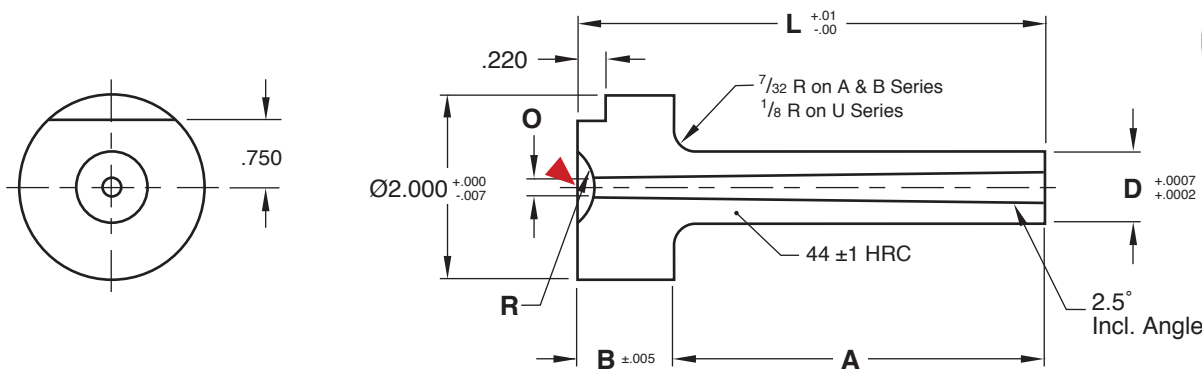

SPRUE BUSHINGS

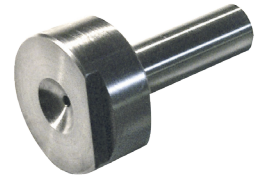

B Series $D=\text{Ø}1.000$ $B=.875$

M AISI 6150 **H** 43-45 HRC

A	L	O=5/32		O=7/32		O=9/32		O=11/32		NO HOLE	
		R=1/2	R=3/4	R=1/2	R=3/4	R=1/2	R=3/4	R=1/2	R=3/4	R=1/2	R=3/4
29/32	1-25/32	SPRB1-512	SPRB1-534	SPRB1-712	SPRB1-734	SPRB1-912	SPRB1-934	SPRB1-112	SPRB1-134	—	—
1-13/32	2-9/32	SPRB2-512	SPRB2-534	SPRB2-712	SPRB2-734	SPRB2-912	SPRB2-934	SPRB2-112	SPRB2-134	—	—
1-29/32	2-25/32	SPRB3-512	SPRB3-534	SPRB3-712	SPRB3-734	SPRB3-912	SPRB3-934	SPRB3-112	SPRB3-134	—	—
2-13/32	3-9/32	SPRB4-512	SPRB4-534	SPRB4-712	SPRB4-734	SPRB4-912	SPRB4-934	SPRB4-112	SPRB4-134	—	—
2-29/32	3-25/32	SPRB5-512	SPRB5-534	SPRB5-712	SPRB5-734	SPRB5-912	SPRB5-934	SPRB5-112	SPRB5-134	SPRB5-N12	SPRB5-N34
3-13/32	4-9/32	SPRB6-512	SPRB6-534	SPRB6-712	SPRB6-734	SPRB6-912	SPRB6-934	SPRB6-112	SPRB6-134	—	—
3-29/32	4-25/32	SPRB7-512	SPRB7-534	SPRB7-712	SPRB7-734	SPRB7-912	SPRB7-934	SPRB7-112	SPRB7-134	—	—
4-13/32	5-9/32	SPRB8-512	SPRB8-534	SPRB8-712	SPRB8-734	SPRB8-912	SPRB8-934	SPRB8-112	SPRB8-134	—	—
4-29/32	5-25/32	SPRB9-512	SPRB9-534	SPRB9-712	SPRB9-734	SPRB9-912	SPRB9-934	SPRB9-112	SPRB9-134	SPRB9-N12	SPRB9-N34
5-29/32	6-25/32	—	—	SPRB10-712	SPRB10-734	SPRB10-912	SPRB10-934	—	—	—	—
6-29/32	7-25/32	—	—	SPRB11-712	SPRB11-734	SPRB11-912	SPRB11-934	SPRB11-112	SPRB11-134	SPRB11-N12	SPRB11-N34

▶ CAD insertion point

A Series $D=\text{Ø}1.000$ $B=.625$

A	L	O=5/32		O=7/32		O=9/32		O=11/32		NO HOLE	
		R=1/2	R=3/4	R=1/2	R=3/4	R=1/2	R=3/4	R=1/2	R=3/4	R=1/2	R=3/4
1-3/16	1-13/16	SPRA1-512	SPRA1-534	SPRA1-712	SPRA1-734	SPRA1-912	SPRA1-934	SPRA1-112	SPRA1-134	—	—
1-11/16	2-5/16	SPRA2-512	SPRA2-534	SPRA2-712	SPRA2-734	SPRA2-912	SPRA2-934	SPRA2-112	SPRA2-134	—	—
2-3/16	2-13/16	SPRA3-512	SPRA3-534	SPRA3-712	SPRA3-734	SPRA3-912	SPRA3-934	SPRA3-112	SPRA3-134	SPRA3-N12	SPRA3-N34
2-11/16	3-5/16	SPRA4-512	SPRA4-534	SPRA4-712	SPRA4-734	SPRA4-912	SPRA4-934	SPRA4-112	SPRA4-134	—	—
3-3/16	3-13/16	SPRA5-512	SPRA5-534	SPRA5-712	SPRA5-734	SPRA5-912	SPRA5-934	SPRA5-112	SPRA5-134	—	—
3-11/16	4-5/16	SPRA6-512	SPRA6-534	SPRA6-712	SPRA6-734	SPRA6-912	SPRA6-934	SPRA6-112	SPRA6-134	—	—
4-3/16	4-13/16	SPRA7-512	SPRA7-534	SPRA7-712	SPRA7-734	SPRA7-912	SPRA7-934	SPRA7-112	SPRA7-134	SPRA7-N12	SPRA7-N34

U Series $D=\text{Ø}.750$ $B=.875$

A	L	O=5/32		O=7/32		O=9/32		NO HOLE	
		R=1/2	R=3/4	R=1/2	R=3/4	R=1/2	R=3/4	R=1/2	R=3/4
29/32	1-25/32	SPRU1-512	SPRU1-534	SPRU1-712	SPRU1-734	SPRU1-912	SPRU1-934	—	—
1-13/32	2-9/32	SPRU2-512	SPRU2-534	SPRU2-712	SPRU2-734	SPRU2-912	SPRU2-934	—	—
1-29/32	2-25/32	SPRU3-512	SPRU3-534	SPRU3-712	SPRU3-734	SPRU3-912	SPRU3-934	SPRU3-N12	SPRU3-N34
2-13/32	3-9/32	SPRU4-512	SPRU4-534	SPRU4-712	SPRU4-734	SPRU4-912	SPRU4-934	—	—
2-29/32	3-25/32	SPRU5-512	SPRU5-534	SPRU5-712	SPRU5-734	SPRU5-912	SPRU5-934	SPRU5-N12	SPRU5-N34

Notes: For Hot Sprue Bushings, refer to page K-8.
For custom sized Sprues, refer to templates in section X.