

ADJUSTABLE HEX NIPPLES

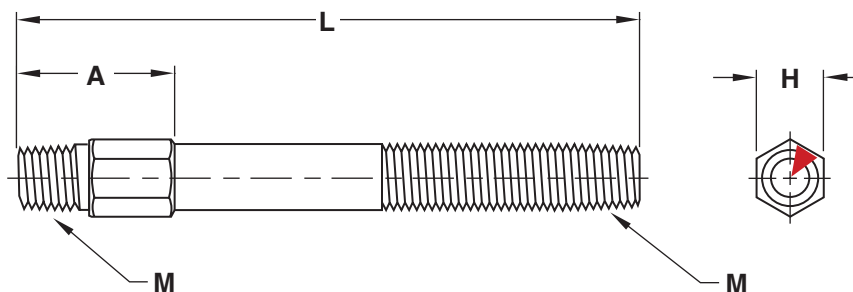

M Brass

CATALOG NUMBER	M Pipe NPT	A	H Hex Size	Available Overall Lengths (L)								
				2.5	4	5.5	7	8.5	10	11.5	13	
APN06	1/16	.68	3/8	•	•	•	•	•	•	•	•	•
APN12	1/8	.75	7/16	•	•	•	•	•	•	•	•	•
APN25	1/4	.87	9/16	•	•	•	•	•	•	•	•	•
APN37	3/8	1.00	11/16	•	•	•	•	•	•	•	•	•
APN50	1/2	1.37	7/8	•	•	•	•	•	•	•	•	•

▶ CAD insertion point

To Order:

- Specify prefix and length. Ex APN50L11.5.

Alternative configurations and materials available:

- For Hex Nipples manufactured from stainless steel, add an "-SS" to the end of the catalog number. Ex. APN25L7-SS or APN50L4-SS
- Hex Nipples can be ordered cut to any length, in any quantity. Specify the catalog number (for brass or stainless steel) with required length. Ex. APN25L6.25 or APN37L5.75-SS

HEX KEY EXTENSION PIPES

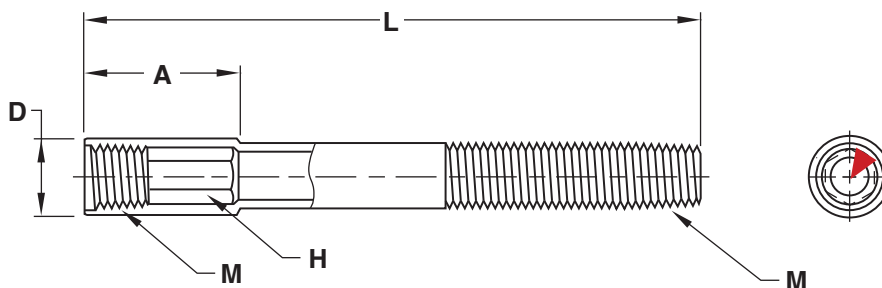

M Brass

CATALOG NUMBER	M Pipe NPT	A	D	H Hex Size	Available Overall Lengths (L)				
					2.5	4	5.5	7	8.5
HKEPN12	1/8	.75	.50	1/4	•	•	•	•	•
HKEPN25	1/4	1.00	.69	3/8	•	•	•	•	•
HKEPN37	3/8	1.25	.81	1/2	•	•	•	•	•
HKEPN50	1/2	1.50	1.00	9/16	•	•	•	•	•

▶ CAD insertion point

To Order:

- Specify prefix and length. Ex. HKEPN12L2.5

Alternative configurations and materials available:

- Hex Key Extension Pipes can be ordered cut to any length in any quantity. Specify the catalog prefix with required length. Ex. HKEPN25L6.25