

Instructions

Wall Mounted Headboard - Zip and Link

HEADBOARDS LTD
headboards.co.uk

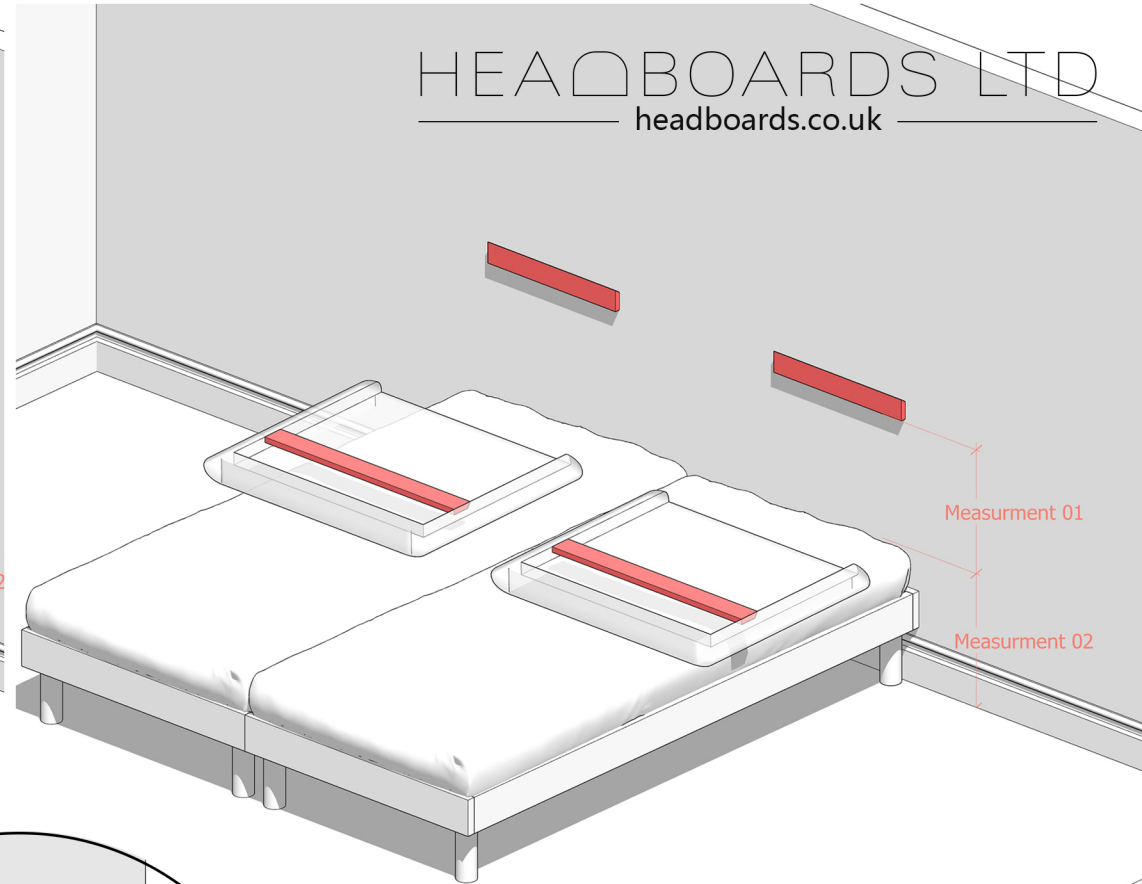
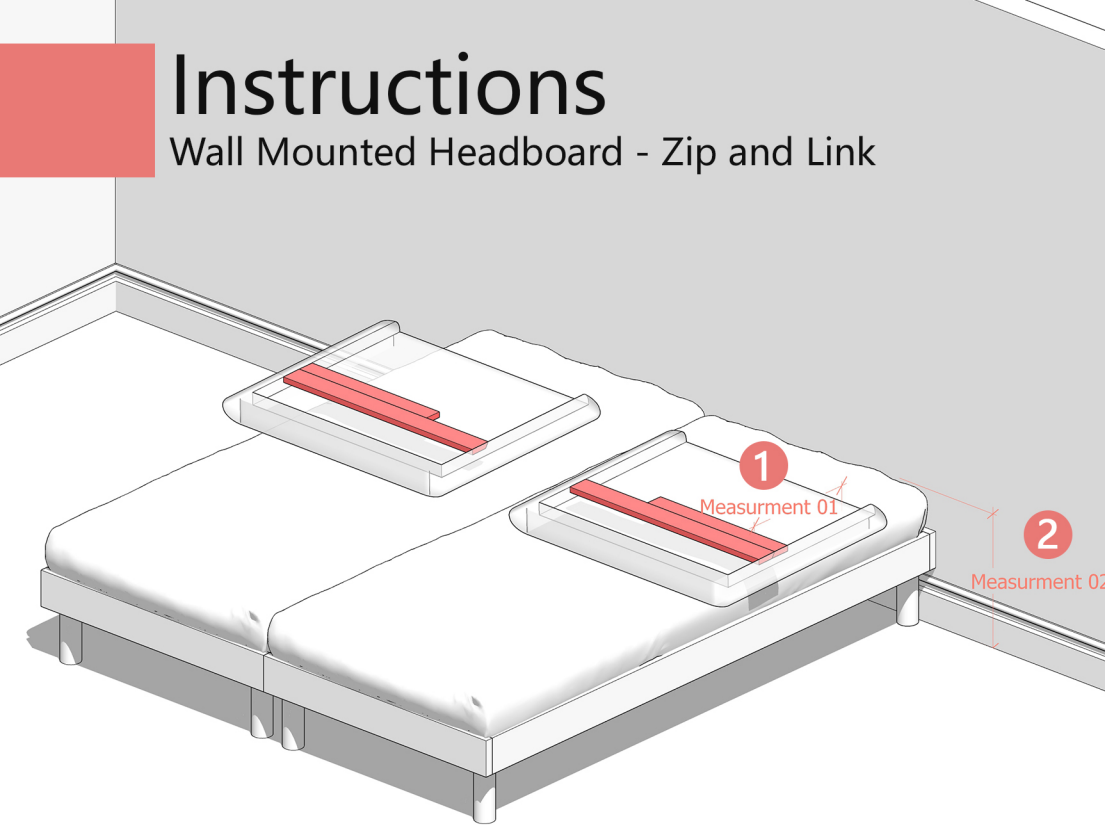

Step 01 : Measure Distance

Measurement 01 : Bottom of the headboard to the bottom of the 45° wall-mounted baton.

Measurement 02 : Floor to the top of the mattress.

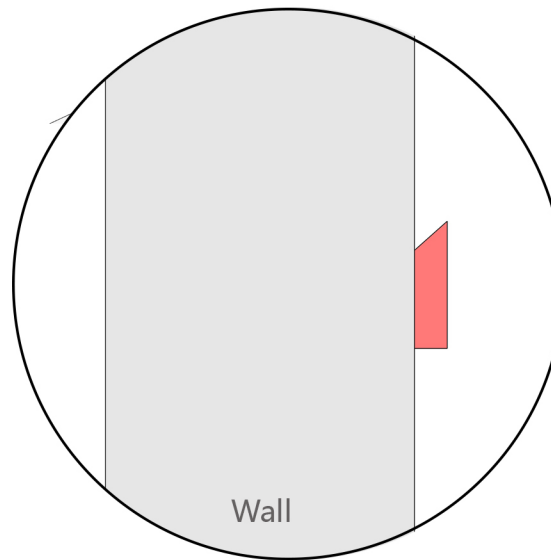

Step 02: Attach Wall-mounted Baton

Mark the measurement 01 on the wall and attach the 45° wall-mounted baton by using provided fixing attachment.

Keep the angle direction shown as in the picture.

Place the both baton at extreme end to slide maximum.



Double Bed Setup

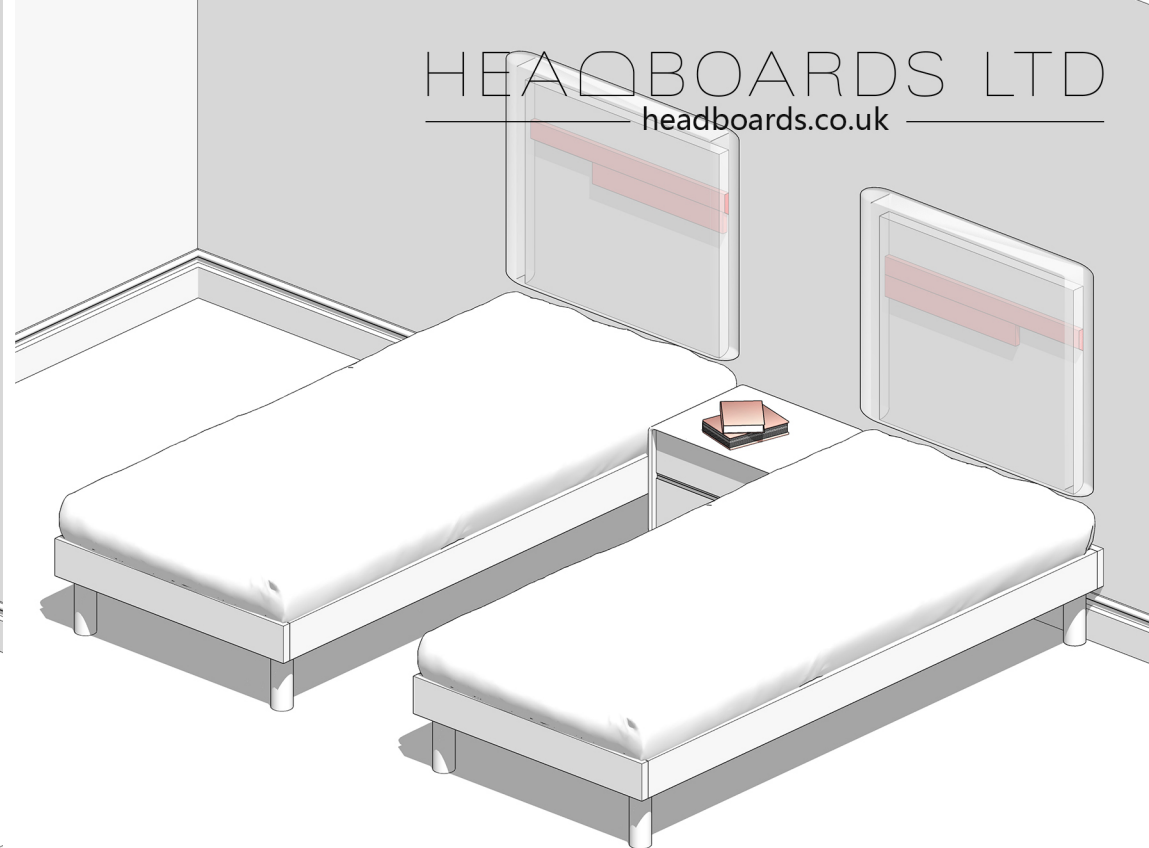

Two Single Setup

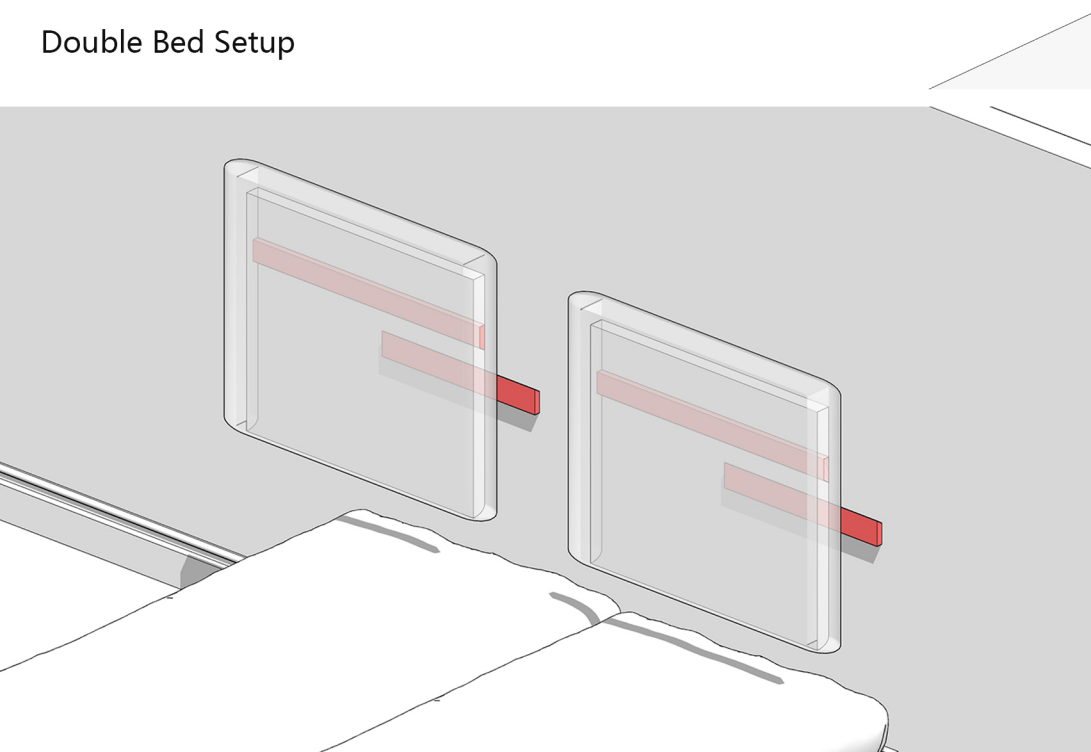

Step 03: Attach Headboard

Attach the headboard over the wall mounted Baton.

You can slide your headboard over the baton in order to align Headboard and Bed in both setup.