



# MIMOSA<sup>®</sup>

THE SIGNATURE COLLECTION



## UPRIGHT BLACK OUTDOOR FIREPLACE



- Provides warmth and ambiance for outdoor settings
- For use with timber fuel
- Easy assembly

ITEM NO.  
0229114  
MADE IN  
CHINA

INFORMATION

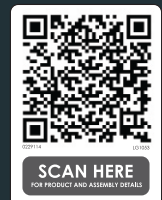

Important: Please retain these instructions for future use

# Contents

Thank you .....	Page 1
Safety Warnings .....	Page 2
Parts List .....	Page 3
Assembly Instructions .....	Page 4
Operating Instructions .....	Page 8
Location .....	Page 9
Care and Maintenance.....	Page 9
Product Warranty .....	Page 10

# Thank you

Congratulations on the purchase of this product, and thank you for making it a member of your household. The creators of this product strive to provide excellent products at affordable prices. You can rest assured that all our products are manufactured to high standards of safety and quality, backed by a 12 month warranty. A lot of thought and development goes into all of our products, and we truly hope you are satisfied with your purchase.

# Safety Warnings

- **Outdoor use only. DO NOT use the fireplace indoors.**
- DO NOT position this product on a timber deck or any combustible surfaces.
- DO NOT leave the fireplace unattended during use.
- Remove bark, dried leaves and twigs well clear of this product prior to use.
- Carbon Monoxide Warning. Carbon monoxide is produced whenever solid fuels are burnt. To avoid poisoning or death, never use this product indoors, and never move this product indoors when it contains hot coals.
- The chimney must not be located below overhead construction such as a covered patio or alfresco ceiling.
- When in use, all surfaces of the fireplace will get hot. Do not touch the fireplace during use.
- Do NOT allow children or pets near the fireplace during use.
- Ensure your fireplace is positioned on a level surface and positioned at least 2 metres distance from any side or overhead combustible materials. E.g. house, fence, deck, trees, etc.
- DO NOT overload the fireplace with fuel. It may result in product failure, failure to contain hot coals and property damage.
- DO NOT use highly flammable chemicals such as petrol or spirits to light the fire or relight the fire.
- DO NOT use in windy conditions.
- DO NOT store or use flammables in the vicinity of the fireplace.
- CAUTION: Use gloves when removing the door as the handles may be hot.

# Parts List



Part A Qty.1  
FIREPLACE



Part B Qty.1  
CHIMNEY

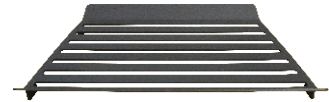

Part C Qty.1  
GRATE



Part D Qty.1  
ASH TRAY



Part E Qty.1  
BRACE



Part F Qty.1  
FLUE TERMINAL



Part G Qty.1  
COVER DOOR



Part H Qty.2  
INSULATOR



Part I Qty.1  
HANDLE



Part J Qty.6  
BOLT



Part K Qty.2  
HANDLE BOLT



Part L Qty.1  
ALLEN KEY

# Assembly Instructions

An allen key has been provided to assist with assembly.



We recommend wearing gloves during assembly to prevent injuries from sharp edges.

**Step 1:**  
Insert the chimney through front of fireplace, and up through hole in the top.  
Fasten chimney with the bolts.

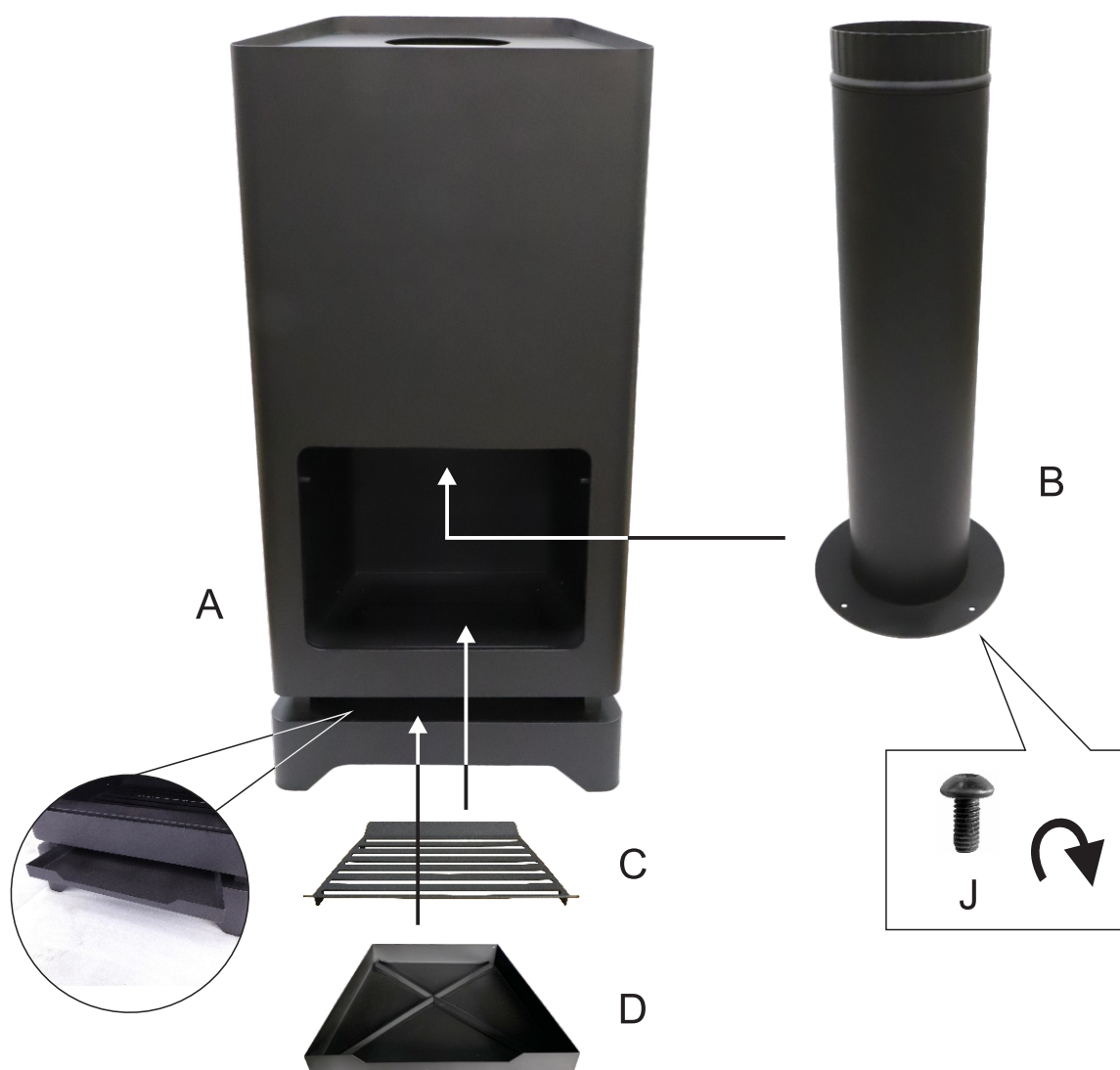

**Step 2:**  
Place the ash tray and the grate in position as shown by the arrows above.

# Assembly Instructions

## Step 3:

Push the flue terminal onto the top of the chimney.



## Step 4:

Fix the brace with the bolts.

# Assembly Instructions

Step 5:  
Assemble the insulators and  
handle onto the cover door.

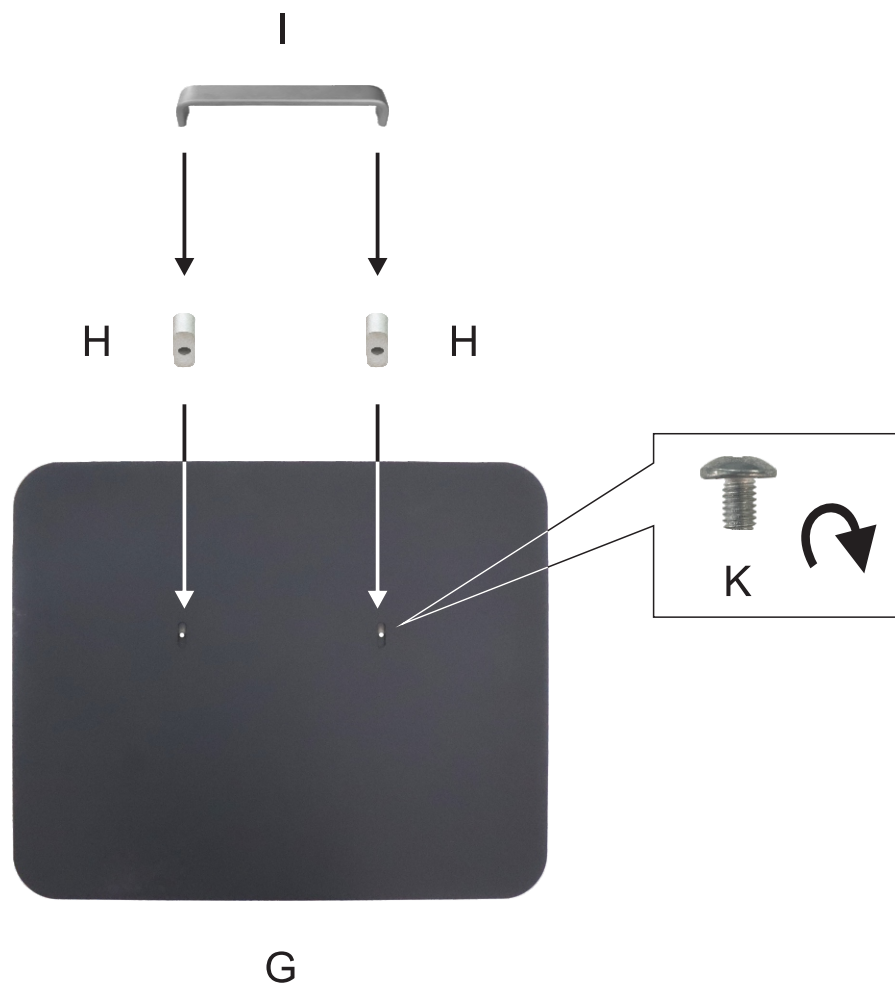



# Assembly Instructions

Step 6:  
Locate the cover door  
onto the fire place.



Fully assembled.



# Operating Instructions

## Preparation

1. To get the fire started, you will need material that can be readily ignited or kindling and you will need firewood to fuel the fire.
2. Gather these materials before attempting to light the fire so you are prepared.
3. If the available firewood is too large, cut, trim or split the firewood to fit in the fireplace without overhang.
4. Don't overload the fireplace. As a general rule, the maximum fuel load is half the area of the grate.
5. Don't arrange the fuel in tight bunches. Allow space between the firewood pieces to ensure good air movement in the fire.

## Lighting

We recommend using the door after ignition to make getting your fire started easier.

**CAUTION: Use gloves when removing the door as the handles may be hot.**

1. Place a layer of dry kindling such as sticks or twigs. You can also use firelighters.
2. Place a small amount of firewood directly above the kindling.
3. Use a long match or a gas lighter to light the kindling.

## Maintaining the Fire

- Wear oven mitts or protective gloves when tending to the fire.
- After the fire has been established, add more firewood directly on top of the fire as desired but do this gradually to avoid overloading.
- Use a poker to reposition coals and improve airflow as desired.
- Never pour Petrol, Kerosene, Diesel, lighter fluid or alcohol onto the fireplace.

## Extinguishing

Allow the fire to burn out. Do not douse the fire with water, the sudden temperature change can cause immediate damage to the fireplace.

# Operating Instructions

## Location

Ensure to position the fireplace outdoors, and well clear of any openings into the home such as windows, vents or ducts.

Flue can be extended (for improved air draw and more remote smoke outlet) by using standard 6" flue extensions.

## When to use the Door

Always wear gloves when handling the door.

Mount the door on the fireplace during windy conditions or to reduce radiant heat directly in front of the fire during use.

When the fireplace is not in use, mount the door on the unit to prevent ash being blown around your yard.

## Care and Maintenance

Allow the fireplace to cool before cleaning.

Always empty the residual ash after each use.

To extend the life of your fireplace, protect it from the elements when not in use.

The use of harsh, chemical cleaners or rough scourers can severely damage the external surfaces of your fireplace. Only use soap and water during cleaning and allow the surfaces to dry after cleaning to prevent excessive corrosion.

Do not clean this fireplace with a high pressure washer or steam cleaner.

If your fireplace has a pre-rusted exterior, don't apply any coatings or rust preventative sprays because they will damage the rusted aesthetic.

## Rust Prevention

Where fire and steel interact, rust will eventually appear due to the extreme heat of the fire. If you want to minimise rust in your fireplace, you may use a light oil or rust preventative spray to reduce rusting when the fireplace not in use however, these oils and sprays are flammable so any oil or rust preventative spray must be cleaned off before the next use.

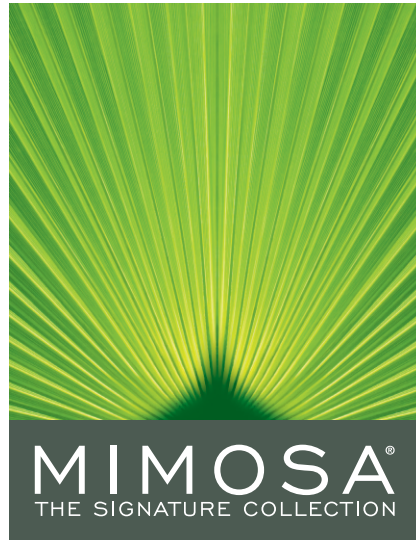

---

## PRODUCT WARRANTY

---

Any claim under this warranty must be made within 12 Months of the date of purchase of the product. To make a claim under the warranty, take the product (with proof of purchase) to any Bunnings store (see [www.bunnings.com.au](http://www.bunnings.com.au) or [bunnings.co.nz](http://bunnings.co.nz) for store locations)

Bunnings Group Ltd bears reasonable, direct, expenses of claiming under the warranty. You may submit details and proof to our store for consideration.

The warranty covers manufacturer defects in materials, workmanship and finish under normal use.

This warranty is provided in addition to other rights and remedies you may have under law: our goods come with guarantees which cannot be excluded under the Australian Consumer Law or Consumer Guarantees Act 1993 (NZ). You are entitled to replacement or refund for a major failure and to compensation for other reasonably foreseeable loss or damage. You are also entitled to have the goods repaired or replaced if the goods fail to be of acceptable quality and the failure does not amount to a major failure.

The warranty excludes damage resulting from product misuse or product neglect. The warranty covers domestic use only and does not apply to commercial applications.

This warranty is given by Bunnings Group Limited ABN 26 008 672 179, Botanicca 3 Level 2 East Tower 570 Swan Street, Burnley, VIC 312, e-mail:

[CustomerSupport@bunnings.com.au](mailto:CustomerSupport@bunnings.com.au)

Or call our Customer Support Team – Ph.1800 797 586

This warranty is given by Bunnings NZ Limited: Postal address: PO Box 14436, Panmure, Auckland 1741,

e-mail: [OnlineEnquiries@bunnings.co.nz](mailto:OnlineEnquiries@bunnings.co.nz) Or call our Customer Support Team – [Ph.1800 797 586](tel:1800797586)