

INSTALL INSTRUCTIONS C-VS-2300-CHGR

23" Vehicle Specific Console for 2021-2022 Dodge Charger (Police Package)

TOOLS REQUIRED:

Phillips Screw Driver
7/16 wrench

Socket set (Standard & Metric)
T-20 Torx Bit

Wire Cutters / Crimping tool

PARTS and MOUNTING HARDWARE:

<u>QTY</u>	<u>DESCRIPTION</u>	<u>PART#</u>
1	ESP module cover plate	11209
1	DS forward trim panel	23226
1	PS forward trim panel	23227
1	O ring	23537
1	7/8" Dome plug	13401
2	M6 nut	16104
2	1/4" x 1" Fender washer	16130
3	1/4" x 3/4" Lag bolt	16359
6	#8 x 3/8" Torx screw	16425

Always!

- Read all instructions before installing any Havis, Inc. products.
 - Use hardware provided with install kit

C-VS-2300-CHGR

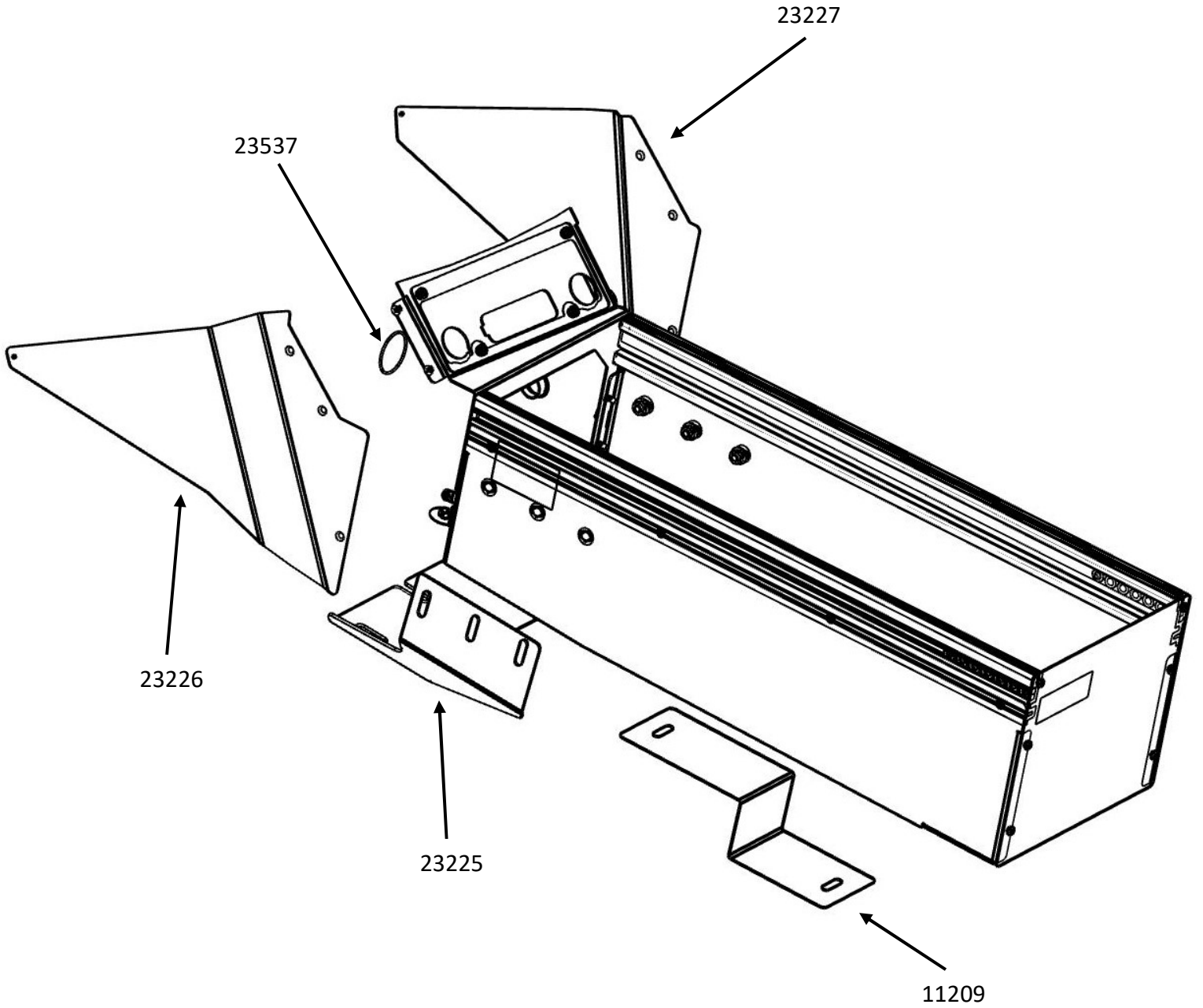



Remove bolts that hold underside of extrusion to rear floor bracket. Remove rear floor bracket bolts and center console bolt. (10mm).

NOTE: previous generation console shown.



Remove OEM plastic center console



Remove sensor and 12 volt socket wire harness assembly from under side of OEM console.

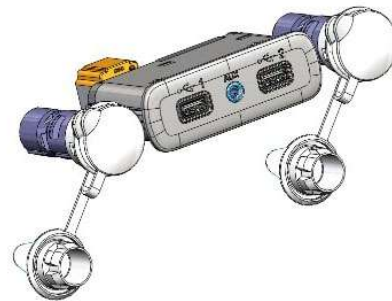

Remove OEM Media Hub and Accessory Power outlets (APO's / 12 volt sockets)

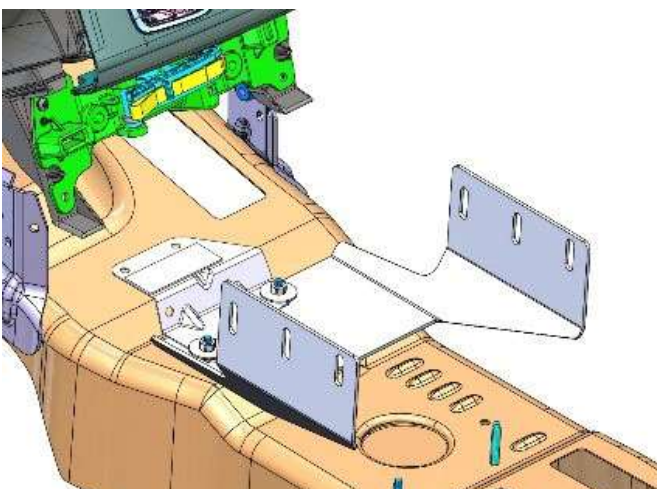

Attach lower mounting bracket from console to OEM studs. Ignition key sense module bracket goes over the supplied bracket. Loosely tighten using previously removed OEM nuts.

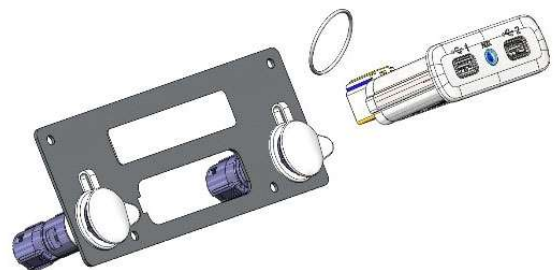

Place supplied rubber "O" ring onto the OEM module. Push ring all the way on then firmly insert into the center section of the front panel. The OEM APO's are then inserted into their designated spots.

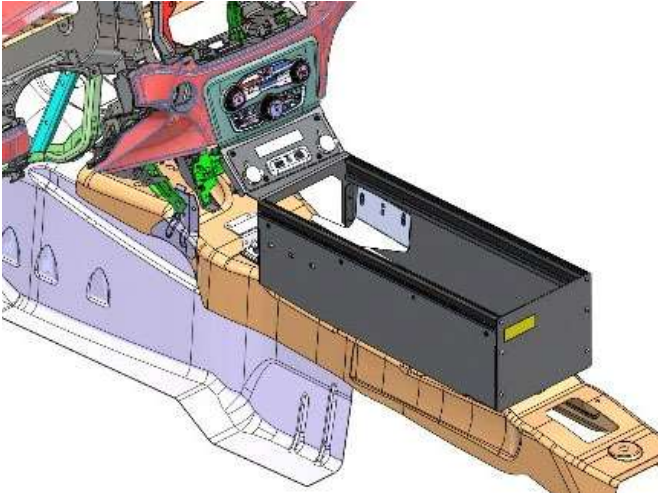

Slide main console housing onto floor bracket. Plug OEM wire harness back onto original connectors and into repositioned OEM equipment.



Use $\frac{1}{4}$ x $\frac{3}{4}$ " self-threading screws to loosely attach the rear of the console to existing floor inserts. Inserts located under rubber floor mat as shown.

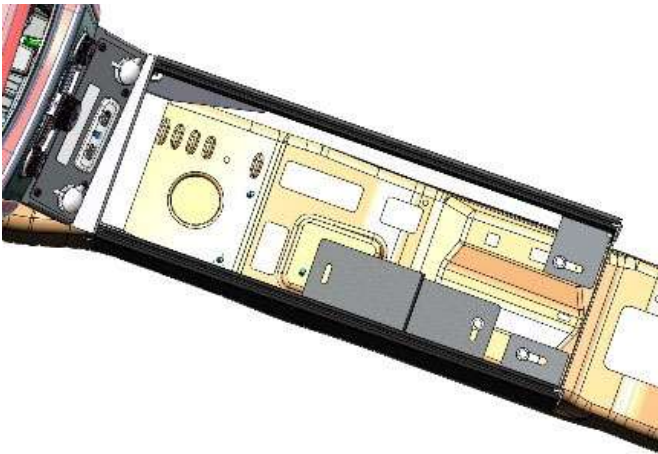

Cover (11209) is provided to guard the OEM sensor on the transmission hump. Attach cover using $\frac{1}{4}$ x $\frac{3}{4}$ " self-threading screw.

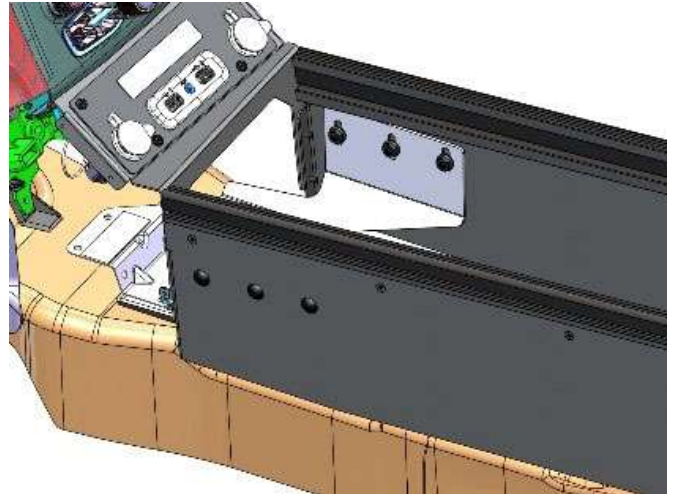

Loosely attach main housing to front mounting bracket using carriage bolt and serrated nuts provided.

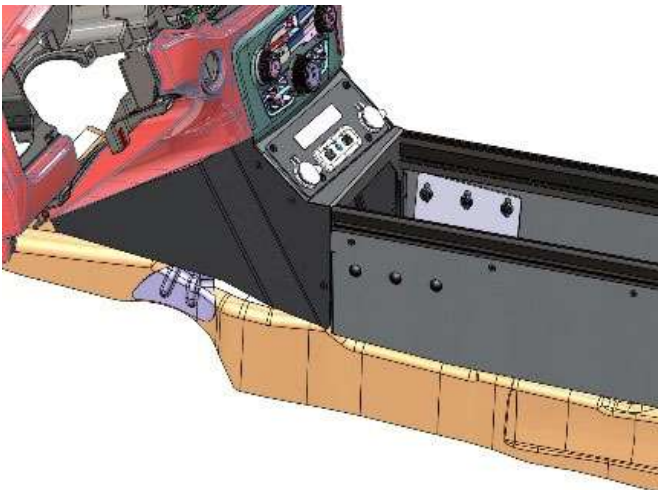

Attach trim panels using #8 x $\frac{3}{8}$ " supplied screws.

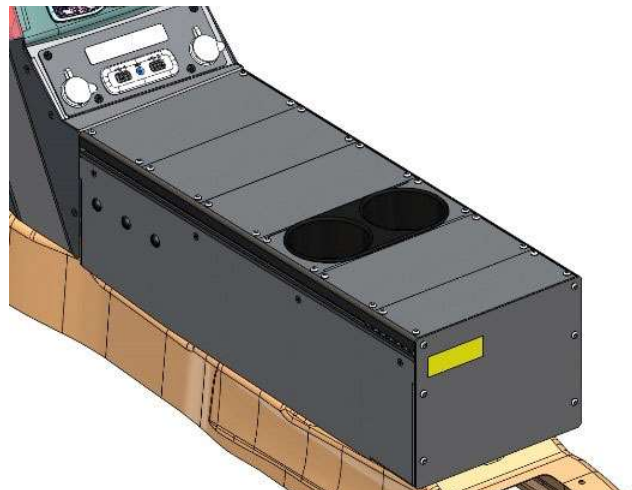

Install control heads and accessories to complete installation.