

DESCRIPTION

The Haron **TS-2007 HIGHLOCK ASSISTANCE SEAT** is a robust seat with a **50mm HIGHER SITTING POSITION** specially designed to assist people who require extra height, seat stability, extra safety and capacity for larger weight and frames. This is a top & bottom fixing seat



HARDWARE KIT

- Includes Bottom Fixing Bolts and Nuts

Locking Stability Buffers

HINGE SYSTEM

- Stainless Steel top or bottom fixing hinges

MATERIAL

Durolux / Urea

- Solid Strong Moulding
- 50mm Height
- Locking Stability Buffers
- Suits Most Pans



Adjustable Guide Buffers can be locked into the sides of most ceramic Pans for side to side movement stability

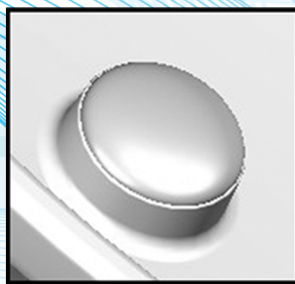

Round flat shaped Heavy Duty Buffers spread weight evenly around the rim of the Pan

Stainless Steel Hinges

