

6 Connect the water supply

All fittings are supplied apart from the isolation valve.



Valves and fittings must be sealed with PTFE tape.

Braided hose to Command Centre MAINS inlet (supplied with Command Centre)

Hot water isolation valve (not supplied)

1/2" BSP adaptor

Strainer

Mains water isolation valve (not supplied)

T-piece

2x male adaptor

See 3

Red marked braided hose to mixer tap

Blue marked braided hose to mixer tap

Connect fittings together

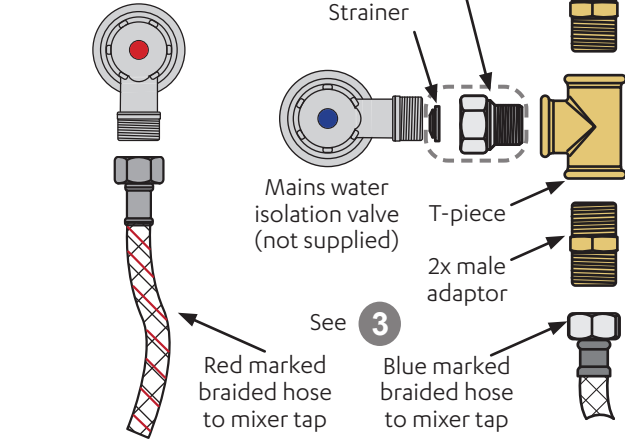

7 Be careful with the sparkling pipework

- Silicone tubes are soft and easily deformed. It is essential to avoid kinks, loops and sags.
- Loosely cable-tie the rigid sparkling pipework to an adjacent braided hose to avoid kinks and squeezing.

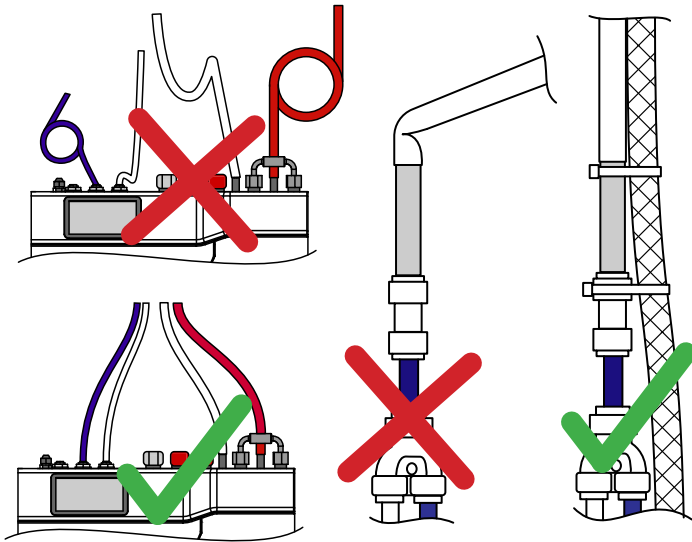

8 Command Centre connections

Mains In	Mains potable water supply.
USB	Connected the Tap.
Boiling out	Red silicone tube from tap. Cut to length.
Chilled out	(BCS) Blue JG pipe from tap. Cut to length. (BC) Blue silicone tube from tap. Cut to length.
Vent	Clear silicone tube from tap. Cut to length.
Sparkling out	White JG pipe from tap. Cut to length.

9 Cleaning and general maintenance

Wipe surfaces with a damp cloth and then wipe dry with a clean, dry cloth. Do not use disinfectant sprays without wiping dry afterwards.



WaterMark
WMAK25927
AS/NZS 3718

Zip Water

67 - 77 Allingham Street, Condell Park, NSW 2200
Postal: Locked Bag 80, Bankstown 1885, Australia
(+612) 9796 3100 | Free Call (Aust): 1800 947 827

www.zipwater.com

Zip Water UK

Trafalgar House
Rash's Green, Dereham,
Norfolk NR19 1JG
0345 6 005 005

specify.zipwater.co.uk

Installation instructions

Zip HydroTap

Celsius Plus All-In-One
BC, BCS

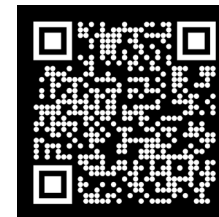

Australia

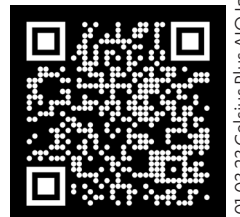

UK

Visit our website to download the manuals

Using these instructions

Please refer to all safety and installation requirements detailed in the Quick start guide provided with the HydroTap Command Centre, and HydroTap Command Centre installation instructions found online, prior to installation of, or any change to, the complete system.



WARNING



Read the instructions

Before commencing the installation, download & read the HydroTap Command Centre installation instructions

Tools needed for installation (not supplied)

In addition to normal tools, the following (or equivalent equipment) will be required.

- 50mm diameter sheet metal hole punch for sinks.
- 50mm diameter hole saw for worktops.
- Tube spanner for fixing the tap assembly.



Be aware of the risks of hazards which could cause harm when using tools. Assess the risks before starting the installation.

Water supply pressure requirements

	Min - Max pressure, kPA (bar)	
	Australia	UK
HydroTap	170 (1.7) - 700 (7.0)	170 (1.7) - 500 (5.0)
Sparkling HydroTap	250 (2.5) - 700 (7.0)	250 (2.5) - 500 (5.0)
Booster	200 (2.0) - 700 (7.0)	200 (2.0) - 500 (5.0)

1 Positioning

Position the tap such that it dispenses into the sink bowl with clearance for a cup or tea pot.



Ensure that taps are positioned to minimise the risks of scalding by dispensing boiling water while using the tap.

Position Command Centre and Tap as close together as possible.

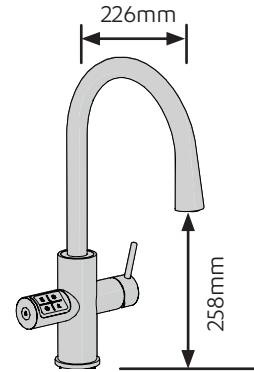
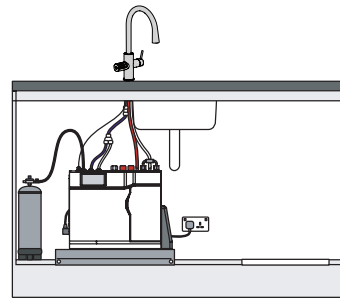

2 Cut the hole



- Cut a Ø50mm hole in the worktop / sink.
- Make sure the tap location will allow the tap spout to drain into the sink.

3 Familiarise yourself with the mains connections

Fit braided hoses, matching the hose colours to the tap

Loop back the integral unmarked braided hose and connect the free end into the fitting shown

See **6**
Mains Hot

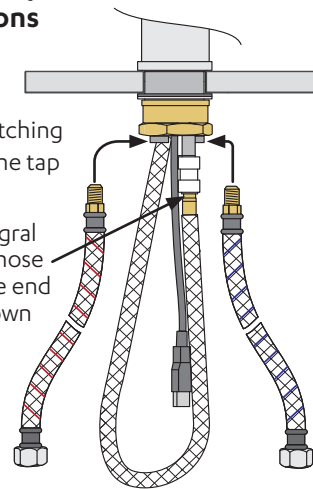

See **6**
Mains Cold

4 Familiarise yourself with the tap connections

3 way silicone tube

Boiling Vent Chilled

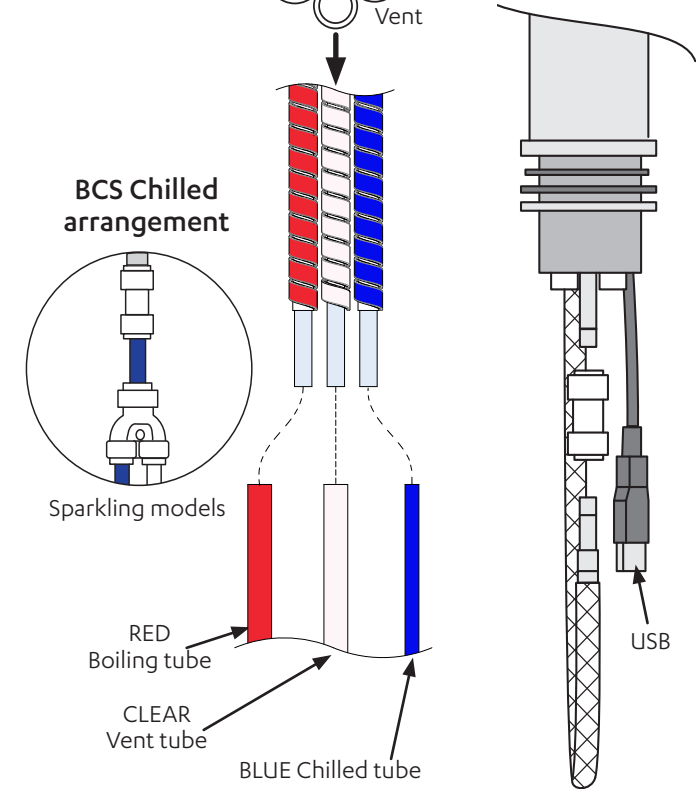

5 Mount and secure the tap

