

Installation Guide for Viega Eco Plus 1F Concealed Cistern for Wall Mount Pan

Cistern Model 8108.10 (747268)



Components

- A Viega Eco Plus 1F assembly.
- B Cistern access duct.
- C Flushing pipe with bend.
- D Flushing pipe – (horizontal adaptor).
- E Dust cover for flushing pipe.
- F Sewer outlet pipe (90x400mm).
- G Pan adaptor pipe
- H Dust cover for sewer outlet pipe.
- I 90 to 100mm sewer adaptor ring.
- J Floor mounting hardware and pan mounting hardware.

Optional hardware not shown here.

Mounting hardware for face fixing to masonry. Fixing set 8173 or 8180.73.

Notes on Eco Plus 1F Installation

- A** Cistern may be installed in stud framing or face mounted to masonry. Minimum spacing of 623mm between studs. Studs must be able to support the applied loads. Refer to project engineer/details.
- B** The waste outlet pipe is 90mm OD, therefore in 90mm cavity installations, accurate alignment of the front face of the mounting bracket with the front face of the studs is critical.
- C** Where the waste pipe is to penetrate a concrete slab floor, it is suggested that core drilling be carried out where a high degree of alignment accuracy is required.
- D** Allow for screed and tile thickness where applicable in all height calculations.
- E** For the correct mounting of flushing plates, the total thickness of wall linings (i.e. total of lining + tiles + adhesive) must be within a specified range. Refer to the following details.

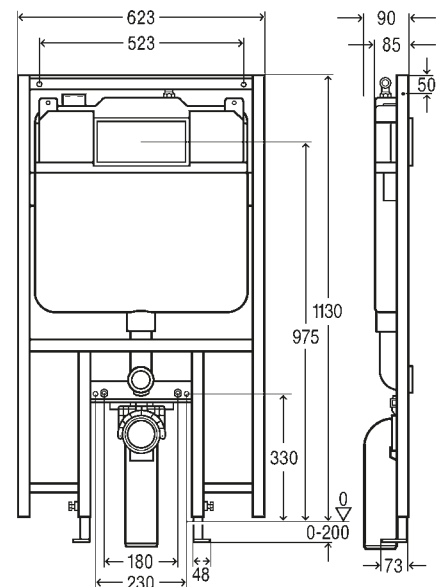
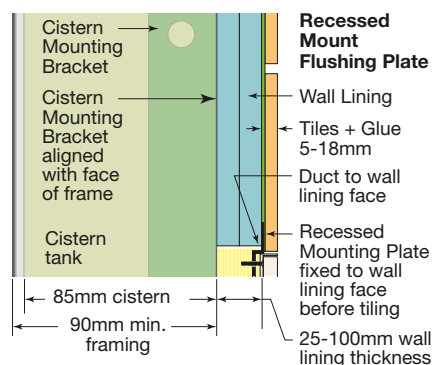
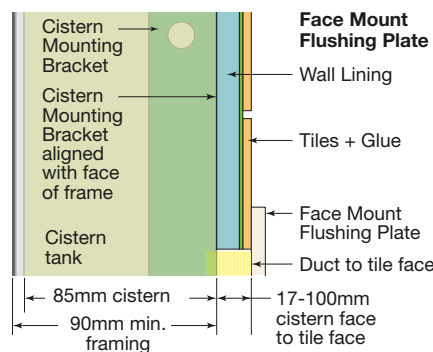
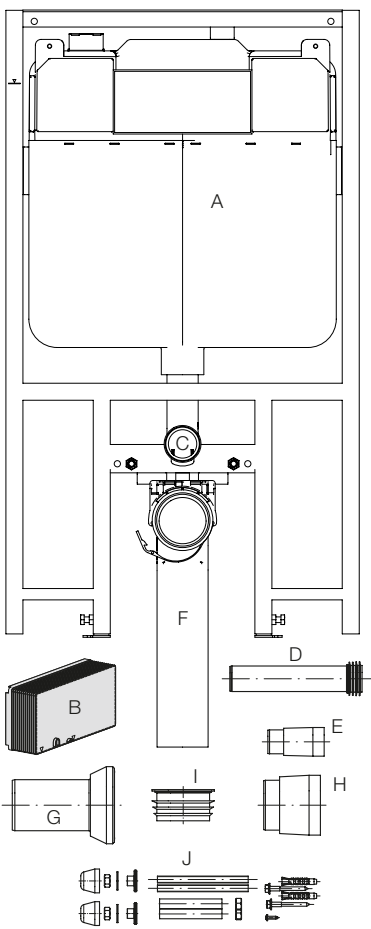
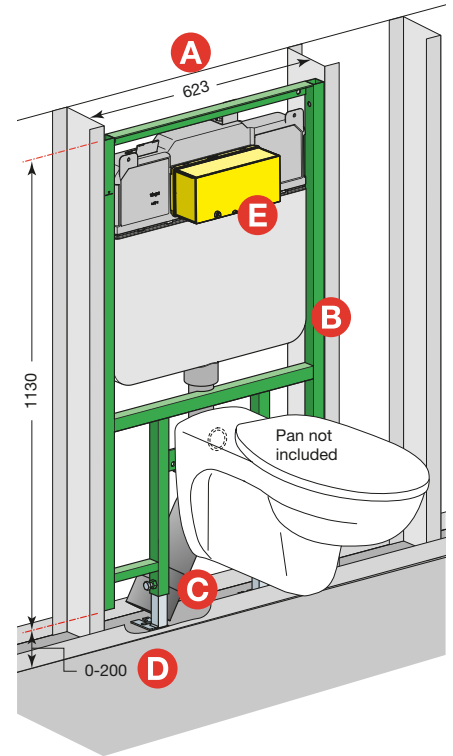

Cistern Installation in Stud Wall

For installation to a masonry wall, proceed to Step 8.

- 1 Prepare studs to accept the cistern and pan support bracket. Minimum of 623mm between stud fixing faces.
- 2 Ensure mains waste pipe is appropriately located in floor, ready to receive the waste connection.
- 3 Place the cistern bracket on the feet and place the unit into the wall space. Align the front face of the cistern support bracket with the face of the studs. Refer to previous Notes. Position and fix the mounting feet to the floor with appropriate fixings. The feet may be rotated to adjust for available space.

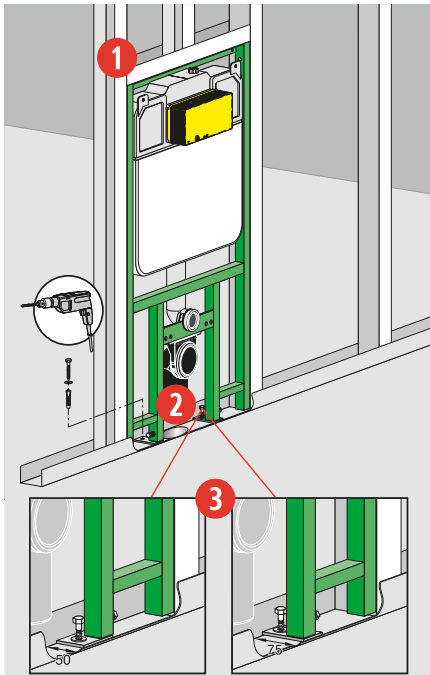

- 4 Determine the appropriate height for the pan (allow for screed and floor tiling). Adjust the cistern/pan bracket and fix the bracket to the floor support posts with the built-in clamping bolts.
- 5 Align the front face of the cistern bracket with the face of the studs and fix the bracket to the studs with appropriate fasteners.
- 6 Trim waste outlet pipe to length required. Mount the pipe in the support bracket and secure with the retaining clamp. A 90 to 100mm adaptor (Component I) is

supplied for the junction with the main sewer line.

- 7 Determine the mounting centres for the pan and fix mounting bolts in place.

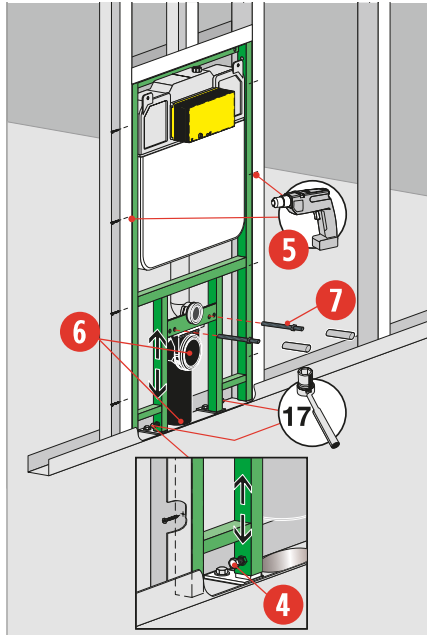

Proceed to Step 16.

Cistern Installation to Face of Masonry Wall

- 8 Determine where the mains waste pipe is or will be located in floor to receive the waste connection.

Determine and mark the fixing points for the cistern/pan support bracket. Take into account the desired pan mounting height, and allow for floor screed and tiles.

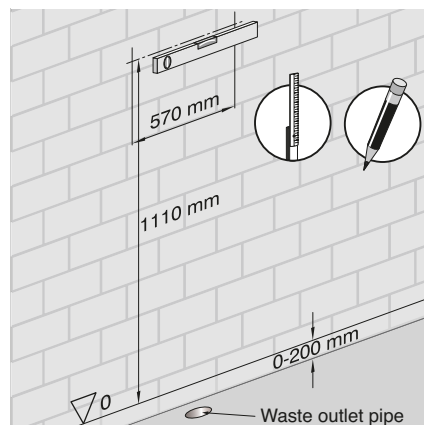

Choose from Step 9 or Step 10.

- 9 Drill holes in masonry and install the fixing brackets. Fit threaded studs to brackets. (Use optional fixing set 8173).

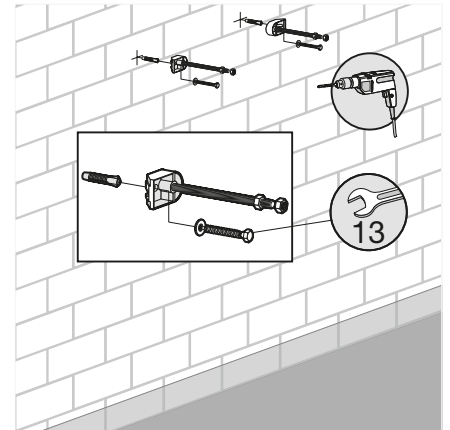

Proceed to Step 11.

- 10 Alternatively, drill holes in masonry and install the fixing studs. (Use optional fixing set 8180.73).

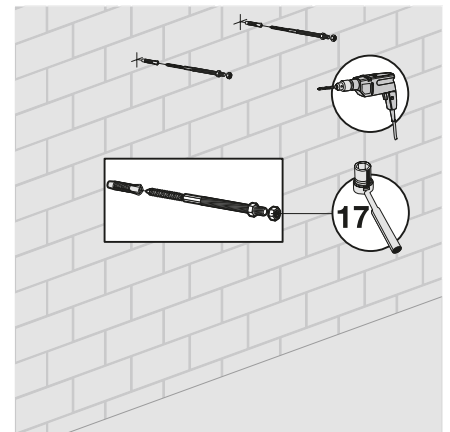

- 11 Place the cistern bracket on the feet and place the unit onto the top fixing studs with backing nuts installed. Position the frame at the required distance (85-200mm) from the wall, install retaining nuts.

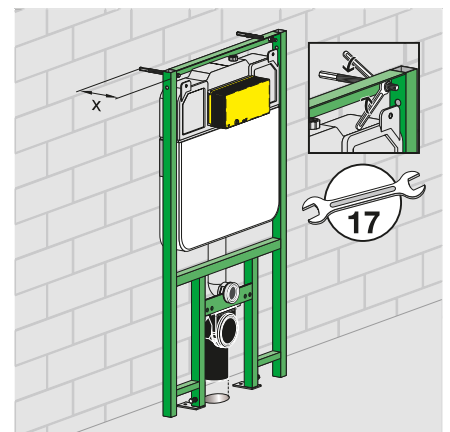

- 12 Check the frame line and level and tighten the retaining nuts.
- 13 Position and fix the mounting feet to the floor with appropriate fixings. The feet may be rotated to adjust for available space.
- 14 Fix the bracket to the floor support posts with the built-in clamping bolts.
- 15 Determine the mounting centres for the pan and fix mounting studs in place.

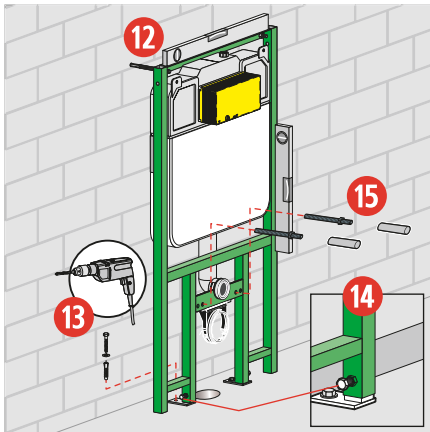

- 16 Trim waste outlet pipe to length required. Mount the pipe in the support bracket and secure with the retaining clamp. A 90 to 100mm adaptor (Component I) is supplied for the junction with the main sewer line.

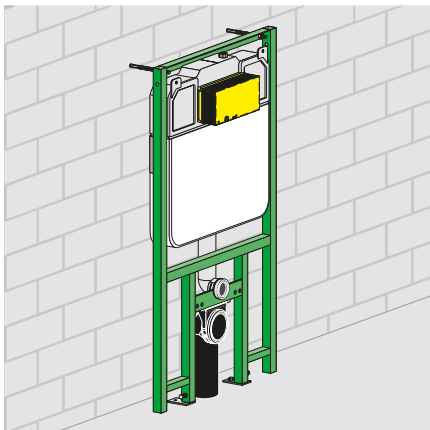

Water Connection

- 17 To gain access to the cistern tap remove the access duct (if fitted) and keep for reinstallation.
- 18 Remove the internal guide plate and keep for reinstallation.

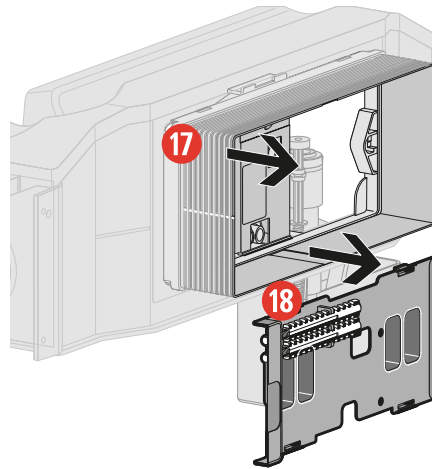

- 19 1 Unlock the mechanism retainer.
2 Push the top of the mechanism down, lean the mechanism forward, then reach behind and unhook the pull bar from the drain valve stem.
3 Remove the mechanism from the cistern.

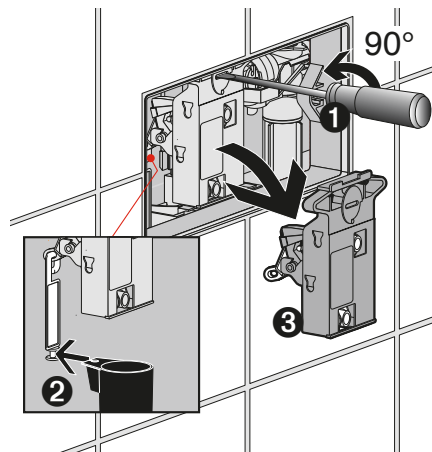

- 20 Where the water inlet line/fitting cannot be rotated to join into the tank fitting, unscrew the inlet tap from the through-tank fitting.

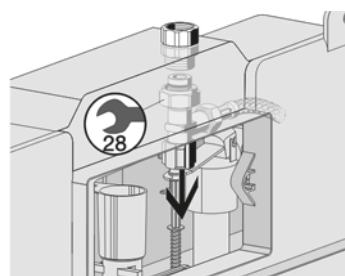

- 21 Connect the inlet water line to the tank fitting (1/2" BSP female fitting). The tank fitting can be rotated with a spanner.

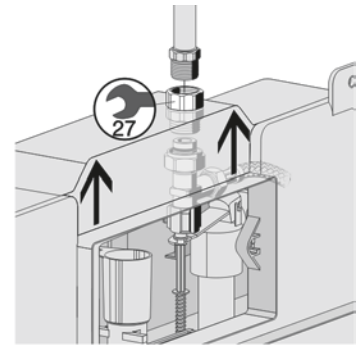

- 22 Refit the cistern tap and tighten with a spanner. Turn tap to off position ready for mains pressure testing.

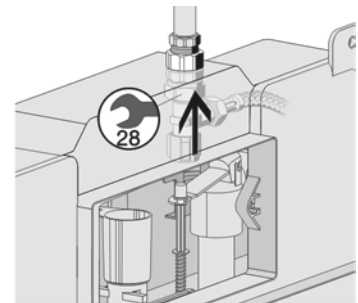

- 23 Where the incoming fitting can be rotated, such as in a new installation with a Propress Line Adaptor N°3, insert the thread into the tank fitting and tighten with spanners.

- 24 Connect incoming water line to your chosen fitting.
- 25 Check that the inlet tap nut is tight. Turn tap to off position ready for mains pressure testing.

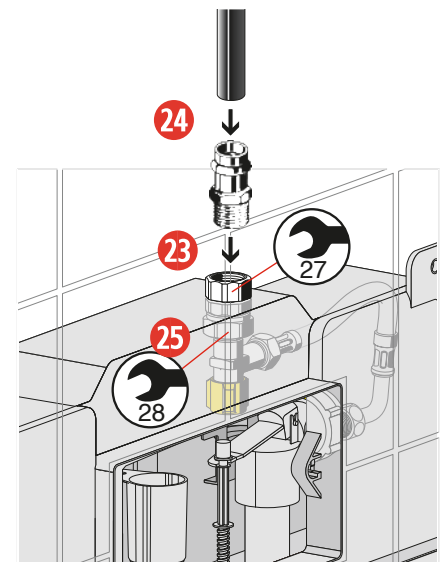

- 26 Reinstall the mechanism, internal guide plate, and fit the access duct (required for all installations).
- 27 Cover pan mounting bolts and insert dust covers provided into the flushing pipe and waste pipe to protect during wall lining and tiling. Store remaining components for use during pan installation.
- 28 The unit may be encased to project specifications.

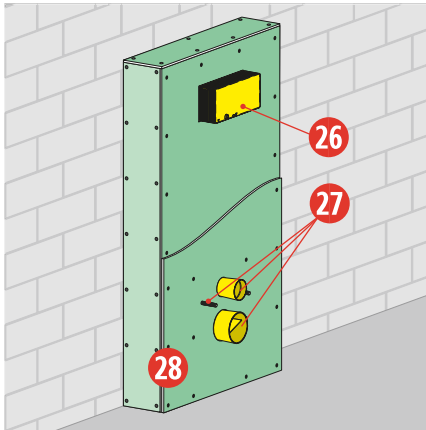

Pan Installation

Proceed with the pan connection after wall and floor tiling is completed. Refer to pan manufacturer for installation instructions.

- 29 Determine the required length for the horizontal flushing pipe. Cut the plain end to length if required. Assemble the pan seal onto the plain end of the horizontal pipe. Install the horizontal flushing pipe into the seal of the vertical flushing pipe.

Insert the pan seal into the back of the pan and fix the pan in place.

Also refer to instructions supplied with the adaptor pipe.

Mains Power Electrical Installation

Where mains power connection is required, this must be installed by a licensed electrician prior to wall lining/tiling. Refer to Viega document VGA1230AU.

Flushing Volume Adjustment

Flush volume settings are factory set and should not need adjustment.

To carry out adjustment of the flushing volumes, remove the flushing valve from the cistern. Follow the instructions for removing the flushing valve, refer to Viega document VGA1188AU Servicing Guide for Viega 1F Concealed Cistern.

- 1 The factory settings for the small flush is 3.0 l. The volume may be adjusted between 2.5 l and 3.0 l by moving the slider on the side of the overflow pipe. The upper position is 2.5 l. The lower position is 3.0 l. The positions can be identified by the notches.

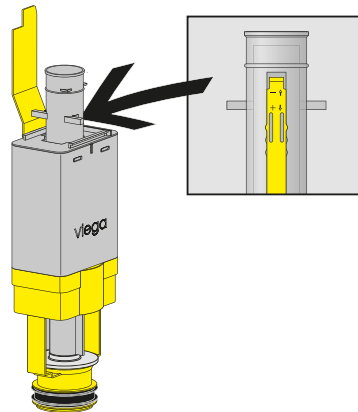

- 2 The factory settings for the large flush is 4.5 l. The volume is infinitely adjustable between 4.5 l and 6.0 l by moving the slider under the flushing valve housing. The left position as shown in the diagram is 4.5 l. The right position as shown in the diagram is 6.0 l.

