

# ProShield Tanking Kit



8kg



## Product Selection Guide

### Key areas of use:

- ✓ Wetrooms
- ✓ Showers
- ✓ Bathrooms
- ✓ Kitchens
- ✓ Utility rooms
- ✓ Laundry rooms
- ✓ Communal showers
- ✓ Steamrooms
- ✓ Saunas
- × Swimming pool
- ✓ Sanariums

### Suitable surfaces & substrates:

- ✓ Concrete
- ✓ Sand/cement screed
- ✓ Plywood for floor only as an overlay (15mm min)
- ✓ Tile backer boards
- × Cement faced fibre boards
- ✓ Anhydrite screeds
- × Tile on Tile\*
- ✓ Firm & stable plaster
- ✓ Plasterboard
- ✓ Sand/cement render
- ✓ New brickwork
- ✓ Blockwork
- ✓ Timber walls

\* Existing ceramic, porcelain and natural stone tiles (overlay) known as "Tile on Tile"



# TECHNICAL DATASHEET

**UltraTile ProShield** provides waterproof protection to backgrounds in commercial environments, wetrooms, domestic bathrooms, kitchens and showers and is suitable for both walls and floors prior to tiling. It is a polymer emulsion based product for use on internal installations only.

## SURFACE PREPARATION

Ensure all areas are clean, dry and free from dust or any other contaminating barriers. Remove any flaking or peeling layers. Background surfaces must be free from movement.

**New Brickwork, Blockwork and Concrete:** Must be fully cured and dry, surface must be reasonably flat.

**Gypsum Plaster/Anhydrite Type Floors:** Must be completely dry. Ensure the surface is fully cured (with >0.5% moisture) prior to application of UltraTile ProShield.

**Timber Walls/Floors, other Boarded Backgrounds:** Background must be clean and free from any loose matter and the surface must be sound, dry and flat. Boards should be firmly fixed to supporting joists and free from any excessive or sudden movement. For floorboards, overlay with at least 15mm exterior grade plywood screw fixed at 300mm centres.

**Note:** Moisture sensitive backgrounds should be protected from moisture ingress from behind.

## APPLICATION

UltraTile ProShield should be applied using a brush or short pile roller to give a continuous thin layer of product at least 0.4mm thick. See application method opposite. Drying time will be extended depending on thickness applied, porosity of background and temperature if less than 20°C.

## APPLICATION METHOD

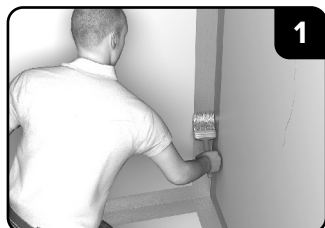

1 Apply coating to the junctions between wall to floor and wall to wall corners using a paint brush or short pile roller at coverage 0.5kg/sqm.



2 Bed a strip of membrane tape into the coating while still wet to strengthen and reinforce the junction points.



3 Immediately apply a further application of the coating to the bedded tape to encapsulate at coverage 0.5kg/sqm. Allow to dry for 2 hours.

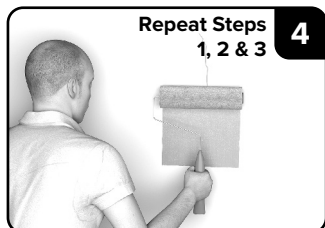

4 Repeat steps 1, 2 and 3 to repair and strengthen hairline superficial cracks in the body of the wall or floor. Allow to dry for 2 hours. Also repeat similar for boarded backgrounds along the joint between boards.

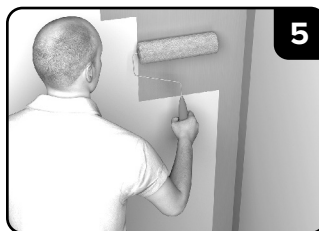

5 When dry, apply a uniform coating over the complete wall and floor area in a continuous layer at a coverage of 0.5kg/sqm using a paint brush or roller as previous. Allow to dry for 2 hours before applying a second coat to the same area at the same coverage 0.5kg/sqm. Allow 24-48 hours drying before commencing tiling.

## CLEANING

Tools should be thoroughly cleaned with water to remove excess material immediately after use.

## TECHNICAL DATA

Unit Size:	8kg Buckets (includes flexible waterproof coating and membrane tape)
Colours:	White
Foot Traffic/Tiling*	24 Hours
Coverage:	0.5kg per m <sup>2</sup> per coat (coverage essential to ensure protection)
Drying Time*:	2 Hours First Coat
Drying Time*:	24 Hours Second Coat
Application Temperatures:	5°C to 25°C

\*Depending on temperatures, substrate, porosity of substrate and tile and site conditions.

## POINTS OF NOTE

The drying period for UltraTile ProShield will be affected by extremes in temperature. High temperature site conditions will increase the speed of drying. Low temperatures will reduce the speed of drying. It is therefore good practice to consider site conditions and storage of materials as essential factors in planning tanking installations.

UltraTile would always advise that tiling installers follow the guidelines for tiling as laid down in BS EN5385. It is essential that expansion joint are built into the design of the tiling installation in order to prevent tension build up. This is a common occurrence which can result in tiles de-bonding.

In flooring situations there needs to be sufficient fall to ensure the water will drain freely from the floor surface.

## STORAGE

This product must be stored in unopened buckets, in a frost free environment out of direct sunlight. Ideal storage temperatures are between 5°C and 25°C.

## SHELF LIFE

Under the above storage conditions this product has a shelf life of 12 months.

## HEALTH & SAFETY

Please ensure that appropriate PPE is used when preparing, mixing and applying products. Always wash hands before consuming food and make sure that materials are kept safely out of reach of children and animals. Please dispose of packaging and waste appropriately. A full Material Safety Data Sheet relating to this product is available from [ultratileadhesives.co.uk](http://ultratileadhesives.co.uk).

## QUALITY ASSURANCE

All products are manufactured in a plant whose quality management system is certified / registered as being in conformity with BS EN ISO 9001, ISO 14001 and ISO 45001. UltraTile products are guaranteed against defective materials and manufacture and will be replaced or money refunded if the goods do not comply with our promotional literature. We cannot however accept responsibility arising from the application or use of our products because we have no direct or continuous control over where and how our products are used. All UltraTile products are sold subject to our terms and conditions of sales, copies of which may be obtained upon request.

Instarmac Group plc  
 Danny Morson Way, Birch Coppice Business Park  
 Dordon, Tamworth, Staffordshire B78 1SE  
 t: +44 (0)1827 254400  
 e: [enquiries@instarmac.co.uk](mailto:enquiries@instarmac.co.uk) orders: [orders@instarmac.co.uk](mailto:orders@instarmac.co.uk)

w: [instarmac.co.uk](http://instarmac.co.uk)

Vers 02.06.2023 Information correct at time of print. Uncontrolled if printed. For the most up-to-date version of this datasheet, please refer to this product's profile on our website which can be found at [ultratileadhesives.co.uk](http://ultratileadhesives.co.uk)

