



# INDUSTRIAL HAND RIVETER

OPERATOR'S MANUAL



## Get to Know Your Industrial Hand Riveter

This quality riveter is more compact than many typical industrial hand riveters and provides a nearly effortless functionality. Used to securely join together a wide range of materials, such as sheet aluminum, steel, plastic and vinyl, this riveter has everything you need to get the job done right the first time, every time.

With its aluminum body, high grade alloy steel jaws, and double handle bearings this riveter is designed to be tough enough to last a life time and can be used with aluminum, steel, and stainless-steel rivets. It even includes a Chrome Molybdenum special profile nozzle for structural rivets up to 6.4mm, so you can take on big jobs.

### Set Includes:

- Industrial Hand Riveter
- 3.2mm (1/8") nosepiece
- 4.0mm (5/32") nosepiece
- 4.8mm (3/16") nosepiece
- 6.4mm (1/4") nosepiece



### NEED HELP?

(206) 453-6776

[www.arestool.com](http://www.arestool.com)

[customerservice@arestool.com](mailto:customerservice@arestool.com)

**Don't forget to register your product!**

# INDUSTRIAL HAND RIVETER

## OPERATOR'S MANUAL

### Prep:

Read these instructions carefully before using your riveter.

1. Select the correctly sized nosepiece you need and screw it into the tool head.
2. Bore rivet holes in both workpieces.
3. Open the tool handle.
4. Insert the rivet mandrel into the nosepiece of the riveter.

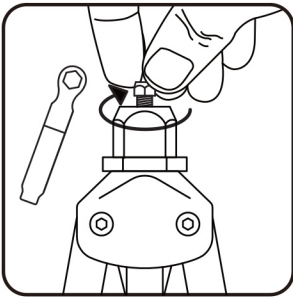

Step 1

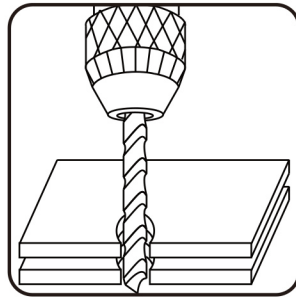

Step 2

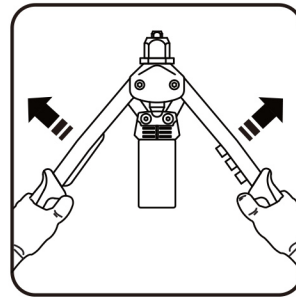

Step 3

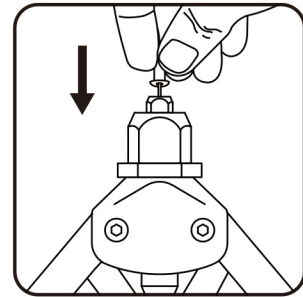

Step 4

### Operation:

Read these instructions carefully before using your riveter.

1. Push the rivet into the aligned holes in both workpieces.
2. Squeeze riveter handles firmly until the rivet mandrel breaks away from the rivet.
3. Open the tool handles to drop the used mandrel into the cup.

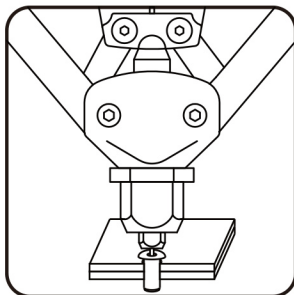

Step 1

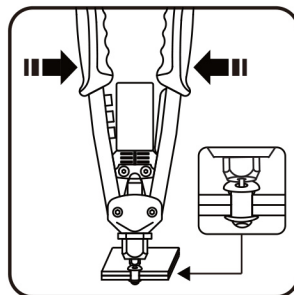

Step 2

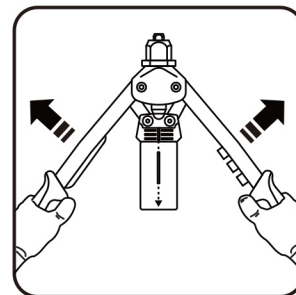

Step 3

# INDUSTRIAL HAND RIVETER

## OPERATOR'S MANUAL

### Maintenance:

1. Keep your riveter clean by wiping it with a clean, dry cloth after each use.
2. Cover it with a clean, dry cloth when not in use or store it in your toolbox to prevent dust or debris buildup.
3. Check your riveter for damage before each use.

### Troubleshooting:

You can set the angle of operation by adjusting the lock nut and the length to which the head sticks out of the body.

1. For faster use, try adjusting the head so that it protrudes from the body further.
2. For easier use, try adjusting the head so that it stays closer to the body. This angle will require less effort.

**Warning:** Always wear eye protection when operating this or any other riveter.

### Additional Products:

If you need additional riveting gear, you can find it on Amazon or on our web store under the following part number:

70418 Industrial Nut Riveter

70017 Professional Pop Rivet Gun with 60 Rivets

# INDUSTRIAL HAND RIVETER

## OPERATOR'S MANUAL

### You are backed by the ARES Tool Performance Assurance!

ARES TOOL warrants this product to be free from defects in materials and workmanship under normal use and service. A defective product may be returned for a free replacement within 90 days from the date of purchase, provide that product is returned immediately after discovery of defect. This warranty shall be valid only when proof of purchase (receipt) showing the date of purchase accompanies the defective product.

#### Exclusions:

These warranties exclude blades, bits, punches, dies, bulbs, fuses, batteries, and other consumables which must be replaced under normal use and service. These warranties shall not apply to any product or part which is used for a purpose for which it is not designed, or which has been repaired or altered in any way so as to affect adversely its performance or reliability, nor shall these warranties apply to any product or part which is subject to misuse, neglect, accident, or wear/tear incident to normal use and service.