



12-PIECE MASTER CYLINDER ADAPTER SET

OPERATOR'S MANUAL



Get to Know Your Master Cylinder Adapter Set

This ARES Master Cylinder Adapter Set includes twelve adapters all designed to work with Brake Fluid Bleeders, so you can easily remove and refill fluid into your entire brake system on your own. Compatible with a variety of master cylinder reservoirs, this adapter set will help you get the job done on nearly any brake system, whether you're a professional or a diy-er. See included pieces in the infographic (next page).



NEED HELP?

(800) 340-1442

www.arestool.com

customerservice@arestool.com

Don't forget to register your product!

Set Includes:

- A. Rectangle Adapter for Chrysler and GM
- B. Adapter for Toyota and Lexus - 43mm
- C. 29mm Adapter
- D. 34.5mm Adapter
- E. 42mm Adapter
- F. 43.5mm Adapter
- G. 43.5mm Adapter
- H. 47mm Adapter
- I. 49.5mm Adapter
- J. 50.7mm Adapter
- K. 56mm Adapter
- L. 77mm Adapter
- M. Brackets
- N. Washers
- O. J-Bolts
- P. Chain

ARES

MASTER CYLINDER ADAPTER SET

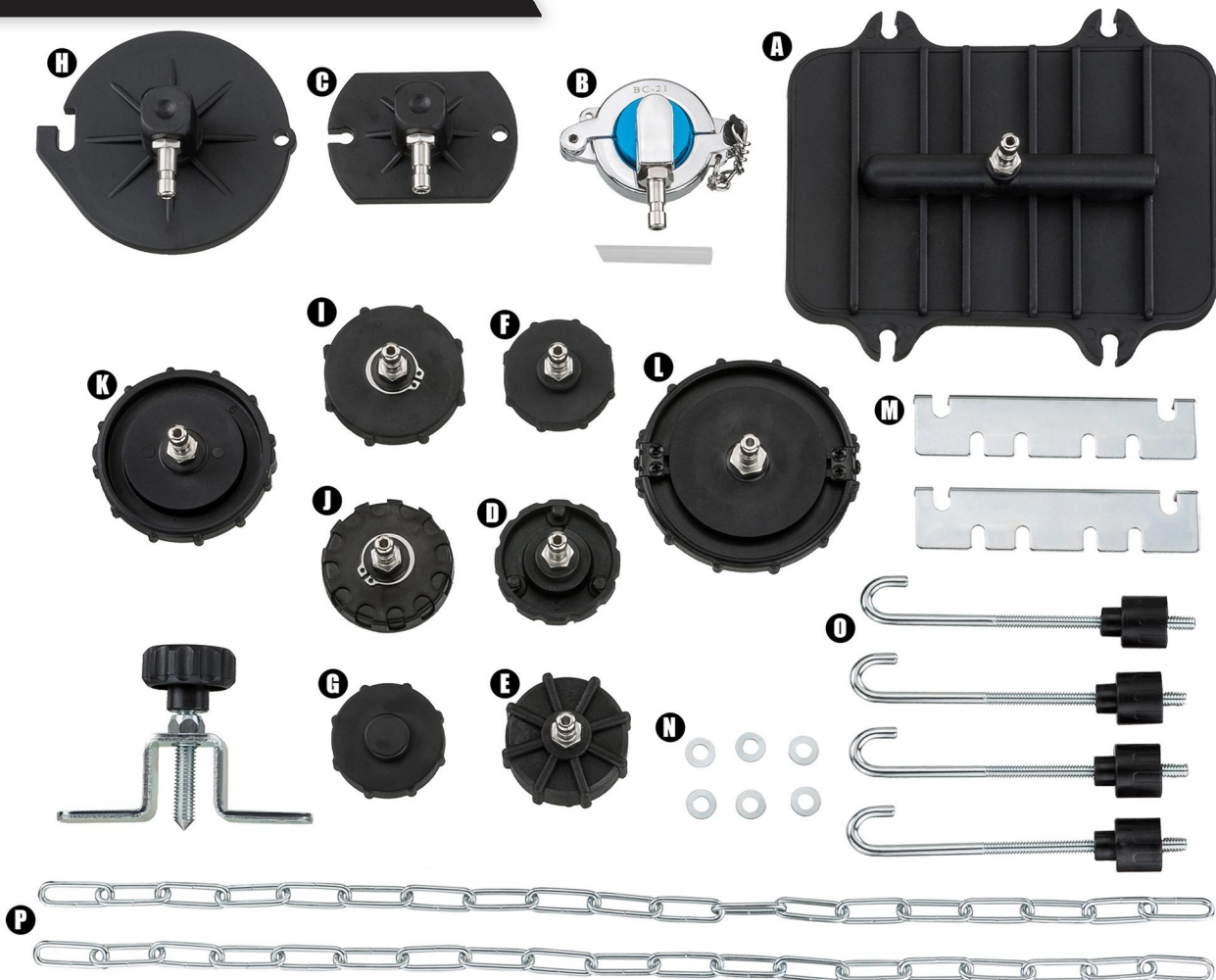









Selecting the Correct Adapter:

Read these instructions carefully before selecting your Master Cylinder Adapter.

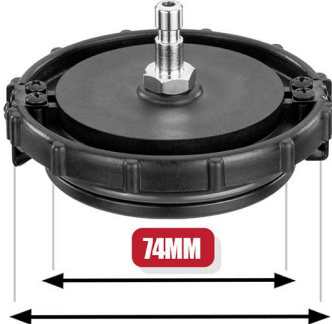
- 1.If available, consult the manual of the vehicle you are working on to find the correct adapter size.
- 2.If a vehicle manual is not available, measure the interior diameter of the master cylinder adapter. Use your own measurements and the make of the vehicle to consult the infographic below and determine the appropriate adapter.

ARES

MASTER CYLINDER ADAPTER SET

 <p>34.5MM 53.5MM</p> <p>Nissan</p>	 <p>56MM 79.5MM</p> <p>Honda Accord</p>	 <p>74MM 93MM</p> <p>Honda</p>	 <p>42MM 57.5MM</p> <p>Alfa Romeo, Audi, BMW, Jaguar, Land Rover, Mercedes, Peugeot, Porsche, Renault, Saab, VW, Volvo, Chrysler Crossfire, Daewoo, late Model Ford, Kia, Some Mazda, and Mini</p>
 <p>49.5MM 66.5MM</p> <p>Most Late Model GM Cars (Buick, Cadillac, Chevrolet, GMC, Hummer, Oldsmobile, Pontiac), and some Mazda</p>	 <p>43.5MM 51.5MM</p> <p>Chrysler, Dodge, Jeep, Plymouth</p>	 <p>43.5MM 49MM</p> <p>Chrysler, Dodge, Jeep, Plymouth</p>	 <p>50.7MM 57MM</p> <p>All Hyundai, Mitsubishi, Nissan, and Subaru, some Chrysler/Dodge, some Ford/Lincoln</p>

ARES

MASTER CYLINDER ADAPTER SET



Toyota and Lexus
Inner Dia: 43mm



Universal
Inner Dia: 47mm
Outer Dia: 85.5mm



Universal
Inner Dia: 29mm
Outer Dia: 55mm



Chrysler/GM

Operation:

Read these instructions carefully before using your Master Cylinder Adapters.

1. These master cylinder adapters are designed for use with the ARES 70921 Manual Brake Fluid Bleeder. For best results, use with ARES 70921.
2. Securely attach correct adapter to brake fluid bleeder hose.
3. Using any other required pieces in the set, according to your vehicle's manual if available, securely attach adapter to master cylinder.
4. Follow brake fluid bleeder instructions for removing and replacing brake fluid from the vehicle.

Maintenance:

1. Wipe adapters with a clean, dry cloth after each use.
2. Store in convenient carrying case to maintain best organization and condition of the tools.

Warnings:

1. Remember to always add new brake fluid into the system while performing the brake bleed. Do not allow the master cylinder go completely dry; this would allow air into the system, which may cause operation issues.
2. Not all brake systems are the same. We encourage our customers to have a firm understanding of how their system works before using this product to ensure proper use.
3. Brake fluid can contain hazardous materials. Please use caution and dispose of brake fluid safely and responsibly.

12-PIECE MASTER CYLINDER ADAPTER SET

OPERATOR'S MANUAL

You are backed by the ARES Tool Performance Assurance!

ARES TOOL warrants this product to be free from defects in materials and workmanship under normal use and service. A defective product may be returned for a free replacement within 90 days from the date of purchase, provide that product is returned immediately after discovery of defect. This warranty shall be valid only when proof of purchase (receipt) showing the date of purchase accompanies the defective product.

Exclusions:

These warranties exclude blades, bits, punches, dies, bulbs, fuses, batteries, and other consumables which must be replaced under normal use and service. These warranties shall not apply to any product or part which is used for a purpose for which it is not designed, or which has been repaired or altered in any way so as to affect adversely its performance or reliability, nor shall these warranties apply to any product or part which is subject to misuse, neglect, accident, or wear/tear incident to normal use and service.