



babyark

**Convertible
Car Seat System**

User Manual



User Manual

Convertible Car Seat System

Weight: 4-65 lbs (1.8-29.5 kg)

Height: 49 inches (124 cm) or less

Age: Birth to 6 years

Keep this User Manual in its storage pocket located on the back of the back cushion of the seat.

Rev.B

Table of Contents

-	Warnings	5
1	Before you install babyark	9
1.1	Safety information	10
1.2	Your vehicle and babyark compatibility	11
1.3	Selecting vehicle seating position	11
1.4	Vehicle seat belts	12
2	About the babyark	15
2.1	About the ACTV8™ Smart Base	16
2.2	About the babyark Seat	21
2.3	Safety features	22
3	Install babyark	25
3.1	Installation process	25
3.2	Recommended installation method	26
3.3	Additional installation methods	36
3.3.1	Rear-Facing Lower Anchors only	39
3.3.2	Rear-Facing vehicle belt only	43
3.3.3	Forward-Facing vehicle belt only	48
3.4	Locking seat belt	54
3.5	BioArk™ side impact protection	55
3.6	Top Tether	57
4	Check your installation	59
5	Adjusting your seat	60
5.1	Recline position	60
5.2	JoltFree™ headrest position	62

5.3	Seat clearance	64
5.4	Changing babyark seat direction	65
6	Day-to-day use of babyark	66
6.1	Securing your child in babyark	66
6.2	Adding Infant Insert cushions	69
6.3	The cup holder	70
6.4	Manual storage location	72
6.5	ACTV8™ Smart Base charging	72
6.6	Lower Anchor funnels	73
7	Uninstall babyark	74
7.1	Uninstalling the babyark seat	74
7.2	Uninstalling the Smart Base	75
8	Care and clean	78
8.1	Cleaning	78
8.2	Fabric cushion removal and installation	79
8.3	Storage of babyark	81
9	Use on an aircraft	82
10	Troubleshooting	82
11	Important information	85
11.1	Warranty	85
11.2	Use of babyark after a crash	85
11.3	No set expiration date	86
11.4	Registration and recall	86
11.5	Contact babyark	87

Please be aware of the following safety guidelines before using your babyark convertible seat.

⚠ WARNINGS

Death or Serious Injury Can Occur

Read and follow all warnings labeled on the car seat and found in this instructions manual.

Seat MUST be used with base.

Seat must be properly connected to the base.

- Correct use is required for the safety of your child. Users of this car seat are responsible for correct installation and use. All sensors and app functions are for assistance and reassurance only.
- Use only with children who weigh 4-65 lbs (1.8 and 29.5 kg) and whose height is 49 inches (124cm) or less.

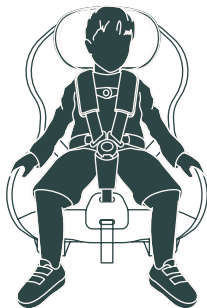

- Use only in a rear-facing position when using it with an infant weighing less than 26.5 lbs. (12 kg) or less than 1 year old. Rear-facing use is permitted 4 to 55 lbs. (1.8 to 29.5 kg) and is recommended for children less than 2 years old.

- Weight limits: Forward-facing 26–65 lbs (11.8–29.5 kg). Rear-facing 4–55 lbs (1.8–25 kg). Use only forward-facing for children 26.5 to 65 lbs. (12 to 29.5 kg) and over 1 year of age.
- Snugly adjust the belts provided with this child restraint around your child.
- Secure this child restraint with the vehicle's child restraint anchorage system (LATCH) if available or with a vehicle belt.
- NEVER leave a child unattended in the babyark seat.
- NEVER leave the babyark seat or base unsecured in your vehicle even when it is unoccupied. In a crash, it could become a projectile and injure other vehicle occupants.
- Strangulation hazard. NEVER allow children to play with vehicle seat belts. If possible, move unused vehicle belts out of reach.
- Vehicle seat belts must stay tightly adjusted around the base at all times.
- DO NOT use a child restraint system that has been involved in a moderate to severe crash. Refer to **section 11.2** in this manual.
- DO NOT place any objects in the support leg area or in front of the base.
- DO NOT make any changes to the product. It could affect its performance and make it unsafe. NEVER use babyark in any configuration not shown in the instructions.
- Only adults should install and adjust the babyark seat and base.

- Cover the babyark seat when your vehicle is parked in sunlight. Parts of the babyark seat can become very hot if left in the sun and can burn a child's skin. Check for hot parts before putting your child in the babyark seat.
 - The fabric covers contain magnets (for ease of use), which may affect pacemakers. In case your child has a pacemaker - please contact us and we will send you magnet-free fabric covers.
 - DO NOT use this product if it has been modified, damaged or is missing parts.
 - DO NOT remove any labels from the product as they contain important information.
-

The babyark box contains:

1. babyark seat
2. babyark base
3. Infant Insert cushions (See section 6.2).
4. Accessories:
 - 4.1. Magnetic charging cable (See section 6.6)
 - 4.2. Two lower anchor funnels (See section 6.8)
5. User Manual - attached to the seat
6. Registration card - attached to the seat

1. Before you install babyark

Before installing the child restraint system, please download the **babyark app** from the Google Play Store or Apple Store to your mobile phone. The SmrtGide™ step-by-step process in the app, along with the information in this user manual, will also assist you with troubleshooting should you encounter any issue when using babyark.



You can also watch how-to videos in babyark's youtube channel www.youtube.com/@babyark or in the babyark app.

If you encounter any issues please contact babyark customer support at 1-888-922-2927 or at contact@babyark.com for assistance and refrain from using the child restraint system until the issue has been resolved.

babyark is the first digital car seat, designed for children from birth up to 6 years of age, that displays live checks during installation. This helps to ensure safe and correct installation, so parents can easily and confidently install and transfer the baby seat between cars.

babyark is equipped with 14 sensors that monitors the baby seat to provide peace of mind while driving. Correct installation and use is mandatory and you can monitor the correct functionality of your baby seat during use. Please make sure that your child is accompanied by an adult caregiver at all times.

1.1. Safety information

Please be aware of the following safety guidelines:

- babyark includes visual and electronic indicators which reassures you during installation and use that your system is connected and functioning correctly. The guiding lights and app are for reassurance and do not replace the information in this user manual and the parent's own responsibility.
- Weight limits: Rear-facing 4-55 lbs. (1.8-25 kg). Forward-facing 26.5 - 65 lbs. (12 - 29.5 kg).
- In some vehicle seats the babyark base will be above of the vehicle seat (or partially floating). This is not a safety issue thanks to our robust design.

Emissions

The babyark monitor uses BLE (Bluetooth Low Energy) which is about 100 times weaker than that of an iPhone14.

Furthermore, the device is located in the base of the seat, far from the child's body, and only periodically activated, so there is practically no emissions whatsoever.

FCC Compliance - see FCC symbol on bottom label on the base and the seat.

1.2. Your vehicle and babyark – Compatibility

The babyark is certified for use in passenger cars, SUVs, crossovers, vans and light trucks.

Please check that your specific vehicle model appears on this vehicle compatibility list before using your babyark. See list in the babyark app (under car compatibility list) or our website: <https://shop.babyark.com/products/babyark>

Note that seating positions with a storage compartment below the floor can't be used with a support leg.

1.3. Selecting vehicle seating position

babyark should be installed **ONLY** on forward facing vehicle seats. Do **NOT** install babyark on rear-facing or side-facing vehicle seats.

NEVER install babyark in a rear-facing position in a vehicle seat which has an active air bag.

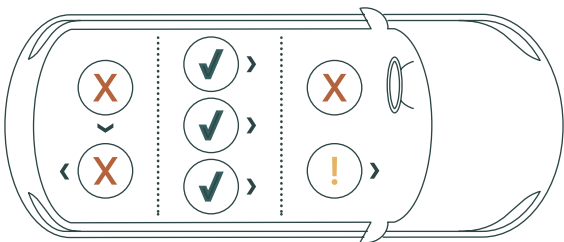

If the vehicle has side airbags, check the vehicle manufacturer's instructions before using babyark in a seating position with side airbags.

It is recommended to install the child restraint system on the rear seat of a vehicle.

According to accident statistics, children are safer when properly restrained in vehicle rear seating positions than in vehicle front seating positions.

1.4. Vehicle seat belts

Vehicle seat belts differ from vehicle to vehicle. Refer to your vehicle owner's manual for specific information about vehicle seat belts and their use with child restraints.

1.4.1 Compatible vehicle belts

Any of the following vehicle seat belt types may be used to install the babyark car seat as long as a secure installation can be achieved and the seating position is approved for installation of a car seat by these instructions and the vehicle owner's manual. If not, move the babyark to another vehicle seating location or try a different installation method.

1. Combination lap & shoulder belts with free sliding latch plates.

Most lap-shoulder belts with free sliding latch plates have a retractor that can be used with a car seat. Check if your vehicle seat belt has a switchable or automatic retractor that locks by slowly pulling the seat belt webbing all the way out until it reaches the end. Then slowly release a few inches of the webbing back into the retractor. Listen for a clicking sound. While still holding the webbing try to then pull out again. If the belt cannot be pulled back out then the retractor is locked and can be used to install the babyark.

Note: If you did not hear clicking and the belt pulls out and cannot be locked it means you do not have a switchable retractor, you have an emergency locking retractor, which **MUST** be used with a locking clip to install a car seat. Please contact babyark (see section 11.5 for all contact details) and we will provide you with a locking clip and installation instructions to lock your vehicle seat belt.

2. Combination lap & shoulder belts with locking latch plates

Locking latch plates hold a car seat secure by keeping the lap belt locked unless the latch plate is tilted. If the lap belt slips/loosens, flip the latch plate over and re-buckle and then test to see if the car seat is held tightly.

3. Lap belts with locking latch plates

Locking latch plates hold a car seat secure by keeping the lap belt locked unless the latch plate is tilted. If the lap belt slips/loosens, flip the latch plate over and re-buckle and then test to see if the car seat is held tightly.

4. Lap belts with locking retractors

Slowly pull the seat belt webbing all the way out until it reaches the end. Then slowly release a few inches of the webbing back into the retractor. Listen for a clicking sound. While still holding the webbing try to then pull out again. If the belt cannot be pulled back out then the retractor is locked and can be used to install the babyark.

DO NOT use a lap belt with a retractor that does not lock.

5. Lap belts with a manual adjustment

A lap belt that is tightened by manually pulling on the loose end will normally hold a car seat tightly. If the lap belt slips/loosens, flip the latch plate over and re-buckle and then test to see if the car seat is held tightly.

1.4.2 Incompatible vehicle belts

DO NOT use the babyark car seat with the vehicle seat belt types listed below:

1. Seat belts that are connected to the door.
2. Motorized/ Automatic seat belt.
3. Inflatable seat belt.
4. A lap belt with a non-locking (ELR) retractor (unless used with a locking clip).
5. Lap & shoulder seat belt with 2 retractors.
6. Lap belt that is forward of the seat bight may not allow a secure installation.

If uncertain, check your vehicle manual for information regarding the vehicles seat belt type and installation requirements.

WARNING! Do not install the babyark in a vehicle seating position that does not allow a secure installation.

2. About the babyark

babyark consists of two separate items which are used together:

1. The ACTV8™ smart base
2. The babyark seat

Download the babyark app from the Google Play Store or Apple Store to your mobile phone.

Note: The babyark seat MUST be used with the ACTV8™ Smart Base

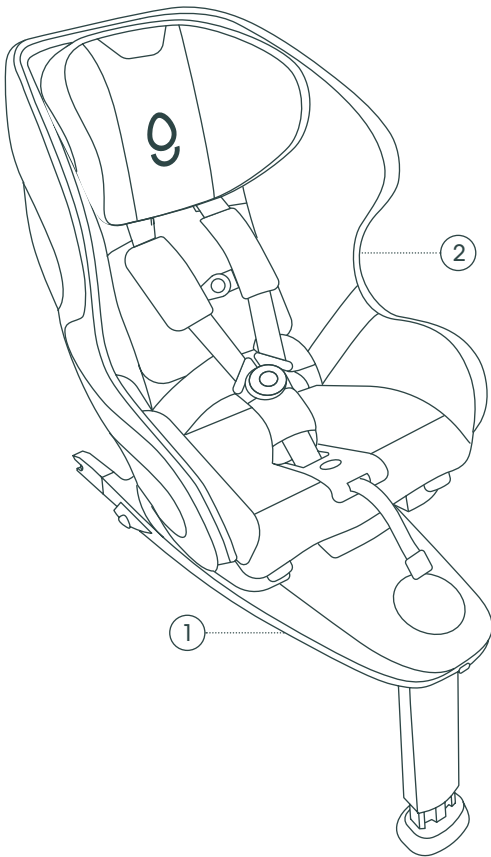

2.1. About the ACTV8™ Smart Base

2.1.1 Features

The ACTV8™ Smart Base connects the babyark seat to your vehicle. The smart base light indicators in conjunction with the user instructions and mobile app will guide you through the car seat installation process.

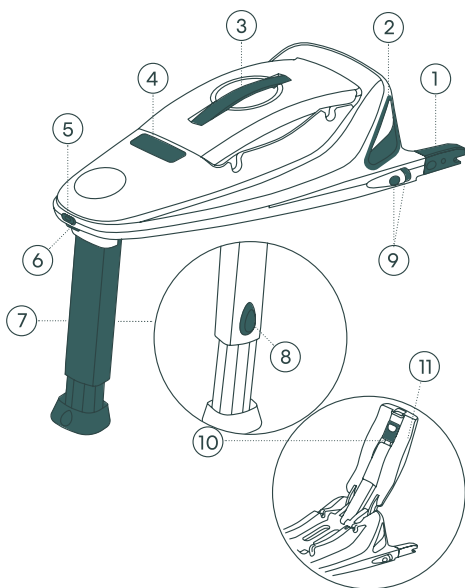

The ACTV8™ Smart Base contains the following features:

1. Lower Anchor connector
2. Vehicle seat belt path
3. Carry handle
4. Anti-rebound bar release button
5. USB charging port
6. Power button
7. Support leg
8. Support leg release button
9. Lower Anchors release button
10. Anti-rebound bar handle
11. Anti-rebound bar

2.1.2. Light indicators

2.1.2.1 Location

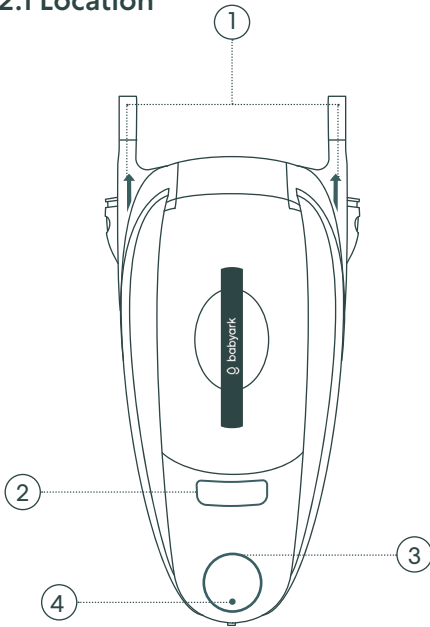

1. Lower Anchor connector guide lights
2. Guide lights for Anti-rebound bar button
3. Safety LED Ring
4. Battery level indicator

2.1.2.2 Operation and status of Guide Lights

Lower anchor connector guide lights:

1. Blinking blue light - lower anchor is not locked.
2. Constant blue light - only this lower anchor is locked, the other side is still not locked.
3. Both arrows are green (for a few seconds, then light goes out) - both lower anchors are locked.

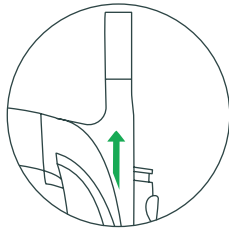
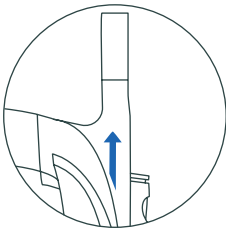

Anti-rebound bar button:

1. Constant blue light - Anti-rebound bar is closed; you can press it to open and place your seat.
2. Constant green light (for a few seconds, then light goes out) - the anti-rebound bar is open.

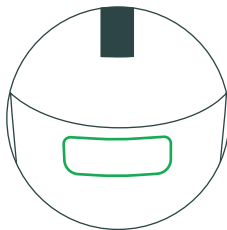
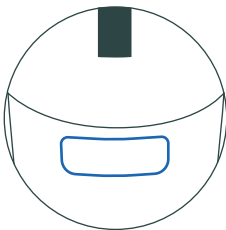

Safety LED Ring:

1. Green – “Confirmation” the stage was performed correctly (LA connector locked/ support leg opened, etc.)
2. Blue – “Child detected” - a child is seated, but not buckled up.
3. Red – “Alert” - something went wrong! Check your installation or open the app to see what went wrong.
4. Circling white – the base is turning on.

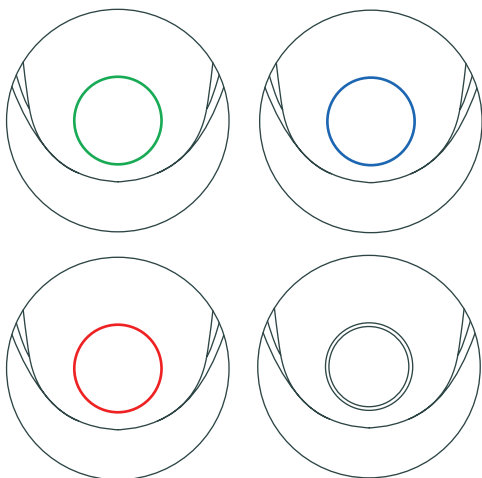

Battery LED indicator:

1. Blinking green – the battery is charging.
2. Blinking red – battery is critically low.

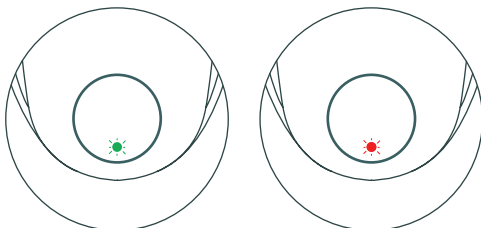

2.1.2.3 Power button

To turn the ACTV8™ smart base on - press the power button, located under the front of the base, quickly. You will see the safety LED ring with circling white light.

To turn the ACTV8™ smart base off - press the power button for a few seconds.

In case the ACTV8™ smart base is not turning on - see section 10.5.

2.2. About the babyark seat

The babyark seat is a convertible safety seat which is uniquely engineered to provide your child with maximum protection.

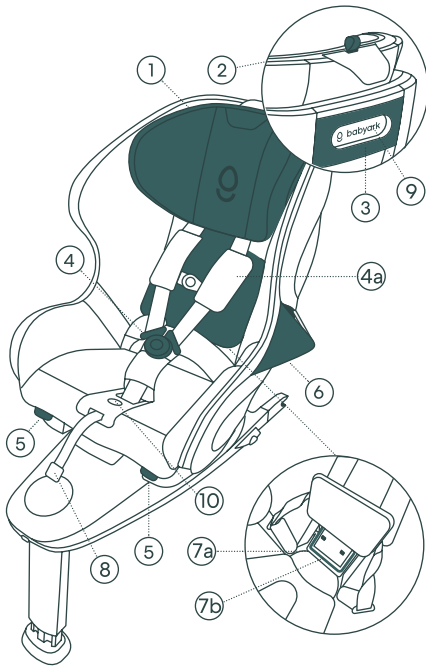

The babyark seat contains the following features:

1. Adjustable JoltFree™ headrest
2. Headrest adjustment loop (under flap)
3. Rear carry handle
4. 5 point harness with buckle
- 4a. Shoulder harness strap with shoulder pad and soft chest clip
5. Recliner lever (both sides)
6. Side protection wing (both sides)
7. Inner carry handle (a) + Safety bar (b)
8. Harness adjustment strap
9. Top tether storage compartment
10. Harness release button

2.3. Safety features

The babyark system contains several unique protection elements:

1. Metal Safety Bar

The babyark seat and ACTV8™ base **MUST** be used together. To eliminate a potential installation error, the user cannot seat, position or restrain a child in the babyark seat until the babyark seat is fully connected onto the base. The black metal safety bar provides an additional safety feature to prevent misuse. It is locked into the upright position when the seat is not connected to the base. By this design, it's impossible to seat, position or restrain a child in the seat when the seat is not locked onto the base. When the seat is properly connected to the base, the safety bar is released and drops down to the back of the seat, under the cushioning.

Make sure you place your child only after the seat is fully connected to the base and the safety handle is in its down position.

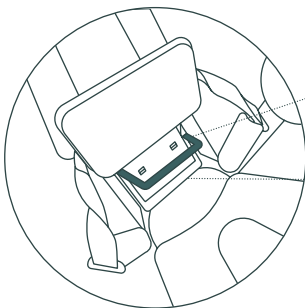

Metal Safety Bar

**Inner Plastic
Carry Handle**

2. ANKR™ rigid no-flex system

The rigid no-flex system, consisting of the support leg, lower anchor connectors and anti-rebound bar, keeps the seat secure at all times, including during an impact, providing a necessary anchor-point to all other shock-absorbing mechanisms at play.

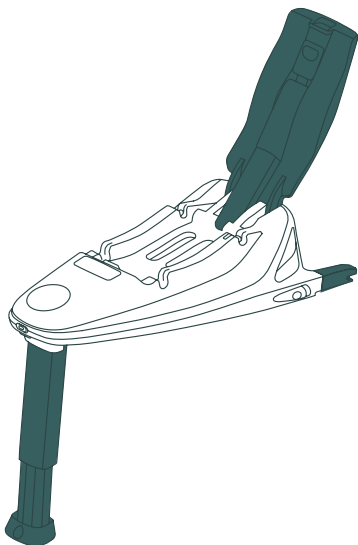

3. Energy absorption

a. BioArk™ side impact protection

Side impact protection system biomimics the woodpecker brain protection mechanism.



b. **Impact activated SafeCoil™ shock absorbing system**

Impact-activated shock-absorbing system, brakes the seat's forward momentum in a controlled and measured manner.

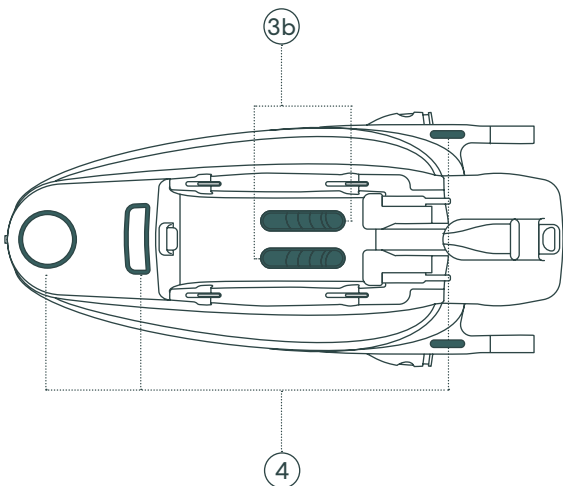

4. **ACTV8™ Smart Base**

A light guiding base, equipped with 14 sensors, that monitors your seat and child.

3. Install babyark

babyark is a state-of-the-art protection system designed for children from 4-65 pounds (1.8-29.5 kg) and whose height is less than 49 inches (124 cm).

3.1. Installation process



Before installing your child restraint system please be aware of the following safety guidelines.

babyark highly recommends to use the babyark on lower anchors of the vehicle's child restraint anchorage system also called LATCH (Lower Anchors and Tethers for Children) in vehicles which have lower anchors fitted onto the car chassis. See Section 3.2. Recommended installation method. Please refer to your vehicle owners manual for further information on LATCH Anchorage System in your vehicle.

WARNINGS

Please reference the vehicle owner's manual for more information.

It is recommended to install the child restraint system on a rear seat of the vehicle.

	<p> WARNING</p> <p>DO NOT place rear-facing child seat on front seat with air bag. DEATH OR SERIOUS INJURY can occur. The back seat is the safest place for children 12 and under.</p> <p><small>© 2012 babyark.com</small></p>
---	---

3.2. Recommended installation method

With lower anchors, support leg and vehicle seat belt.

In order to get the maximum protection from the babyark Convertible Car Seat System - this is the recommended method of installation for children 4-65 pounds (1.8-29.5 kg), rear and forward-facing.

Rear-Facing: 4-55 lbs. (1.8-25 kg)

Lower Anchors + Support leg + Vehicle seat belt (lap or lap & shoulder belt)



» Go to section 3.2.1

Forward-Facing: 26.5-65 lbs. (12-29.5 kg) and at least 1 year of age

Lower Anchors + Support leg + Vehicle seat belt (lap or lap & shoulder belt)



» Go to section 3.2.1

3.2.1 Recommended installation - ACTV8™ Smart Base

Before you begin, check that the seating position you have chosen has lower anchors at the seat bight for that seating location. Location of some vehicle lower anchors will be identified by the LATCH Lower Anchor symbol: 

Refer to vehicle owner's manual for seating locations which have the LATCH anchorage system.

Also check that your vehicle manufacturer allows the following by reading the vehicle owner's manual:

- Placing the support leg on the vehicle floor.
- Installation of a car seat with both LATCH and a vehicle seat belt at the same time.

If not, install the babyark seat and base using an additional installation method. See section 3.3.

Note: In order to use the ACTV8™ Smart Base guiding lights and allow connection to the babyark app for fully guided installation process, make sure the ACTV8™ Smart Base is turned on and charged (section 2.1.2.3)

1. Lift the base using the carry handle. The support leg should fall and lock in place.

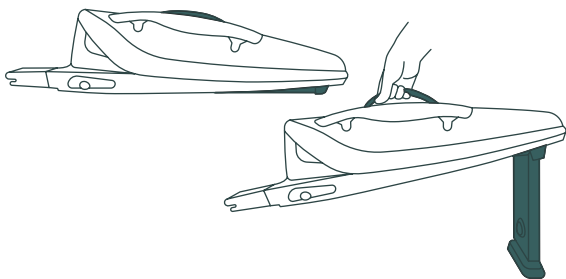

2. Place the ACTV8™ smart base on the rear seat of the vehicle equipped with lower anchors.

Note: You can use the lower anchors funnels provided by babyark to help with the lower anchor installation. See details in section 6.8.

3. Align the lower connectors on the base with the rigid lower anchor bars of the vehicle and push the base backwards until the lower anchor connectors lock onto the rigid lower anchor bars of the vehicle and you hear a click.

Note: Both lower anchor connector buttons will pop out and change from red to green when properly connected.

Check that both lower anchor connector buttons are green and LATCH connectors are securely locked by pulling out on the base.

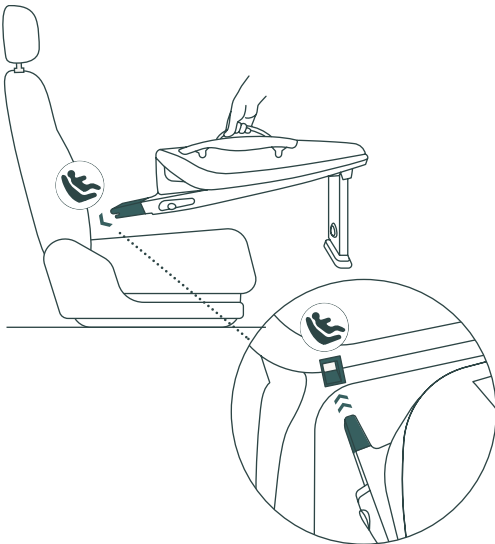

4. Thread the vehicle seat belt through ACTV8™ smart base vehicle seat belt path at back of the base as shown in the image below. Make sure that the vehicle belt is not twisted and then buckle on the seat belt.

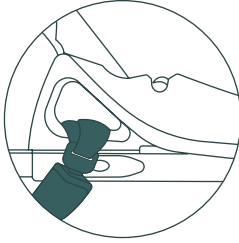

5. Tighten lap belt around the base by pulling the loose end of a lap belt only or by pulling upon the shoulder portion of a lap and shoulder belt to remove belt slack and tighten the lap belt. Check that the lap belt stays tightly adjusted around the ACTV8™ smart base by moving base side to side, If lap belt loosens, see section 3.4.
6. Press the anti-rebound bar release button to open the anti-rebound bar located in the upper section of the ACTV8™ smart base.

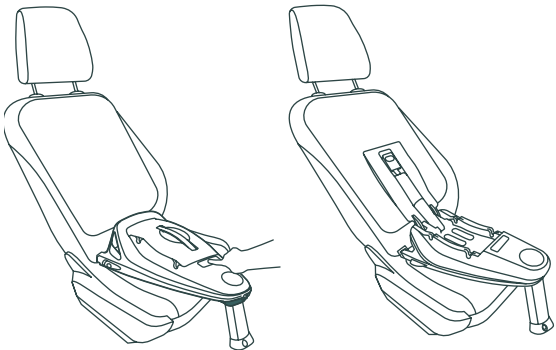

7. Extend the support leg until it reaches the floor of the vehicle (1). Lift the base slightly (2) and continue extending the support leg until you hear a click. After extending the leg, the space between ACTV8™ smart base and vehicle seat should be no more than 1".

Note: Make sure that the anti-rebound bar is touching the vehicle seat back.

In case there is loose or no contact between the anti-rebound bar and the vehicle seat, refer to section 10.4.

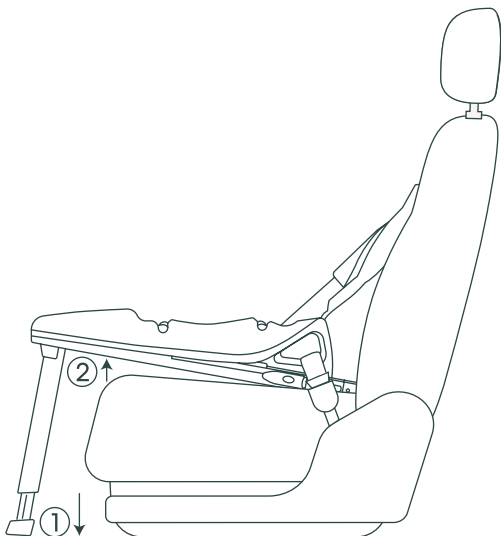

3.2.2 Recommended installation - babyark seat on the base

Please check your state national guidelines concerning minimum age recommendations for children to ride in the forward-facing direction and rear-facing direction.

The babyark seat can be attached to the ACTV8™ smart base in both rear-facing and forward-facing directions:

Rear-Facing:

Children less than 1 year of age and 4-26.5 lbs (1.8-12 kg), must be rear-facing. babyark convertible car seat can be used up to 55 lbs. (25 kg) rear-facing and recommends children be rear-facing until at least 2 years of age.

Some states require that children are kept rear-facing until they are at least 2 years of age.

Please check your local child passenger safety regulation.

Forward-Facing:

For children at least 1 year of age (2 years or older recommended), at least 26.5 lbs (12 kg) and up to 65 lbs (29.5 kg).

Please note that it is recommended to use the rear-facing position for as long as possible as it offers superior protection.

In this method of installation the top tether is not needed, due to the fact that the support leg allows the full utilization of the energy absorption system. Plus, it stabilizes the car seat preventing the forward motion in the case of an impact for both forward and rear installations.

3.2.2.1 Rear-Facing seat installation 4-55 lbs. (1.8-25 kg)

Before placing the seat, ensure latches on the base are open. If the latches are not open, see section 10.6.

1. Lift the seat by means of the plastic inner carry handle under the seat cushioning and the rear carry handle on the back of the seat.

Note: The black metal safety bar is locked in its upright position while the seat is not installed on the base.

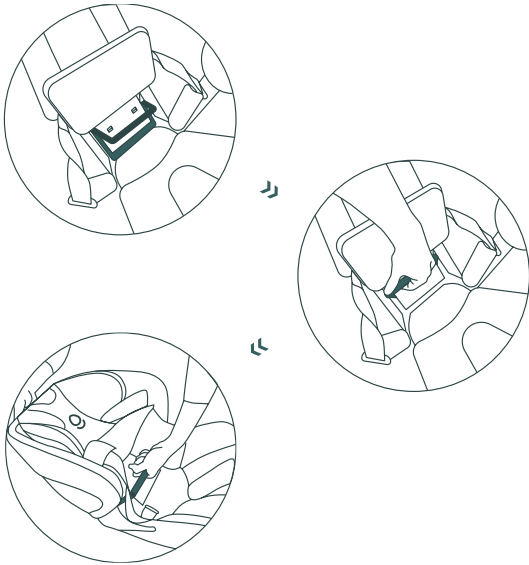

2. With the seat facing the back of the vehicle, lower the seat onto the base and release the inner carry handle to attach the seat onto the four base latches as shown in the images below.

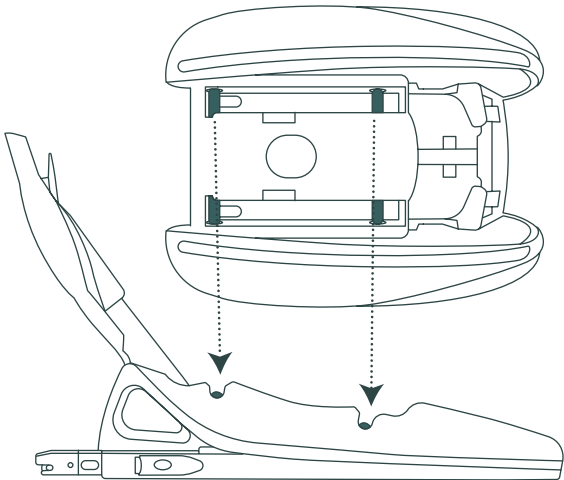

3. Check that the seat is locked on the base securely by pulling up on seat. The metal safety bar should be down (behind the cushion) and the seat should not detach from the base.
4. Adjust the JoltFree™ headrest height according to section 5.2.
5. Adjust seat recline angle into the safe recline zone according to section 5.1.1.
6. If the car seat is installed in an outboard seating position, open the side protection wing on the side next to the vehicle door, see **section 3.5**.
7. Check babyark clearance to vehicle seat in front of it, see section 5.3.
8. Check that seat is correctly installed, see **section 4**.

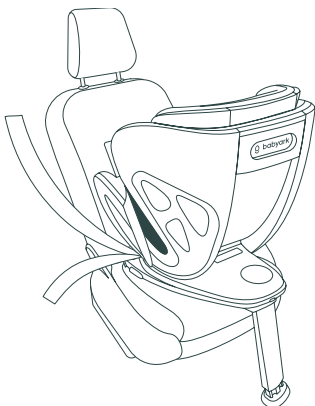

3.2.2.2 Forward-facing seat installation 26.5-65 lbs. (12-29.5 kg)

Before placing the seat, ensure latches on the base are open. If the latches are not open, see section 10.6.

1. Lift the seat by means of the inner carry handle under the seat cushioning and the rear carry handle on the back of the seat.

Note: The black metal safety bar is locked in its upright position while the seat is not installed on the base.

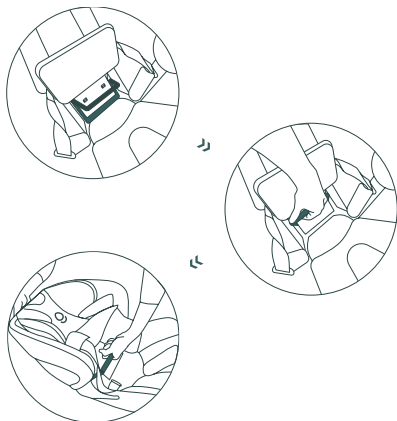

2. With the seat facing the front of the vehicle, lower the seat onto the base and release the inner carry handle to attach the seat onto the four base latches as shown in the images below.

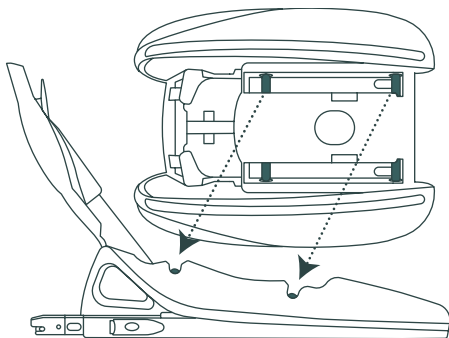

3. Check that the seat is locked on the base securely by pulling up on seat. The metal safety bar should be down (behind the cushion) and the seat should not detach from the base.
4. Adjust the JoltFree™ headrest height according to section 5.2.
5. Adjust seat recline angle into the safe recline zone according to section 5.1.1.
6. If the car seat is installed in an outboard seating position, open the side impact protection wing on the side next to the vehicle door. See section 5.1.
7. Check babyark clearance to vehicle seat in front of it, see section 5.3.
8. Check your seat is correctly installed. **See section 4.**

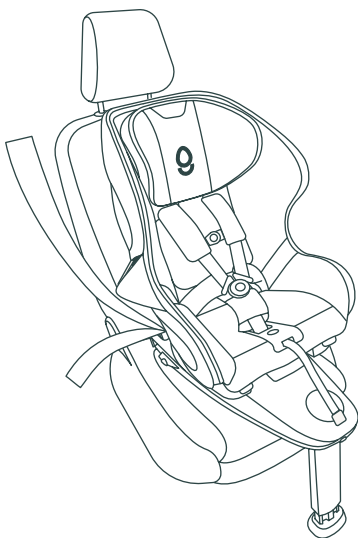

3.3. Additional installation methods

Installation of babyark using the installation methods in this section will not allow you to utilize the full benefits of the system energy absorption. In addition, the Smart Base™ and app will not be able to guide you through the installation process and provide the monitoring and reassurance babyark can provide while using the recommended installation. We suggest to turn off the base in case of installing by the methods detailed below. **babyark recommends installing by the method described in section 3.2.**

Please check your state national guidelines concerning minimum age recommendations for children to ride in the forward-facing direction and rear-facing direction.

The babyark seat can be attached to the ACTV8™ smart base in both rear-facing and forward-facing directions:

Rear-Facing:

Children less than 1 year of age and 4-26.5 lbs (1.8-12 kg), must be rear-facing. babyark convertible car seat can be used up to 55 lbs. (25 kg) rear-facing and recommends children be rear-facing until at least 2 years of age.

Some states require that children are kept rear-facing until they are at least 2 years of age.

Please check your local child passenger safety regulation.

Forward-Facing:

For children at least 1 year of age (2 years or older recommended), at least 26.5 lbs (12 kg) and up to 65 lbs (29.5 kg).

Please note that it is recommended to use the rear-facing position for as long as possible as it offers superior protection.

Rear-Facing
4-15 lbs (1.8-6.8
kg) or 12 months
of age or less
Lower Anchors
only*



» **Go to
section
3.3.1**

*** Do not install by this method for a child weighing more than 15 lbs. (6.8 kg).**

Rear-Facing
4-55 lbs (1.8 - 25
kg) or 12 months
of age or less
Vehicle seat belt
only (lap belt or
lap & shoulder
belt)



» **Go to
section
3.3.2**

Forward-Facing
26.5-65 lbs (12
- 29.5 kg) and
over 12 months
of age
Top tether +
Vehicle seat belt
(lap belt or lap &
shoulder belt)

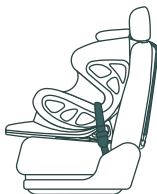

» **Go to
section
3.3.3**

3.3.1 Rear-Facing Lower Anchors only

Warning! Use this method ONLY if your baby is under 15 lbs. (6.8 kg).

Before you begin, check that the seating position you have chosen has lower anchors at the seat bight for that seating location. Location of some vehicle lower anchors will be identified by the LATCH Lower Anchor symbol: 

Refer to vehicle owner's manual for seating locations which have the LATCH anchorage system.

If a seating location without LATCH will be used, install the child restraint system using the seat belt only. See section 3.3.2.

Installation of ACTV8™ Smart Base with lower anchors only:

1. Lift the base using the carry handle and hold the support leg folded underneath, place the ACTV8™ smart base onto the rear seat of the vehicle equipped with lower anchors.

Note: You can use the Lower Anchors Funnels provided by babyark to help with the installation. See section 6.6.

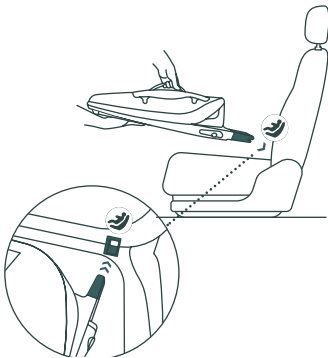

2. Align the lower connectors on the base with the rigid lower anchor bars of the vehicle and push the base backwards until the lower anchor connectors lock onto the rigid lower anchor bars of the vehicle and you hear a click.

Note: Both lower anchor connector buttons will pop out and change from red to green when properly connected.

Check that both lower anchor connector buttons are green and LATCH connectors are securely locked by pulling out on the base.

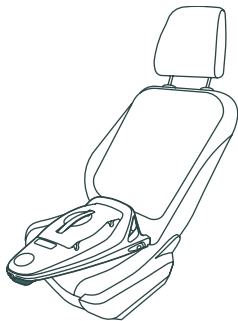

3. Press the anti-rebound release button to open the anti-rebound bar located in the upper section of the ACTV8™ smart base.

Note: Make sure that the anti-rebound bar is touching the vehicle seat back. In case there is loose or no contact between the anti-rebound bar and the vehicle seat, refer to section 10.4.

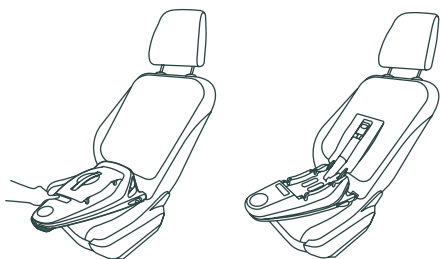

4. Check your installation – the base should not move more than 1” in any direction.

Securing babyark seat onto ACTV8™ Smart Base

5. Before placing the seat, ensure latches on the base are open. If the latches are not open, see section 10.6.
6. Lift the seat by means of the inner carry handle under the seat cushioning and the rear carry handle on the back of the seat.

Note: The black metal safety bar is locked in its upright position while the seat is not installed on the base.

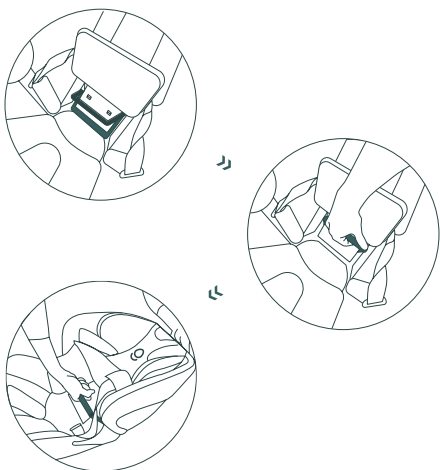

7. With the seat facing the rear of the vehicle, lower the seat onto the base and release the inner carry handle to attach the seat onto the four base latches as shown in the images below.

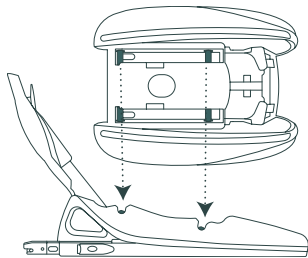

8. Check that the seat is locked on the base securely by pulling up on seat. The metal safety bar should be down (behind the cushion) and the seat should not detach from the base.
9. Adjust seat recline angle by the indicated line on the seat for rear-facing according to **section 5.1.2**.
10. Adjust the JoltFree™ headrest height according to section 5.2.
11. Check babyark clearance to vehicle seat in front of it, see section 5.3.
12. Check that seat is installed correctly, see **section 4**.

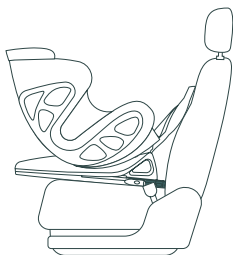

*** Do not install by this method for a child weighing more than 15 lbs. (6.8 kg).**

3.3.2. Rear-Facing vehicle belt only (lap belt or lap & shoulder belt)

Installation of your child restraint system using vehicle seat belt only will not allow you to enjoy the full benefits of the system.

Note: Installing the system this way may result in some wobbling, but the system will remain entirely secure for use. Please make sure the vehicle seat belt is fully tensioned and locked. For the best possible performance, please see section 3.2 for the recommended installation method, which uses lower anchors, a vehicle seat belt, and a support leg.

- Weight for Rear-Facing: 4-55 lbs (1.8-25 kg).

Installation of ACTV8™ Smart Base (with a lap belt or lap & shoulder belt)

1. Lift the base using the carry handle and hold the support leg folded underneath, place the ACTV8™ smart base onto the rear seat of the vehicle.

Important: Place the base as close to the back of the vehicle seat as possible by pushing the lower anchor connectors into the seat bight. Be careful not to damage the upholstery.

Note: You can use the Lower Anchors Funnels provided by babyark to help the lower anchor connectors go further into the vehicle seat bight so that the base is as far back on the vehicle seat as possible. See section 6.6.

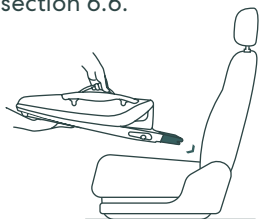

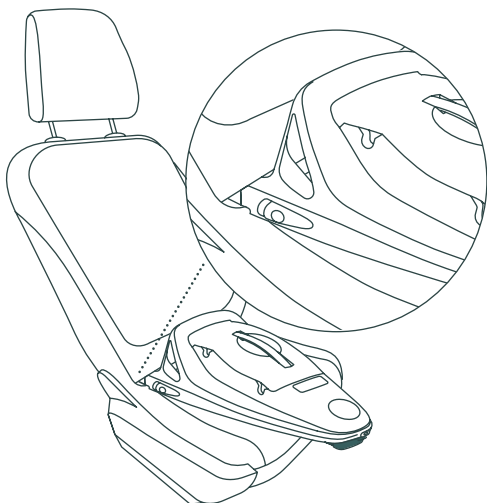

2. Thread the vehicle seat belt through the Belt Path at the back of the ACTV8™ smart base as shown in the image below. Make sure that the vehicle belt is not twisted and then buckle the seat belt.

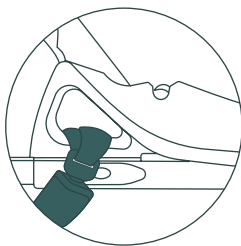

3. Tighten lap belt around the base by pulling the loose end of a lap belt only or by pulling upon the shoulder portion of a lap and shoulder belt to remove belt slack and tighten the lap belt.

Check that the lap belt stays tightly adjusted around the ACTV8™ smart base by moving base side to side, If lap belt loosens, see section 3.4.

4. Press the anti-rebound release button open the anti-rebound bar located in the upper section of the ACTV8™ smart base.
Note: Make sure that the anti-rebound bar is touching the vehicle seat back.

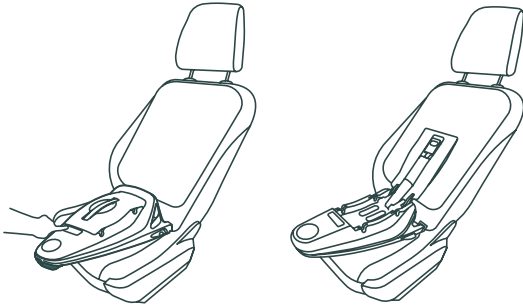

5. Check for secure installation of base.

Note: Installing the system this way may result in some wobbling, but the system will remain entirely secure for use. Please make sure the vehicle seat belt is fully tensioned and locked. For the best possible performance, please see section 3.2 for the recommended installation method, which uses lower anchors, a vehicle seat belt, and a support leg.

Securing babyark seat onto ACTV8™ Smart Base

6. Before placing the seat, ensure latches on the base are open. If the latches are not open, see section 10.6.

- Lift the seat by means of the inner carry handle under the seat cushioning and the rear carry handle on the back of the seat.

Note: The black metal safety bar is locked in its upright position while the seat is not installed on the base.

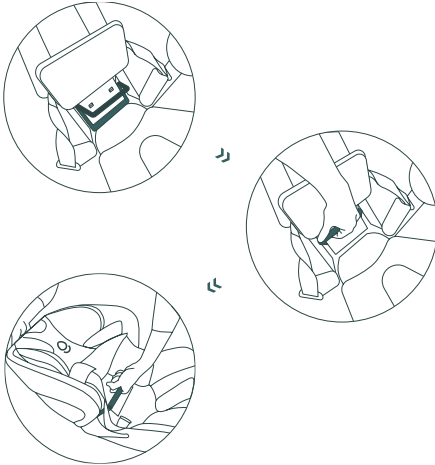

- With the seat facing the rear of the vehicle, lower the seat onto the base and release the inner carry handle to attach the seat onto the four base latches as shown in the images below.

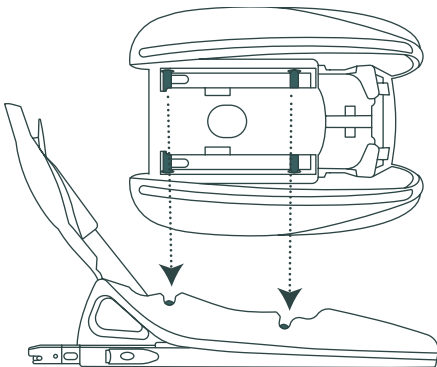

9. Check that the seat is installed on the base securely by pulling up on seat. The safety bar should be down (behind the cushion) and the seat should not detach from the base.
10. Adjust the seat recline angle by the indicated line on the seat for rear-facing according to section 5.1.2.
11. Adjust the JoltFree™ headrest height according to section 5.2.
12. Check babyark clearance to vehicle seat in front of it, see section 5.3.
13. Check that seat is installed correctly, see **section 4.**

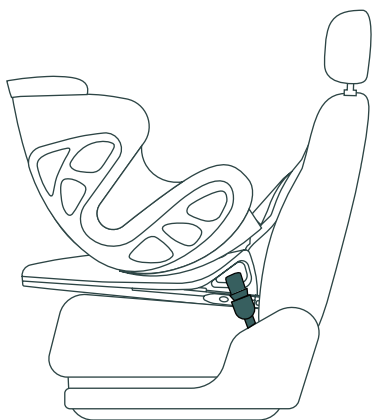

3.3.3. Forward-Facing vehicle belt only (Lap belt or lap & shoulder belt) and top tether

Installation of your child restraint system using vehicle seat belt only will not allow you to enjoy the full benefits of the system.

See section 3.2.1 to realize the full benefits of the system, or see section 3.2 for recommended installation method.

- Weight for Forward-Facing: 26.5-65 lbs (12-29.5kg).

ACTV8™ Smart Base placement

1. Lift the base using the carry handle and hold the support leg folded underneath, place the ACTV8™ smart base onto the rear seat of the vehicle.

Important: Place the base as close to the back of the vehicle seat as possible by pushing the lower anchor connectors into the seat bight. Be careful not to damage the upholstery.

DO NOT attach connectors to the vehicle lower anchors for lap & shoulder belt or lap belt only installations.

Note: You can use the Lower Anchors Funnels provided by babyark to help the lower anchor connectors go further into the vehicle seat bight so that the base is as far back on the vehicle seat as possible. See section 6.6.

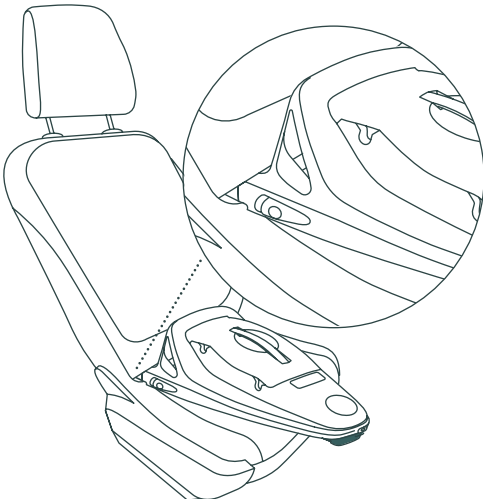

2. Press the anti-rebound release button to open the anti-rebound bar located in the upper section of the ACTV8™ smart base.

Note: Make sure that the anti-rebound bar is touching the vehicle seat back.

In case there is loose or no contact between the anti-rebound bar and the vehicle seat, refer to section 10.4.

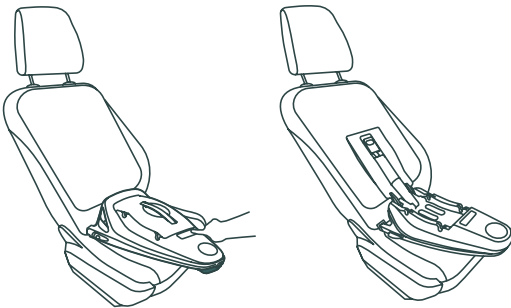

Securing babyark seat onto the Smart Base

3. Before placing the seat, ensure latches on the base are open. If the latches are not open, see section 10.6.
4. Lift the seat by means of the inner carry handle under the seat cushioning and the rear handle on the back of the seat.

Note: the black metal safety bar is locked in its upright position while the seat is not installed on the base.

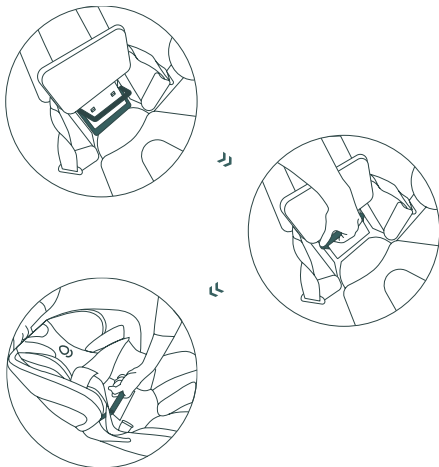

5. With the seat facing the front of the vehicle, lower the seat onto the base and attach the seat onto the four base latches as shown in the images below.

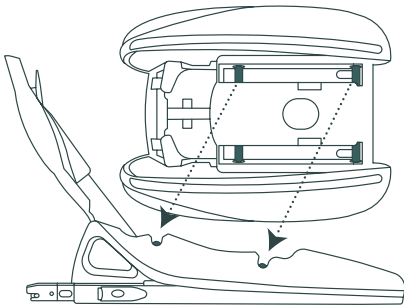

6. Check that the seat is installed on the base securely by pulling up on seat. The safety bar should be down (behind the cushion) and the seat should not detach from the base.
7. Route and buckle the vehicle seat belt as described in the following steps:

When installing with a vehicle seat belt only in forward-facing installation, the seat belt MUST be connected through the forward-facing belt path in the seat and not in the base.

- a. Open the side protection wings on both sides of the babyark seat.
- b. Thread the vehicle seat belt through the forward-facing belt path on both sides of the seat itself. Ensure the vehicle seat belt is not twisted and then buckle the seat belt.
- c. Adjust the seat recline angle by the indicated line on the seat for rear-facing according to section 5.1.2

WARNING! The vehicle seat belt must be routed BELOW the energy absorbing arm on the side protection wing and then goes BEHIND the back cushion of the babyark seat. Detach both snaps of the back cushion to route the seat belt correctly.

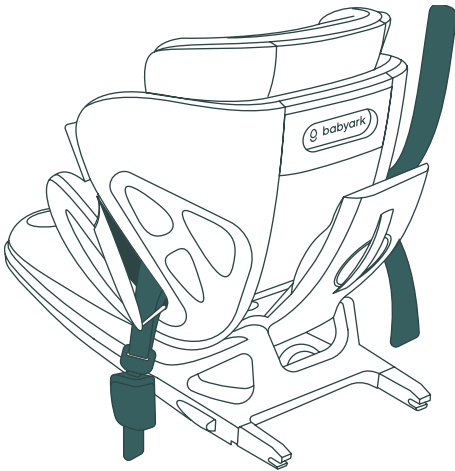
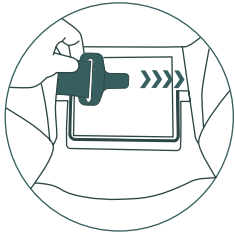
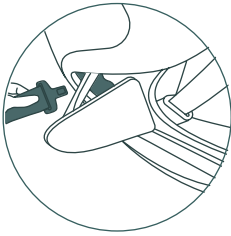
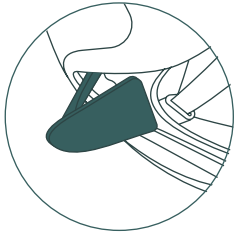

- d. Tighten lap belt around the seat by pulling the loose end of a lap belt only or by pulling upon the shoulder portion of a lap and shoulder belt to remove belt slack and tighten the lap belt.
 - e. Check that the lap belt stays tightly adjusted around the seat by moving the seat side to side, If lap belt loosens, see section 3.4.
8. Close the side protection wings on both sides.
 9. Locate the tether anchor for the seating position being used.

Please refer to the vehicle owner's manual for details on top tether anchor locations in your vehicle and how best to route the tether strap.



Top tether strap MUST always be used when available.

10. Remove the top tether strap from the storage compartment located on the top back of the babyark seat.
11. Thread the strap through the opening in the storage compartment door and the rear carry handle (1).
12. Make the tether strap as long as needed and attach the top tether hook (2) to the vehicle tether anchor (3).

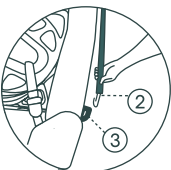
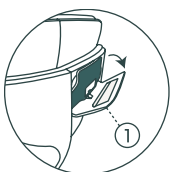

13. Pull the loose end of the top tether strap to remove slack from the strap until it is tight. Close and secure the storage compartment door with both snaps.
14. Adjust the JoltFree™ headrest height according to section 5.2.
15. Check for secure installation: the babyark should not move more than 1" in any direction. If it does, try re-tightening the top tether and the vehicle seat belt and ensure that the lap portion of the vehicle belt is locked.

If you cannot get a secure installation try moving the seat to another seating location or installing using the preferred installation method for forward-facing.

The babyark seat must be in contact with the vehicle seat back as shown. Insert the lower anchor connectors into the vehicle seat bight to ensure contact is made.

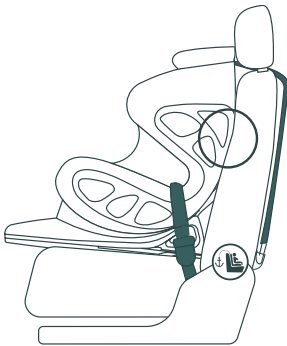

3.4. Locking the seat belt

When installing the babyark using a vehicle seat belt, the babyark **MUST** be held tightly at all times by a lap belt (or lap portion of a lap/shoulder belt) that locks and will not loosen.

Follow all instructions in your vehicle owner's manual and refer to section 1.4 for compatible vehicle seat belt systems and how to lock them. If the vehicle seat belt does not stay tightly adjusted/locked try another vehicle seating location or installation method.

3.5. BioArk™ side impact protection

When the seat is installed in an outboard seating position, the side protection wing on the side closest to the vehicle door should be opened to activate the BioArk™ side impact protection system.

Note: The side impact protection should only be used when using the recommended installation - section 3.2.

3.5.1 To open the side protection wing:

1. When the seat is installed in an outboard seating position, press the button on the side protection wing closest to the car door (1). The side protection impact wing should open slightly.
2. Pull the side protection wing the rest of the way out until it clicks and locks in position (2).

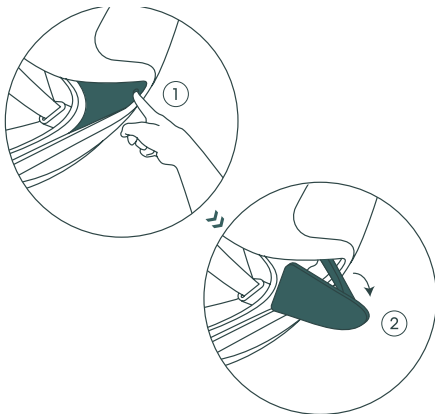

3. Ensure the side protection wing on the internal side of the vehicle is closed, so that it doesn't harm any passenger sitting next to your seat.

3.5.2 To close the side protection wing:

Push the energy absorbing arm inwards (1) and close the wing (2) until it is locked in place.

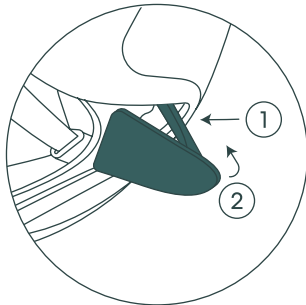

3.6 Top tether

Only use the top tether strap when installing the babyark forward-facing with a vehicle belt only according to section 3.3.3.

3.6.1 To use the top tether strap:

1. Open the outer door (rear carry handle) and then open the inner door (top tether storage compartment) by pulling out on the two upper corners.

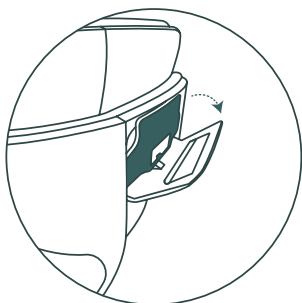

2. Pull out the entire top tether strap, hook and belt adjuster.
3. Thread the strap through the opening in the top tether storage compartment door and the rear carry handle.
4. Close and secure the inner door with both snaps.
5. Make the tether strap as long as needed. Attach and tighten the top tether hook to the vehicle tether anchor per Section 3.3.3

Important: In case the top tether strap is not in use, you **MUST** place it in the designated compartment.

3.6.2 To store the top tether strap:

The top tether strap has a designated storage compartment in the rear top part of the babyark seat.

1. Disconnect the tether hook from the vehicle tether anchor. Insert the hook part to one side of the compartment and the silver buckle to the other side.
2. Open the rear carry handle and pull the tether back through the opening.
3. Open the top tether storage compartment door and pull the tether back through the opening.
4. Insert the hook part to one side of the compartment and the silver belt adjuster to the other side.
5. Fold the rest of the strap in a “snake” shape and place over the hook and buckle in the storage compartment.
6. Make sure you use the entire length of the storage compartment so that the door will close.

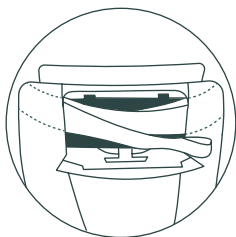

7. Close and secure the storage compartment door with both snaps.

4. Check your installation

1. Check that the seat is facing the correct direction for your child. Always rear-facing for infants 26.5 lbs. (12 kg) or less or 12 months of age or less, less than 2 years of age recommended. Forward-facing for children over 26.5 lbs. (12 kg) or more and over 1 year of age.
2. Check that the seat is placed in an appropriate recline position. See **section 5.1**.
3. Check that the child restraint system is securely installed by holding the seat near to the forward-facing seat belt path and moving it: from side to side, from front to back. The seat should move less than 1" (2.5cm).
 - If the child restraint system moves more than 1" (2.5 cm), check that the LATCH connectors are locked onto the vehicle anchors if used, that the vehicle seat belt, if used, is tight and stays tight, and check that the seat is locked onto the base. Also, refer to the vehicle owner's manual for more information.
 - To minimize movement, it is recommended to install using the lower anchor connectors as explained in **3.2**.
 - If a secure installation cannot be achieved, try moving the babyark to another seating location in the vehicle or installing by a different method.

5. Adjusting your seat

5.1 Recline position

⚠ WARNING

- Only recline positions within the marked “Safe Recline Zone” for Rear-facing and Forward-facing should be used, for ALL methods of installation.
- Proper recline of a rear-facing car seat is required.
 - Too reclined can cause ejection in a sudden stop or crash.
 - Too upright can cause breathing difficulties.

5.1.1 When installing WITH support leg

To recline the babyark seat:

1. Pull one of the recline levers and move the seat to the desired recline position.

Do not use positions marked "NEVER use these recline positions"

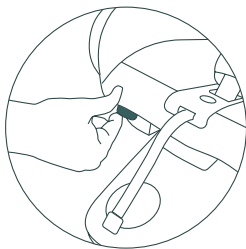

2. Release the lever to lock the seat in place.
3. Check that seat is firmly locked in place; The seat should not move when pushed or pulled.
4. For both rear and forward-facing installations the vertical line on the side of the seat should be within the marked “Safe Recline Zone for Rear-facing and Forward-facing” on the base.

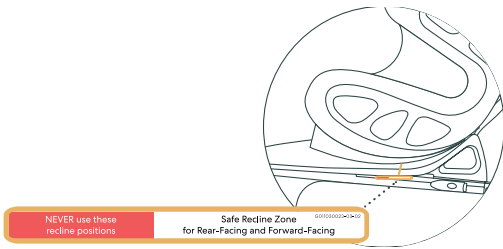

5.1.2 When installing without support leg

In addition to the marked "Safe Zone", you need to make sure the seat is properly reclined in relation to the ground. To ensure this, verify that the line indicated in the label shown below is parallel to the ground.

Note: There is a different line for infants up to 22 lbs. (10 kg) rear-facing only, and for children above 22 lbs. (10 kg) in rear AND forward-facing positions.

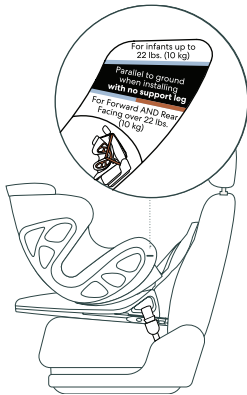

Refer to steps 1-4 in section 5.1.1 for how to move the seat so that the appropriate line on the label is parallel to the ground.

5.2. JoltFree™ Headrest position

The shoulder harness strap should be positioned as follows to properly fit child:

Rear facing



For rear-facing use, adjust the JoltFree™ headrest to position the harness straps at or just below the top of child's shoulders.

Forward facing



For forward-facing use, adjust the JoltFree™ headrest to position the harness straps at or just above the top of child's shoulders.

To adjust the JoltFree™ headrest and shoulder harness strap height:

1. Loosen harness straps by pressing the round harness release button near the crotch belt and pulling the shoulder harness straps out (not the pad).

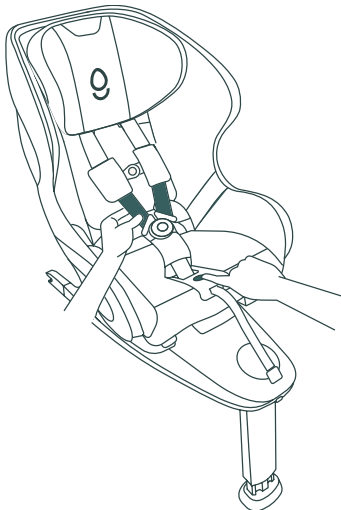

2. Adjust the JoltFree™ headrest height by pulling the headrest adjustment loop on the top of the headrest (under the flap), and moving the headrest up or down to properly fit child, as indicated above for rear or forward-facing.
3. Release the loop and ensure the JoltFree™ headrest is firmly locked in place.



4. For **rear-facing** only: In order to further protect your young child's head while in rear-facing position, open the flap at the top of the headrest and keep it open.

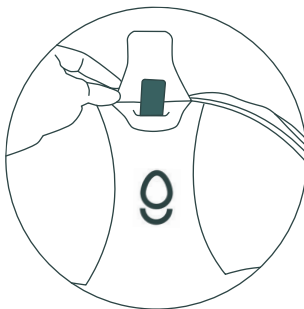

5.3. Seat clearance

The child restraint system must have sufficient space around it in the vehicle to ensure the safety of your child, especially in the case of an accident. In an accident the seat will move slightly in a forward movement in relation to the base, due to the operation of the energy absorption system.

To protect the seat occupant there should be a clearance gap from the child restraint system to the vehicle seat in front of it:

If gap cannot be achieved, move child restraint system to another vehicle seating location that will provide more clearance.

Forward-facing installation:

A clearance of at least 4 inches between the front of the ACTV8™ smart base and the vehicle seat in front of the child restraint system must be kept.

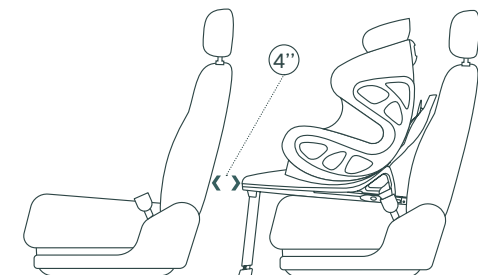

Rear-facing installation:

A clearance correct gap of at least 3 inches between the top rear of the seat (behind the JoltFree™ headrest) and the vehicle seat must be kept. Use the rear handle as a feature to check clearance: If you can fully open it – you're good.

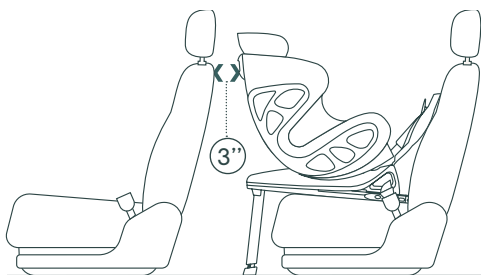

5.4 Changing babyark seat direction

1. Release the seat by one of the options:
 - Fully extend the harness by pressing the harness release button and pull the harness itself (not the pad), then lift the inner carry handle located behind the rear cushion.
 - While pressing the harness release button, lift the seat by the inner carry handle.

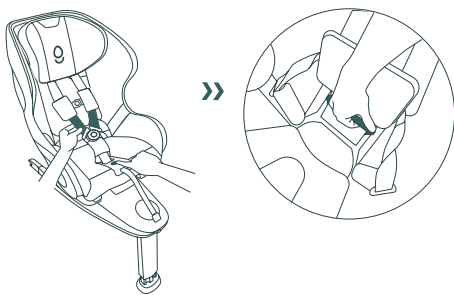

2. Before placing the seat onto the base, ensure latches on the base are open. If the latches are not open, see section 10.6.
3. Turn the seat around so it faces the other direction and place the seat onto the base.
4. Check that the seat is locked on the base securely by pulling up on seat. The black safety bar should be down (behind the cushion) and the seat should not detach from the base.

6. Day to day use of babyark

6.1. Securing your child in babyark

WARNING

- Failure to follow the warnings on the car seat and in this manual or correctly securing your child in the child restraint system may result in serious injury or death in the event of a vehicle accident.
- Your child **MUST** be securely harnessed into the child restraint system at all times when travelling.
- Child must be dressed in clothing with arms and legs that will not interfere with buckling, snugly adjusting or positioning harness.

Correctly secure child by following this step-by-step procedure:

1. Unbuckle harness and place buckle tongues on sides of seat.

You can use the magnets in the upholstery to help with moving the harness away from the seat center.

2. Place your child in the child restraint system with their back flat against the back of the child restraint system. Do not allow your child to slouch when securing them into the child restraint system.
3. Place the harness straps over your child's shoulders. The straps should lie in a flat position without any twists. The shoulder pads can be adjusted using the velcro connection in the back - note there is a marked area for approved location.
4. Check position of shoulder harness straps:

- For rear-facing use, adjust the JoltFree™ headrest to position the harness straps **at or just below** the top of shoulders. To achieve the correct harness fit, the infant insert must be used for children up to 11 lbs. (5 kg).
 - For forward-facing use, adjust the JoltFree™ headrest to position the harness **at or just above** the top of shoulders.
5. Buckle the harness by inserting the buckle tongues one at a time into the buckle. Pull up on each to be sure they are locked.

WARNINGS:

- "Seat Buckled" indicator in the Safety LED Ring and app will indicate "green" when only one buckle tongue is inserted so it is important to insert both tongues and check that both are securely buckled.
- Green indication in the the Safety LED Ring and app for "Seat Buckled" does not indicate that harness is snugly adjusted, only that at least one buckle tongue is engaged.
- If harness cannot be snugly adjusted as described below, **DO NOT** use this car seat.

-
6. Buckle the chest clip and slide the adjustable chest clip up or down so it is placed at the level of the child's armpits.
 7. Tighten the harness fit to achieve a snug level of secure comfort for your child by pulling the harness adjustment strap at the bottom front of the seat.

Important! A snug strap should not allow any slack. It lies in a relatively straight line without sagging. It does not press on the child's flesh or push the child's body into an unnatural position.

8. You should always check if the harness is too loose or too tight for the child passenger by performing a Pinch Test, as follows:
 - Try to pinch along the length of the harness at the shoulder.
 - If harness folds, harness is too loose.
 - To snugly adjust, pull up on the harness from the thigh level.
 - Pull down on the harness adjustment strap at the bottom front of the seat to tighten.
 - Perform the pinch test again.
 - When no pinch is possible the harness is tight enough.
-

Important! Be aware that bulky clothing or blankets can prevent a snug harness fit. Buckle your child in the seat first before placing coats and/or blankets over the harness.

9. Verify that the chest clip is placed at armpit level on the child.

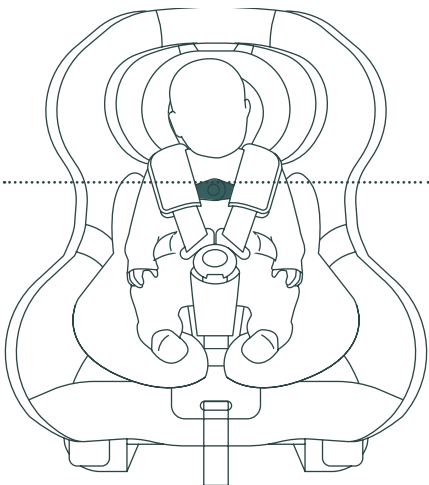

6.2 Adding Infant Insert cushions

For infants up to 11 lbs. (5 kg) you must use the Infant Insert cushions to achieve the correct harness fit.

Place the Infant Insert cushions in the babyark seat and thread the harness as shown in the illustration below.

Discontinue use of Infant Insert cushions when child is more than 11 lbs. (5 kg).

WARNING!

When using the Infant Insert cushions, the forgotten child alert will only be activated once the child is buckled.

The sensors system does not replace guardian responsibility.

NEVER leave your child alone in the vehicle.

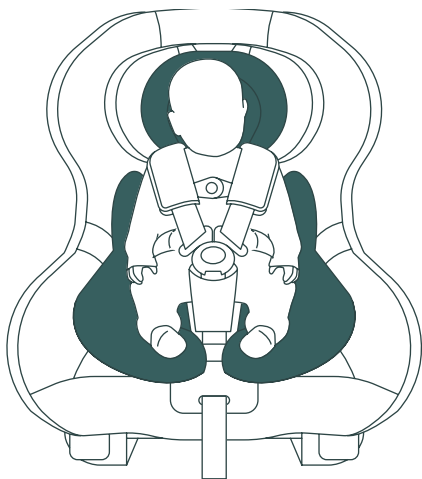

6.3 The cup holder

6.3.1 To attach the cup holder

1. Unzip the zipper, about 1" (2.5cm), on the side of the babyark seat you would like to install the cup holder.

Note: The cup holder arm is two-sided and can be attached on either side of the seat.

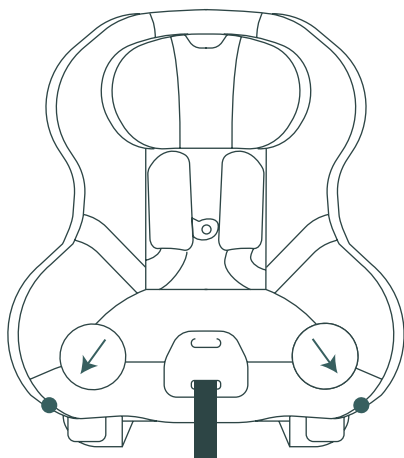

2. Place the cup holder arm into the socket.

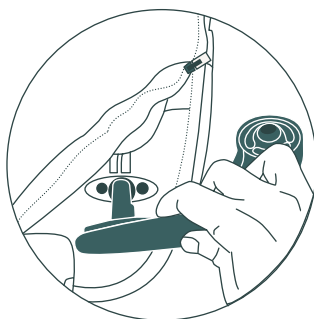

3. Place the cup onto the arm. Note that you hear a “click” when the cup is placed properly.

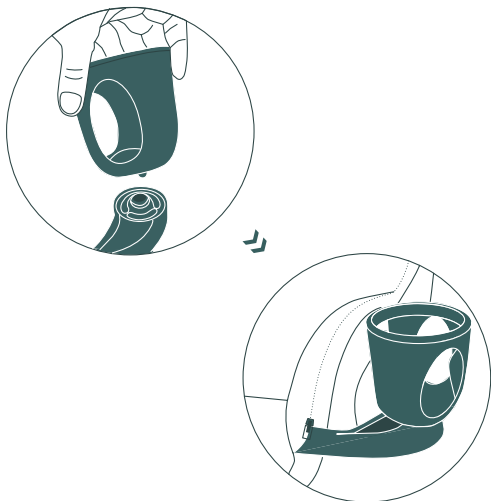

6.3.2 To remove the cup holder

1. Turn the cup clockwise until it clicks and comes off.



2. Pull the cup holder arm gently away from the babyark seat in a straight direction.

6.4 Manual storage location

Important! Keep these instructions for future use. Keep this user manual in its manual storage pocket located on the seat.

1. The storage location of the manual is on the flipped side of the back cushion of the seat (the cushion below the JoltFree™ headrest).
2. Lift the bottom part and insert the manual in the marked pocket.

6.5 ACTV8™ Smart Base charging

In order to operate the ACTV8™ smart base sensors and light indicators, we use a rechargeable battery. You can charge the Smart Base with the magnetic cable we provided with the seat, by connecting it to the charging port in the front of the base.

We recommend to charge the base periodically. The battery LED indicator will light up with flashing green when charging, and red light when the battery is critically low (See section 2.1.2 for light indicators).

WARNING! Strangulation hazard.

When charging the base in a vehicle, the cable should be safely routed to not interfere with any objects or children.

Store the charging cable away from children when not in use.

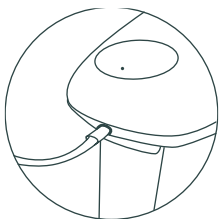

6.6. Lower Anchor Funnels

Some vehicles have their lower anchor bars hidden or covered by the vehicle upholstery at the vehicle seat bight, so, we supplied you with Lower Anchors Funnels (see picture below) that you can attach to your vehicle lower anchor bar to provide access to the lower anchor bars.

To use, position the funnel with the hooks upward and place the funnel over the vehicle lower anchor and attach the plastic hooks of the funnel under and around the bar. Repeat on the other side.

Make sure that the funnel does not interfere with how the lower anchor connectors on the ACTV8 smart base attach to the vehicle lower anchor. If they do, do not use the funnels.

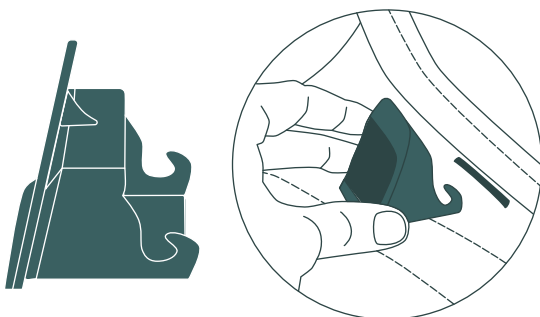

You can also use the funnels when installing the base with vehicle seat belt only as a "spreader" to allow the rigid lower anchor connectors on the base to be placed further back on the vehicle seat.

To use, place the funnels into the vehicle seat bight at the locations where the lower anchor connectors need to be pushed into the vehicle seat bight (not connected to the lower anchors).

7. Uninstall babyark

7.1 Uninstalling the babyark seat

Forward-facing installation with vehicle belt only

1. If the seat is being used forward-facing and installed using the vehicle seat belt:
 - a. You must first unbuckle the vehicle seat belt and pull it through the babyark seat belt path.
 - b. Then disconnect the top tether hook from the top tether anchor in the vehicle and store in the top tether storage compartment on the back of the seat, see section 3.6.2.

Removal of babyark seat from base

2. To remove the seat from the base by one of the options:
 - Fully extend the harness by pressing the harness release button, then lift the inner carry handle located behind rear cushion.
 - While pressing the harness release button, lift the seat by the inner carry handle.

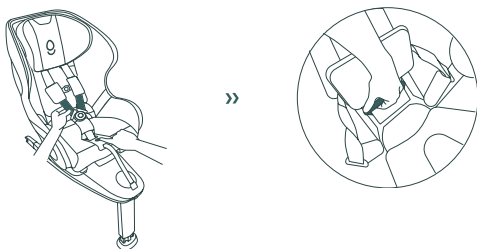

Note: When the seat is not on the base the metal safety bar will stay in its upright position. Do not try to force it down.

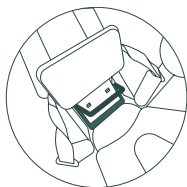

7.2 Uninstalling the ACTV8™ Smart Base

You must remove the babyark seat from the base before removing the base from the vehicle. See section 7.1.

1. Close the anti-rebound bar by lifting and pulling on the anti-rebound bar handle until the anti-rebound bar is locked in the down position.

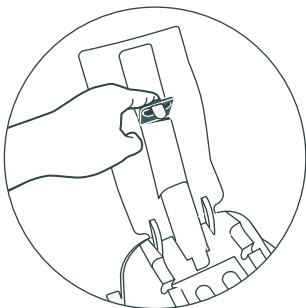

2. If the support leg is in use it must be compressed to the shortest position. Push the button located behind the support leg and lift the bottom of the support leg up until it will go no further, then release the button.

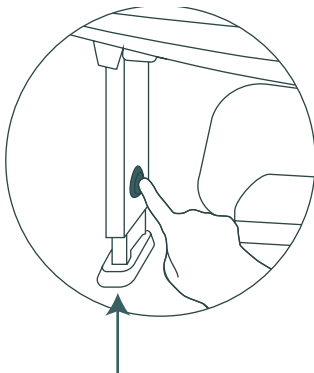

3. If the base is installed using the vehicle seat belt - unbuckle the vehicle seat belt and remove it from the belt path on the base.
4. If the base is installed using the LATCH lower anchor connectors - Push and hold the Lower Anchor Release Button (1) and then push the Lower Anchor Lock Button (2) on each of the lower anchor connectors (one on each side of the base) and pull the base forward, away from the vehicle seat back (3).

Note: The release button is "double-action" so both buttons must be pressed, 1 then 2, for the connector to release from the vehicle anchor.

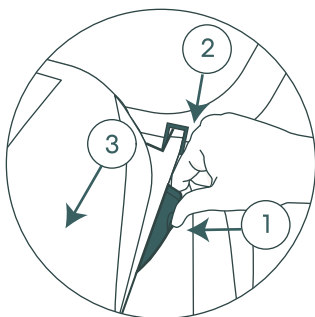

5. Fold the support leg under the base by pulling down on the upper part of the support leg while rotating towards the bottom of the base.

Note: The support leg cannot be locked in the folded position and will fall freely once you lift the base unless you hold it in place.

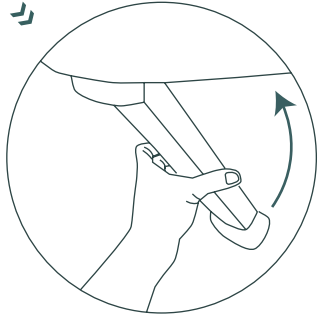
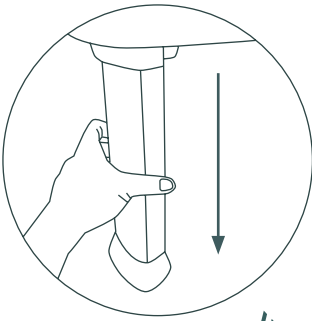

6. You can now remove the base from the vehicle seat by using the base carry handle.

8. Care and cleaning

8.1 Cleaning

Avoid getting any dirt or sand in between the babyark seat and the ACTV8™ smart base as this can negatively impact to the seat latching and recline functions.

Please remove any dirt or sand from the bottom of the seat before placing on the base and vacuum the base if any dirt/sand is present to avoid permanent damage to the child restraint system.

Base, harness straps and plastic parts on seat

If the base, harness or non-fabric parts of the seat must be cleaned, wipe with a damp cloth.

Do not use lubricants, solvents, soap, bleach or other household cleaners.

Do not over-wet the base as it contains electronic components. Especially the charging port in the front of the base.

Buckle and Lower Anchor Connector hardware

Buckle and connectors can be rinsed under warm running water.

DO NOT use detergents or lubricants.

Ensure the base does not get wet when cleaning the lower anchor connectors.

Fabric and cushion care:

Fabric cushions can be spot cleaned using warm water with mild detergent.

For a more thorough cleaning, remove them as instructed below and follow the washing instructions provided on the care label sewn to the inside of each cushion.

8.2. Fabric cushion removal and installation

You can also watch how-to videos in babyark's youtube channel www.youtube.com/@babyark or in the babyark app.

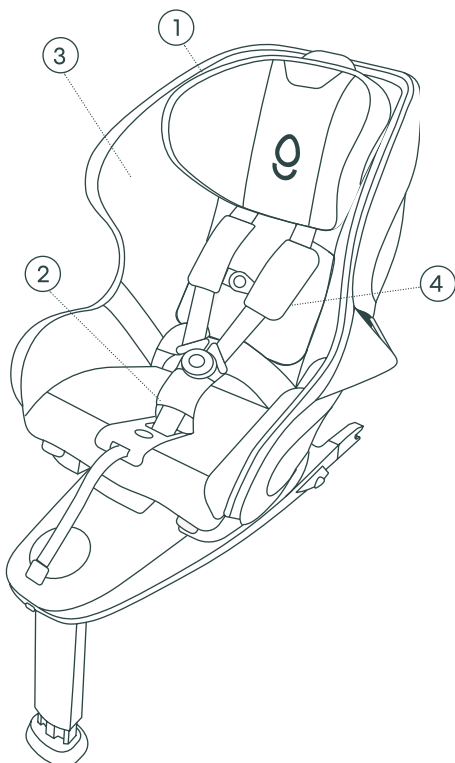

1. JoltFree™ Headrest

- To remove the headrest cover, unzip the headrest upholstery all the way and remove it.
- To install the headrest cover, reverse the removal procedure.

2. Crotch belt cover

- To remove the crotch belt cover, open the belt buckle.
- Detach the snap and remove the crotch belt cover by pulling it up over the buckle.
- To install the crotch belt cover, reverse the removal procedure. Note: Make sure to insert the plastic tab located behind the buckle into the inner pocket on the crotch belt cover.

3. Seat upholstery

- To remove the seat upholstery, disconnect the 2 snaps in the front of the seat.
- Pull the zipper from both sides of the seat all the way up.
- Detach the 2 snaps attaching the seat upholstery to the back cushion.
- Detach the snaps for the lap belts covers on both sides.

Note:

- There is a safety plate in the back cushion pocket. Make sure to put it back when re-installing the upholstery.
- The seat upholstery is tucked under the plastic cover in the crotch area and needs to be pulled out. (Note the fabric will need to be tucked back under the plastic part when re-installing the seat upholstery).
- There is a pocket in the bottom of the seat with a plastic part inside - it is safe to wash and should not be removed.

In case it is removed, you **MUST** put it back to ensure functionality of the seat.

- Remove the zipped cover of the seat upholstery.
- To install the seat upholstery, reverse the removal procedure.

4. Shoulder pads

- Open the chest clip
- Detach the snaps from each shoulder pad and move the shoulder harness aside.
- Disconnect the pad from the hook and loop fastener.
- Remove the pad.
- To install the shoulder pads, reverse the removal procedure.

Note: The green line on the shoulder pad should be between the green lines on the hook and loop.

Warning! The Fabric cover/upholstery is a safety feature and the babyark seat should never be used without it.

The fabric covers contain magnets (for ease of use), which may affect pacemakers. In case your child has a pacemaker - please contact us and we will send you magnet-free fabric covers.

8.3 Storage of babyark

If the child restraint system is not in use for an extended period of time, the seat and Smart Base should be removed from the vehicle and placed in a cool, dry storage location.

9. Use on an Aircraft

This Restraint is Certified for Use in Motor Vehicles and Aircraft.

It is strongly recommended that children should be secured in child seats during airline travel. Contact airlines about their policy on use of child restraints before traveling.

You can use the babyark system (seat and base) on an aircraft on forward-facing aircraft seats only.

Please refer to sections on vehicle belt only installation, sections 3.3.2 rear-facing and 3.3.3 forward-facing.

Note:

- On an aircraft, top tether use is not required.
- The seat clearance stated in **section 5.3** are not mandatory on an aircraft.

10. Troubleshooting

Should you encounter any issues when using babyark, or the proposed solutions below does not work, please call Customer Support at 1-888-9BABY-ARK. (1-888-922-2927).

10.1. Anti-rebound bar locked

The anti-rebound bar is a safety feature that locks during an accident. In case it locks during a normal car ride (very bumpy road or other reasons) - you can unlock it by pushing it backwards (towards the back of the vehicle seat) and forward again by pulling the anti-rebound bar handle.

10.2. babyark seat will not lock onto base

The inner carry handle must be in its lowest position, flush with the seat back to lock the seat onto the base. Check that there is nothing interfering with the handle.

10.3. Support leg not indicating it is fully extended

The support leg must be in contact with the vehicle floor in order to indicate that it is fully extended. Lift the base slightly and continue extending the leg until you hear a click, then lower the base.

If there is still no indication for an extended support leg, gently press down on the front of the base.

10.4. Anti-rebound bar not in contact with the vehicle seat back

For all installations:

If the vehicle seat back is adjustable, adjust seat back into the most upright position then close and re-open the anti-rebound bar.

For installations using support leg:

If the anti-rebound bar is fully opened and still not in contact with the vehicle seat back, you can extend the support leg further until there is contact between the vehicle seat and the anti-rebound bar.

10.5. ACTV8™ smart base doesn't turn on

If pressing the power button doesn't result in the Safety LED ring circling white light (the smart base is turning on):

1. Press and hold the power button for a few seconds, to turn the smart base off and then try turning it back on, by briefly pressing the power button.
2. Charge the smart base (section 6.5) and try turning it on after a few minutes.

10.6. Base latches are closed on ACTV8™ Smart Base

If the base latches are closed before placing the seat, push the pins down until the latches open so you can place and lock the babyark seat on the base.

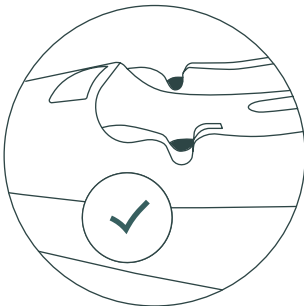
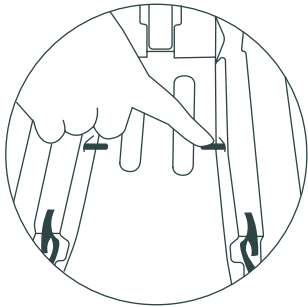
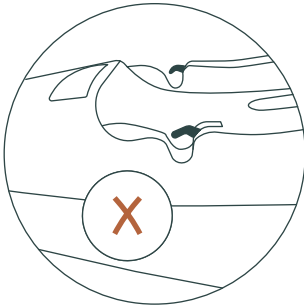

11. Important information

11.1. Warranty

For warranty details see babyark website www.babyark.com/warranty.

If you need to make a claim, please contact babyark Inc. (see Section 11.5 for contact information).

11.2. Use of babyark after a crash

US National Highway Traffic Safety Administration recommends that child restraint systems should be replaced following a moderate or severe crash in order to ensure a continued high level of crash protection for child passengers.

The Agency further states that child restraint systems do not automatically need to be replaced following a minor crash. NHTSA defines a minor crash as one in which ALL of the following apply:

- The vehicle was able to be driven away from the crash site.
- The vehicle door nearest the car seat was not damaged.
- None of the passengers in the vehicle sustained any injuries in the crash.
- If the vehicle has airbags, the airbags did not deploy during the crash
- There is no visible damage to the car seat.

babyark's advanced sensors and diagnostic system enable easy determination as to whether the crash was severe enough to activate the SafeCoil™ energy-absorbing system and whether the impact exceeded a certain threshold and need to be replaced.

babyark must be replaced following a crash if:

- The app directly notifies you of the need to replace babyark.
- The SafeCoil cylinders viewed on the base are elongated (see section 3.b).
- The top shell (color gray/white) and the bottom shell (black) are no longer aligned (see illustration below).

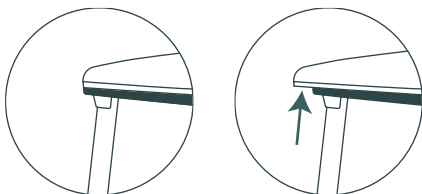

11.3. No set expiration date

The babyark convertible has no set expiration date. For further details visit babyark website www.babyark.com/warranty.

11.4. Registration and recall

Child restraints could be recalled for safety reasons. You must register this restraint to be reached in a recall.

Send your name, address, e-mail address if available, and the restraint's model number and manufacturing date to:

babyark Inc. 2000 Ponce de Leon Blvd. Coral Gables, Florida 33134, USA or call 1-888-9BABY-ARK. (1-888-922-2927).

Or register online at: www.babyark.com/register

If you are using the app (recommended), you are already registered!

For recall information, call the U.S. Government's Vehicle Safety Hotline at:

1-888-327-4236 (TTY: 1-800-424-9153)

or go to <http://www.NHTSA.gov>.

Please note the following:

If you choose not to use the app, please go to babyark.com/register or you can fill out the prepaid registration postcard attached to the seat pad and mail it.

On the product registration form, please provide the following details: Model No. and Manufactured Date.

The model number and "manufactured in" date are located on a label on the bottom of the child restraint system, as shown below.

	Model Name: The Base
babyark inc. 2000 Ponce de Leon Blvd. Coral Gables, FL 33134, USA	Model Number: G011030010
1-888-9BABY-ARK (1-888-922-2927)	MAC address:
www.babyark.com • Made in China	Serial Number:
	Manufactured in:

.....

This child restraint system conforms to all applicable Federal motor vehicle safety standards. **This Restraint is Certified for Use in Motor Vehicles and Aircraft.** Child restraints could be recalled for safety reasons. You must register this restraint to be reached in a recall. Send your name, address, email address if available and the restraint's model number and manufacturing date to **babyark inc.** 2000 Ponce de Leon Blvd. Coral Gables, FL 33134, USA or call 1-888-9BABY-ARK (1-888-922-2927) or register online at www.babyark.com/register. For recall information, call the U.S. Government's Vehicle Safety Hotline at 1-888-327-4236 (TTY: 1-800-424-9153) or go to <http://www.NHSTA.gov>.

.....

The babyark Convertible has no set expiration date (for further details visit [babyark website](http://babyark.com)).

WARNING! • Discontinue use if car seat is damaged or broken. • NEVER use this car seat after a crash unless crash and car seat meet ALL conditions in "Use of babyark after a crash" section in the instructions manual. • Read all instructions before using this product. • If instructions are missing or if any questions arise you should immediately contact us at 1-888-922-2927 or go to www.babyark.com to contact customer support. G011030020-00-02

11.5. Contact babyark

mail: babyark inc.

2000 Ponce de Leon Blvd.

Coral Gables, Florida 33134

USA

call: 1-888-9BABY-ARK (1-888-922-2927)

email: contact@babyark.com

visit: www.babyark.com

babyark Inc.

2000 Ponce de Leon Blvd.
Coral Gables, Florida 33134
USA

1-888-9BABY-ARK
(1-888-922-2927)

www.babyark.com