

Velobike

Velobike M2 Frameset Manual



This document relates to the following framesets

- Velobike M2 - XL (SKU: VB-F-M2-XL)
- Velobike M2 - L (SKU: VB-F-M2-L)
- Velobike M2 - M (SKU: VB-F-M2-M)
- Velobike M2 - S (SKU: VB-F-M2-S)
- Velobike M2 - XS (SKU: VB-F-M2-XS)

Specifications

- Frameset weight: 1850g +/- 50g (Size Large)
- Bottom Bracket Interface: BSA
- Tire Clearance: 700x25c
- Chainring Clearance: 70 tooth (42mm Chainline)
- Dropouts: 120mm M10 Bolt-on (Rear), 100mm M9 Bolt-on (Front)
- Material: Japanese Toray T1000 and T700 Carbon Fibre

Velobike M2 Frameset Geometry

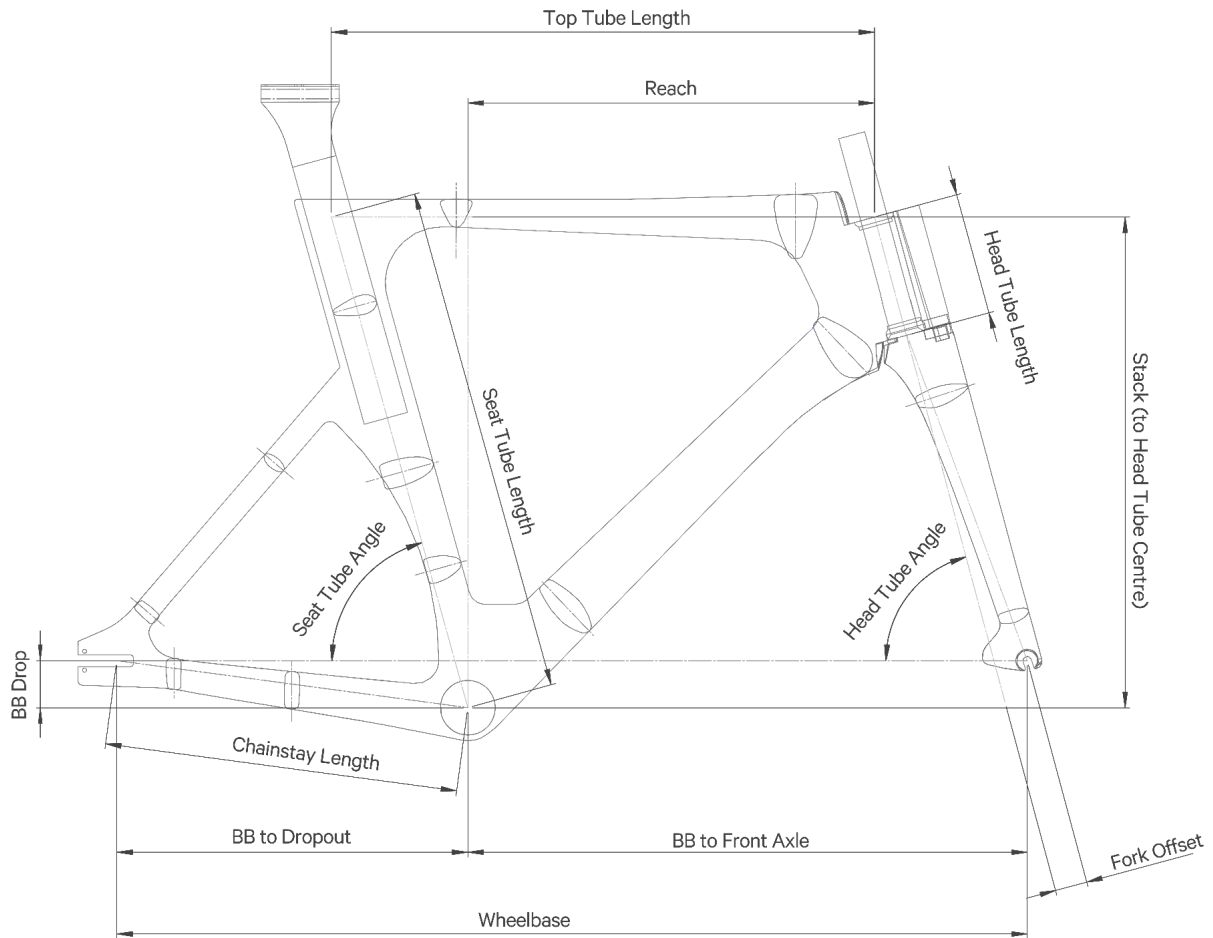

	XS	S	M	L	XL
Top Tube Length	516	535	556	575	595
Seat Tube Length	501	508	520	534	562
Reach	383	396	413	430	450
Stack	484	502	516	522	548
Head Tube Length	95	110	124	130	155
Head Tube Angle	73°	74.5°	74.5°	74.5°	74.5°
Seat Tube Angle	74.5°	74.5°	74.5°	74.5°	74.5°
Fork Offset	35	35	35	35	35
BB Drop	50	50	50	50	50
Chainstay Length	380	380	380	380	380
BB to Dropout	377	377	377	377	377
BB to front Axle	551	552	573	592	619
Wheelbase	928	929	950	969	996

Tools needed for assembly

- Allen Key Set
- 8mm Wrench
- Grease
- Loctite #242 or #243
- Clean Rags
- Carbon Paste
- Torque Wrench and Hex bits
- Extension for Hex Bit or Extended 5mm Hex Bit
- Park Tool SG 7.2 - Oversized Adjustable Saw Guide



Seatpost Clamp

SKU: VB-F-M2-A01

1x Seatpost Clamp included per frameset

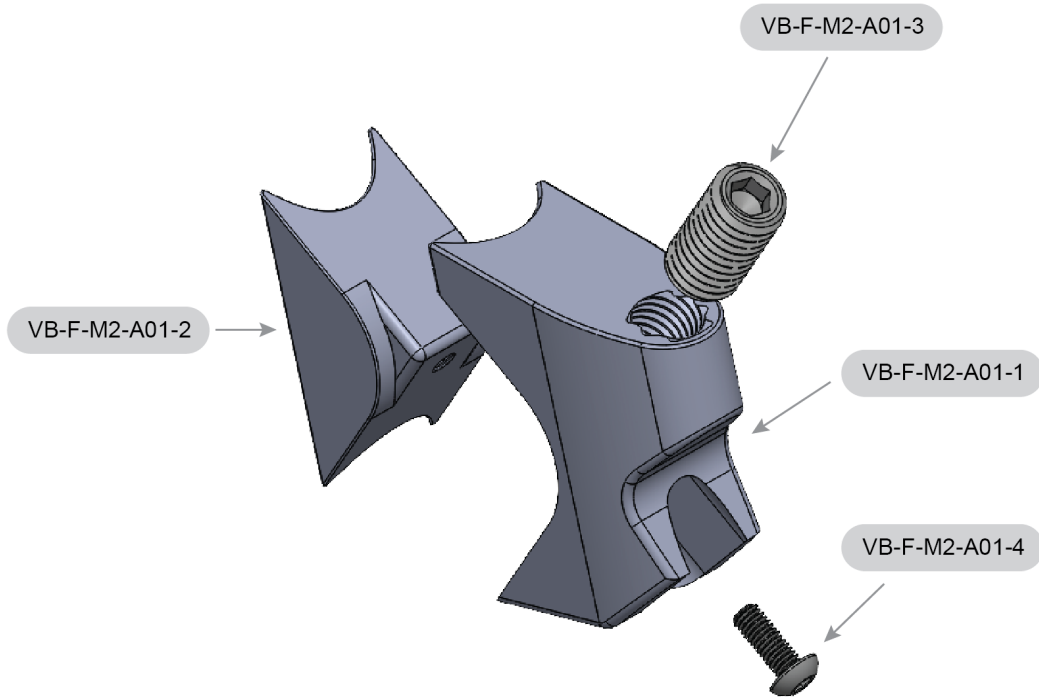

Part	SKU	Details
Seatpost Clamp Block	VB-F-M2-A01-1	
Seatpost Clamp Wedge	VB-F-M2-A01-2	
Seatpost Clamp Grub Screw	VB-F-M2-A01-3	M8x1.25 16mm Grub Screw Stainless Steel 4mm Hex Key Right hand thread 5.5Nm Max
Seatpost Clamp Screw	VB-F-M2-A01-4	M3x0.5mm 8mm Button Head Stainless Steel 2.5mm Hex Key Right hand thread

Seatpost Clamp Installation

1. Apply a drop of blue Threadlocker (Loctite #242) on the bolt threads
2. Apply grease on the seat post clamp and on the screws
3. Assemble the seat post clamp with the small screw (VB-F-M2-A01-4), allowing the parts (VB-F-M2-A01-1 and VB-F-M2-A01-2) to move freely
4. Place the seat post collar inside the frame, holding it to prevent it falling inside the frame
5. Insert the seatpost, on which some carbon fibre assembly paste has been applied
6. Position the seatpost to the desired height
7. Tighten the set screw (VB-F-M2-A01-3) at **5.5Nm**

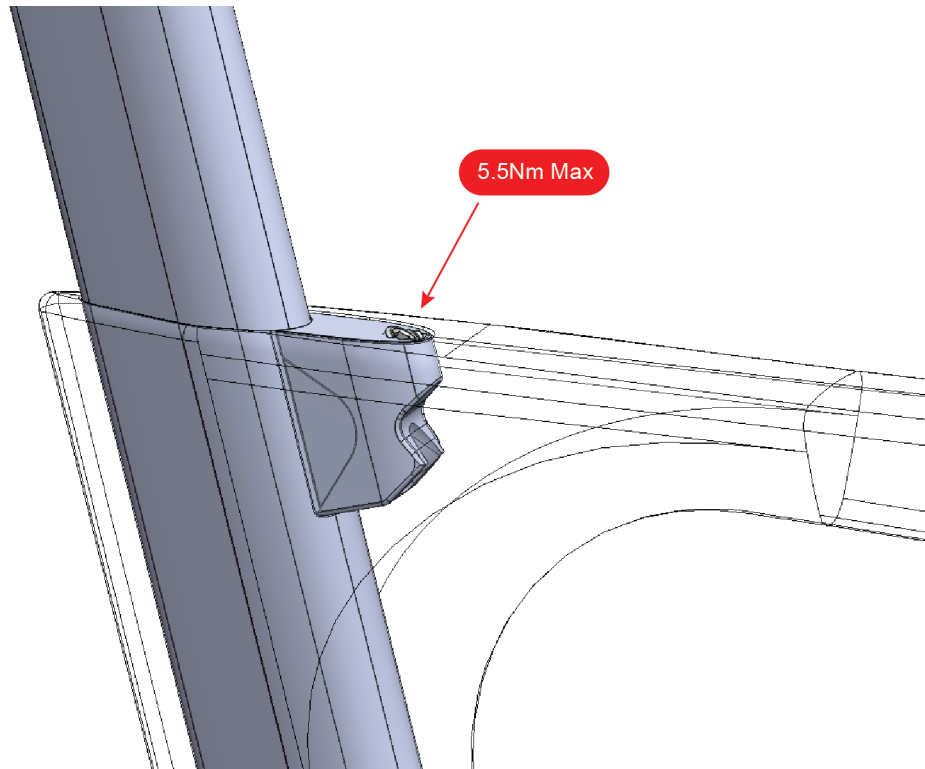

Minimum and Maximum Seatpost Extension

- Minimum Seatpost Insertion: 80mm
- Maximum Seatpost Insertion: 5mm above bottoming out
- The Seatpost might need to be cut depending on desired saddle height
- Use Park Tool SG 7.2 to cut seatpost

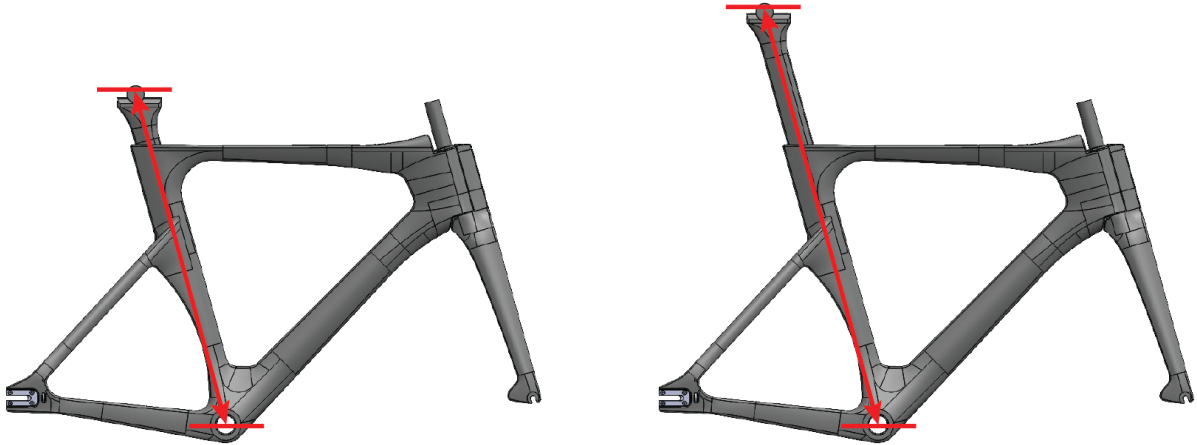

Frame Size	Minimum (mm)	Maximum (mm)
XS	597	797
S	604	804
M	616	816
L	630	830
XL	658	858

Measurement is taken from the centre of the bottom bracket to the saddle clamp. Add on the height of your saddle for a true height value.

Dropouts

SKU: VB-F-M2-A02

2x Dropout sub-assemblies Included per frameset



Part	SKU	Details
Dropout Plate Outer	VB-F-M2-A02-1	
Dropout Plate Inner	VB-F-M2-A02-2	
Dropout Plate Screw	VB-F-M2-A02-3	x4 Per Assembly M4x0.7 8mm Countersunk Screw Stainless Steel 2.5mm Hex Key Right hand thread 1.5Nm Max
Dropout Tensioner Block	VB-F-M2-A02-4	

Dropout Tensioner Screw	VB-F-M2-A02-5	M5x0.8 40mm Threaded Set Screw Stainless Steel
Dropout Tensioner Dial	VB-F-M2-A02-6	M5x0.8 40mm Threaded Set Screw

Rear Dropouts Adjustments

Turning the adjustment knob will allow you to set your dropouts to the desired position. This allows the bike to keep the perfect chain tension and wheel alignment every time.

Dropouts allow for a maximum of 30mm wheel adjustability.

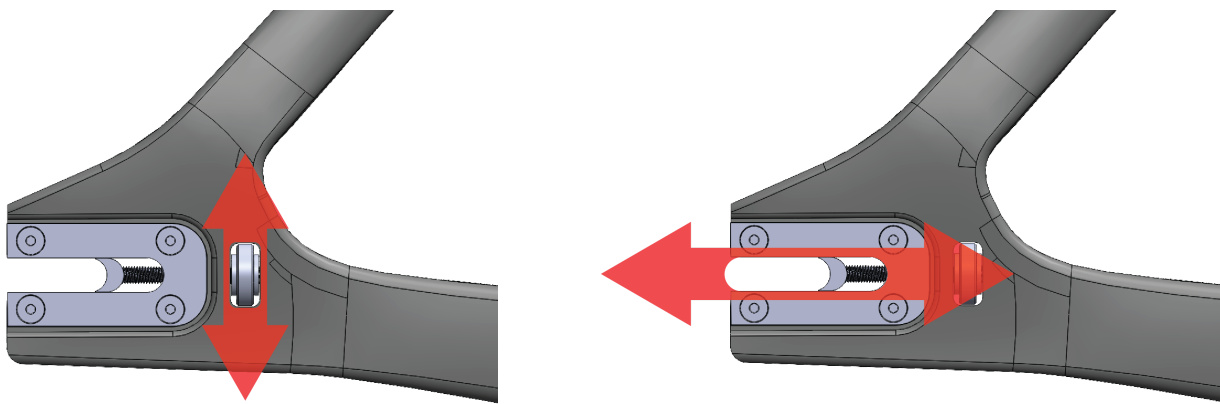

Fork Limit Screw

Threaded in on the underside of the headtube. This screw stops over rotation of the fork. Removing this screw may result in damage to the frame and fork if over rotation occurs.

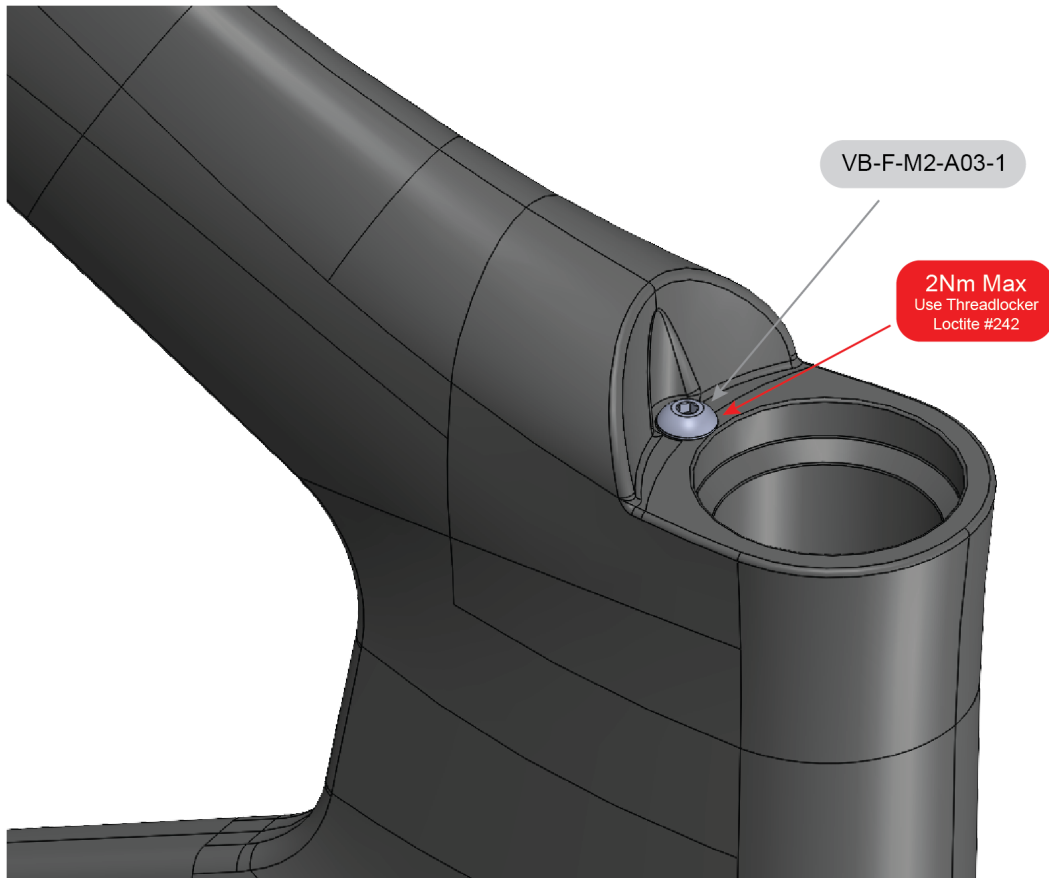

Part	SKU	Details
Fork Rotation Limit Screw	VB-F-M2-A03-1	M5x0.8 10mm Button Head Screw Stainless Steel 3mm Hex Key Right hand thread 2Nm Max

Headset Assembly

1. Clean both upper and lower bearing bores. Fit check with bearings and make sure there is no interference.
2. Apply grease in both upper and lower bearing bores and insert bearings.
3. Assemble fork into the frame head tube from the bottom. Take note of crown race configuration
4. Install Headset expansion plug. Torque up to 6Nm Max using 6mm Allen key
5. Install stem according to manufacturer's instructions
6. Preload fork headset with topcap

Note: If there is play in the fork assembly due to the fork and headset tolerance stack, the front fairing may need to be tuned in height to allow for the fork topper to sit flush for correct bearing preload during first assembly. Up to 1mm of material may need to be sanded off. Anything within 1mm is within correct manufacturing tolerance.

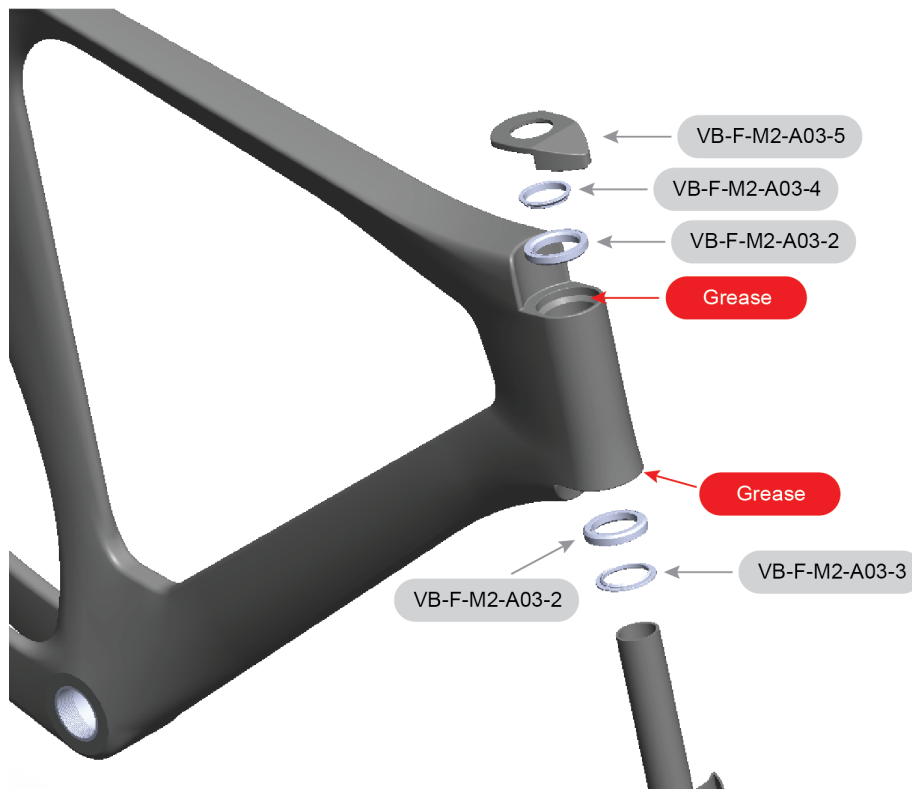

Part	SKU	Details
Headset Bearing	VB-F-M2-A03-2	P08 ($\varnothing 41.8 \times 6.5 \times 45^\circ$)
Headset Crown Race Base Plate	VB-F-M2-A03-3	
Headset Bearing Crown Race	VB-F-M2-A03-4	
Fork Topper	VB-F-M2-A03-5	
Expansion Plug	VB-F-M2-A03-6	6Nm Max

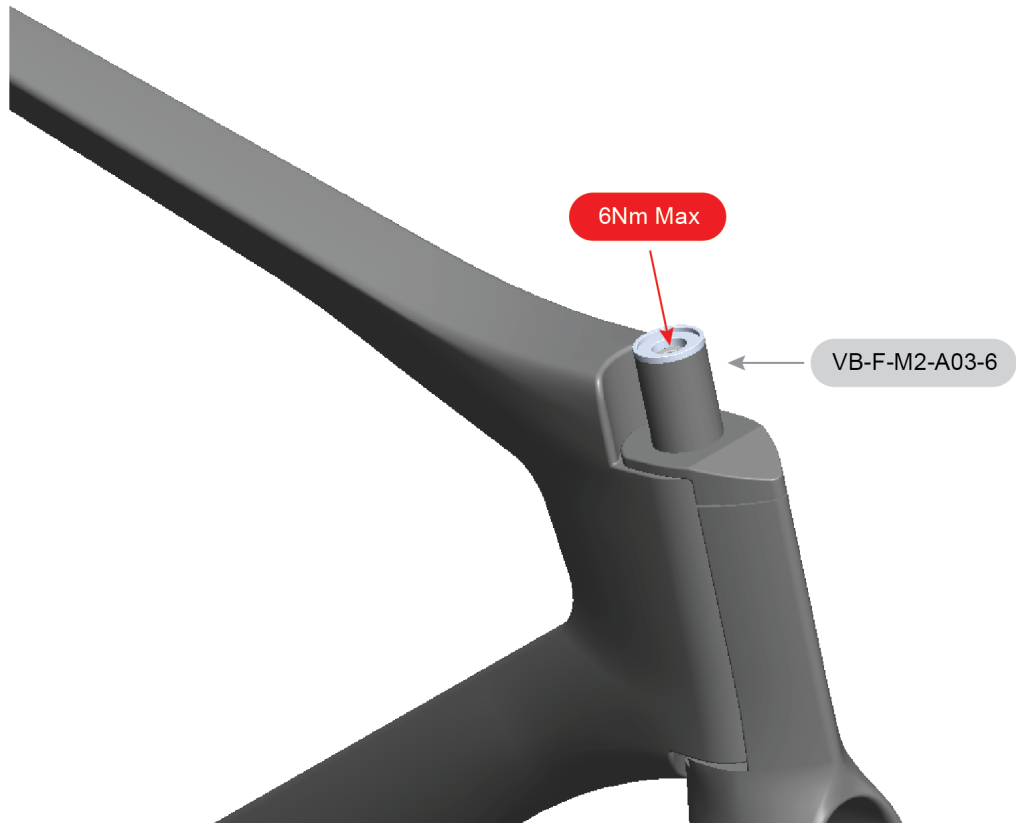
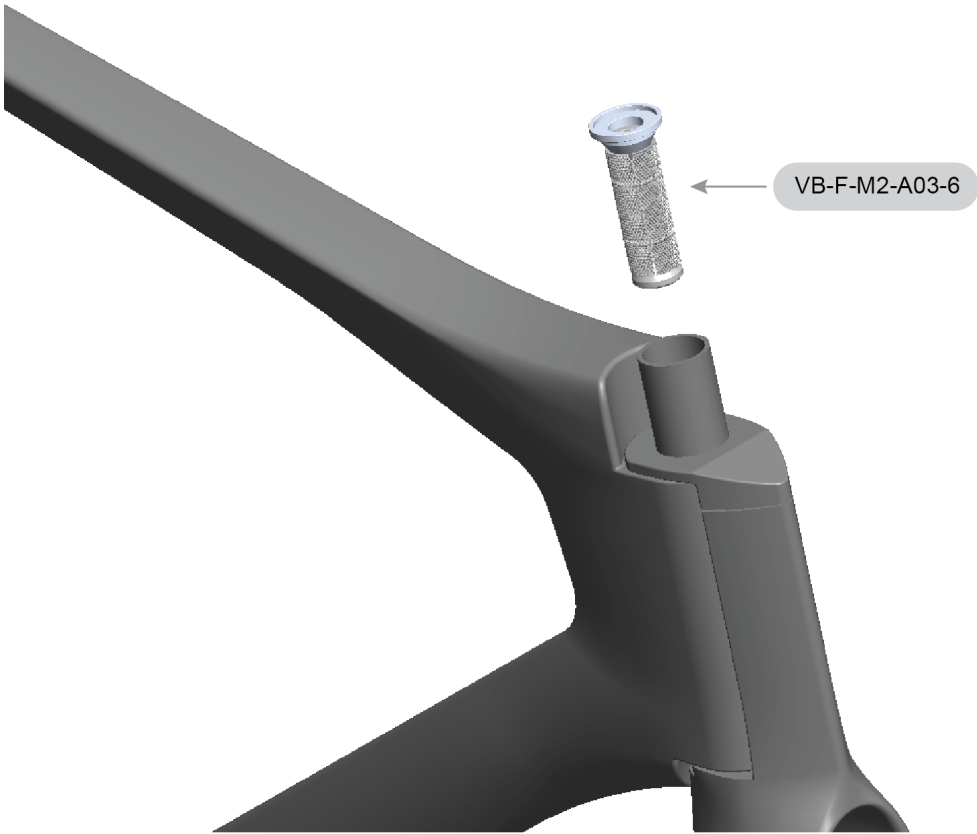

Steerer Tube Height

The Steerer tube comes with extra length so that it may be trimmed to a desired length based on stem height and riding position (use standard steerer cutting jig).

Ensure the steerer does not sit more than 3mm below the top of the stem.

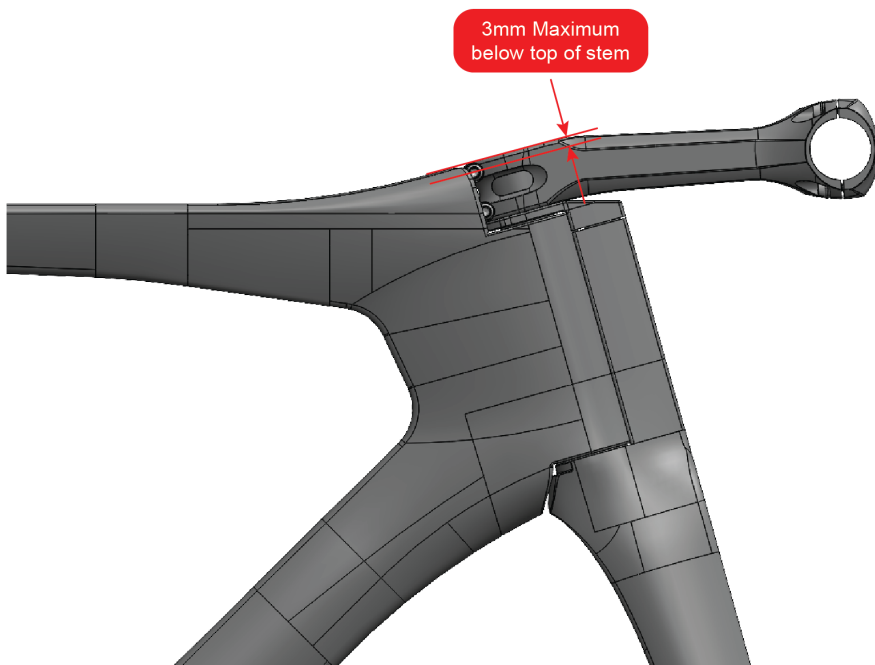
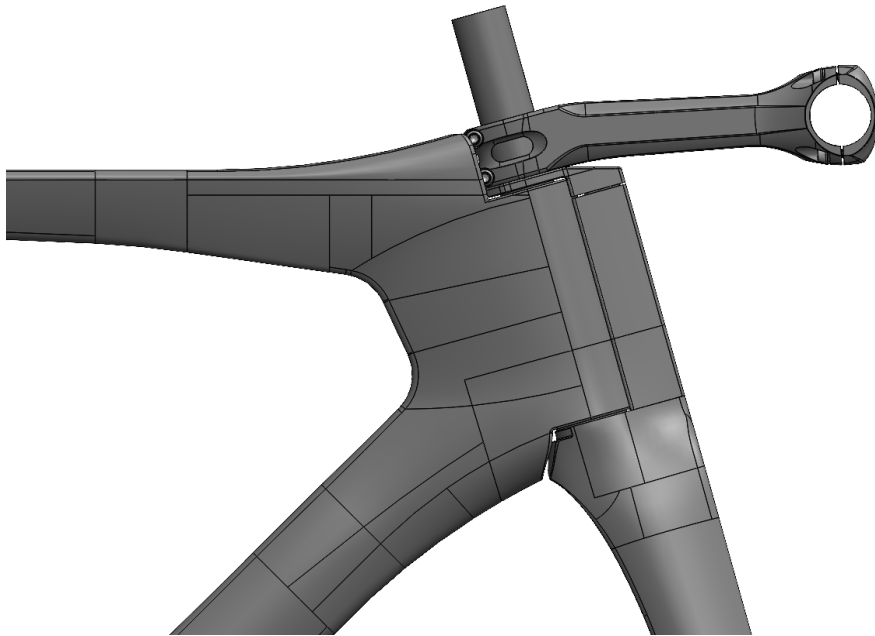

Stem / Headtube Clearance

The recessed headtube has clearance for stems with a maximum of 14.5mm of clamping stock behind the steerer tube.

