



Ustellar

LED RGB Flood Light User Guide



LED RGB Flood Light User Guide

THANK YOU for choosing Ustellar. To optimize user experience, please install and use the light according to the following instruction.

Warning

- (1) Please check if the light and the parts are intact before installation.
- (2) Make sure to cut off power before installation.
- (3) Please do not place this light in corrosive conditions.
- (4) If there is any damage to the cord, please cut off the power and stop using it immediately.
- (5) Please do not retrofit the light within the warranty period.
- (6) To ensure the light works properly, please use the voltage indicated on the packing.
- (7) To avoid any damage to the light, please do not use chemical solvent during routine maintenance.

1. Specification

Model No.	UT88863	UT88866	UT88867
Wattage	25W	80W	100W
Color	RGB		
Input Voltage	AC100-120V		
Protection Rating	IP66		
Controlled By	IR Remote Controller		
Battery for Controller	CR2032/CR2025		
Frequency	50/60Hz		
Mercury Content	No		
Lifespan	50000H		
Working Temperature	-20°C ~40°C		

2. Components

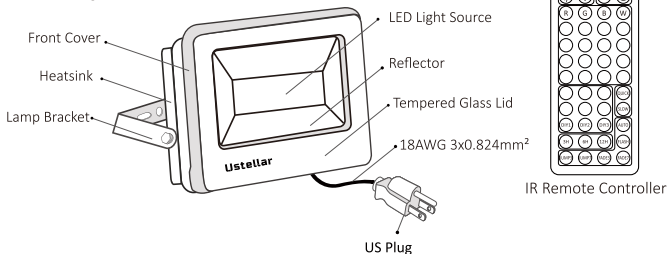

Note: 1. Different plugs for different countries. 2. Cord - type Z attachment.
For type Z attachment, if the external cord of this luminaire is damaged, it cannot be replaced without breaking or destroying the luminaire.

3. Dimension

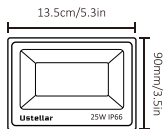

UT88863-RGB

Weight: 1.1lb/0.5kg Max Projected Area: 20 m²
Suggested Height for Installation: 5m

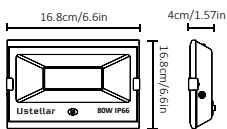
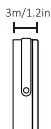

UT88866-RGB

Weight: 3.3lb/1.5kg Max Projected Area: 40 m²
Suggested Height for Installation: 6m

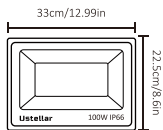

UT88867-RGB

Weight: 5.7lb/2.6kg Max Projected Area: 60 m²
Suggested Height for Installation: 6m

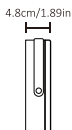

4. Installation

Step A: According to the spacing of two screw bits on the bracket, drill two holes on the mounting panel.

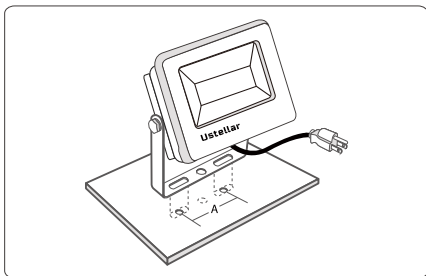

Step B: Aim the bracket at the holes and fix it with two bolts.

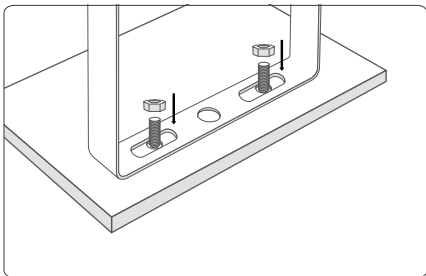

Step C: Adjust the lighting direction up or down as per your need and plug in to power the light on.

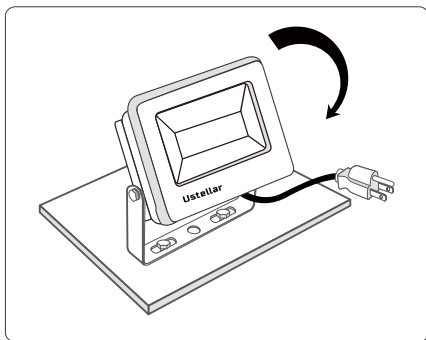

Step D: Remove the plastic sheet from the bottom of the remote controller so as to activate the controller.

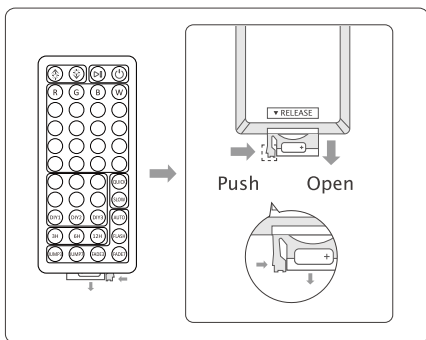

Note:

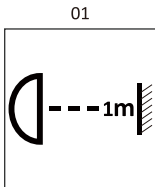

- 01 Make sure that the distance between the light and the object being lit is more than 1 meter, so as to avoid high temperature caused by short distance.

Non-replaceable Light Source.

Limitation of Indoor and Outdoor Use

- (1) This light is waterproof and dampproof. It is protected against the rain, but it cannot be immersed in water.
- (2) The mounting position of this light should be able to bear at least 10 times as heavy as the light.
- (3) This light should be used in condition that is good for heat dissipation. Its working temperature should be less than 40°C. Too high the working temperature will cause serious lumen depression and affect lifespan of the light.

5. Remote Controller

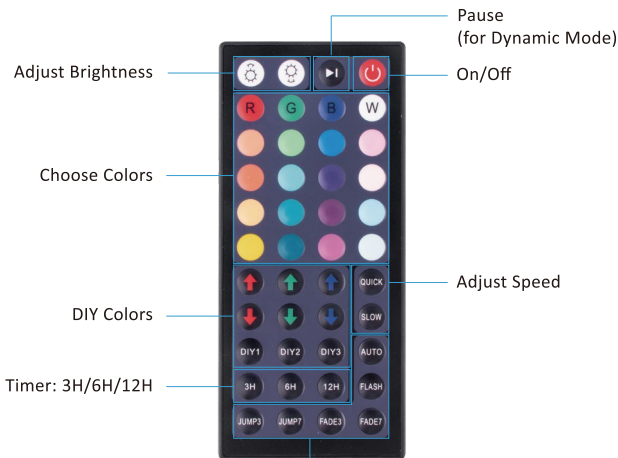

Dynamic Mode

AUTO: Loop the modes automatically.

FLASH: Flash and strobe when adjusting to the highest speed.

Jump3: flash change between 3 colors.

Jump7: flash change between 7 colors.

Fade3: smooth change between 3 colors.

Fade7: smooth change between 7 colors.

How to DIY colors?

This flood light is made of RGB LEDs, which means there are three colors (red/green/blue) on one LED. All lighting colors are made by changing the ratio of red, green and blue on the LED.

- e.g. Red + Green = Yellow Lighting
Red + Blue = Purple Lighting
Green + Blue = Cyan Blue Lighting

Firstly, choose and press one button from DIY1 to DIY3 on the IR controller, for instance, the DIY1 button. Secondly, press \uparrow or \downarrow button to increase (\uparrow) or decrease (\downarrow) the ratio of red, green and blue on the LED, so as to create different lighting colors. Then the specific DIY color lighting will be saved on the DIY1 button (the button you choose on the first step). Next time when you want to use this DIY color lighting, simply press DIY1 button for a quick access.

Note:

- (1) The remote controller has memory function, which means that it can start at your last choice on color and mode.
- (2) The flood light is controlled by the IR remote controller. To make it work perfectly, please point the remote controller to the light and make sure there is no obstacle between the light and the remote controller for better signal response.
- (3) After a period of usage, the remote controller might run out of battery and become insensitive or the available detection distance may be shortened. If the remote controller is not working, you might first try to replace its battery as per instructions shown below. If the remote controller still fails to work after replacing new battery, please contact the seller for help.

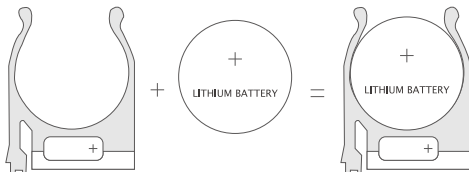

Contact Us

Have some issue? No worries! Please reach us via these channels.
Our customer services team is more than happy to help.



support@ustellar.com

Manufacturer: Shenzhen Ustellar Technology Ltd.

(shen zhen shi you shi tuo ke ji you xian gong si)

Address: 308A, 3/F, Building A, Youth Entrepreneur Hub, Jianshe East Road,
Qinghua Community, Longhua Street, Longhua District, Shenzhen,
CHINA 518000

Ustellar

E-manual



Step 1: Scan the QR code

Step 2: Click E-manual PDF file

Step 3: Read file online or download



Go paper-free, make life easier, and do something good for the environment.



FC IP66 (----1m)

Made in China