

MANTIS

Electric All-Terrain Bike



RAWTT
MANTIS

Quick Start

INSTRUCTIONS

To open box

You will need flat head screwdriver, hammer, a 2nd person to help.

1. Use a flat head screwdriver and hammer, tap at the metal tabs (see picture) until it bends open. Do this to every metal tab around the bottom of the box.



2. With a friend, wiggle the box cover until it loosens from the base, then lift upwards. Be careful not to catch or damage the contents within.



To Unbox Mantis

You will need scissors, a dirt bike stand or wide wooden blocks about 16” tall

1. Take out the wheel and front mudguard zip-tied to the back of the bike.



2. Take out the handlebar zip-tied to the front of the bike. Remove the headlight with an allen key.



3. Remove the pins and dowel from the front forks.

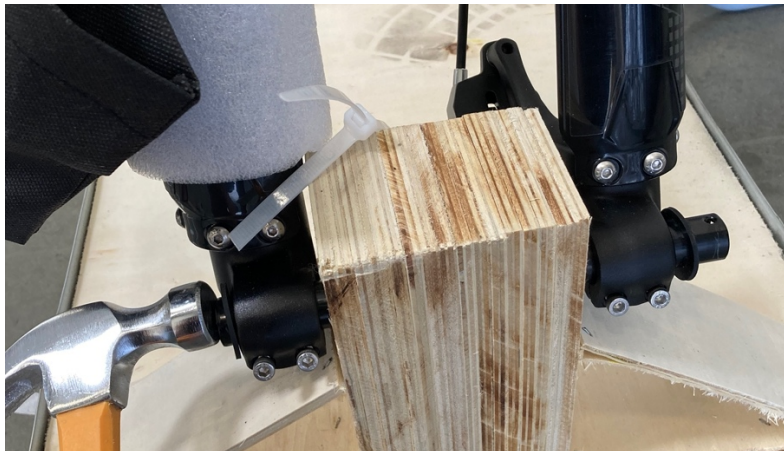
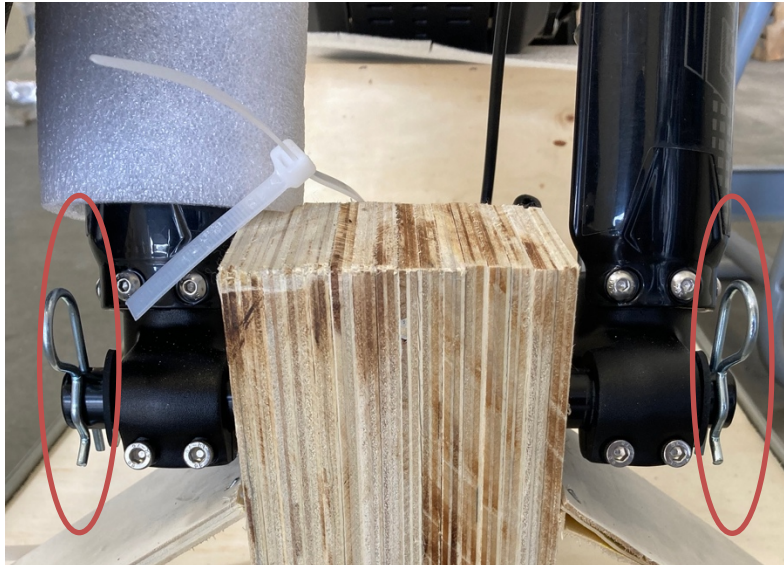

4. Remove the straps on each side of the bike.



5. With a friend, lift the bike out of the container and on to the stand.

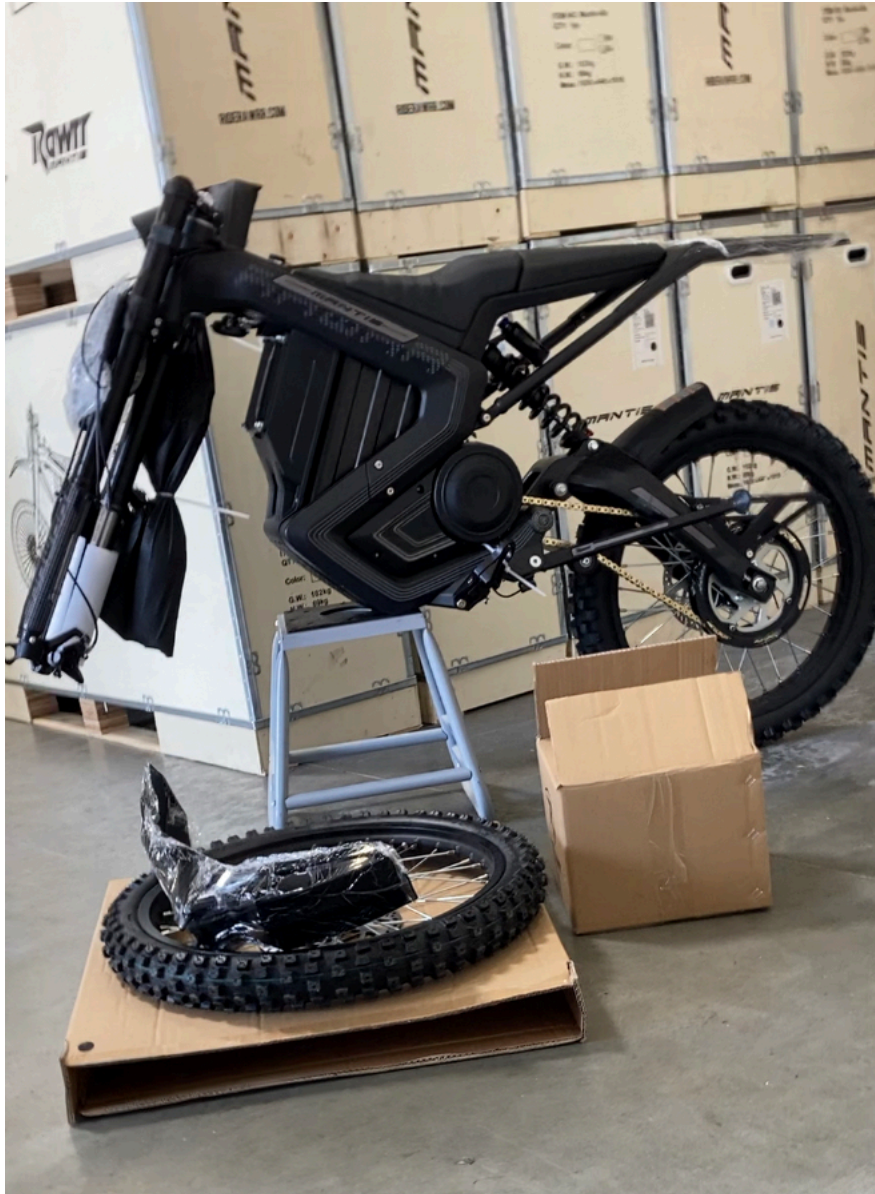

6. Open the included cardboard box and take out the provided tools.



Torque Specifications

1	Front wheel axle fastener	20 ft/lb (28 Nm)
2	Ignition lock cover fastener	3 ft/lb (4 Nm)
3	Rear wheel sprocket fastener	14 ft/lb (19 Nm)
4	Front and rear wheel disc fastener	5 ft/lb (6 Nm)
5	Front and rear brake caliper fastener	6 ft/lb (8 Nm)
6	Derailleur Fastener	14 ft/lb (19 Nm)
7	Foot peg fastener	16 ft/lb (22 Nm)
8	Side stand fastener	25 ft/lb (34 Nm)
9	Motor mount fastener	16 ft/lb (22 Nm)
10	Swingarm fastener	46 ft/lb (63 Nm)
11	Rear shock Fastening	33 ft/lb (45 Nm)
13	Rear wheel axle fastener	49 ft/lb (67 Nm)
14	Handlebar fastener	6 ft/lb (8 Nm)
15	Steering column slotted nut	3 ft/lb (4 Nm)
16	Steering column cap nut	33 ft/lb (45 Nm)

Assembly

We recommend having a friend help with the assembly of the bike.

Step 1. Mount Handlebars

1. Place the headlight bracket on the upper coupling plate, align all four (4) holes, and snap the clamp nut in the slot in front of the headlight bracket.

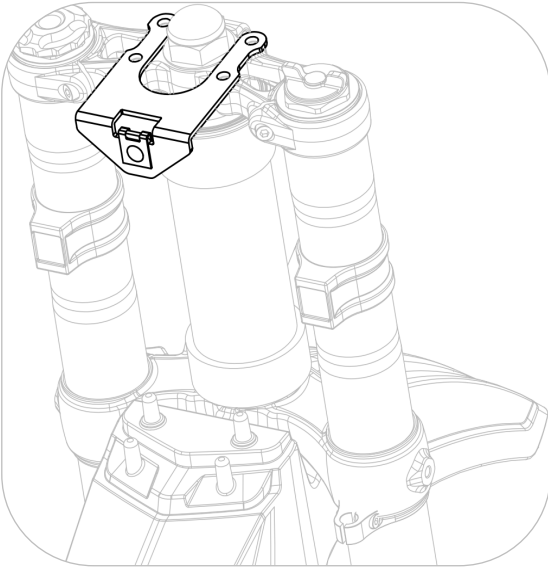

2. Put the handlebar on the headlight bracket, align the holes. If desired, place the included spacers to raise the handlebar. Tighten the four (4) screws with a #5 allen wrench.

Note: The 4 screws should be added with bullet spacers

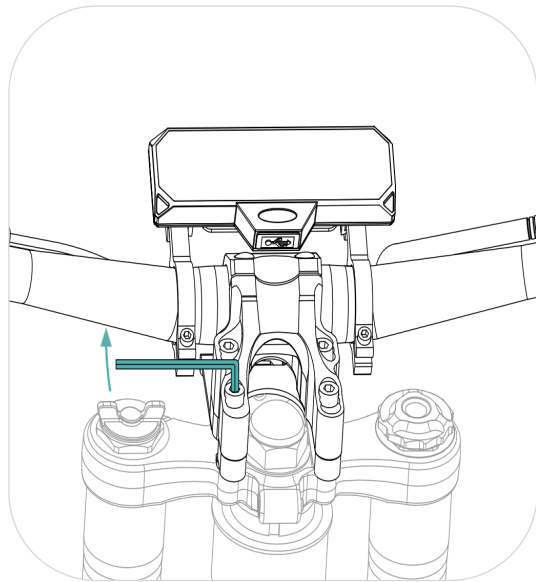

Step 2. Adjust Handlebar Height, Angle (optional)

1. Loosen the two (2) screws below the gauge with a #3 allen wrench and rotate the gauge at a suitable angle.

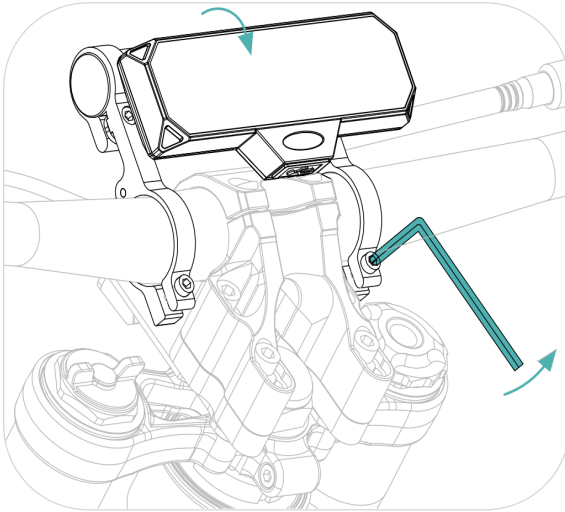

2. Loosen the four (4) screws on the back of gauge with a #5 allen wrench to adjust the handle angle.

Note: Do not lose the screw spring spacer.

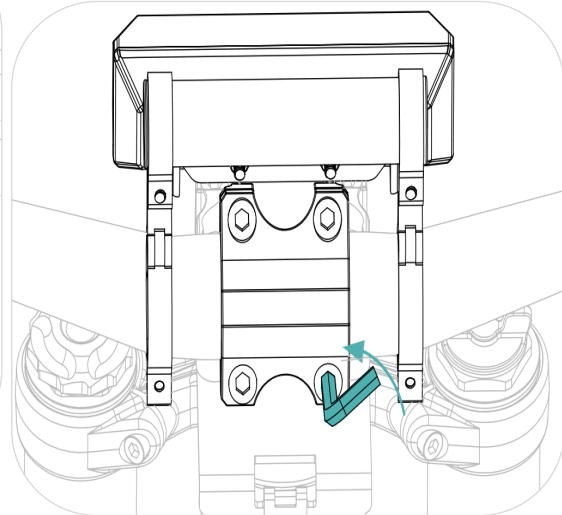

Step 3. Mount Front Wheel

1. Loosen the front wheel lock nut with two #19 wrenches and take out the shaft and nut.

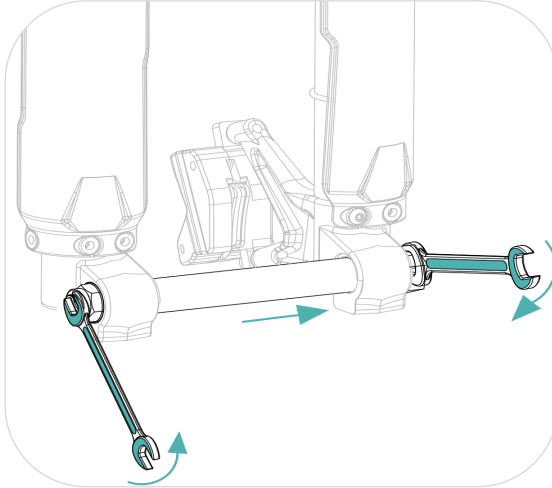

2. Install the front axle bushings on each side

Note: Do not crush the seal.

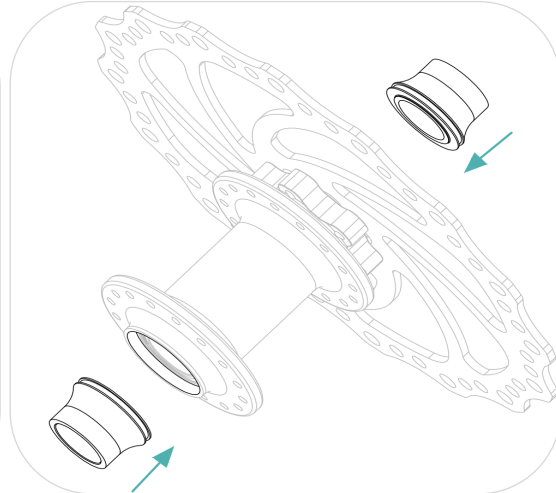

3. Remove the front brake caliper, place the front wheel inside the fork, install the front axle so that it passes through the fork and the front wheel in turn, and fasten the front axle with two #8 allen wrenches.

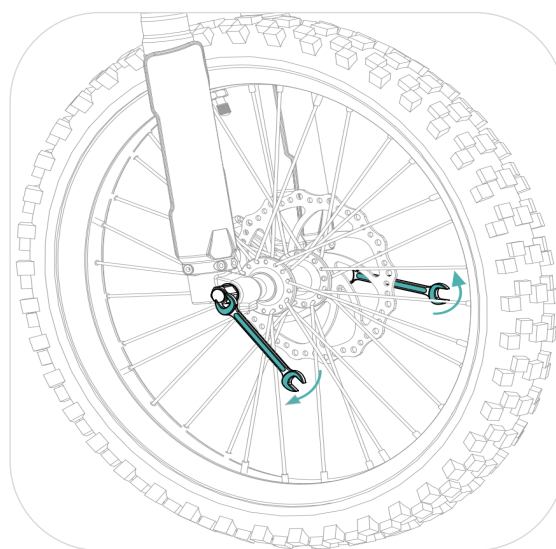
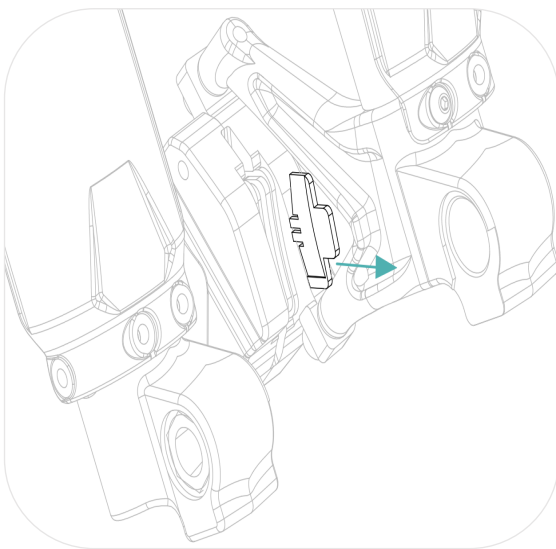

Note:

- 1. Do not use the front brake lever after removing the caliper as it can cause the brake pistons to clamp and make it difficult to put the disc brake disc in.**
- 2. When installing the front wheel, ensure proper fitment of the disc brake disc and caliper. After installation, check that the front wheel rotates smoothly and without any strange noise.**
- 3. When installing the disc brake disc, apply a thread locking compound (provided) to the threads.**

Step 4: Install Front Mudguard

1. Secure the front mudguard to the lower coupling plate with 3 screws including flat washer and spring locking washer using #4 allen wrench

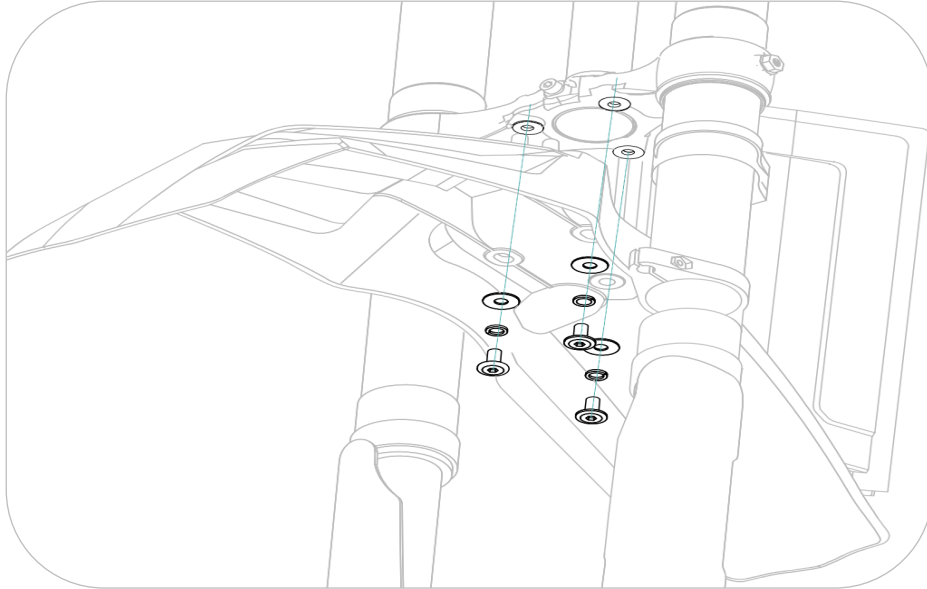

Step 5. Install Headlight / Number Plate

1. Place the headlight/Number Plate on the front mudguard positioning pins and add the adjustment spacer between the headlight and the bracket.

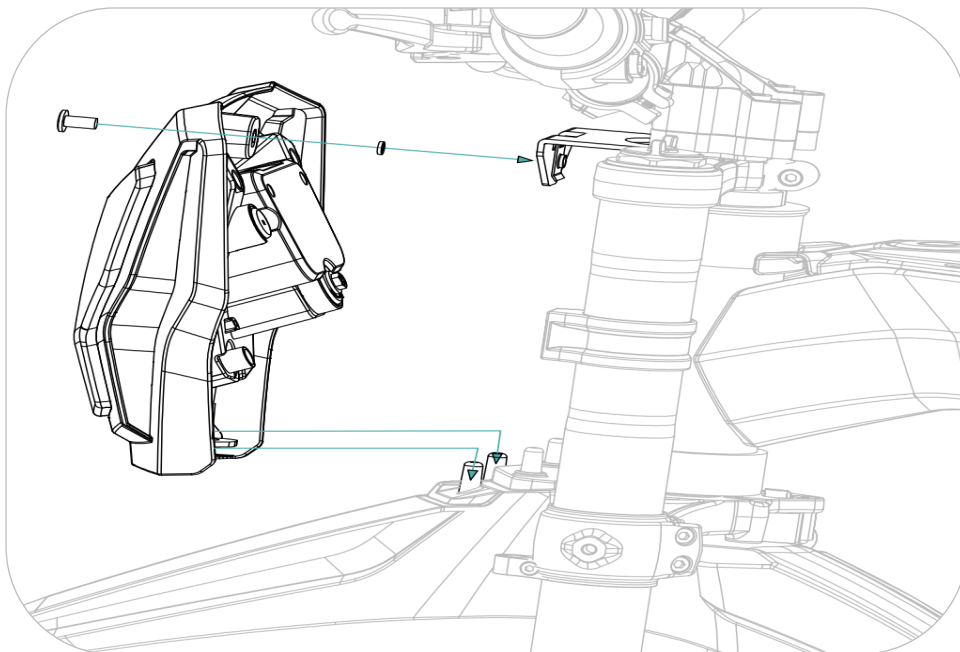

2. Adjust the position and tighten the middle screw with #5 allen wrench

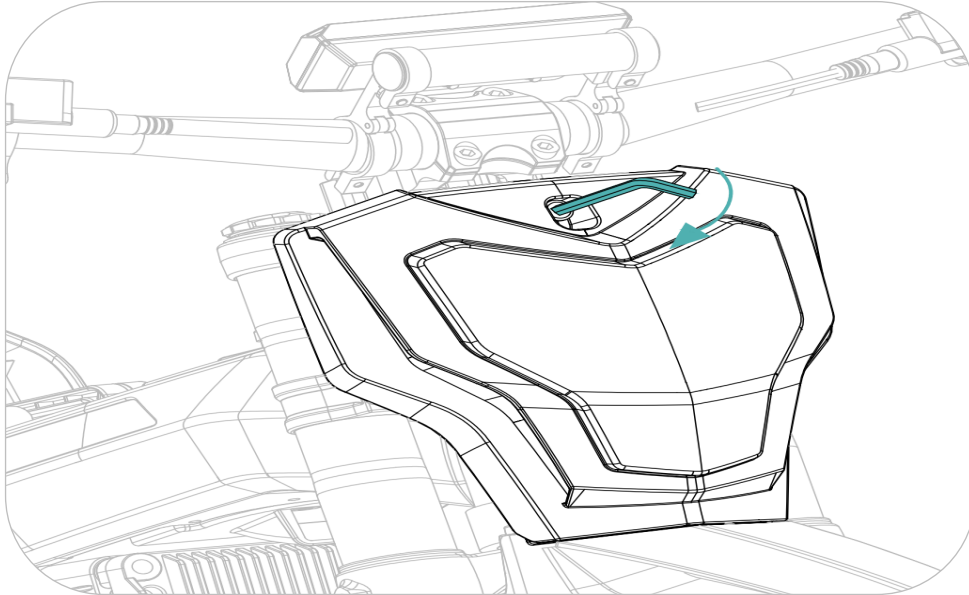

Step 6. Adjust Headlight Angle (optional)

Adjust the headlight height by rotating the adjusting screw with a Phillips screwdriver.

Note that turning the screw clockwise will lower the light, while turning it counterclockwise will raise it.

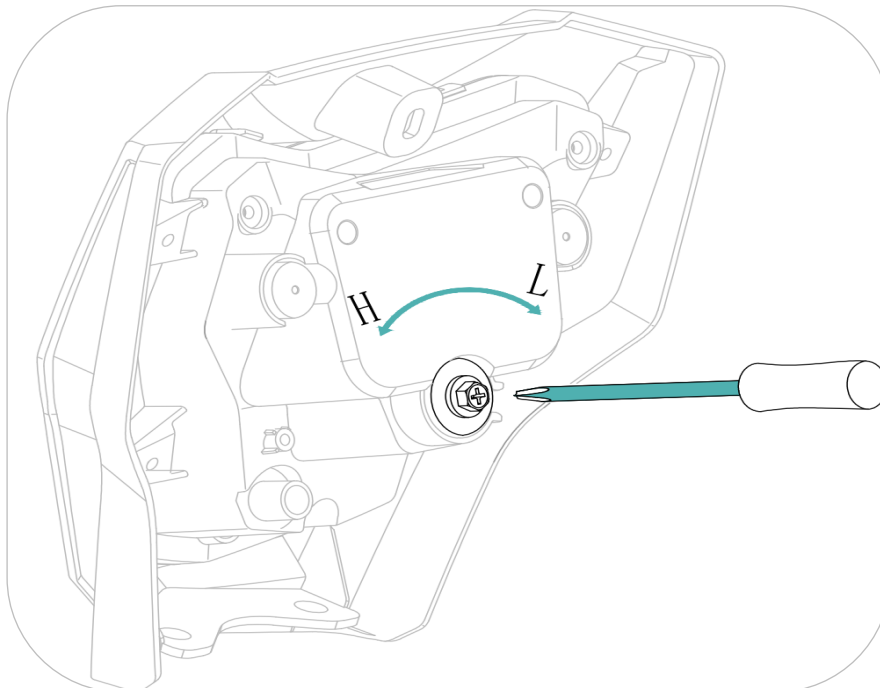

Step 8. Charge the battery

1. Under normal circumstances, turn the bike on then press the seat cushion switch on the handlebar. Once open, check the air switch to ensure it is in the off state.

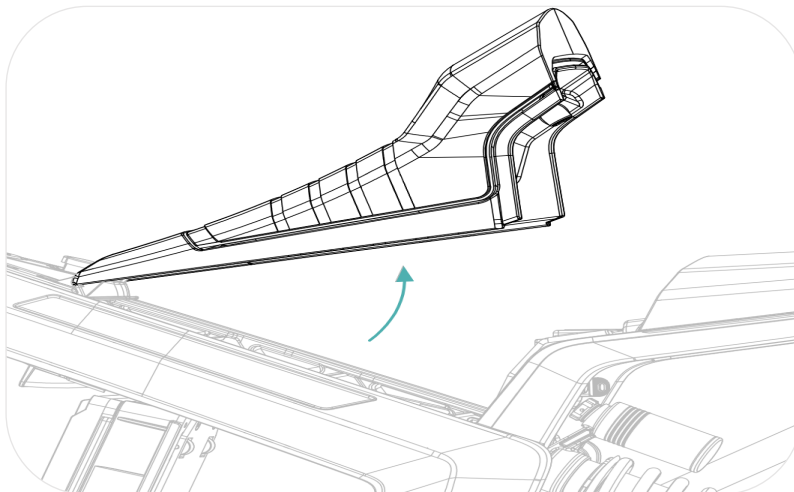
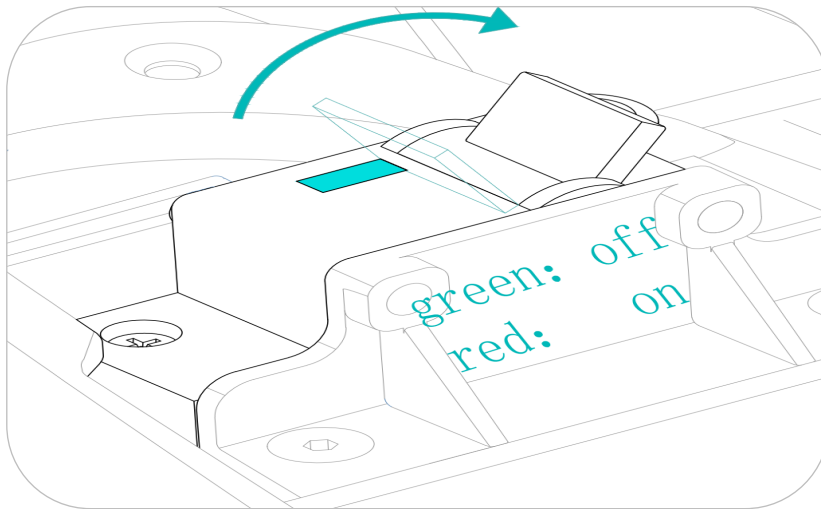

2. In cases where the battery is unavailable or damaged, and the whole bike cannot be powered on, insert the key into the round hole located underneath the rear cushion. The seat will release.

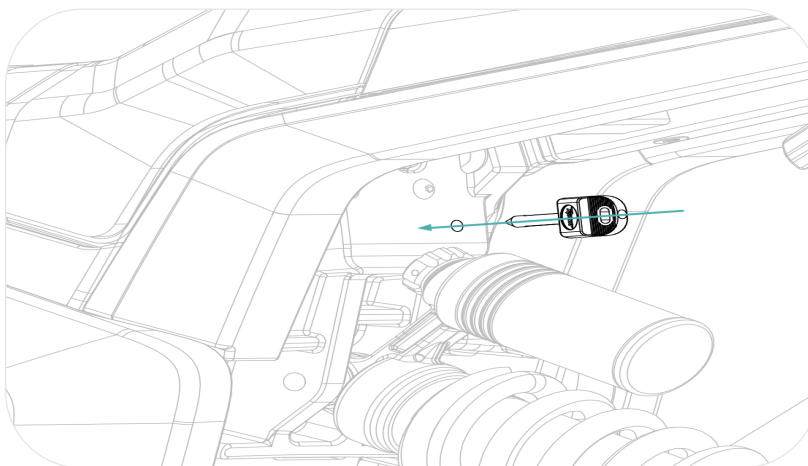

The battery charging port is on the right side of the frame. Slide the battery into the battery compartment; plug in the charger, turn the on/off switch to the left (ON), close the seat, turn off the ignition and remove the key.

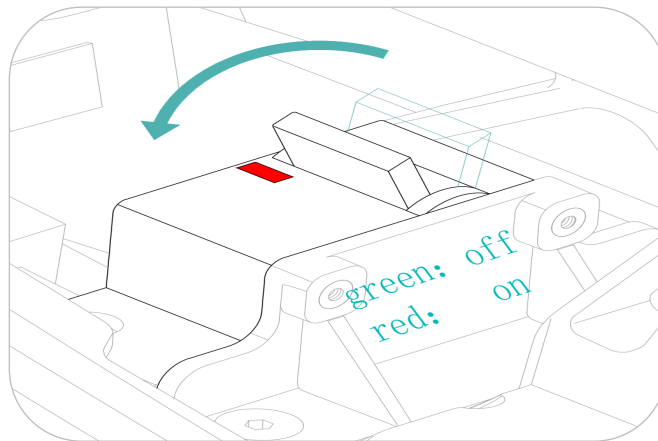
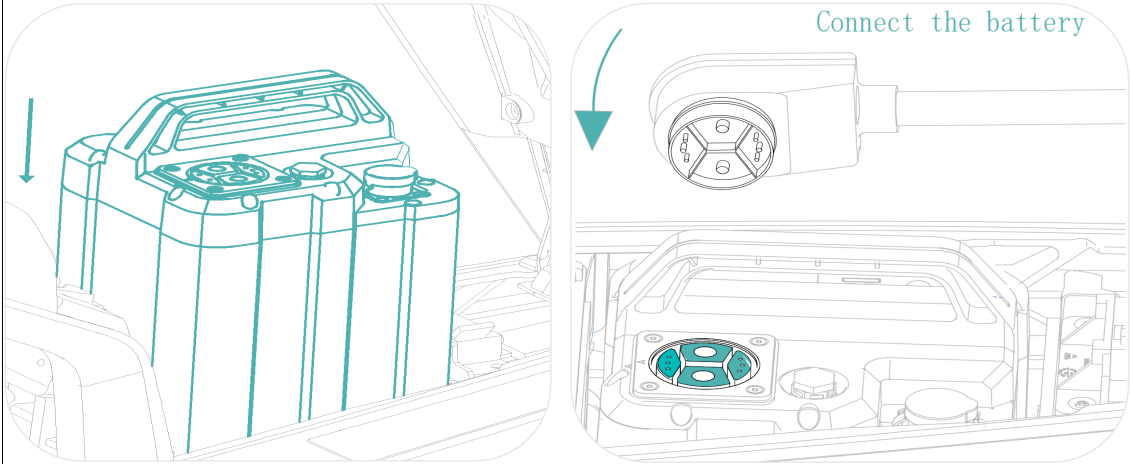

Open the seat when the whole bike power on

1. Insert the key into the switch lock and turn it clockwise.

2. Press the seat cushion button on the left combination switch

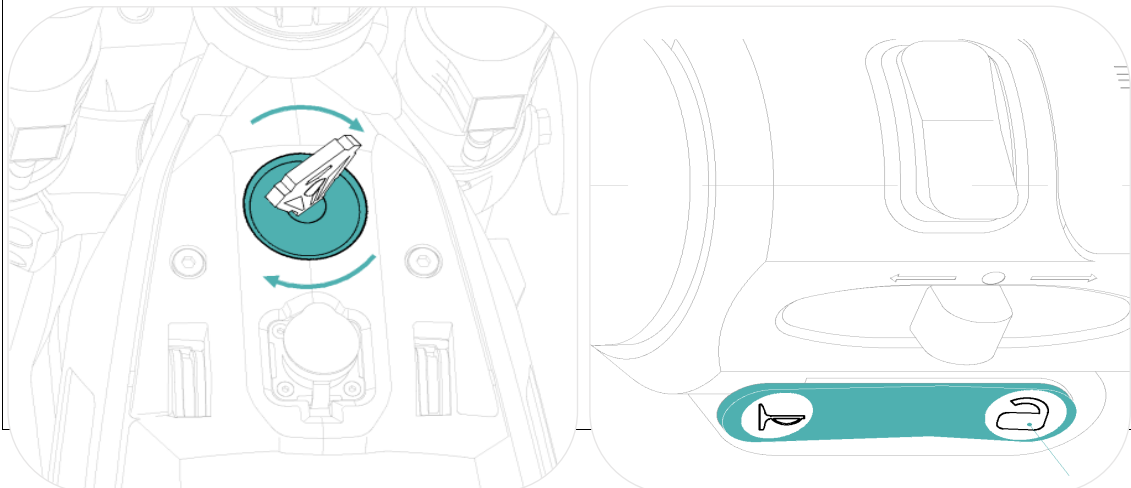

Other Notes

1. RAWRR is committed to continuously improving the performance of its products, and as such, product specifications and manual content may change without prior notice. If there are any discrepancies between the icons and pictures in this manual and the actual product, please refer to the actual product for accuracy.

RAWRR
MANTIS



@RIDERAWRR

Rawrr Inc

 5550 Stockdale Ct Jurupa Valley, CA 92509

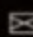
 Hello@riderawrr.com
