

KEEP FOR FUTURE REFERENCE



*P.O. Box 368 – 908 West Main
Laurel, MT USA 59044
phone 800-548-7341
phone 406-628-8231
fax 406-628-8354*

INSTRUCTIONS

International Version

STOCK NUMBER: 59906



**RADIO REMOTE CONTROL OPTION
RETROFIT KIT INSTALLATION
FOR INTELLI-GRIP®-ENABLED LIFTERS**



***READ ALL INSTRUCTIONS AND WARNINGS
BEFORE USING THIS PRODUCT***



DESIGNED FOR THE MATERIALS HANDLING PROFESSIONAL

INSTALLATION

Find your lifter from the sections below and follow the instructions listed there:

P1-DC3

- 1) Remove the power cable clip (circled).
- 2) Align the two holes on the radio receiver's mounting plate with the holes on the pad frame. Insert screws and tighten securely.
- 3) Route the radio receiver's cable through the lifter to avoid tangling or pinching while in use (see 4 & 7).
- 4) Route the radio receiver cable underneath the lift bar beside vacuum hoses.
- 5) Remove the vacuum pump cover and route the connection cable around edge (see 7).
- 6) Plug the radio receiver's cable into Intelli-Grip® control unit.
- 7) Ensure the cable is routed to avoid tangling or damage during lifter operation. Reinstall the vacuum pump cover (see 5).
- 8) Perform all inspections and tests, as directed in the INSPECTIONS AND TESTS section of the lifter's instructions. **Make sure that all components of the Remote Control System are functioning correctly.**

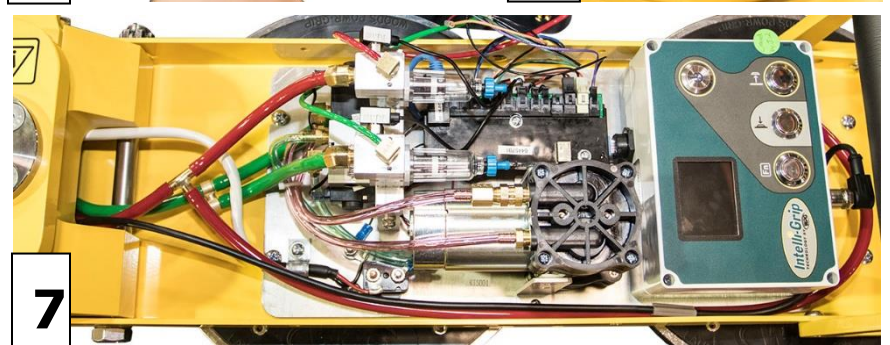
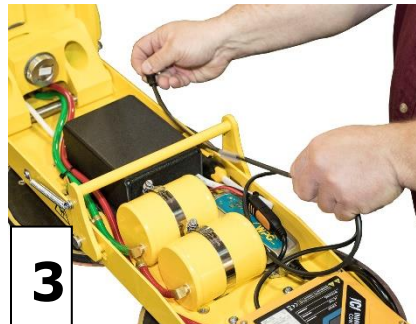

MRTALPCH6-DC3

Note: Kit ships with radio receiver attached to mounting plates necessary for installation on MRTALPCH6-DC3 (see cover page).

- 1) Disconnect the quick connects located near the control handle (see OPERATING FEATURES in the lifter's *INSTRUCTIONS*), to allow access for installation.
- 2) Align the two holes on the mounting plate with the holes on the pad channel. Then insert screws and tighten securely (circled).
- 3) Plug the end of the radio receiver cable into the Intelli-Grip® control unit. Then secure routing of the cable, to avoid tangling or pinching while the lifter is in use.
- 4) Reconnect quick connects, according to the desired configuration described in the lifter's *INSTRUCTIONS*.
- 5) Perform all inspections and tests, as directed in the INSPECTIONS AND TESTS section of the lifter's *INSTRUCTIONS*. ***Make sure that all components of the Remote Control System are functioning correctly.***

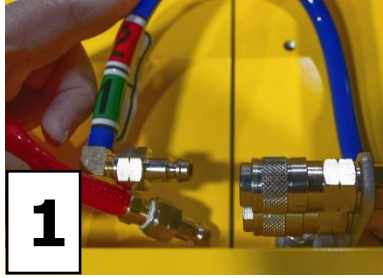

MRT4-DC3

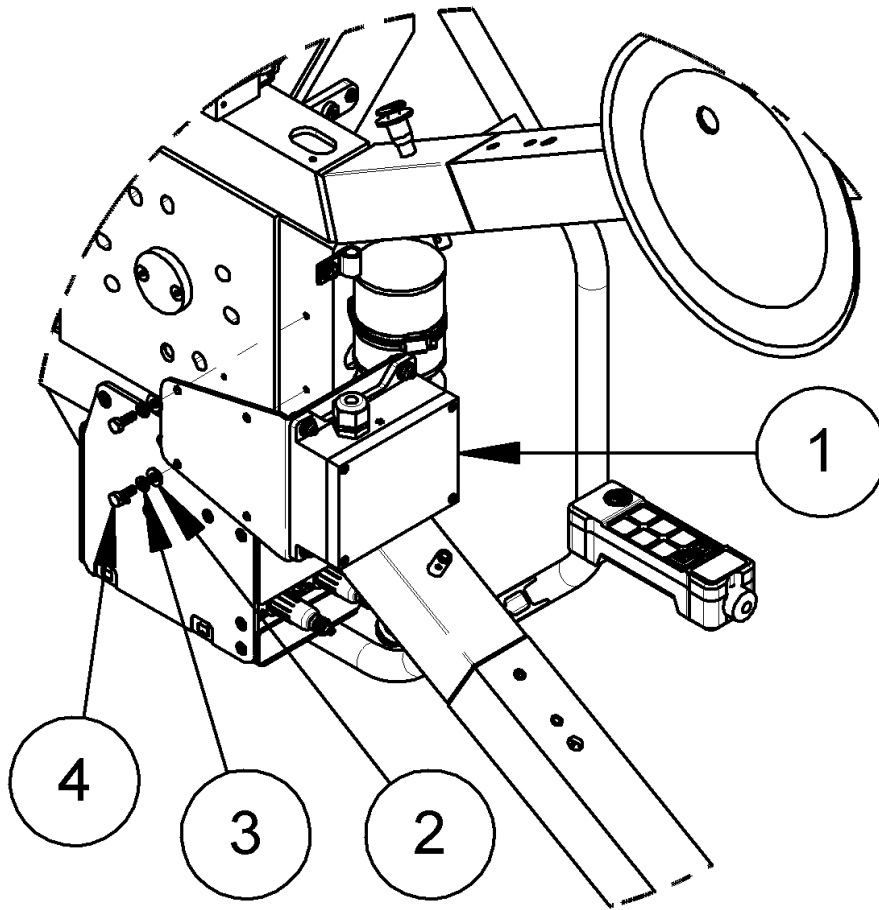

- 1 RADIO RECEIVER
- 2 FLAT WASHER
- 3 LOCK WASHER
- 4 1/4-20 BOLT

- 1) Push each of the bolts through a lock washer and then a flat washer. Align the two holes on the radio receiver's mounting plate with the corresponding holes on the pad frame. Insert the bolts and tighten securely.
- 2) Connect the end of the radio receiver's cable into the Intelli-Grip® control unit.
Note: Route cable to avoid tangling or pinching while the lifter is in use. Use a wire clip to secure the cable, if needed.
- 4) Perform all inspections and tests before using lifter, as directed in the INSPECTIONS AND TESTS section of the lifter's *INSTRUCTIONS*. ***Make sure that all components of the Remote Control System are functioning correctly.***

MRTA8-DC3

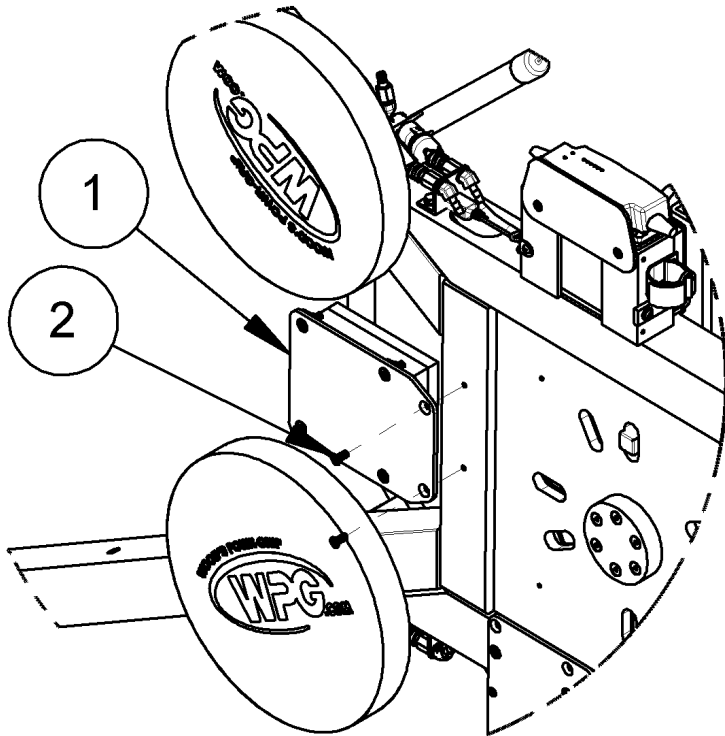

MRTALP-DC3

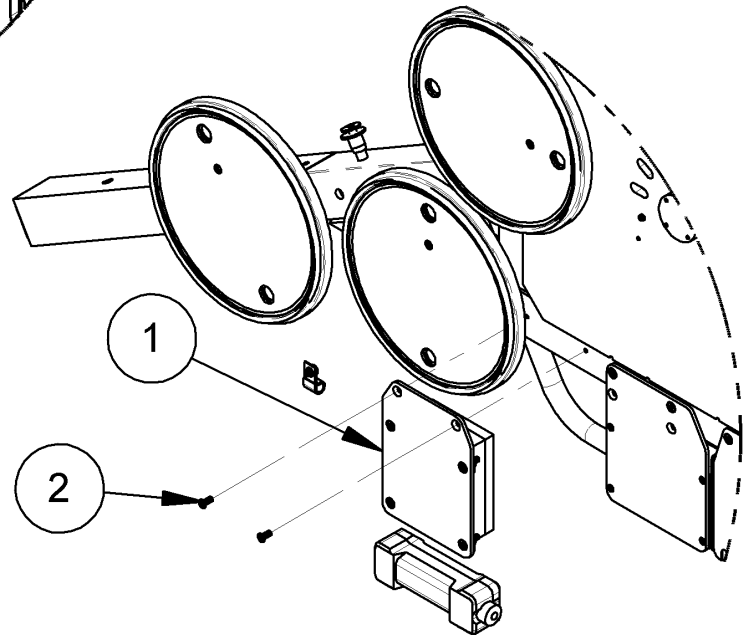

- 1 RADIO RECEIVER
- 2 ¼-20 FLAT-HEAD SCREW

- 1) Align the radio receiver's two holes with the holes on the pad frame. Insert the screws and tighten securely. Use a medium strength thread-locker to secure the screws if needed.
- 2) Connect the end of the radio receiver's cable to the Intelli-Grip control unit.
Note: Route cable to avoid tangling or pinching while the lifter in use. Use a wire clip to secure the cable, if necessary.
- 4) Perform all inspections and tests before using lifter, as directed in the INSPECTIONS AND TESTS section of the lifter's instructions. ***Make sure that all components of the Remote Control System are functioning correctly.***

LIMITED WARRANTY

Wood's Powr-Grip® (WPG) products are carefully constructed, thoroughly inspected at various stages of production, and individually tested. They are warranted to be free from defects in workmanship and materials for a period of one year from the date of purchase.

If a problem develops during the warranty period, follow the instructions hereafter to obtain warranty service. If inspection shows the problem is due to defective workmanship or materials, WPG will repair the product without charge.

WARRANTY DOES NOT APPLY WHEN:

- modifications have been made to the product after leaving the factory;
- rubber portions have been cut or scratched during use;
- repairs are required due to abnormal wear and tear; and/or
- the product has been damaged, misused, or neglected.

If a problem is not covered under warranty, WPG will notify the customer of costs prior to repair. If the customer agrees to pay all repair costs and to receive the repaired product on a C.O.D. basis, WPG then will proceed with repairs.

TO OBTAIN REPAIRS OR WARRANTY SERVICE

For purchases in *North America*:

Contact the Technical Service Department at Wood's Powr-Grip. When factory service is required, ship the complete product – prepaid – along with your name, address and phone number to the street address hereafter.

For purchases in *all other localities*:

Contact your dealer or the Technical Service Department at Wood's Powr-Grip for assistance.

Wood's Powr-Grip Co., Inc.
908 West Main St
Laurel, MT USA 59044

406-628-8231 (phone)
800-548-7341 (phone)
406-628-8354 (fax)

