

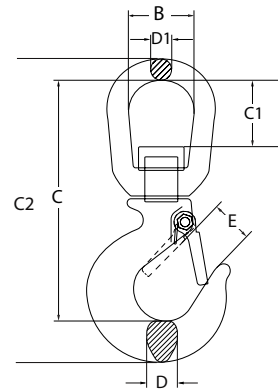

HOIST HOOK SWIVEL

International Swivel Eye Hoist Hooks with Safety Latch are commonly used for general lifting and can also be used in towing applications.

- Manufactured from forged alloy steel quenched and tempered.
- Capacities available from 1 ton to 11 ton.
- Marked with work load limit and alloy.
- Conforms to AS3777 with safety factor of 4:1
- Latch kits are available as spare part.



WLL (tonne)	WEIGHT (kg)	DIMENSIONS (mm)						
		B	C	C1	C2	D	D1	E
1	0.34	32	108	22.5	136	16	9	17
1.5	0.57	37.5	133.5	29.5	163.5	16	12	22.5
2	1.02	42.5	150.5	33	192	17.5	15.8	26
3	1.24	42.5	163	33	209	23	15.8	26
4.5	2.25	48	191	39	246	31	18	32.5
7	4.66	64	243.5	53	313	34	25	43
11	7.4	70	277	53	364	41.5	28.5	49.5

We're Australia's leading online supplier of lifting equipment and partner with some of the most trusted brands in the world to deliver quality products at competitive prices.