

Power Supply Tray Manual

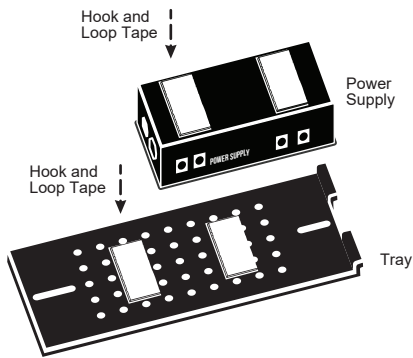

1. Apply hook and loop tape to the tray and your power supply. The tape is used to attach the two together.

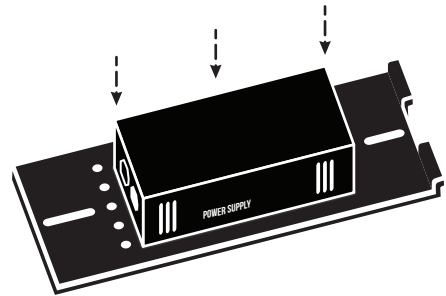

2. Place power supply onto tray using the hook and loop tape. (Cable ties can also be used to attach power supply)

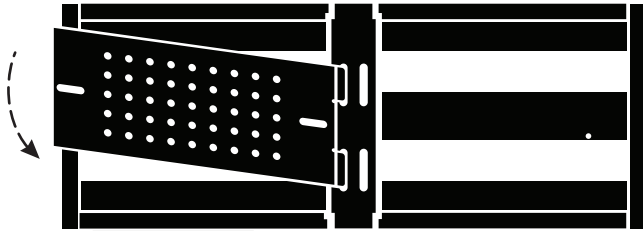

3. Place the tray in such a way that the mounting holes of it lineup with those of the pedalboard.

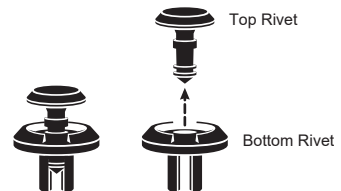

4. Take one of the included plastic rivets and separate the top and bottom.

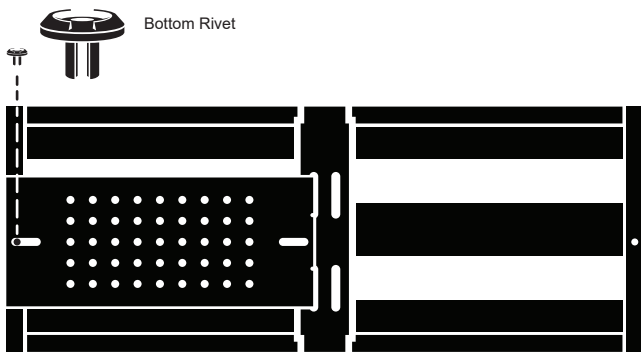

5. Push the bottom rivet into the lined up mounting holes. Make sure the bottom rivet is flat to the surface of the tray.

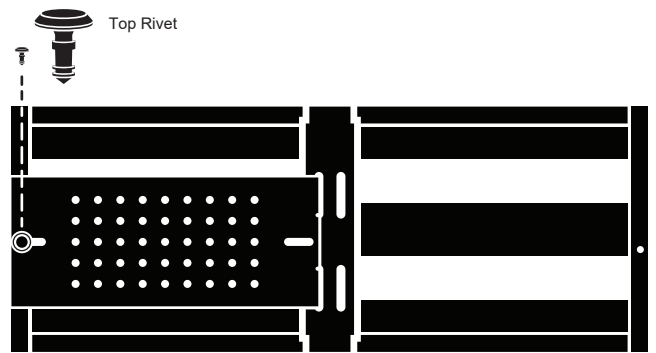

6. Push the top rivet into the bottom rivet until it latches. The top rivet should sit flush with the bottom rivet when fully installed

UPD-209-B

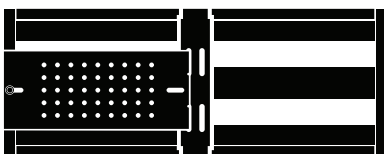

UPD-2412-B

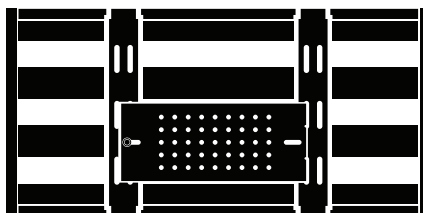

UPD-2416-B

