

20MM THREADS

The SP Series B speaker poles are equipped with a 20mm threaded connection. Simply turn the subwoofer adapter counter clockwise to remove and use the 20mm threaded connection.

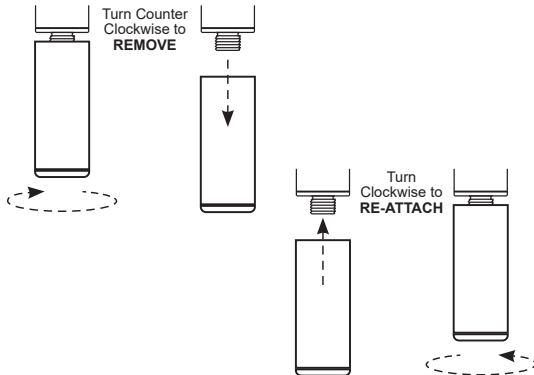

SPECIAL INSTRUCTIONS

- Occasionally clean the pole with a damp cloth or non-abrasive cleaner. Do not lubricate or use silicone spray on the center tube.
- Do not drag the speaker pole while it is loaded; this could cause breakage of the fittings and result in damage to the pole.
- When supporting equipment, check that the telescoping collar is securely tightened.
- Always release the collar with caution and stand clear of load.

Visit ultimatesupport.com to download a detailed product manual, read full warranty details and to register for warranty.

ULTIMATE
SUPPORT®

SATELLITE POLES

Manual

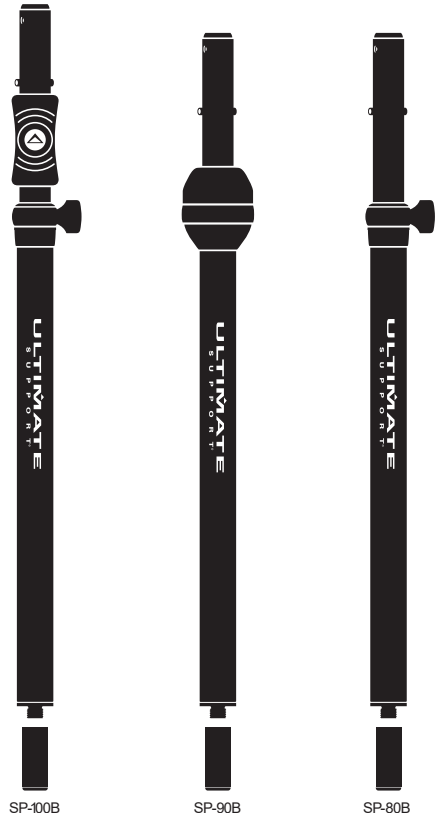

LIMITED LIFETIME WARRANTY
GO TO [ULTIMATESUPPORT.COM](https://ultimatesupport.com) FOR MORE DETAILS



SP-100B HEIGHT ADJUSTMENT

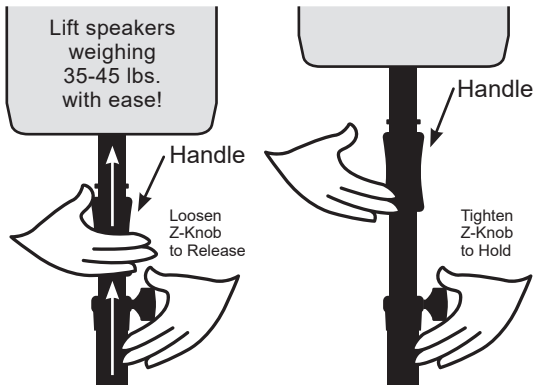

Using Air-Powered Lift Assist

Put speaker on stand. Firmly grip handle, loosen z-knob and guide telescoping tube to desired height. Tighten z-knob. CAUTION: For light speakers, grip handle tightly while loosening z-knob.

To lower speaker, firmly grip handle, loosen z-knob and guide telescoping tube down. Lighter speakers will take more effort to lower. Tighten z-knob.

SP-90B HEIGHT ADJUSTMENT

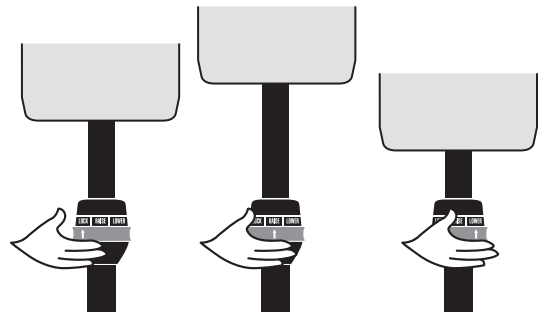

Using TeleLock®

Turn the gray dial to the lock, rise, or lower position to adjust stand height. The locked position holds speaker in place. The rise position allows the speaker to rise, but NOT lower.

To lower speaker, slowly turn gray dial to the lower position. The faster you turn it to the lower position the faster the speaker will fall. For added support, use hand to control speed of speaker lowering.

SPEAKER ADAPTER

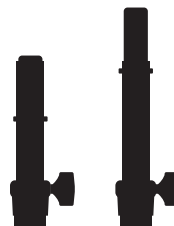

Built-in Adapter

The built-in adapter fits both 1-1/2" or 1-3/8" internal diameter speaker sockets. Use the lower position for 1-1/2". For 1-3/8" sockets, depress push buttons and raise adapter until it locks in raised position.



CAUTION!

This stand carries a gas powered shock that pushes up when z-knob is loosened. Keep clear of telescoping tubing and make sure z-knob is fully tightened. For best results when lowering stand, keep speaker on stand.

IMPORTANT INFORMATION

For maintaining any of Ultimate Support's speaker poles, please read the back of this manual under special instructions. These instructions will help you maintain your stand and keep your warranty.