

# SP-100 HEIGHT ADJUSTMENT

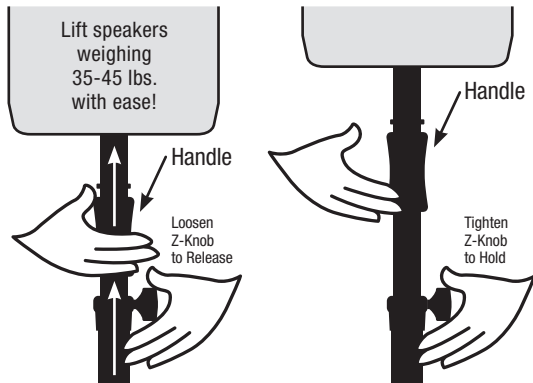

## Using Air-Powered Lift Assist

Put speaker on stand. Firmly grip handle, loosen z-knob and guide telescoping tube to desired height. Tighten z-knob. **CAUTION:** For light speakers, grip handle tightly while loosening z-knob.

To lower speaker, firmly grip handle, loosen z-knob and guide telescoping tube down. Lighter speakers will take more effort to lower. Tighten z-knob.

## Caution!

*This stand carries a gas powered shock that pushes up when z-knob is loosened. Keep clear of telescoping tubing and make sure z-knob is fully tightened. For best results when lowering stand, keep speaker on stand.*



Visit [ultimatesupport.com](http://ultimatesupport.com) to download a detailed product manual, read full warranty details and to register for warranty.

# ULTIMATE SUPPORT®

## SATELLITE POLES

### Manual



SP-100



SP-90



SP-80

LIMITED LIFETIME WARRANTY  
Go to [ultimatesupport.com](http://ultimatesupport.com) for More Details



## ATTACHING TO SUBWOOFER

### Seating Your Speaker Pole

Place pole into subwoofer and while pushing down firmly turn clock-wise until tightened (Do not over tighten). To remove pole, turn counter clock-wise until it stops turning, then lift pole out.

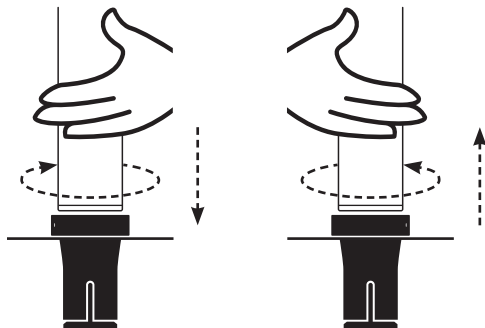

### Fully Seating Your Speaker Pole

Place speaker on pole, with the weight of the speaker pushing down, loosen slightly, then fully retighten speaker pole. Once the pole is fully seated, adjust speaker to desired height.

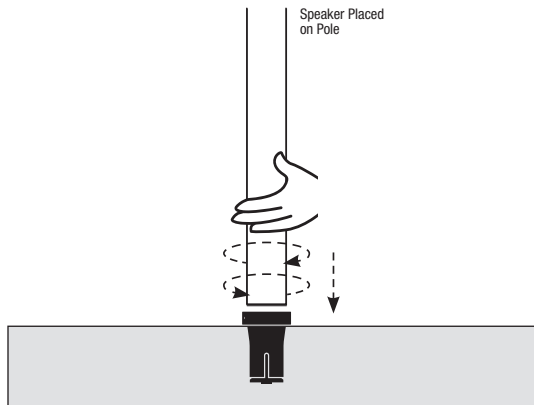

## SP-90 HEIGHT ADJUSTMENT

### Using TeleLock®

Turn the gray dial to the lock, rise, or lower position to adjust stand height. The locked position holds speaker in place. The rise position allows the speaker to rise, but NOT lower.

To lower speaker, slowly turn gray dial to the lower position. The faster you turn it to the lower position the faster the speaker will fall. For added support, use hand to control speed of speaker lowering.

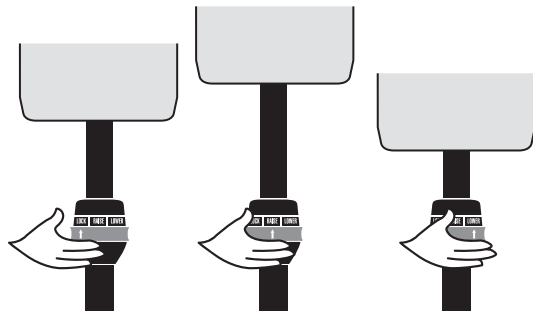

### Using the 20mm Threads

Remove the small screw on the side of the universal fit adapter, use a 2mm allen wrench. Pull off the bottom of the universal fit adapter. Remove the center screw, then unscrew top of universal fit adapter. Screw pole into desired subwoofer.

