

User Manual

Foldable Full-Size Wireless
Keyboard Mouse Combo

Product Features

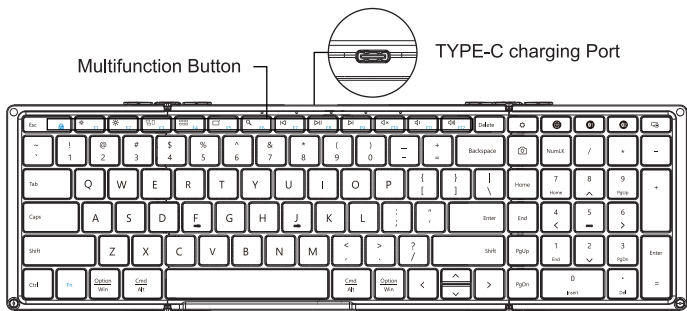

Charging Indicator/Low battery Indicator

Caps Lock Indicator

USB Indicator

BT1 Indicator

BT2 Indicator

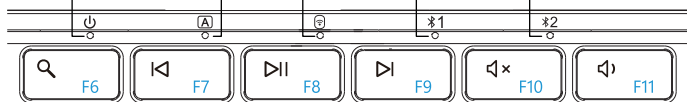

2.4G Connection

Bluetooth Connection 1

Bluetooth Connection 2

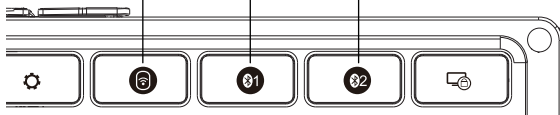

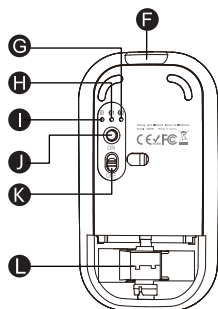
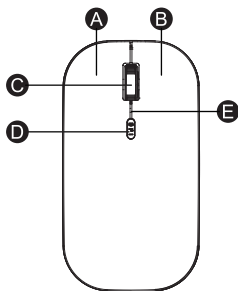

A Left Button

C Scroll Wheel Button

E Charging Indicator Light/
Low Battery Indicator Light

G Bluetooth 2 Indicator Light

I USB Indicator Light

K Power Switch

B Right Button

D DPI Switch Button

F Type-C Charging Port

H Bluetooth 1 Indicator Light

J Mode Switch Button

L USB Receiver

2.4G Connection

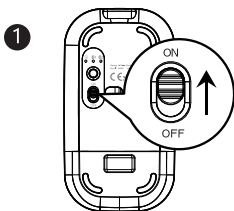

1. Switch the mouse Power Switch to ON.



1. Unfold the Keyboard.

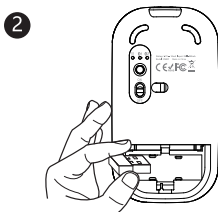

2. Take out the USB receiver.

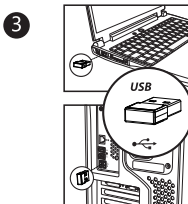

3. Plug into the computer USB port.

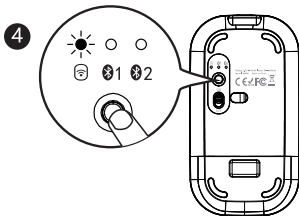

4. Press the Mode Switch Button on the bottom of the mouse until the  light is on, the mouse enters into 2.4G mode.

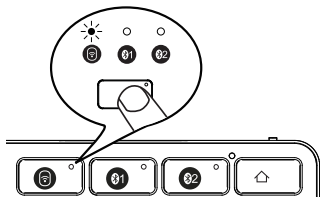

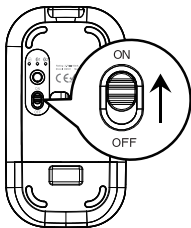

4. Single press  to switch to this channel, and the indicator light flashes slowly, enter into 2.4G mode.

Mouse Bluetooth Connection

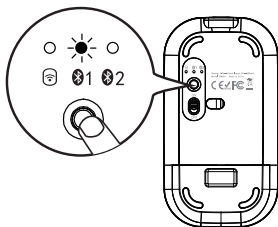

1. Switch the mouse Power Switch to ON.





2. Press the Mode Switch Button on the bottom of the mouse until the   light is on, the mouse enters into Bluetooth mode.

1

2

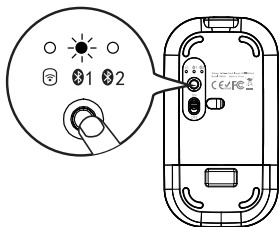
3



3. Long press the Mode Switch Button on the bottom of mouse for 3-5 seconds again, until the   light flashes quickly, at this time the mouse enters into the Bluetooth pairing mode.

Windows 10 System(Mouse)

- 4 Click "Bluetooth Devices" on your computer

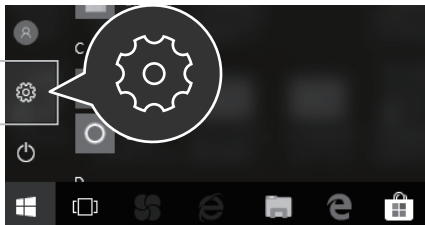

- 5 Click "Add or Delete Bluetooth Devices"

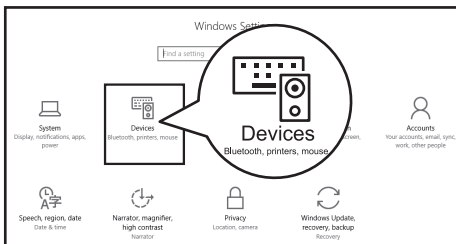

- 6 Bluetooth search for "ProtoArc XKM01", click "Pair"

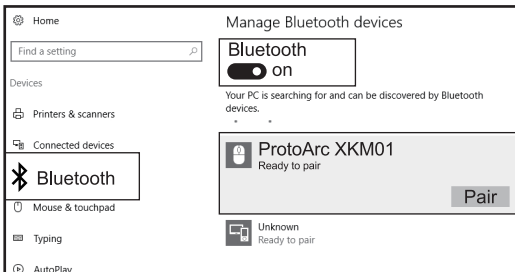

- 7 "ProtoArc XKM01" is "Connected", the mouse can be used normally.

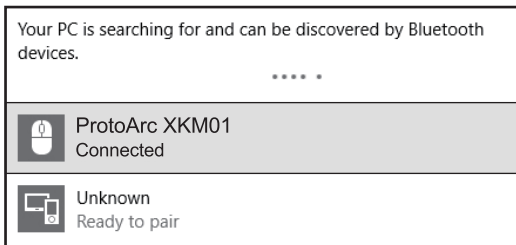

Mac OS System(Mouse)

Before pairing, please operate the Bluetooth mode installation procedures ①②③.

- 4 Click "System Preferences" on Mac



- 5 Click "Bluetooth" in "System Preferences".



- 6 Bluetooth search for "ProtoArc XKM01" and click "Pair" to complete the installation, the mouse can be used normally.



iOS System(Mouse)

* The mouse function is only supported by systems above iPad OS 13/ iOS 13.
Before pairing, please operate the Bluetooth mode installation procedures ①②③.

- 4 Click "Settings" on your device and click "Accessibility".

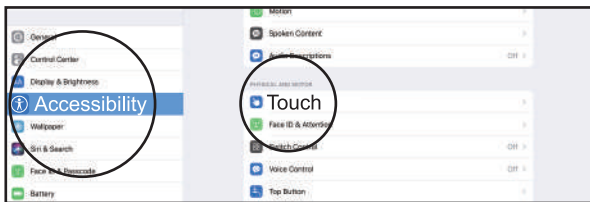

- 5 Click "Touch".

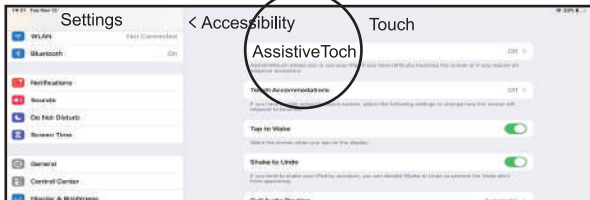

- 6 Turn on "AssistiveTouch".

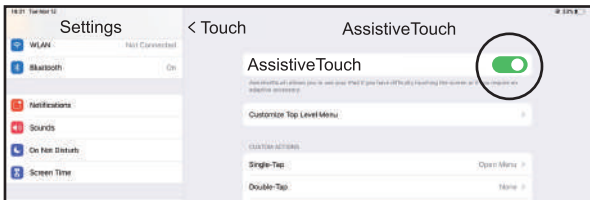

- 7 Click "Settings" on your device and turn on "Bluetooth".



- 8 Bluetooth search for "ProtoArc XKM01" and click "Pair" to complete the pairing process.

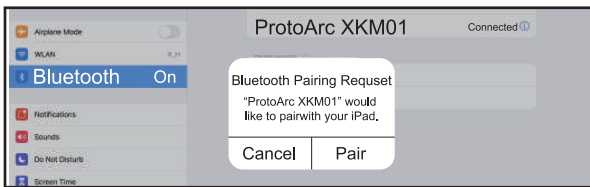

- 9 "ProtoArc XKM01" is "Connected", the mouse can be used normally.



Android System(Mouse)

Before pairing, please operate the Bluetooth mode installation procedures ①②③.

- 4 Click "Settings" on your device and turn on "Bluetooth".

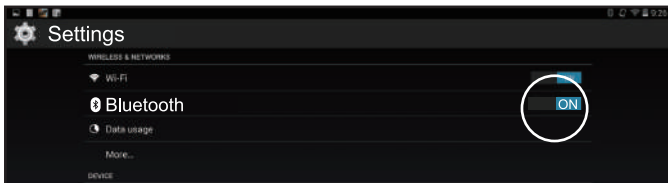

- 5 Bluetooth search for "ProtoArc XKM01" and click "Pair" to complete the pairing process.

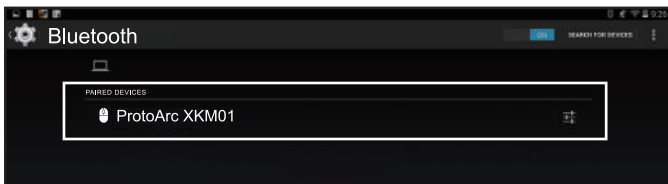

- 6 "ProtoArc XKM01" is "Connected", the mouse can be used normally.

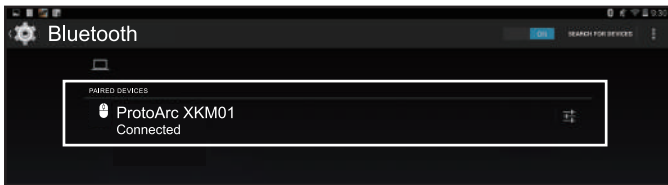

Keyboard Bluetooth Connection

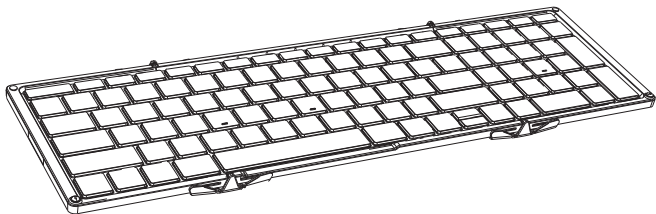

1

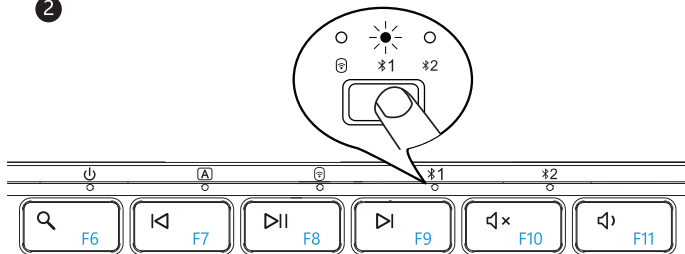

1. Unfold the Keyboard

2



2. Single press to choose any Bluetooth connection  / , the blue indicator light flashes once to enter Bluetooth mode. Then long press for 3-5s, when the blue indicator light flashing quickly, it enters Bluetooth pairing mode.

Windows 10 System(Keyboard)

- 4 Click "Bluetooth Devices" on your computer.

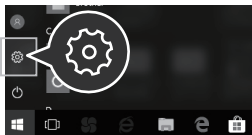

- 5 Click "Add or Delete Bluetooth Devices".

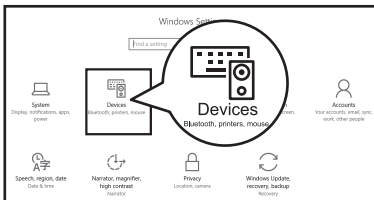

- 6 Bluetooth search for "ProtoArc XKM01", click "Pair".

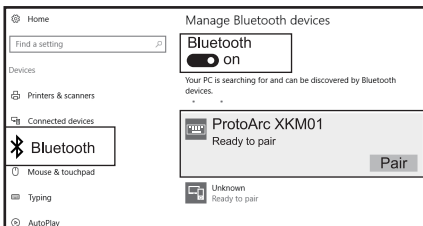

- 7 "ProtoArc XKM01" is "Connected", the keyboard can be used normally.

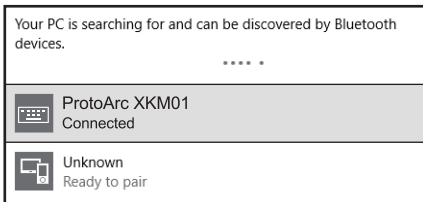

Mac OS System(Keyboard)

Before pairing, please operate the Bluetooth mode installation procedures ①②.

- 4 Click "System Preferences" on Mac.



- 5 Click "Bluetooth" in "System Preferences".



- 6 Bluetooth search for "ProtoArc XKM01" and click "Pair" to complete the installation, the keyboard can be used normally.



iOS System(Keyboard)

Before pairing, please operate the Bluetooth mode installation procedures ①②.

- ④ Click "Settings" on your device and turn on "Bluetooth".



- ⑤ Bluetooth search for "ProtoArc XKM01" and click "Pair" to complete the pairing process.

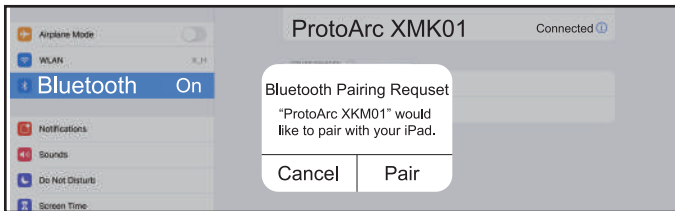

- ⑥ "ProtoArc XKM01" is "Connected", the keyboard can be used normally.

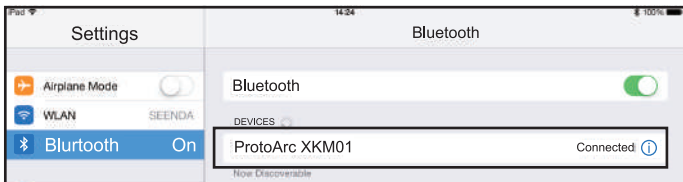

Android System(Keyboard)

Before pairing, please operate the Bluetooth mode installation procedures ①②.

- 4 Click "Settings" on your device and turn on "Bluetooth".

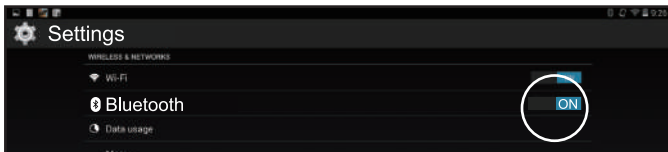

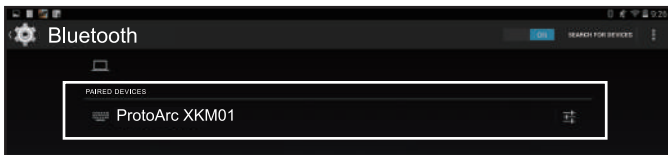

- 5 Bluetooth search for "ProtoArc XKM01" and click "Pair" to complete the pairing process.

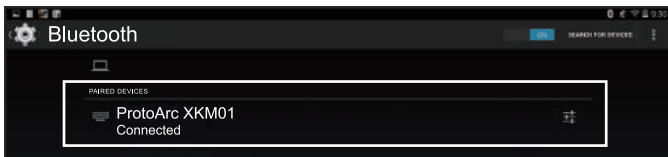

- 6 "ProtoArc XKM01" is "Connected", the keyboard can be used normally.



Mouse Mode Switch Method

 |  |  After are connected, short press Mode Switch Button on the bottom of the mouse, easily switch between multiple devices.

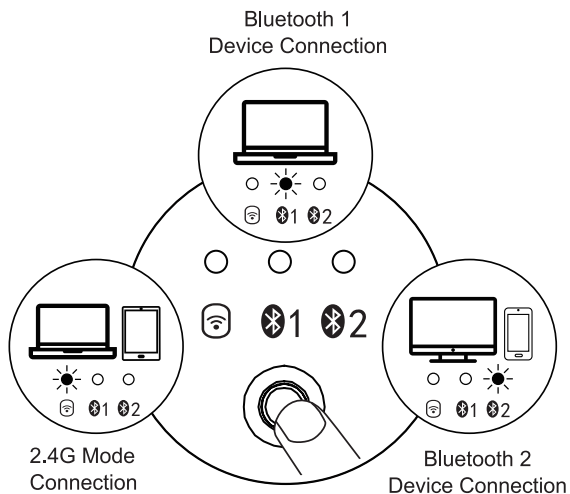

Mouse Charging



Charging Cable



Keyboard Mode Switch Method

① | ② | ③ After are connected, short press the channel key on the keyboard, easily switch between multiple devices.

Bluetooth 1 Device Connection

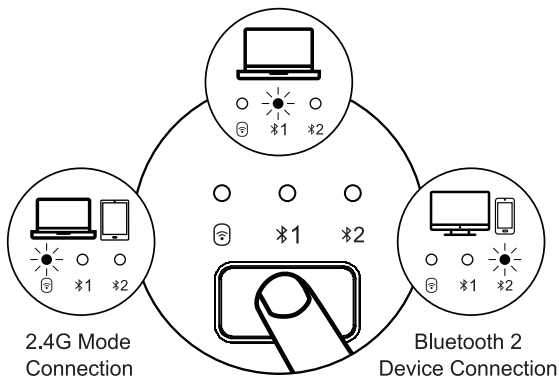

Keyboard Charging

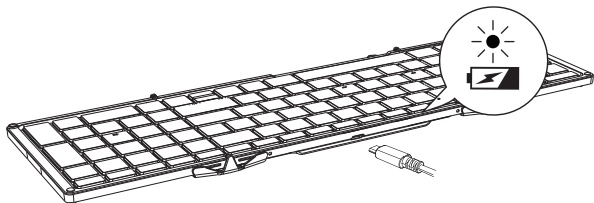









When the battery is too low, the low battery indicator will turn red and flash quickly. Please connect to the power supply to charge in time to ensure that the keyboard has sufficient power to meet normal work.

If the battery of the keyboard is too low, there will be delays and freezes and other problems in typing, which affect normal use.

Power indicator turns red while charging, then turn off after fully charged.

Multimedia Function Keys

Keys	Windows OS	Android OS	iOS	Mac OS
	Light -	Light -	Light -	Light -
	Light +	Light +	Light +	Light +
	Window Switch	Window Switch	Window Switch	Window Switch
	Application Switch	Application Switch	Open latest Window	Open latest Window
	Display Desktop	Go Home	Go Home	Go Home
	Search	Search	Search	/
	Previous Track	Previous Track	Previous Track	Previous Track
	Play & Pause	Play & Pause	Play & Pause	Play & Pause
	Next Track	Next Track	Next Track	Next Track
	Mute	Mute	Mute	Mute
	Volume -	Volume -	Volume -	Volume -
	Volume +	Volume +	Volume +	Volume +
	Setup	Setup	Setup	Setup
	Lock Screen	Lock Screen	Lock Screen	/
	Screenshot	Screenshot	Screenshot	Screenshot
	FN+ESC (FN lock) button to turn on or turn off the FN function			

Note: The FN function is a cyclic mode (F1-F12 and multimedia functions are cyclically used).

Product Parameters

Keyboard Parameters:

Battery Capacity	210 mAh
Working Current	≤ 3.5 mA
Sleep Current	31 uA
Charging Current	190 mA (±20mA)
Standby Current	≤ 0.3 mA
Standby Time	≥ 150 Days
Charging Time	< 2 Hours
Wake Up Way	Press any key
Weight	297 g
Keyboard Dimension	386.4x119.7x12.4mm(Unfolded) 215.5x119.7x20.9mm(Folded)

Mouse Parameters:

Engine	Optics
DPI	1000/1600/2400 DPI
Mouse Button Life	More than 3 million times
Battery Capacity	300mAh
Battery Life	1000 times charge and discharge cycles
Standby Time	200 Days
Continuous Working Time	50 hours
Mouse Dimensions	107.9*59.1*20.1mm

2.4G Transmission Parameters:

Transmission Distance	10m
Working Voltage	3.7V
Working Current	<5mA
Polling Rate	250Hz
System Requirements	An available USB port Windows XP, Windows 7, Windows 8, Windows 10 or higher version Mac OS X 10.10 or higher version

Bluetooth Transmission Parameters:

Transmission Distance	10m
Working Voltage	3.7V
Working Current	<5mA
Polling Rate	125Hz
System Requirements	Bluetooth receiving device Windows 8, Windows 10 or higher version Mac OS X 10.10 or higher version Android 4.3 or higher version

Tips

1. If it fails to connect normally, it is recommended to turn off the keyboard power, restart the Bluetooth of the device and connect again. Or delete the extra Bluetooth option name in the Bluetooth connection list of the device and reconnect.
2. To switch to a channel that has been successfully connected, first press the channel button firstly, and then wait 3 seconds to keep working.
3. The keyboard mouse has memory function, when the keyboard mouse is connected properly at one channel, turn off the keyboard mouse and turn on again, the keyboard mouse will be in the default channel, and the indicator of this channel is on.

Sleep Mode

1. When the keyboard is not used for more than 30 minutes, it will automatically enter the sleep mode and the indicator light will be off.
2. When you use the keyboard again, you only need to press any key, and the keyboard will wake up within 3 seconds. The indicator will light up again and starts to work.

Packing List

- ▶ 1* Wireless Bluetooth Keyboard
- ▶ 1* Wireless Bluetooth Mouse
- ▶ 1* Type-C Charging Cable
- ▶ 1* Hard Carrying Case
- ▶ 1* Phone Holder
- ▶ 1* User Manual