

正面

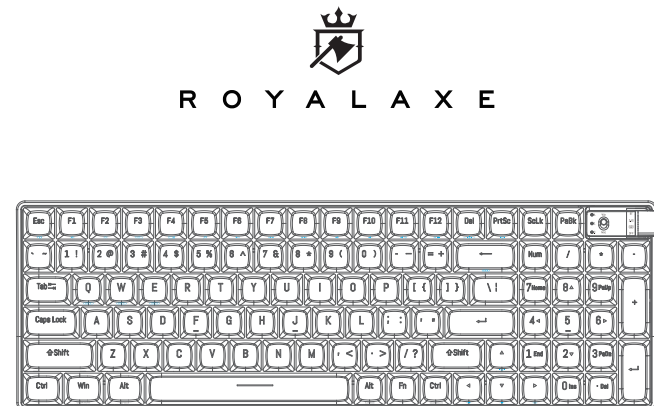

R100

BT 3.0/BT 5.0/2.4G/Wired Three Mode Mechanical Gaming Keyboard Co-created by ProtoArc x RoyalAxe

USER MANUAL

English:

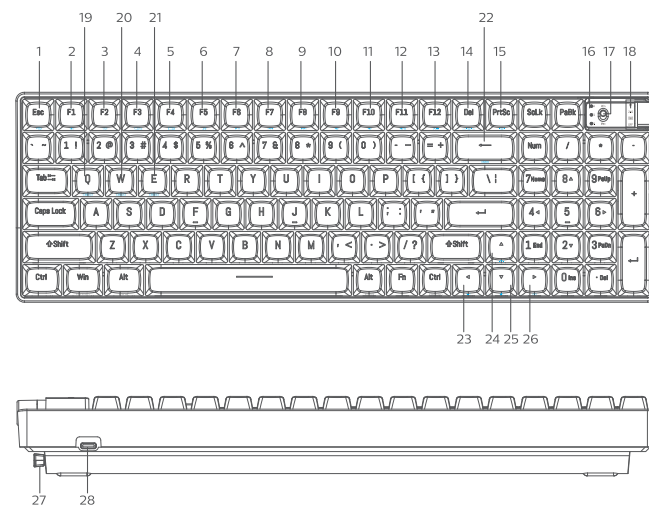

1

Function overview of the keyboard

- 1. Fn+ : Reset
2. Fn+ : Screen brightness -
3. Fn+ : Screen brightness +
...
28. Type-C charging/wired interface

2

Wired connection

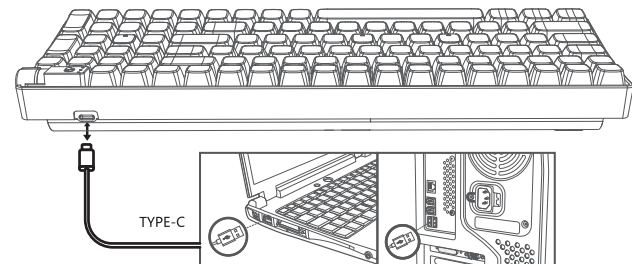

1.Insert the TYPE-C interface of the charging cable into the keyboard, and connect the USB interface to your computer.

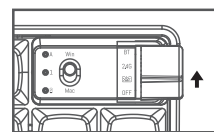

2.Keep the mode rotary knob in OFF or in Wired mode, 1 indicator will flash once and then go out, the connection is successfully completed.

Note: In TYPE-C wired mode, the "OFF" switch has no function.

3

2.4G connection

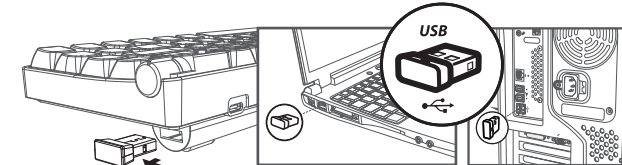

1.Take out the receiver and insert the receiver into the USB port of the computer.

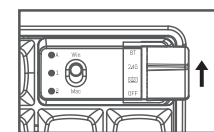

2.Turn the mode rotary knob to 2.4G mode, the 1 indicator flashes twice and then goes off, the connection is successfully completed.

4

Bluetooth connection

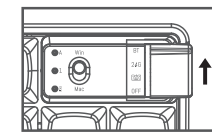

1.Turn the mode rotary knob to BT mode, the 1 indicator flashes three times and then goes out.

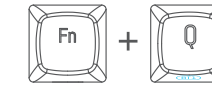

Take the connection to BT1 as an example as follows:

1.Long press the Fn + Q key for about 3-5 seconds, the corresponding indicator light will flash quickly, and then enter the Bluetooth pairing mode.

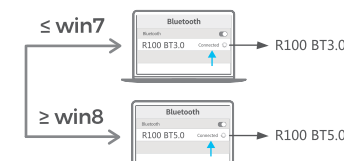

2. Turn on the Bluetooth of your computer or other device, search and select "R100 BT3.0" or "R100 BT5.0" and start Bluetooth pairing until the connection is completed.

Notice: 1. Windows 7 and below system versions do not support Bluetooth 5.0; 2. The device number corresponding to Bluetooths 3.0 is R100 BT3.0, and the device number corresponding to Bluetooth 5.0 is R100 BT5.0

5

Mode switching method of the keyboard

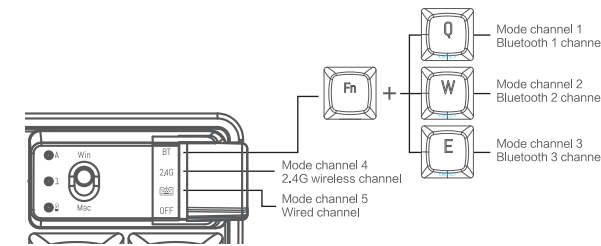

- 1. Mode channel: The keyboard has 5 channels, BT1, BT2, BT3, 2.4G, wired, and 5 devices can be connected at the same time.
2. Mode rotary knob: Turn the mode rotary knob between OFF/Wired/2.4G/BT. Press Fn+ Q, W or E to switch between different Bluetooth channels of BT1, BT2 and BT3.

iOS/Mac/Win layout switching

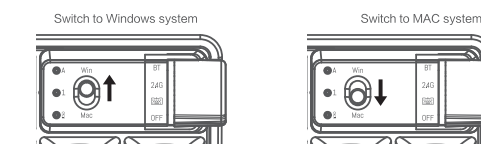

Note: the default setting is Windows layout.

6

Charging guide:

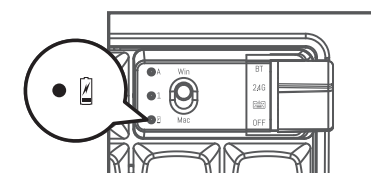

1. Low voltage reminder: indicator flashes red to remind low voltage.

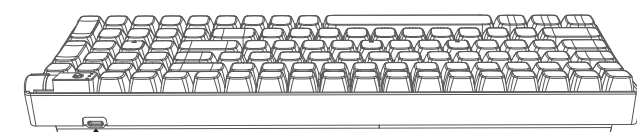

2.Plug the charging cable' TYPE-C interface into the keyboard, USB interface into your computer to start charging. red light is always on during charging process.

3. indicator turns in green after the charging is completed, During the plug-in charging process, every mode is not controlled by the "OFF" switch, and the power supply is directly supplied by the charging cable.

7

Custom drive

For custom mode, please scan the code to download the official driver: https://www.protoarc.com Find "Support" from Header Menu > "Download" Reminder: The driver only supports customization in wired and 2.4G mode.

Technical specifications

- Connection method: wired / 2.4G/Hz / Bluetooth 3.0 / Bluetooth 5.0
-Wireless effective distance: 2.4G/Hz about 15 meters / Bluetooth about 10 meters
-Working current and voltage: 5V = 500mA(max)
-Keyboard keys: 98
-Keycap material: PBT
-Mechanical switch lifespan: 100 million times
-Lithium battery: 3000mAh
-Keyboard product size: 368.9x121.5x44.5mm
-Weight: 995g ± 20g

System requirement

- 1. 1 x USB port
2. Bluetooth 3.0/Bluetooth 5.0
3. Windows® 7/Windows® 8/Windows® 10 or later, Android 3.2 and above; Mac OS 10.5 or later
Note: Multimedia functions are partially invalid in different OS versions.

Trouble shooting

- 1. Make sure that the USB wireless receiver of the product is correctly plugged into the USB port of the computer.
2. Make sure the computer meets the minimum system requirement.
3. If the distance between the product and the receiver exceeds an effective range, please reduce the distance for better performance.

Attention

- 1. Please use dry and soft cloth to clean the product.
2. Do not disassemble the product by force.
3. Do not get in the rain or in the sun or fire.
4. Do not flush directly with water.

8

Shaft replacement method:

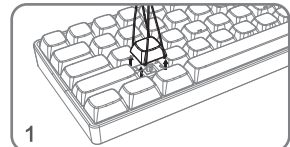

1 Use a keycap puller to unplug the key caps.

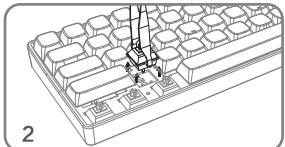

2 Pull out the switch with a switch puller.

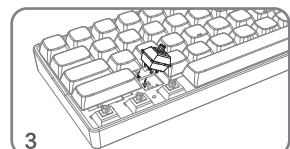

3 Check the installation position of the switch to be replaced and align the hole positions.

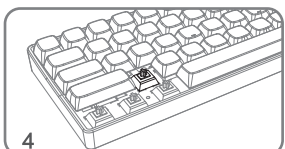

4 Place the new switch on the slot.

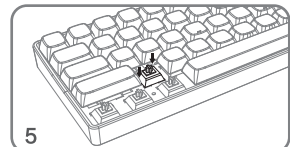

5 Gently press the new switch to install it into the slot.

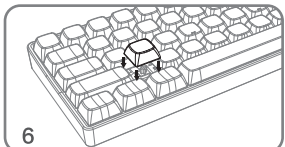

6 Install the keycap, you can use it normally.

9

Important safety and compliance information

Disposal of product and packing material: Waste Electrical and Electronic Equipment-WEEE. This symbol on the product or on its packaging indicates that this product must not be disposed of with your household waste.

CE Declaration of Conformity: This device complies with the requirements set out in the Council Directive on the Approximation of the Laws of the Member States relating to Electromagnetic Compatibility Directive (2014/30/EU), RoHS directive (2011/65/EU) and Radio Equipment Directive (2014/53/EU) for Radio Equipment.

Federal Communications Commission (FCC) Notice: This equipment has been tested and found to comply with the limits for a Class B digital device, pursuant to Part 15 of the FCC Rules. These limits are designed to provide reasonable protection against harmful interference in a residential installation.

THIS CLASS B DIGITAL APPARATUS MEETS ALL REQUIREMENTS OF THE CANADIAN INTERFERENCE - CAUSING EQUIPMENT REGULATIONS. FCC Compliance Statement: This device complies with Part 15 of the FCC Rules. Operation is subject to the following two conditions: (1) this device may not cause harmful interference, and (2) this device must accept any interference received, including interference that may cause undesired operation.

Commission Fédérale de la Communication: Cet équipement a été testé et déclaré conforme aux limites des appareils numériques de classe B aux termes de l'article 15 Des règles de la FCC. Ces limites sont conçues de façon à fournir une protection raisonnable contre les interférences nuisibles dans le cadre d'une installation résidentielle.

CET appareil produit, utilise et peut émettre des hyperfréquences qui, si l'appareil n'est pas installé et utilisé selon les consignes données, peuvent causer des interférences nuisibles aux communications radio. Cependant, rien ne peut garantir l'absence d'interférences dans le cadre d'une installation particulière. Si cet appareil est la cause d'interférences nuisibles pour la réception des signaux de radio ou de télévision, ce qui peut être évité en fermant l'équipement, puis en le remettant en fonction, l'utilisateur pourrait essayer de corriger la situation en prenant les mesures suivantes.

Toutes modifications n'ayant pas reçu l'approbation des services compétents en matière de conformité est susceptible d'interdire à l'utilisateur l'usage du présent équipement. CET APPAREIL NUMÉRIQUE DE LA CLASSE B RESPECTE TOUTES LES EXIGENCES DU RÈGLEMENT SUR LE MATÉRIEL BROUILLEUR DU CANADA.

10



Dear customer, Thank you for purchasing a ROYALAXE accessory product. To ensure you a reliable after-sales service, please read the following instructions carefully. This product warranty period is valid for one year from the date of purchase (the date of receipt of the return receipt and the invoice date of the buyer).

- The following situations are not covered by after-sales service :
1. Unable to provide a valid warranty card and invoice (not including those that can prove the products is within the valid warranty period) or the alteration of the warranty without authorization.
2. The product model and serial number on the warranty card are not in conformity with the physical product or without the distributor seal.
3. The model number, serial number or production date code on the product has been altered, removed or made illegible.
4. The defect is the result of excessive use outside the intended purpose, e.g. non-stop use in a commercial environment.
5. Damage due to not used in accordance with product instructions.
6. Damage caused by the use of pirated software or computer virus during use.
7. Damage caused by accident, damage, or repair from unauthorized service vendors.
8. Damage caused by force majeure.
9. The product does not work properly due to missing connection caused by accident, signal interference or other influential factors during use.
10. For normal wear and tear defects, or by their nature consumable parts.
11. The product does not function properly because it was not originally designed, manufactured or approved for use in the country where you use the product, which might occur when you imported the product.

If the functions of the product which you had purchased are defected or can not be used normally, please contact your local retailer.

The serial number of the product filled in the form must be consistent with the actual product. This certificate the primary instrument for the after-sales service, please safe keep it. If you need technical support, please show this warranty card, and we will provide quality and professional services.

11

Table with 3 columns: Information type (Commodity, User, Sales, Maintenance), Name, and Value. Includes fields for Name, Place of origin, Model No., Serial No., Address, Tel., Postcode, Retailer, Invoice No., Stamp & Signature, etc.

12

Customer Support : Email: support@protoarc.com

Co-created by ProtoArc x RoyalAxe

Manufacturer: Dongguan Lingjie Electronics & Technology Co., Ltd Address: No. 23 Zhenxing North Road, Xiegang Town, Dongguan,Guangdong, China Web:https://www.protoarc.com



Made in China

背面