

User Manual

2.4G+Bluetooth+Bluetooth Wireless
Rechargeable Trackball Mouse

CONTENTS

Product Features	2
2.4G USB Connection	3
Bluetooth Connection	4
Charging Function Guide	11
How to Switch Connection Mode	12
Data Parameters	13
What's in Package	13

Product Features

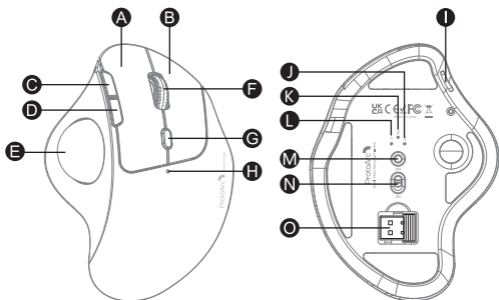

- A** Left Button
- B** Right Button
- C** Forward Button
- D** Backward Button
- E** Trackball
- F** Scroll Wheel
- G** DPI Button
- H** Charging / DPI Indicator
- I** TYPE-C Charging Port
- J** Wireless 2 Indicator
- K** Wireless 1 Indicator
- L** 2.4G Indicator
- M** Switch Device Button
- N** Power Switch
- O** USB Receiver

2.4G USB Connection

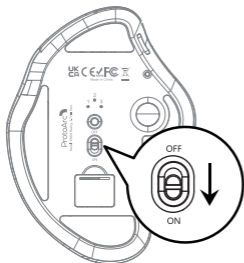

1. Turn on the power switch to ON.

1

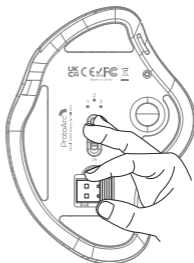

2. Take out the receiver.

2

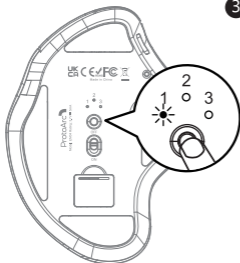

3. Press the mode switch button until the white light 1 is on and enter 2.4G mode.

3

4

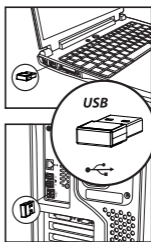

4. Insert the usb receiver into your computer's usb port.

Bluetooth Connection

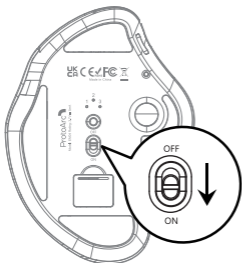

1. Turn on the power switch to ON.

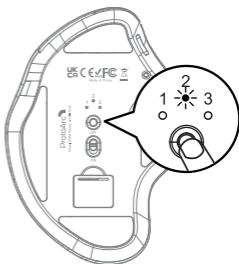

2. Press the mode switch button and switch to 2 or 3 mode, the white light flashes slowly.

1 2

3

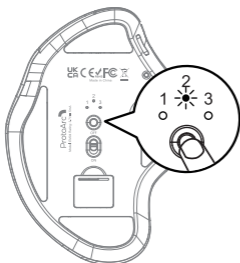

3. Press and hold the mode switch button for 3~5 seconds until the white light flashes quickly, then the mouse enters the Bluetooth pairing mode.

Windows 10 System

- 4 Click "Bluetooth device".



- 5 Click "Add or remove a Bluetooth device".

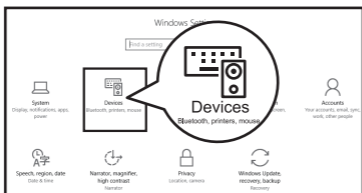

- 6 Your computer will automatically search for "ProtoArc EM04" and then click "pair".

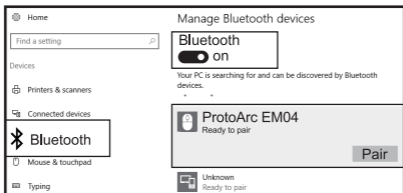

- 7 "ProtoArc EM04" is connected and can be used normally.

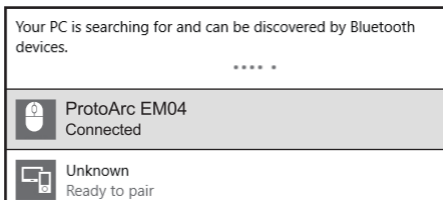

Mac OS System

Please complete the Bluetooth mode installation step 123 before pairing.

- 4 Click "System Preferences" on Mac.



- 5 Click "Bluetooth" in "System Preferences".

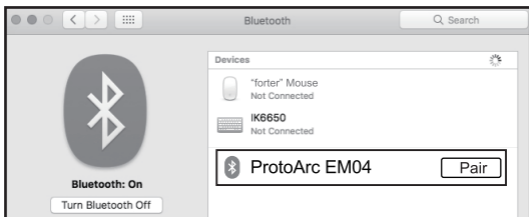

- 6 Your computer will automatically find "ProtoArc EM04", then click "pair", and you can use it after installation.

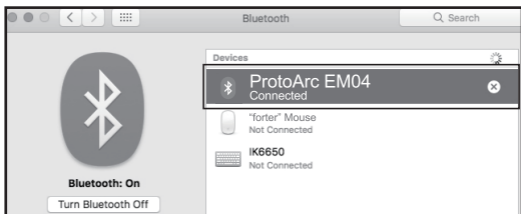

iOS System

Only the system above iOS 13 supports the mouse function.

Please complete the Bluetooth mode installation step 123 before pairing.

- 4 Click Settings on your device, then turn on Accessibility.

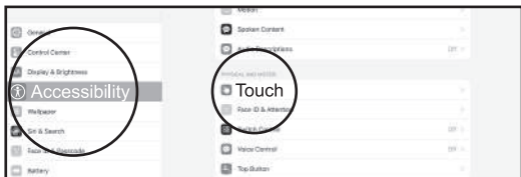

- 5 Click Touch.

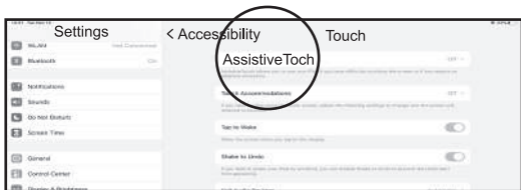

- 6 Turn on Assistive Touch.

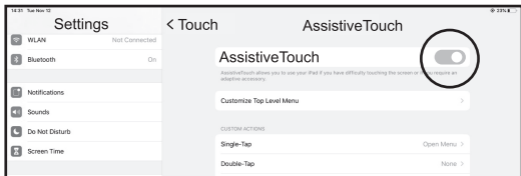

- 7 Click Settings on the device, then turn on Bluetooth.

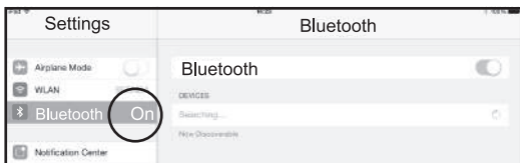

- 8 Your computer will automatically find "ProtoArc EM04", then click "Pair", complete pairing.

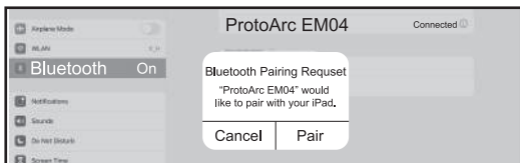

- 9 "ProtoArc EM04" is connected and can be used normally.

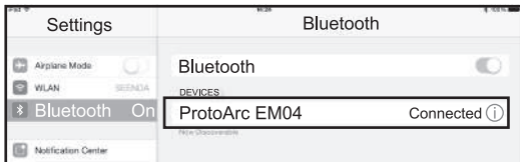

Android system

Please complete the Bluetooth mode installation step 123 before pairing.

- 4 Click Settings on the device, then turn on Bluetooth



- 5 Your computer will automatically find "ProtoArc EM04", then click "pair", complete pairing.

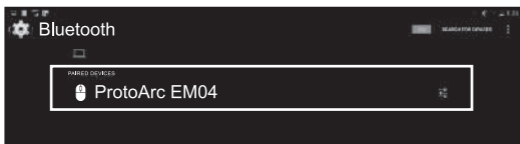

- 6 "ProtoArc EM04" is connected and can be used normally



Charging Function Guide

When the power is insufficient, the charging indicator and the corresponding channel indicator flash until it is turned off. Please connect the power supply for charging in time, and use the USB cable to connect the TYPE-C charging Port.

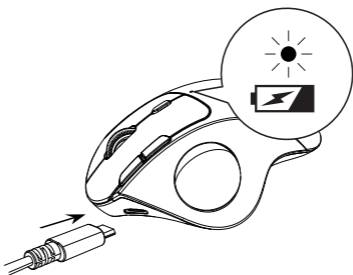

Connect the charging cable to the USB port of the computer, the charging indicator is always on during charging, the charging time is about 1-3.5 hours and the indicator light turns off when charging is complete.

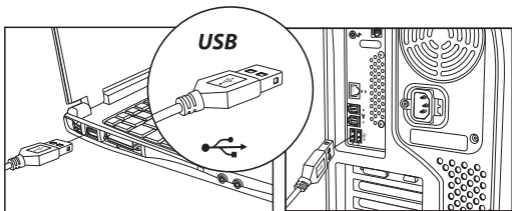

How to switch connection mode

After BT1, BT2 and 2.4G USB mode is connected, press the mode switch button on the top of the mouse to switch between multiple devices.

Wireless 1 Device Connection

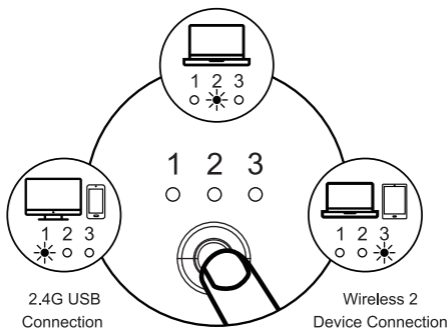

Data parameters

Basic parameter:

Movement Detection Technology: Optical

Lithium Battery Capacity: 300mA

DPI: 200-400-800-1200-1600

Click Life: 3 million+

Dimension: 136.8*100.5*52.3mm

Weight: 119g

Bluetooth transmission parameters:

Transmission distance: 10m

Working Voltage: 3.7V

Working current: 8mA

Reaction rate: 125Hz

System requirement:

Bluetooth-enable device

Windows 8, Windows 10 or higher version

Mac OS x 10.10 or higher version

Android 4.3 or higher version

2.4G transmission parameters:

Transmission distance: 20m

Working Voltage: 3.7V

Working current: 10mA

Reaction rate: 250Hz

System requirement:

An available USB port

Windows XP, Windows 7, Windows 8, Windows 10 or higher version

Mac OS x 10.10 or higher version

What's in Package

- ▶ 1 x Wireless Mouse
- ▶ 1 x USB Receiver
- ▶ 1 x Type C Charging Cable
- ▶ 1 x User Manual