

# User Manual

2.4G+Bluetooth+Bluetooth Wireless  
Rechargeable RGB Trackball Mouse

## Product Features

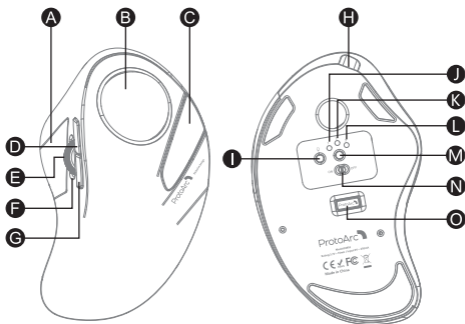

- A** Left Button
- B** Trackball
- C** Right Button
- D** Forward Button
- E** Scroll Wheel
- F** Charging / DPI Indicator
- G** Backward Button
- H** TYPE-C Charging Port
- I** Light Switch Button
- J** 2.4G Indicator
- K** Bluetooth 1 Indicator
- L** Bluetooth 2 Indicator
- M** Mode Switch Button
- N** Power Switch
- O** USB Receiver

**Five DPI:** 200-400-800-1200-1600, pressing the scroll wheel and right button simultaneously for 5 seconds to switch. The number of times the light flashes on the scroll wheel indicates the level of DPI. Only one level of DPI can be adjusted at a time.

**Light mode:** Flow-Breath-Constant-Wave-Off, if the mouse is inactive for 2 minutes, the light will turn off automatically.

## 2.4G USB Connection

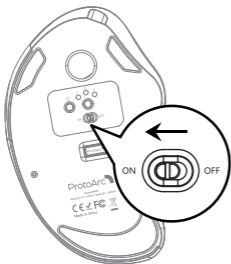

1. Turn on the power switch to ON.

1

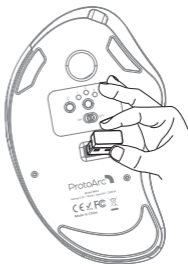

2. Take out the receiver.

2

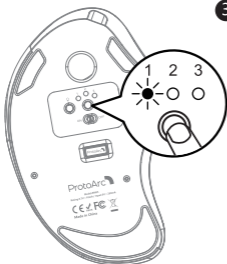

3. Press the mode switch button until the white light ① is on and enter 2.4G mode.

3

4

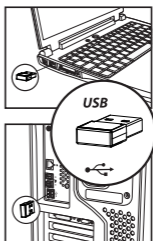

4. Insert the usb receiver into your computer's usb port.

## Bluetooth Connection

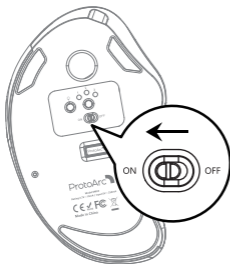

1. Turn on the power switch to ON.

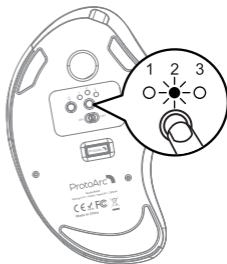

2. Press the mode switch button and switch to ② or ③ mode, the white light flashes slowly.

1

2

3

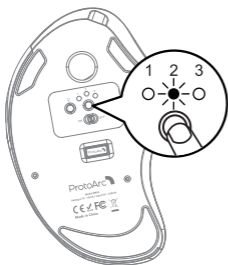

3. Press and hold the mode switch button for 3~5 seconds until the white light flashes quickly, then the mouse enters the Bluetooth pairing mode.

## Windows 10 System

- 4 Click "Bluetooth device".



- 5 Click "Add or remove a Bluetooth device".

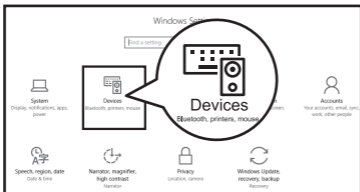

- 6 Your computer will automatically search for "ProtoArc EM03" and then click "pair".

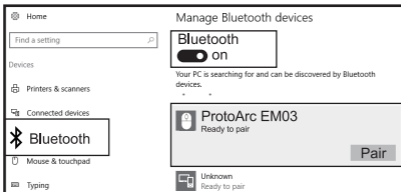

- 7 "ProtoArc EM03" is connected and can be used normally.

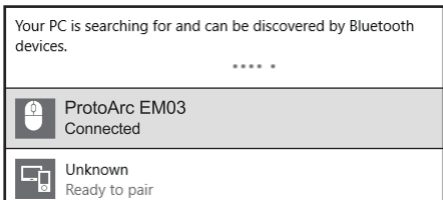

## Mac OS System

Please complete the Bluetooth mode installation step 123 before pairing.

- 4 Click "System Preferences" on Mac.



- 5 Click "Bluetooth" in "System Preferences".

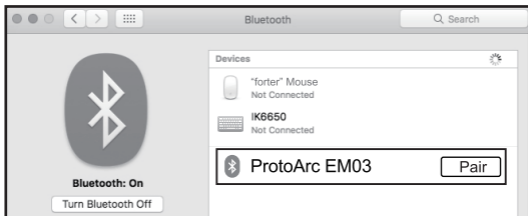

- 6 Your computer will automatically find "ProtoArc EM03", then click "pair", and you can use it after installation.

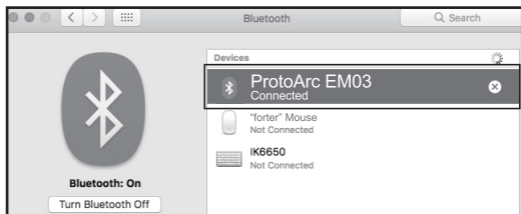

## iOS System

Only the system above iOS 13 supports the mouse function.

Please complete the Bluetooth mode installation step 123 before pairing.

- 4 Click Settings on your device, then turn on Accessibility.

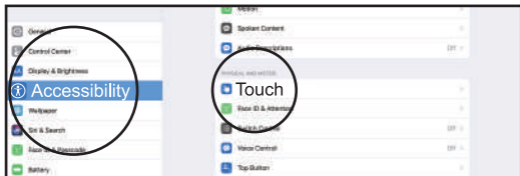

- 5 Click Touch.

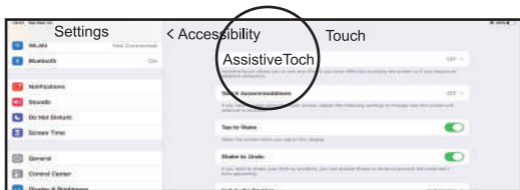

- 6 Turn on Assistive Touch.

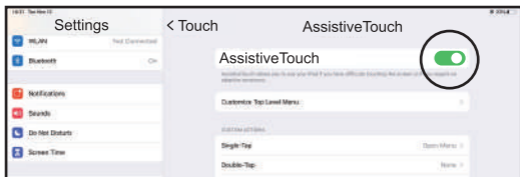



- 7 Click Settings on the device, then turn on Bluetooth.

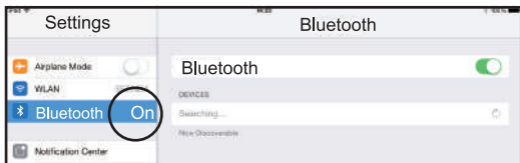

- 8 Your computer will automatically find "ProtoArc EM03", then click "Pair", complete pairing.

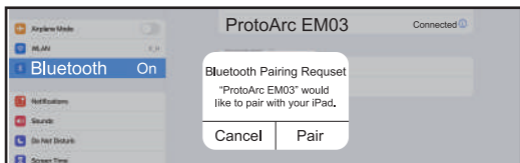

- 9 "ProtoArc EM03" is connected and can be used normally.

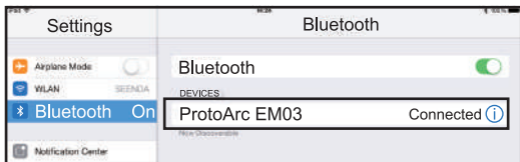

## Android system

Please complete the Bluetooth mode installation step 123 before pairing.

- 4 Click Settings on the device, then turn on Bluetooth.

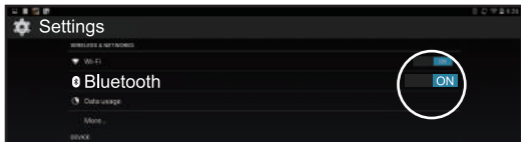

- 5 Your computer will automatically find "ProtoArc EM03", then click "pair", complete pairing.

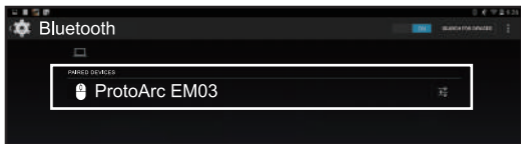

- 6 "ProtoArc EM03" is connected and can be used normally.

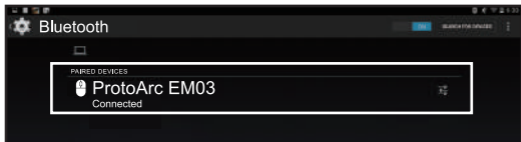

## Charging Function Guide

When the power is insufficient, the charging indicator and the corresponding channel indicator flash until it is turned off. Please use the attached charging cable to charge in time.

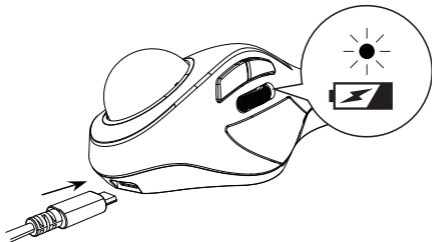

Plug the charging cable into the USB port of the computer. The charging light will turn red during the charging process. The charging time is about 1-3.5 hours. The charging light will turn green after the charging is completed.

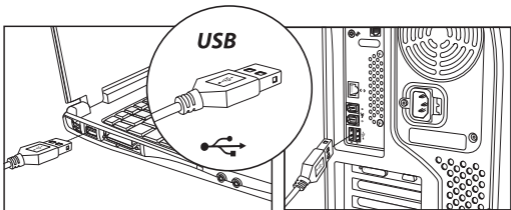

## How to switch connection mode

After BT1, BT2 and 2.4G USB mode is connected, press the mode switch button on the top of the mouse to switch between multiple devices.

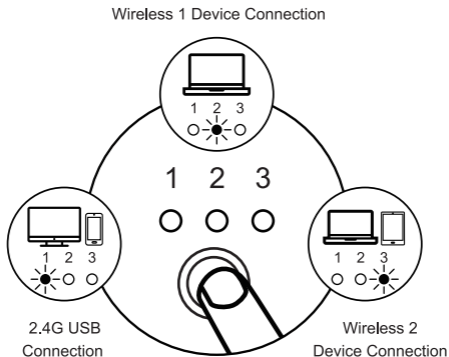

Press the mode switch button on the top of the mouse to switch between 3 devices.

## Data parameters

### Basic parameter:

Movement Detection Technology: Optical

Lithium battery Capacity: 930mA

DPI: 200-400-800-1200-1600

Click life: 3 million+

Dimension: 167.8\*105.5\*55.1mm

Weight: 193.2g

### Bluetooth transmission parameters:

Transmission distance: 10m

Working Voltage: 3.7V

Working current: 10mA

Reaction rate: 125Hz

### System requirement:

Bluetooth-enable device

Windows 8, Windows 10 or higher version

Mac OS x 10.10 or higher version

Android 4.3 or higher version

### 2.4G transmission parameters:

Transmission distance: 20m

Working Voltage: 3.7V

Working current: 10mA

Reaction rate: 250Hz

### System requirement:

An available USB port

Windows XP, Windows 7, Windows 8, Windows 10 or higher version

Mac OS x 10.10 or higher version

## What's in Package

- ▶ 1 x Wireless Mouse
- ▶ 1 x USB Receiver
- ▶ 1 x Type C Charging Cable
- ▶ 1 x User Manual