



# **EKM01 Plus**

# User Manual

Dual Mode Ergonomic  
Keyboard and Mouse Combo

[support@protoarc.com](mailto:support@protoarc.com)

[www.protoarc.com](http://www.protoarc.com)

## CONTENTS

<b>Product Features</b>	<b>2</b>
<b>2.4G USB Connection</b>	<b>4</b>
<b>Mouse Bluetooth Connection</b>	<b>5</b>
<b>Keyboard Bluetooth Connection</b>	<b>6</b>
<b>How to Switch Mouse Device Channels</b>	<b>7</b>
<b>How to Switch Keyboard Device Channels</b>	<b>7</b>
<b>Charging Guide</b>	<b>8</b>
<b>Multimedia Function Button</b>	<b>9</b>
<b>Product Specification</b>	<b>10</b>
<b>Sleep Mode</b>	<b>11</b>
<b>Tips</b>	<b>11</b>
<b>Packing List</b>	<b>11</b>

## Product Features

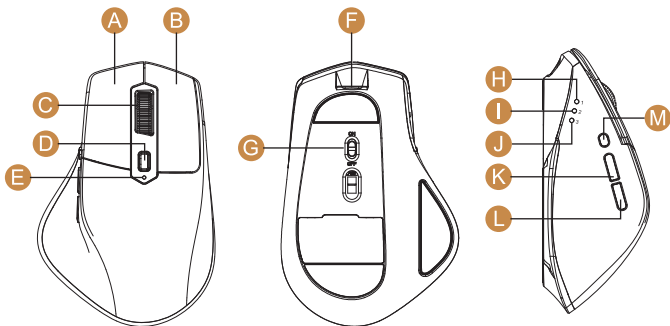

**A** Left Button

**B** Right Button

**C** Scroll Wheel Button

**D** DPI Button

**E** Low Power / Charging Indicator

**F** Type-C Charging Port

**G** Power Switch

**H** 2.4G Indicator

**I** BT1 Indicator

**J** BT2 Indicator

**K** Forward Button

**L** Backward Button

**M** Channel Switch Button

### DPI Button

Press the DPI button to adjust the cursor sensitivity. A single flash of indicator light corresponds to DPI level 800, two to 1300, and three to 2000.

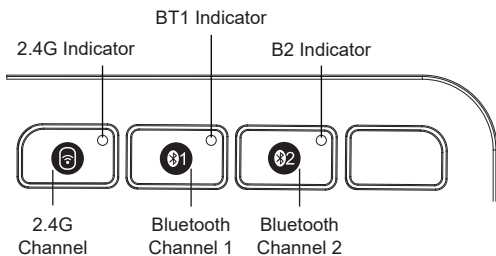
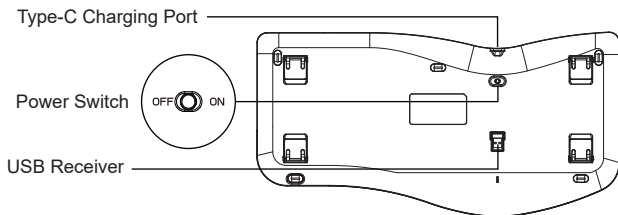
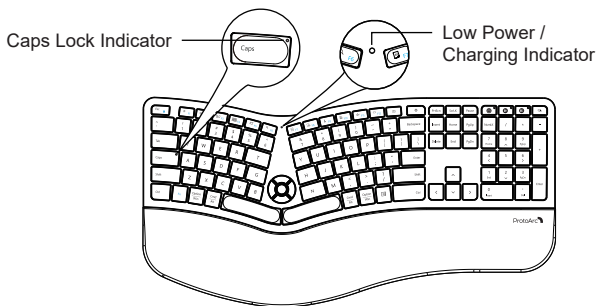

## 2.4G USB Connection

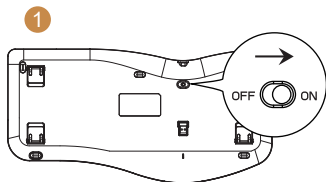

1. Switch the keyboard ON.

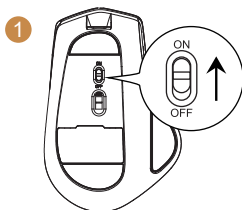

1. Switch the Mouse ON.

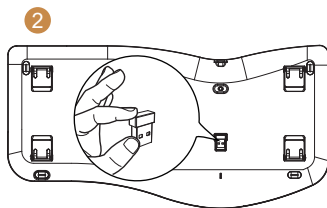

2. Take out the USB receiver.

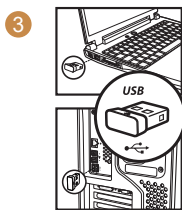

3. Plug it into a USB port on your computer.

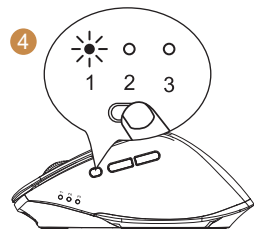

4. Press the mode switch button on the left of the mouse to channel 1, the 2.4G indicator will be on, now the mouse is in 2.4G mode.

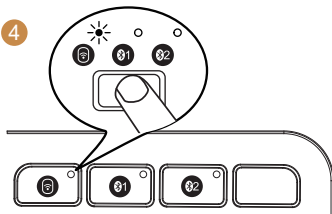

4. Press **Fn** key to switch to 2.4G channel, the white indicator will flash slowly, the keyboard now is in 2.4G mode.

## Mouse Bluetooth Connection

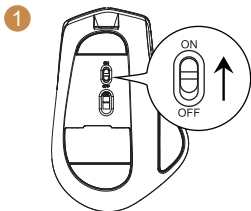

1. Turn the power switch to ON.

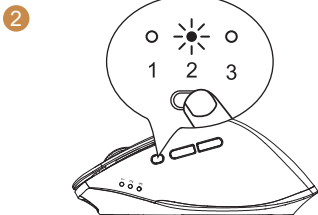

2. Press the channel switch button to channel 2 or 3 until the corresponding channel indicator is on.

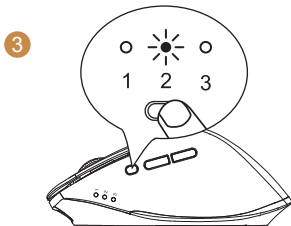

3. Long press the channel switch button for 3~5 seconds until the corresponding channel indicator flashes quickly, the mouse enters Bluetooth pairing mode.

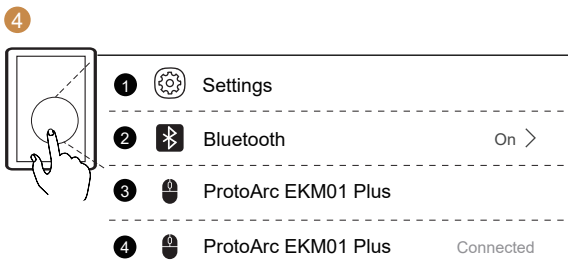

4. Turn on the Bluetooth settings on your device, search or select “ProtoArc EKM01 Plus” and start Bluetooth pairing until the connection is completed.

## Keyboard Bluetooth Connection

1

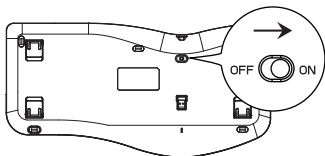

1. Turn the power switch to ON.

2

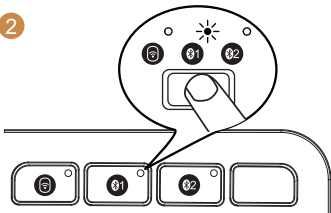

2. Press the channel switch button 01 / 02 until the corresponding channel indicator is on.

3

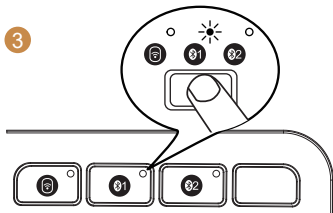

3. Long press the channel switch button for 3~5 seconds until the corresponding channel indicator flashes quickly, the keyboard enters Bluetooth pairing mode.

4

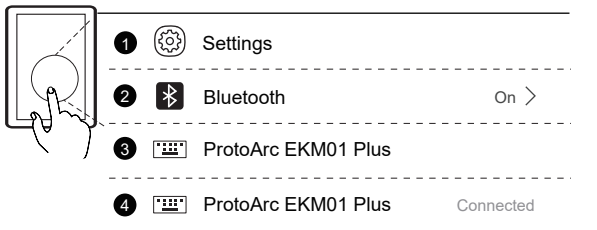



4. Turn on the Bluetooth settings on your device, search or select “ProtoArc EKM01 Plus” and start Bluetooth pairing until the connection is completed.

## How to Switch Mouse Device Channels

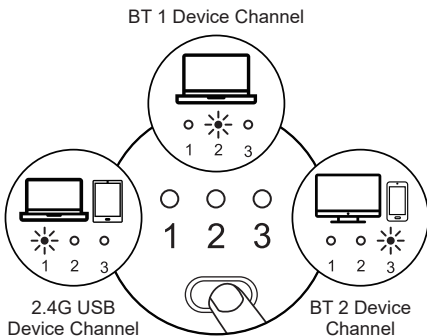
After BT1, BT2 and 2.4G USB mode is connected, press the mode switch button on the left side of the mouse to switch between multiple devices.



## How to Switch Keyboard Device Channels

After  |  |  are connected, press the corresponding channel key to switch between devices.

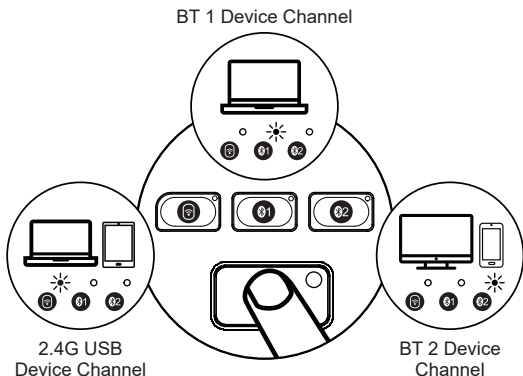



## Charging Guide

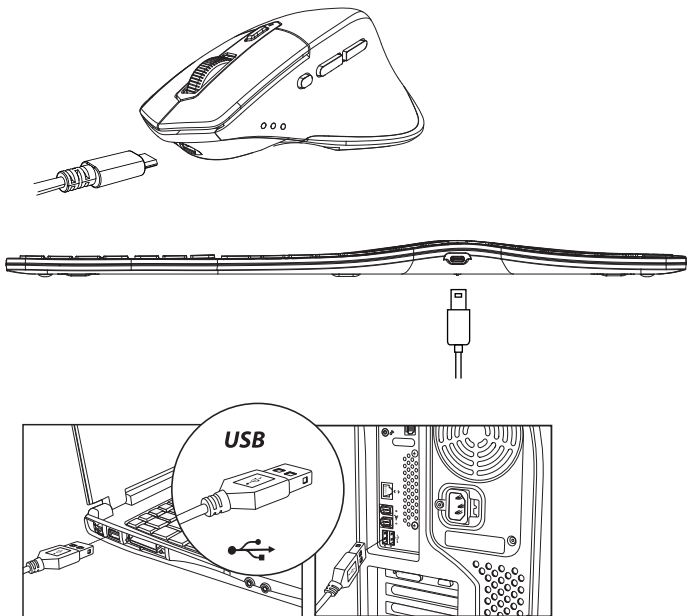

1. When the battery is low, the indicator light will turn red and start flashing until the keyboard/mouse is turned off.
2. Insert the Type-C port into the Keyboard/Mouse and the USB-A port into the computer to charge, the red light stays on while charging.
3. It takes 2–3 hours for one cycles full charged, and the indicator turns green when fully charged.

## Multimedia Function Button

Buttons	Windows	Android	iOS	MAC OS
	Decrease brightness	Decrease brightness	Decrease brightness	Decrease brightness
	Increase brightness	Increase brightness	Increase brightness	Increase brightness
	Window switching	Window switching	/	Multi-window preview
	Multi-window preview	/	App switching	App switching
	Show desktop	/	/	Show desktop
	Search	Search	Search	Search
	Select all	Select all	Select all	Select all
	Copy	Copy	Copy	Copy
	Cut	Cut	Cut	Cut
	Paste	Paste	Paste	Paste
	Mute	Mute	Mute	Mute
	Home	Home	Home	/
	Screenshot	Screenshot	Screenshot	Screenshot
	Open Setting	/	/	/
	Lock	/	Lock	Lock
	Volume up	Volume up	Volume up	Volume up
	Volume down	Volume down	Volume down	Volume down
	Previous	Previous	Previous	Previous
	Play&Stop	Play&Stop	Play&Stop	Play&Stop
	Next	Next	Next	Next
	Press FN+ESC to turn ON / OFF the FN function			

**NOTE:** The FN function is for alternate commands (F1-F12 & multimedia functions are dual-use keys).

## Product Specification

### Keyboard

Compatible Operating Systems	2.4G: Windows System Bluetooth: Windows 8, Windows 10 or above, Mac OS X 10.12 or above, Android 4.3 or above.
Battery Capacity	500mAh
Sleep Time	Enter into the sleep mode after no operation of 60 minutes
Battery Life	1000 times charge and discharge
Key Life	3 Millions Strokes
Standby Time	≥ 365 Days
Wake Up Way	Press any key
Operating Distance	8 m / 26 ft
Working Current	≤3mA
Keyboard Dimension	480.1 x 244.4 x 25.6 mm / 18.9 x 9.6 x 1.0 in

### Mouse

Compatible Operating Systems	2.4G: Windows System Bluetooth: Windows 8, Windows 10 or above, Mac OS X 10.12 or above, Android 4.3 or above.
Working Voltage	3.7V
Working Current	≤3.5mA
DPI	800-1300-2000
Sleep Time	60 mins
Working Time	140 hours
Charging Time	2-3 hours
Battery Capacity	500mAh
Wake Up Way	Press any button
Operating Distance	8 m / 26 ft
Standby Time	100 Days
Mouse Dimension	124.6 x 83.6 x 50.4 mm / 4.9 x 3.3 x 2.0 in

## Sleep Mode

1. When the keyboard is idle for more than 60 minutes, it will automatically enter sleep mode and the indicator light will turn off.
2. To wake up the keyboard, simply press any key on the keyboard, and it will be ready within 3 seconds. The indicator light will light up again.

## Tips

1. If the Bluetooth connection is not working properly, turn off and turn on the keyboard or to restart the device's Bluetooth and attempt to reconnect. Or delete the extra Bluetooth option name in the Bluetooth connection list of the device and reconnect.
2. To switch to a successfully connected channel, press the channel button and wait for 3 seconds before continuing to use.
3. The keyboard has a memory function. When it connected on a specific channel, turn off the keyboard and turn on again, they will automatically connect to the default channel and this channel indicator is on.

## Packing List

- ▶ 1 x Wireless Bluetooth Keyboard
- ▶ 1 x Wireless Bluetooth Mouse
- ▶ 1 x USB Receiver
- ▶ 1 x Type-C Charging Cable
- ▶ 1 x User Manual