

User Manual

2.4G + BT1 + BT2

Wireless Ergonomic Split Keyboard

Product Features

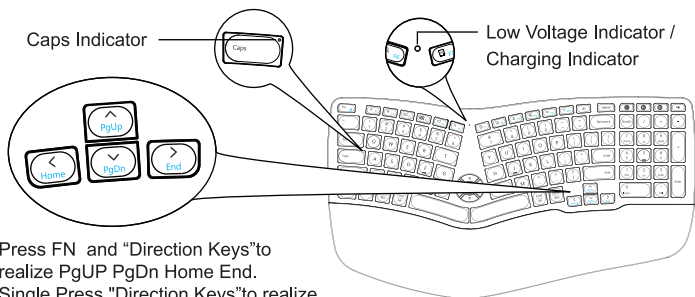

Press FN and "Direction Keys" to realize PgUP PgDn Home End.
Single Press "Direction Keys" to realize direction key function.

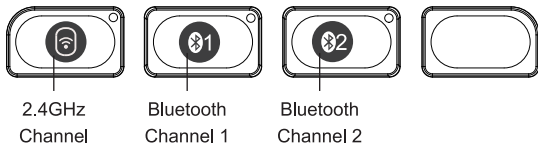
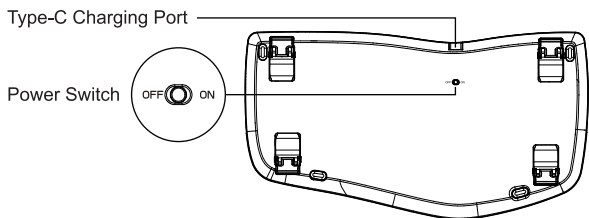

2.4GHz Connection Steps

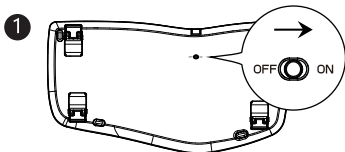

1. Switch the keyboard power ON.

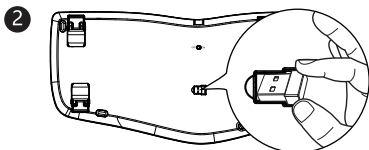

2. Take out the USB receiver.

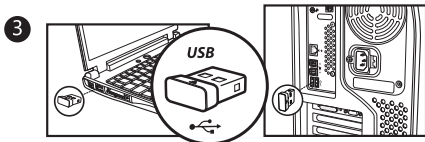

3. Plug the USB receiver into the USB port of the computer.

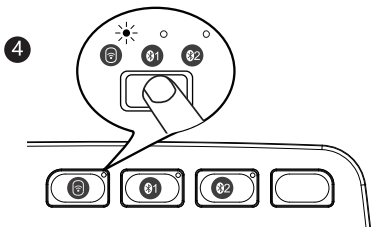

4. Press **F6** key to switch to 2.4G channel, the white indicator will flash slowly, the keyboard now is in 2.4G mode.

Bluetooth Connection Steps

1

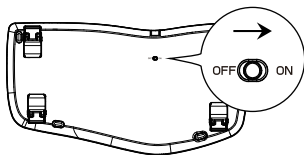

1. Switch the power ON.

2

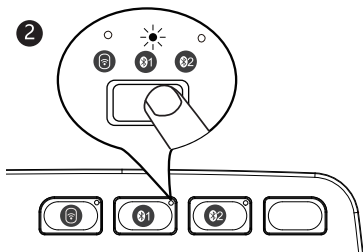

2. Press the channel key to choose a bluetooth channel 01 / 02, when the indicator light flashes slowly, keyboard is in the corresponding channel.

3

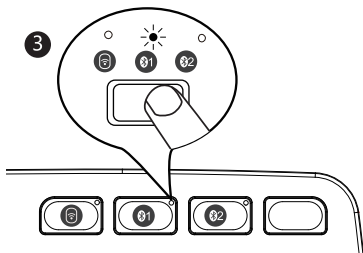

3. Hold and press the channel key for 3 to 5 seconds, the white indicator will flash quickly, the keyboard now enters bluetooth pairing mode.

Windows 10 OS

4 Open "Settings" and Click Bluetooth Devices.

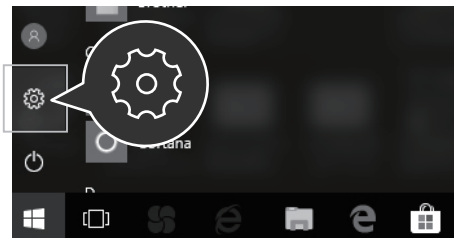

5 Choose “Add / Delete Bluetooth Devices”.

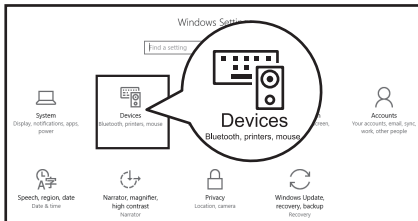

6 Search for “ProtoArc EK01-NL” and click “Pair”.

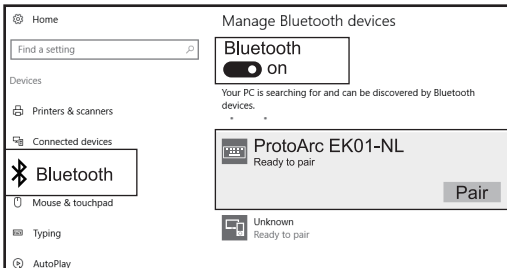

7 Pairing is complete when it shows “ProtoArc EK01-NL Connected”.

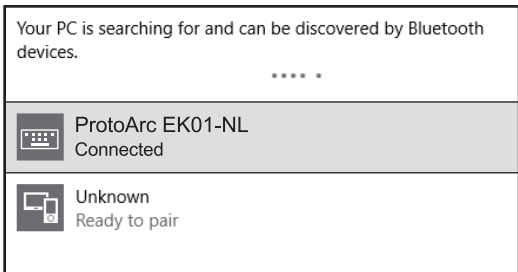

Mac OS

Complete Keyboard Bluetooth Connection Steps 1, 2 and 3 before pairing.

- 4 Find “System Preferences” on Mac.



- 5 Turn on “Bluetooth” in System Preferences, search for “ProtoArc EK01-NL”.



- 6 Click “Pair”, then wait until it shows “connected” for pairing to complete.



iOS

Complete Keyboard Bluetooth Connection Steps 1, 2 and 3 before pairing.

- 4 Open "Settings" and turn on Bluetooth.

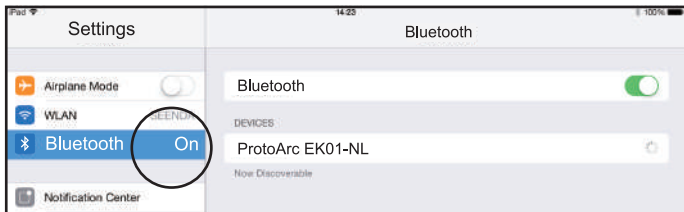

- 5 Choose "ProtoArc EK01-NL" from the list and click "Pair".

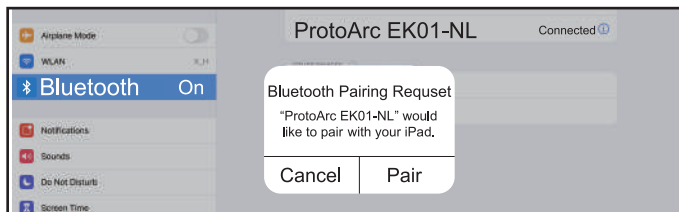

- 6 Pairing is complete when it shows "ProtoArc EK01-NL Connected".



Android System

Complete Keyboard Bluetooth Connection Steps 1, 2 and 3 before pairing.

- 4 Open “Settings” and turn on Bluetooth.

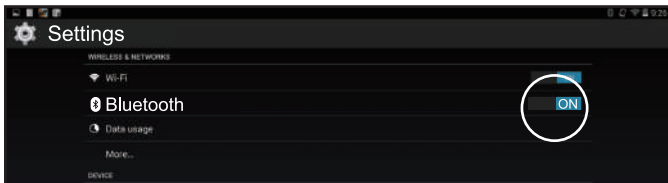

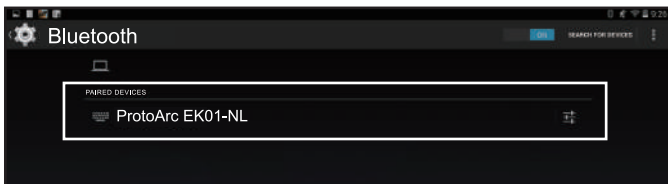

- 5 Bluetooth search and click to pair the “ProtoArc EK01-NL”.

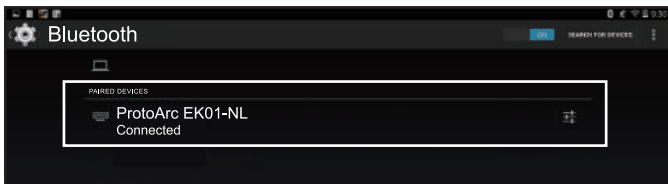

- 6 Pairing is complete when it shows “ProtoArc EK01-NL Connected”.



How to Switch Device Channels

After  |  |  are connected, press the corresponding channel key to switch between devices.

Bluetooth 1 Device Channel

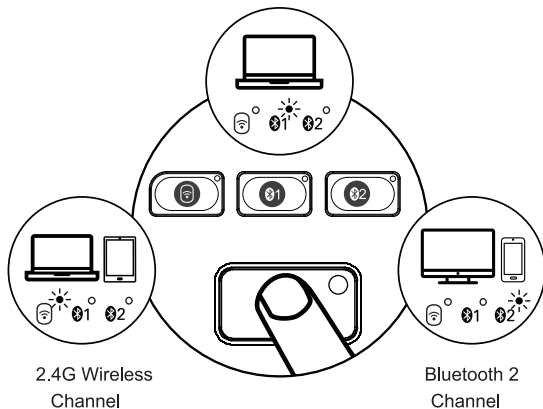



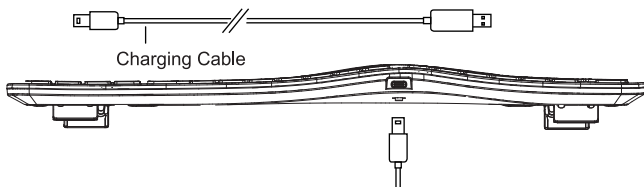







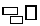

Keyboard Charging



When battery is low, the power indicator light will start to flash until the keyboard turns off. Please recharge as soon as possible to ensure best user experience. Low battery may cause poor connection quality, resulting delays or other problems while using.

The power indicator light is red while charging and will turn green when fully charged. One full charge cycle takes about 2-3 hours.

Multimedia Function Button

Buttons	Windows	Android	iOS	MAC OS
	Decrease brightness	Decrease brightness	Decrease brightness	Decrease brightness
	Increase brightness	Increase brightness	Increase brightness	Increase brightness
	Window switching	Window switching	/	Multi-window preview
	Multi-window preview	/	App switching	App switching
	Show desktop	/	/	Show desktop
	Search	Search	Search	Search
	Select all	Select all	Select all	Select all
	Copy	Copy	Copy	Copy
	Cut	Cut	Cut	Cut
	Paste	Paste	Paste	Paste
	Mute	Mute	Mute	Mute
	Home	Home	Home	/
	Screenshot	Screenshot	Screenshot	Screenshot
	Lock	/	Lock	Lock
	Volume up	Volume up	Volume up	Volume up
	Volume down	Volume down	Volume down	Volume down
	Previous	Previous	Previous	Previous
	Play&Stop	Play&Stop	Play&Stop	Play&Stop
	Next	Next	Next	Next
	press FN+ESC to turn ON / OFF the FN function			

NOTE: The FN function is for alternate commands (F1-F12 & multimedia functions are dual-use keys).

Product Specification

Compatible Operating Systems	2.4G: Windows System Bluetooth: Windows 8, Windows 10 or above, Mac OS X 10.12 or above, Android 4.3 or above.
Battery Capacity	300mAh
Sleep Time	Enter into the sleep mode after no operation of 30 minutes
Battery Life	1000 times charge and discharge
Key Life	3 Millions Strokes
Standby Time	200 Hours
Wake Up Way	Press any key
Operating Distance	8 m / 26 ft
Working Current	$\leq 3\text{mA}$
Keyboard Dimension	423.8 x 231.4 x 27.7mm / 16.7" x 9.1" x 1.1"

Tips

1. If keyboard fails to connect, switch the keyboard power OFF then turn it back ON, retry the Bluetooth connection procedures again. Clear the current Bluetooth connection list, remove current devices and then reconnect.
2. To switch to a already connected channel, please wait for 3 seconds after pressing the switch device button for it to respond.
3. The keyboard has memory function, when a keyboard channel is successfully connected, that channel connection will remain connected in the default channel. The corresponding indicator light will be on.

Sleep Mode

1. When the keyboard stays idle for more than 30 minutes, it will automatically enter sleep mode and the indicator light will be off.
2. To wake the keyboard simply press any key on the keyboard and it will be ready within 3 seconds. The indicator light will turn on again.

What's In Package

- ▶ 1 x Wireless Bluetooth Keyboard
- ▶ 1 x USB Receiver
- ▶ 1 x Type-C Charging Cable
- ▶ 1 x User Manual