

Installing a New Light System and SAE Pigtail

Provided Materials:

- Pigtail cord

Tools Recommended:

- Razor blade
- Phillips head screwdriver



1 Use the Phillips head screwdriver and remove bottom plate screws to access sign interior.



2 Disconnect the old light system from the sign.



3 Use razor to cut around the outer edge of the old pigtail socket. Remove through bottom of sign.



4 Insert new pigtail into hole and push it into place. This might require a bit of force.



5 Optional: If you purchased one of our tools, push it into the socket and rotate to ensure socket is open.

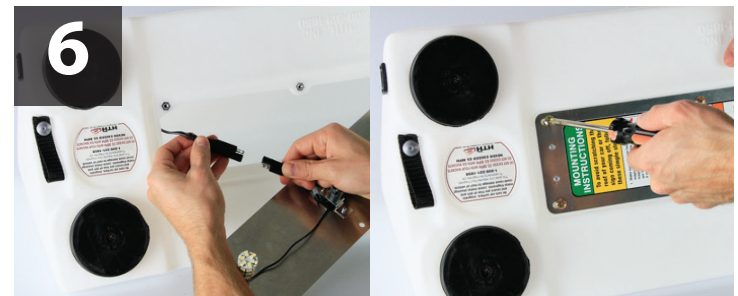

6 Connect new light system to new pigtail, then screw plate back into place with screwdriver.

If you have questions please call 407.629.0012