

# Install Magnetic Adapter Kit

## Provided Materials:

- 1.) 17" Magnetic Pigtail
- 2.) Quick Release to Magnetic
- 3.) Magnetic Adapter

## Tools Required:

- Phillipshead Screwdriver
- Box cutter

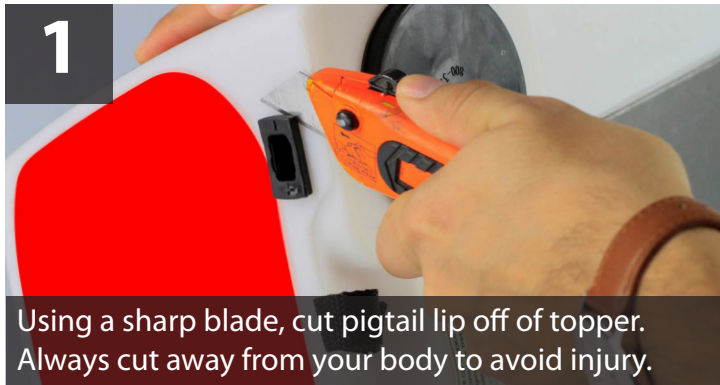
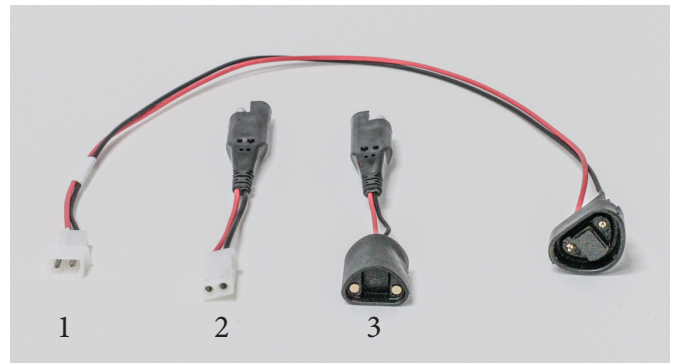

Using a sharp blade, cut pigtail lip off of topper. Always cut away from your body to avoid injury.



Remove screws from bottom of sign and remove the old lighting system.



Feed magnetic pigtail into hole and use hand to secure into place. This may require a bit of force.

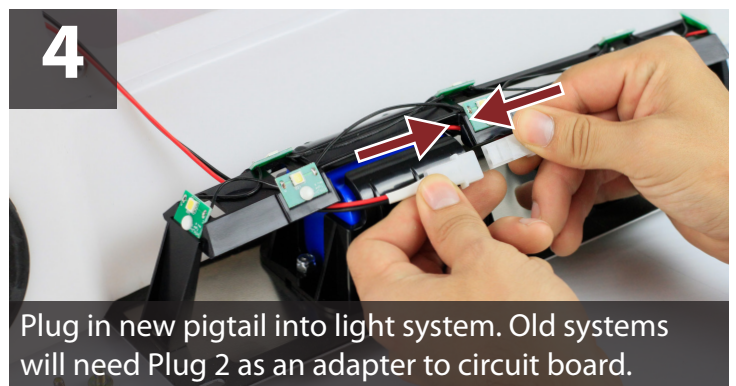

Plug in new pigtail into light system. Old systems will need Plug 2 as an adapter to circuit board.

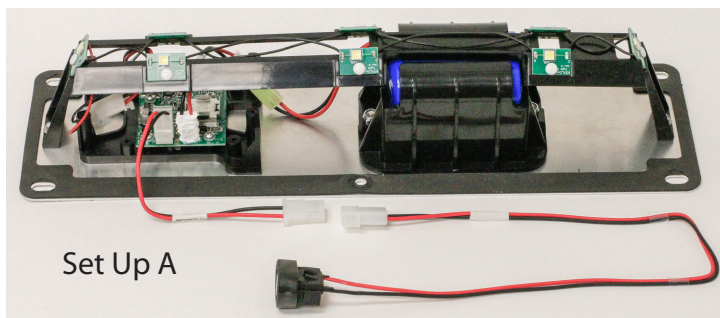

Set Up A

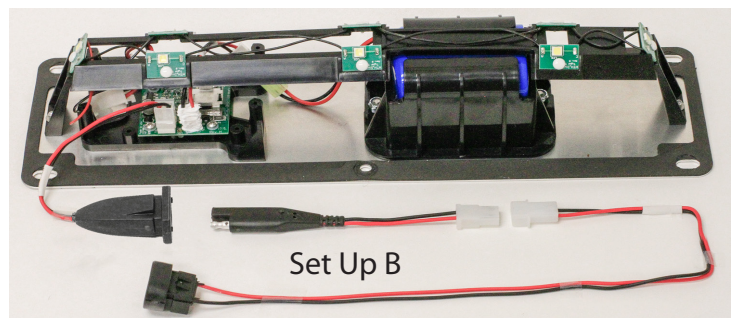

Set Up B



Screw new light system to the topper shell.

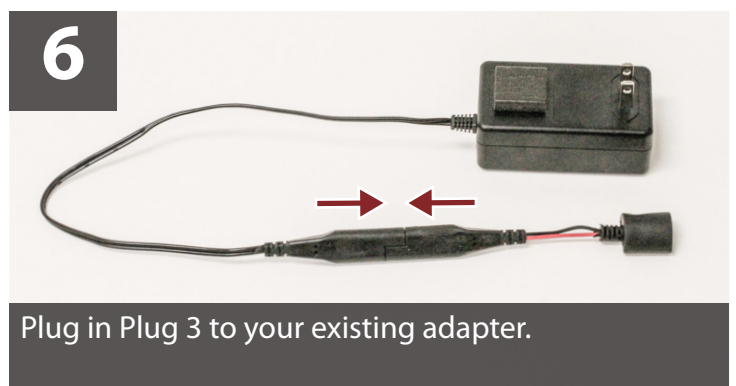

Plug in Plug 3 to your existing adapter.