

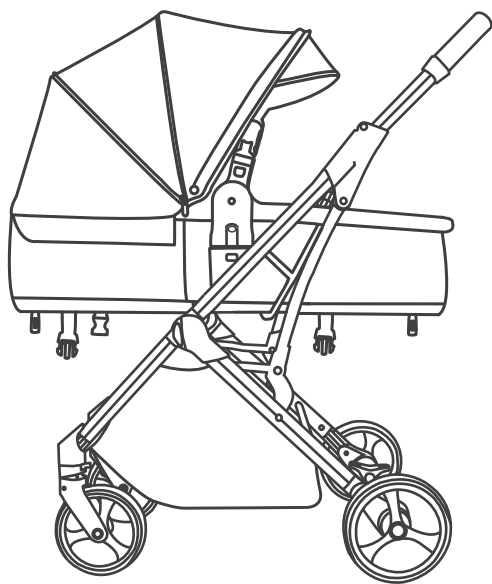

# Flight™ Stroller Instructions



Item: Flight™ Stroller  
Suitable for baby from 0-36 months old  
Max weight capacity: 45lbs

# **WARNING!**

Please read this manual carefully before using this product and keep for future reference.

1. Please ensure the brake is on before putting baby into the stroller.
2. Always use caution when adjusting the backrest.
3. Never leave a baby unattended.
4. Always use the five-point harness when the baby is in the stroller.
5. Do not allow the baby to stand on the stroller.
6. Do not hang anything on the stroller handles. Do not put anything on the canopy.
7. Always engage the brakes when stopped.
8. Overloading, folding incorrectly or using non-approved accessories may make the stroller unsafe.
9. This stroller is not recommended for baby over 45lbs.
10. Excessive weight may cause a hazardous, unstable condition to exist.
11. Suitable for age 0-36 months old.
12. Sitting mode and playing mode is not suitable for baby below 5 months old.
13. It is not recommended you carry more than 6lbs in the lower basket.
14. Baby should not climb into the stroller without assistance.
15. Parcels or accessory items placed on the stroller may cause the stroller to become unstable.

# Flight™ Stroller Parts Instructions

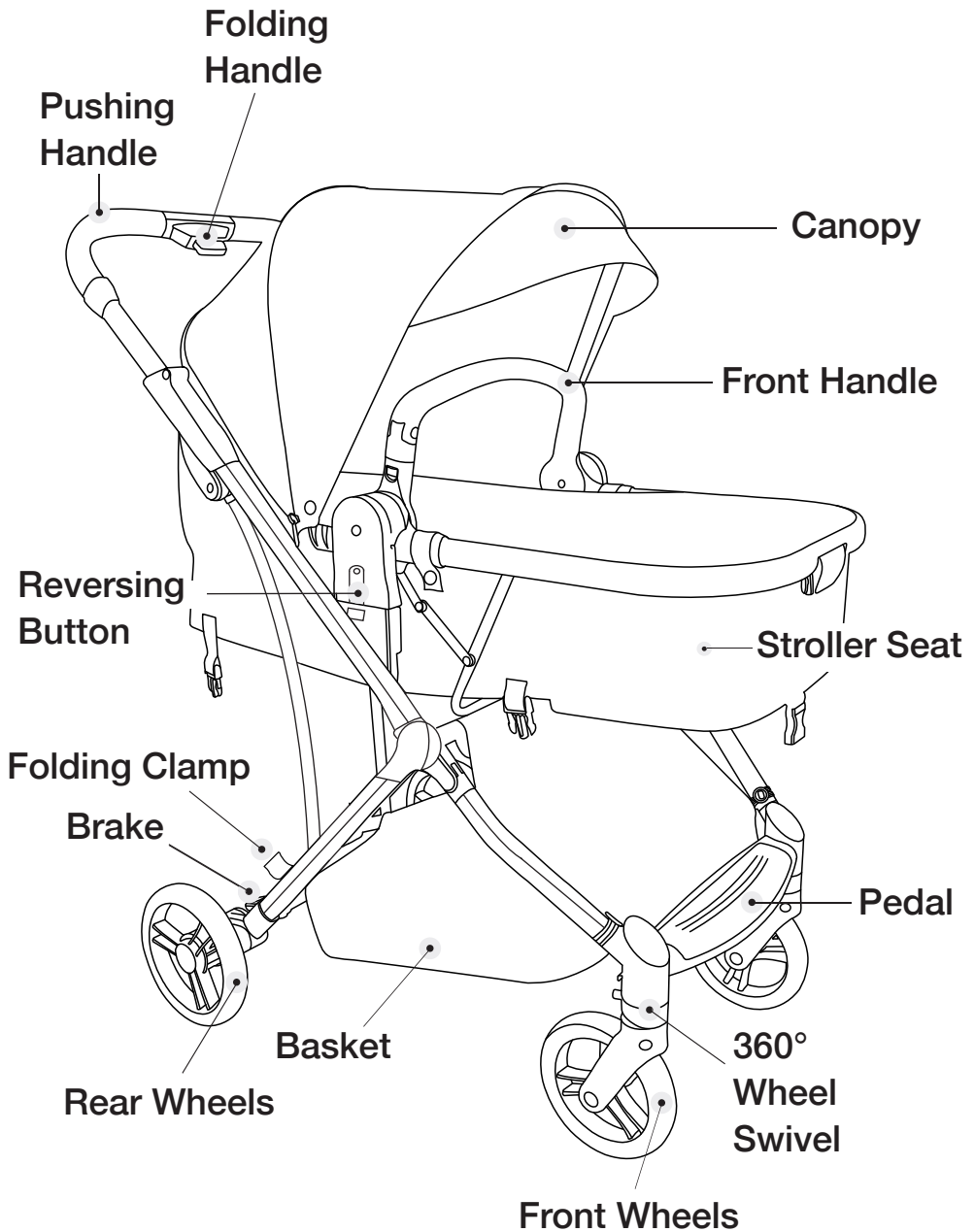

# Assembly Method

## 1. Open the Stroller Frame

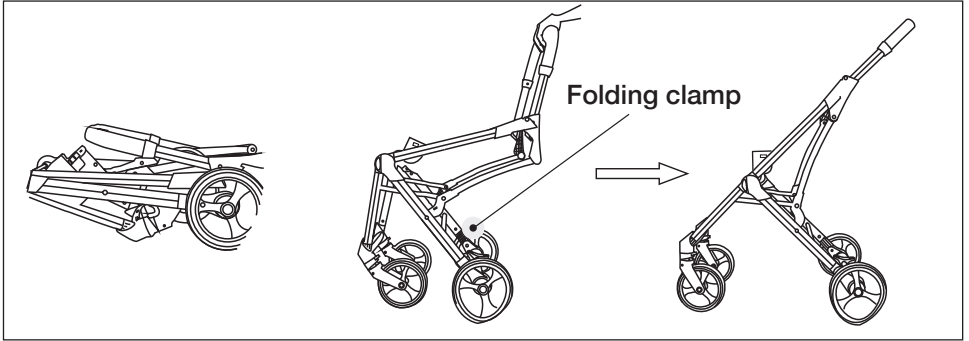

Open the package and take out the stroller. Place wheels on if needed. Unhook folding clamp. Face toward the rear wheels and leave the frame on the ground. Lift stroller up with arms on either side of frame until it locks in place.

## 2. Assembly & Disassembly for the Front Wheels

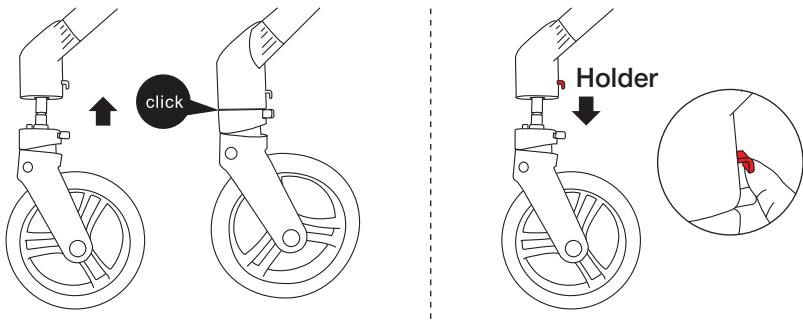

**Front Wheels Assembly:** Put the front wheel into the front wheel socket until hearing a clear “click” sound.

**Front Wheels Disassembly:** Press the holder, then remove the front wheels.

### 3. Assembly & Disassembly for the Rear Wheels

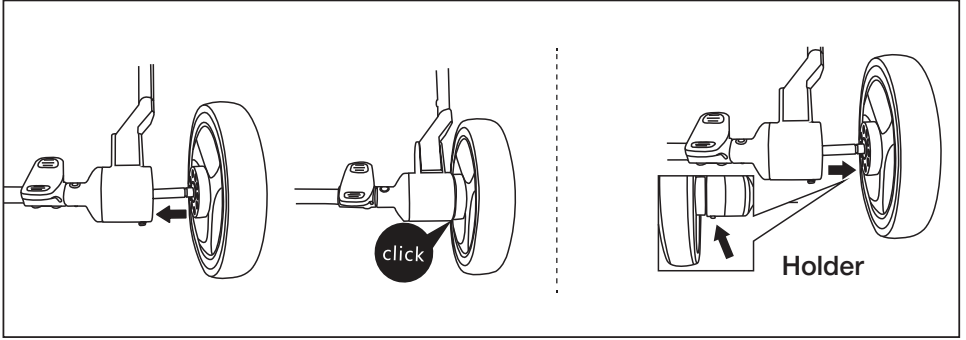

Rear Wheels Assembly: Put the rear wheel into the rear wheel socket until hearing a clear “click” sound.

Rear Wheels Disassembly: Press the holder, then remove the rear wheels.

### 4. Assembly & Disassembly for Stroller Seat

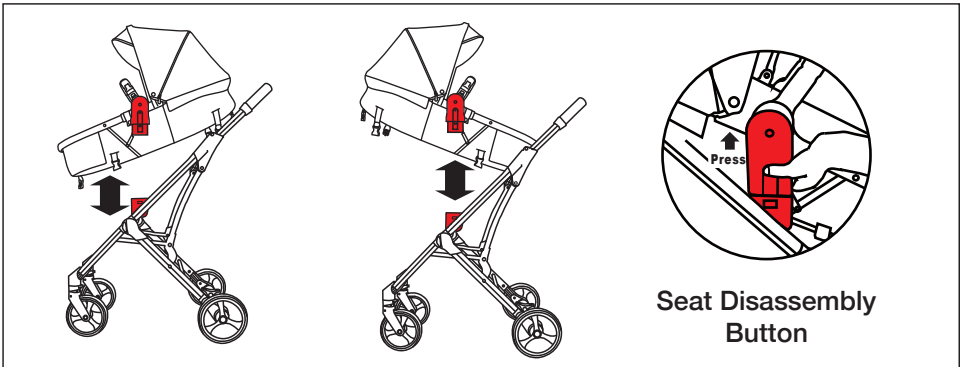

Seat Assembly: Open the seat, and aim both sides’ connecting parts at the frame sockets, then press it downward until hearing a clear “click” sound.

Seat Disassembly: Press disassembly button on both sides of seat and lift up.

## 5. Usage for the Sitting Mode of Stroller Seat

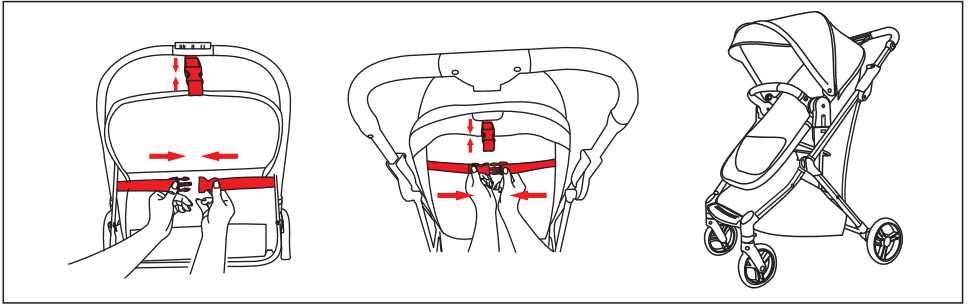

Buckle up the footrest button and backrest button separately, then the stroller can adjust to sitting mode. This mode is not suited to baby below 5 months old.

## 6. Usage for the Playing Mode of Stroller Seat

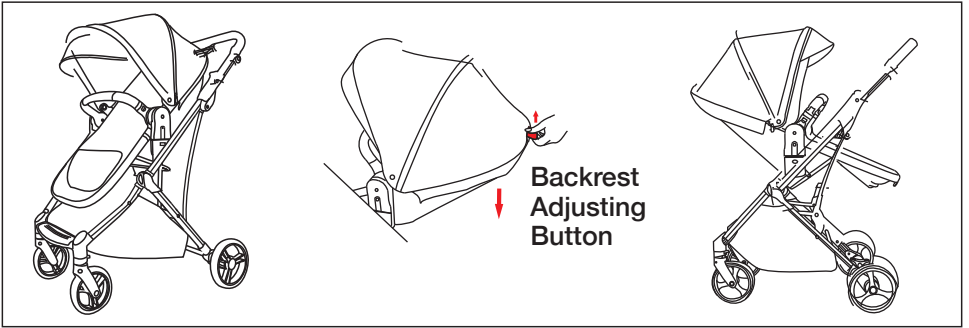

When the stroller is in sitting mode, pull up the backrest adjusting button and press the seat down until hearing a clear “click” sound, then the stroller is in playing mode.

## 7. Usage for the Sleeping Mode of Stroller Seat

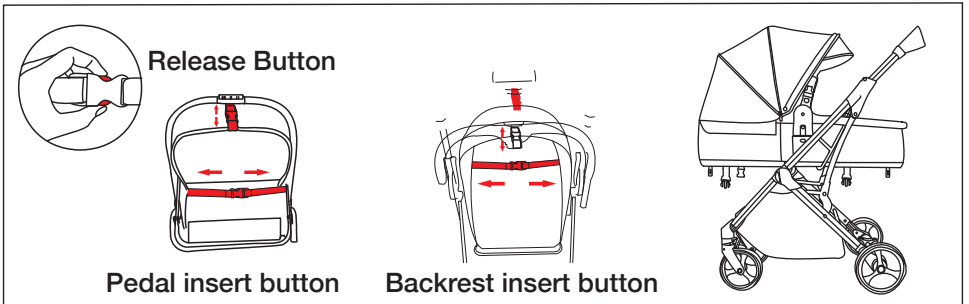

Release the insert button for pedal and backrest separately, then the stroller can adjust to sleeping mode. This mode is suited to baby from 0-5 months old. Changing pad (included) and Hatch™ Bassinet mattress and waterproof fitted sheet (purchased separately) are to be used for sleeping mode.

## 8. Usage for the Front Wheels

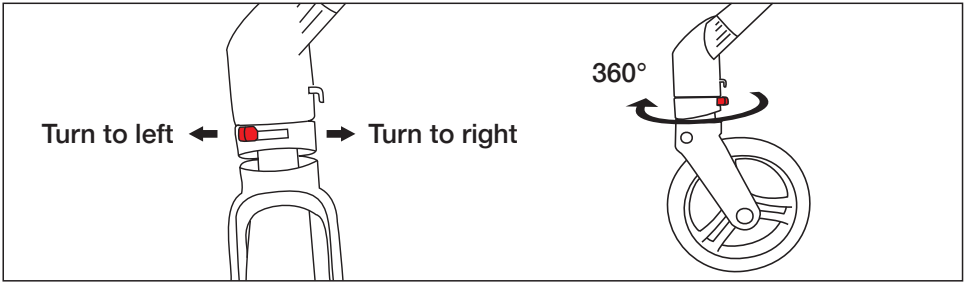

Putting the front wheel orientation button left or right can lock or release the orientation function.

## 9. Usage for the Rear Wheels Brake

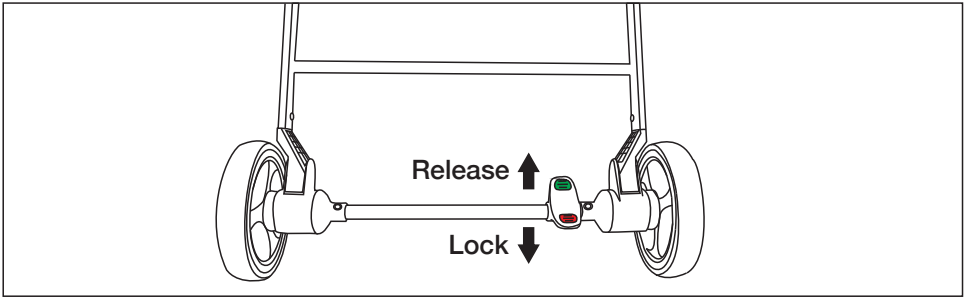

Before stopping the stroller or letting baby in or out of the stroller, the brake must be locked. The red button downward means the brake is locked and the green button downward means the brake is released.

## 10. Assembly & Disassembly for the Front Armrest

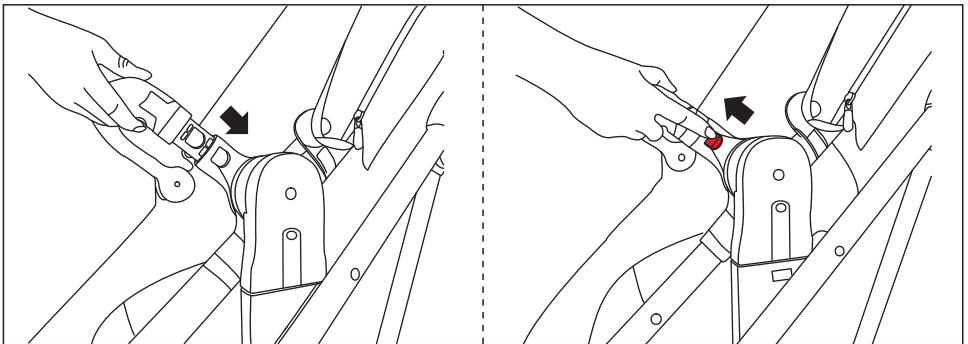

Assembly for the Front Handle: Aim both sides' connecting parts at the front handle socket, then push downward until hearing a clear "click" sound.

Disassembly for the Front Handle: Hold both sides of the releasing button, then lift up on the front handle.

## 11. Usage for the Canopy

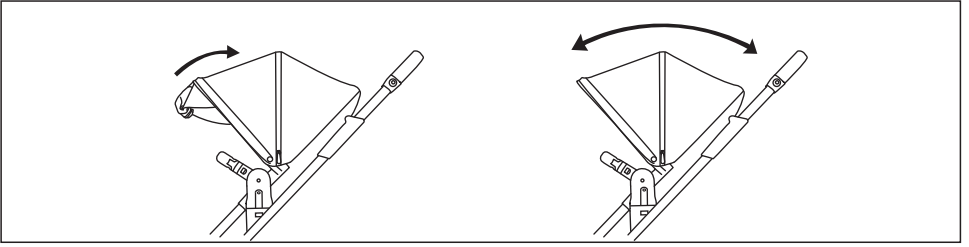

Hold the canopy bracket forward or backward with your hand to open or close the canopy.

## 12. Usage for the Full Canopy

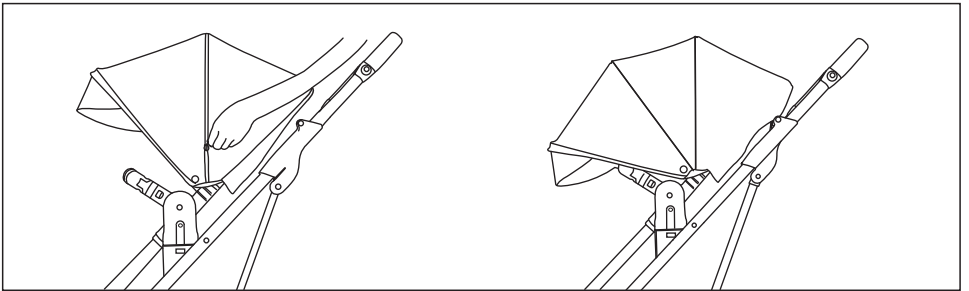

Unzip the zipper to make a full canopy. Zip the zipper to make a normal canopy.

## 13. Usage for the Safety Belt

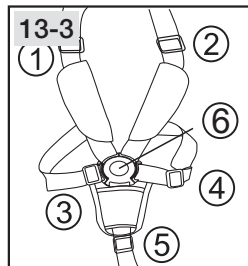
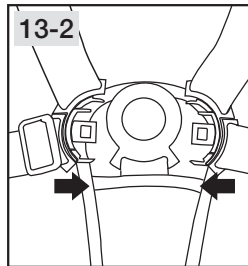
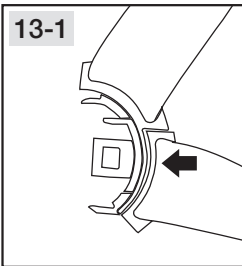

① ②  
Shoulder adjuster

③ ④  
Waist adjuster

⑤  
Crotch adjuster

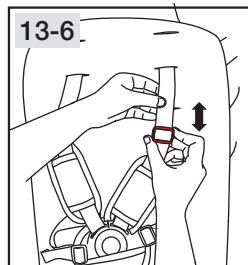
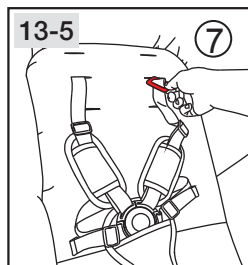
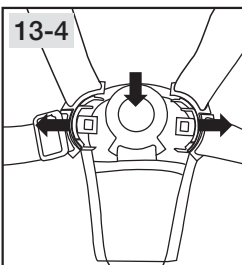

⑥  
Releasing button

⑦  
Seat belt buckle



# ⚠️ WARNING!

Safety belts should be buckled when baby is in stroller!

Avoid serious injury from falling or sliding out!

Always use seat belt!

This stroller is equipped with a 5-point safety belt. Insert the plug-in parts of both the left side and the right side into the center buckle separately, until hearing a clear “click” sound. To release, press the releasing buckle. Plug the safety belt buckle into a suitable buttonhole, then adjust the shoulder, waist, and crotch adjuster according to the size of the baby.

## 14. Fold the Stroller

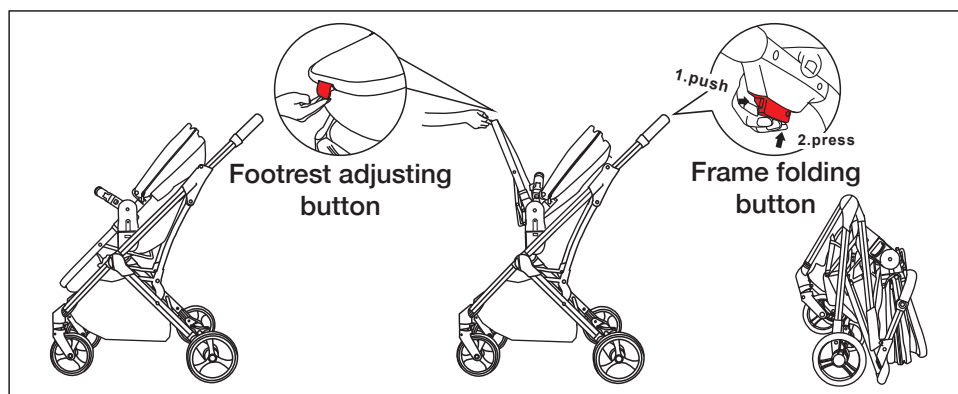

Stroller will only fold in highest sitting mode facing out. Close canopy first by tucking in the leatherette trim, lift the footrest adjusting button on bottom to release the lock, then fold the bassinet and unhook the snaps by both folding buttons. Press the frame folding button, and press downward until hearing a clear “click” sound, then the stroller is folded. Make sure folding clamp is secured. Use travel straps to carry.

## Thank you for Purchasing this Stroller!

- This product is designed strictly in accordance with GB14748-2006, EN1888-2:2018, ASTM F833-19.
- The company reserves the right for further product improvement.  
Please take the received object as standard.
- The pictures in this manual are for referene only. There may be some differences with the real product.

## Daily Maintenance

- Regularly check your bassinet for loose screws, aging parts and breakage of sewing threads. Please repair or replace the parts in time if needed.
- Do not place heavy objects on the top of the stroller.
- Prohibit using other non-original parts or accessories.
- Hatch™ Bassinet and waterproof fitted sheet purchased separately.

## Soft Goods Cleaning

- For soft goods' dust and general stains, use household soap or neutral detergent to brush stains with a cleaning device. Do not use bleach.
- Avoid using a damp cloth for scrubbing.  
In order to avoid damage to the surface of the soft goods, do not scrub the soft goods cover too hard.
- Put the washed soft goods in a dry and ventilated place. Do not overexpose to the sun's rays.
- Changing Pad can be washed and hung to dry.
- Hatch™ Bassinet and waterproof fitted sheet (sold separately) is machine washable.

## Stroller Frame Cleaning

- Use a damp cloth and mild detergent to scrub the frame.
- Do not use corrosive detergents.

If you have any questions, please email [info@rompandroost.com](mailto:info@rompandroost.com) or call us at 1-844-631-4578 and we will be happy to help. In addition, there is a video of assembly/disassembly on our website [www.rompandroost.com](http://www.rompandroost.com).

