



# UTV & ATV Armor Kit Installation Tips

Thank for your purchase of this Ricochet Off-Road Armor Kit. All of our kits are custom designed to fit each model and should install hassle free with no additional modifications required. Please carefully read through all included instruction sheets before beginning your install.

The tips described on this sheet are general mounting tips that may or may not apply to your particular model, refer to the attached model specific instructions for a step by step mounting procedure.

If you do encounter a problem during installation please check the FAQ on our website or feel free to contact us by phone or email using the contact info at the bottom of this page.

## **Required Tools:**

(refer to your hardware placement guide for bolt sizes)

## **Button Head TORX Bolts:** (socket bit is highly recommended)

8mm bolts use a T-40 TORX bit

6mm bolts use a T-30 Torx bit

## **Hex Bolts & Nuts:**

10mm bolts uses 17mm

8mm bolts uses 13mm

6mm bolts uses 10mm

1/4"-20 bolts uses 7/16"

## **Drill Bits:**

While we try to avoid drilling whenever possible some models require one or two mounting points to be match drilled. When instructions call for a drilled mounting point use an **11/32"** bit to match drill through the mounting point on the skid plate only after the plate has been fully secured to your machine using the other hardware listed on your hardware guide.

## **Locking Nuts:**

Most sets will include two types of locking nuts. Loose nuts are Nylock, and any nuts welded onto other hardware are pinch-style Stover lock nuts. It is highly recommended that you use a bit of Anti-seize or a drop of oil on the threads of the welded-on pinch style nuts, this will make the bolts go on and come off much easier.

## **Other helpful tips:**

- Before you begin the installation organize all the included hardware according to the hardware placement sheet so you can quickly find the correct bolts and brackets when you need them.
- Install all bolts finger-tight at first until all hardware has been installed, this will give you maximum adjustability.
- When using the cupped washers to secure the plates to factory mounting points do not over torque the bolts because the threads can strip easily. If you do strip one out the simplest way to repair the thread is to use a 1/4"-20 x 5/8" self tapping bolt.
- You may find it easier to remove the rear tires when installing the rear a-arm guards, it's typically very tight and hard to see when the tires are left on.

**Contact us at 1-866-273-1197 or [dh\\_gibbs@comcast.net](mailto:dh_gibbs@comcast.net) with any questions or concerns.**

## Hardware List RZR 900 XP (P/N 7445F)

### Bash Plate Hardware (P/N 745T)

- 1) #700-01A Bar Clamp
- 1) #700-40 Bar Clamp
- 4) 8 x 25mm Button Head Bolts
- 4) Std. 8mm Washers

#700-1A

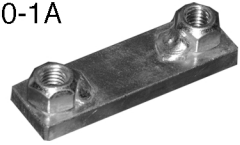

#700-40

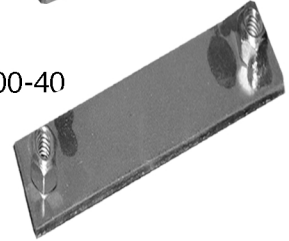

### Main Frame Skid Plate Hardware (P/N 745M & 745R)

- 14) #832 Cupped Washers
- 8) 6 x 16mm Hex Bolts
- 4) 6 x 25mm Hex Bolts
- 2) 6 x 30mm Hex Bolts
- 4) #828 Spacer (1/2")
- 2) #700-47 Spacer (11/16")
- 14) 6mm Lock Washers

#828

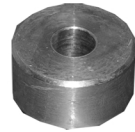

#700-47



### Rock Slider Hardware (P/N 745FBA & 745FBB)

- 6) #700-45 Angle Brackets
- 2) 1 3/4" Clamp
- 2) #700-46 Bar Nut
- 8) 8 x 20mm Button Head Bolts
- 6) 8 x 45mm Hex Bolts
- 2) 5/16" x 2" Button Head Bolts
- 10) HD 8mm Washers (larger ones)
- 6) std. 8mm Washers (smaller ones)

1 3/4" Clamp



#700-45



### Front A-Arm Guard Hardware (P/N 745AFA & 745AFB)

- 8) 1" Clamps
- 8) 8 x 20mm Button Head Bolts
- 8) std. 8mm Washers

#700-46

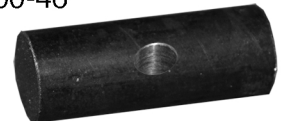

### Rear Linkage Guards Hardware (P/N 745ARA & 745ARB)

- 2) #700-48 Spacers
- 6) 8 x 65mm Hex Bolts
- 6) 8mm Nylock Nuts
- 12) HD 8mm Washers

#700-48



## Mounting Instructions for RZR 900 XP (P/N 7445F)

### 1. What you will need to install your Ricochet Skid Plates:

- Hand Drill with 11/32" bit (or 3/8")
- Vice Grips (or pliers)
- 10mm Socket
- 13mm Wrench (open or box end)
- T-40 Torx Wrench or Socket (included with full sets)
- Medium Strength Lock Tight Compound
- Anti Sieze Compound (or other metal lubricant)

2. Begin by removing the factory plastic skid plate and boot guards. Before you begin installing your new skid plates take a moment to prep your mounting hardware. Take each 6mm hex bolt, apply a small amount of lock tight to the threads and feed it through a 6mm lock washer, a #832 Cupped Washer and a 1/2" spacer for the 6 x 25s and a 11/16" spacer for the 6 x 30s. Do not apply lock tight to any of the 8mm bolts, these are threaded into locking nuts and you will want to use some anti sieze compound or a drop of oil on these bolts.

3. Now you may begin installing the two main frame skid plates (P/Ns 745M & 745R) using all the same mounting points used by the plastic skid plate. Refer to the hardware placement guide for the correct positions of the longer bolts with spacers. Leave these bolts loose enough that the position of the plate can be adjusted until every bolt has been installed. Once every bolt is started you may begin tightening them down while making sure that the two plates remain butted firmly against each other. DO NOT over torque these bolts.

4. Next install the bash plate (P/N 745T). Refer to the Hardware Placement guide for the position of the two bar clamps used. Hold the bash plate in place and note where each bar clamp will need to sit behind the steel plate. By reaching around behind the a-arm, place each bar clamp in it's proper position. Now put your bash plate in place and feed the 8 x 25mm button head bolts with std. 8mm washers into each nut.

5. Before installing the rock sliders you will need to drill out three of the four mounting points below the doors. Remove the front two & rear sheet metal screws, leaving the third one back in place as shown in the figures below. Using an 11/32" drill bit open up the holes in these positions in order to accomidate the 8mm bolts (fig. 1) Now take the 8 x 45 mm hex bolts with the std. 8mm washers and feed them through the drilled out holes from the inside. (fig 2.) Attach a #700-45mm angle bracket in each one of these positions, using your vice grips to keep it from spinning (fig. 3) Tighten these bolts down just enough to still allow the bracket to rotate.



Fig 1.

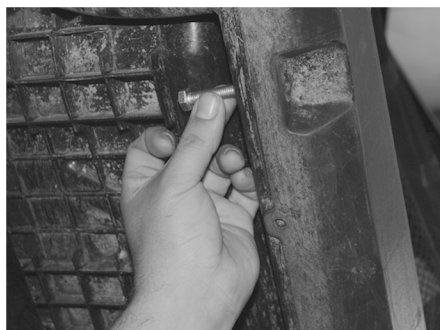

Fig 2.

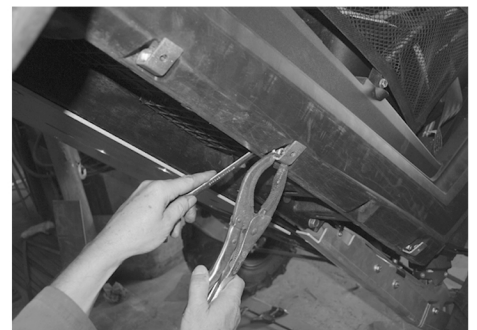

Fig 3.

## Mounting Instructions for RZR 900 XP (P/N 7445F)

6. Next, take the #700-46 Bar Nut and slide it into the circular opening as shown in fig. 4. Note that one side of the threaded hole has a counter bore to help guide the bolt in straight. Make sure this side is facing straight down.



Fig 4.

7. Now you can install your rock sliders, by first using the 8 x 20mm button head bolts with HD 8mm Washers, and attaching the plate to the angled brackets. Leave these loose until all the mounting bolts are in place. Use the 5/16" x 2" button head bolt with HD 8mm Washer to attach to the Bar Nut and finally use the 8 x 20mm button head bolt with HD 8mm washer to attach the 1 3/4" clamp which wraps around the frame and lines up with front mounting point. Now you may tighten all of the bolts down completely. Finally using your 13mm wrench utilize the access holes in the skid plate to tighten the 8 x 45mm Hex Bolts.

8. To install your front A-Arm guards hold the guard in place and attach to the a-arm using the 1" clamps wrapped around the a-arm so that the nut on each clamp lines up with each of the four mounting points on the guard. Install using the 8 x 20mm button head bolts with std. 8mm washers. After the a-arm guards are fully installed rotate the tires to full lock in both directions watching closely for any interferences. If an interference exists loosen the bolts and adjust the guard's position accordingly.

9. Install the rear linkage guards using the 8 x 65mm Hex bolts with the 8mm nylock nuts and HD 8mm Washers. Use #700-48 spacer to fill the gap in the linkage channel on the rear mouning point as shown on your hardware placement guide. This spacer will have to be put in place before installing the other bolts. Once the spacer is in place hold the guard in position and feed an 8 x 65mm Hex Bolts through the spacer. and attach a nylock nut. Leave this nut loose while you install the other bolts. Once all the bolts are installed you may tighten everything down.

10. Congratulations, you have completed the install of your Ricochet Skid Plate kit. Please feel free to call us with any questions or comments you might have.

1-866-273-1197



# Hardware Placement Sheet for RZR 900 XP (P/N 7445F)

