

Please read the instructions carefully before putting your star together

Parts:

- A. Distance Cord Lock
- B. Closing String Lock
- C. S-Hook for hanging
- D. LED Bulb
- E. Cable with USB
- F. USB AC Adapter
- G. On/Off Switch

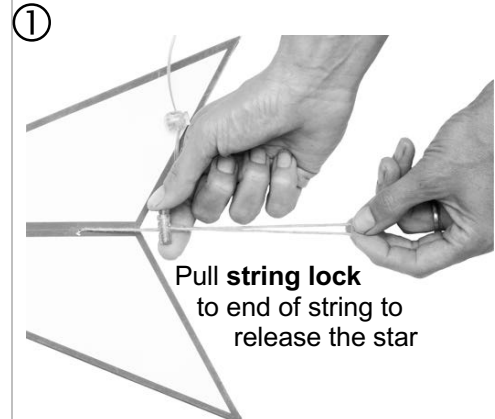
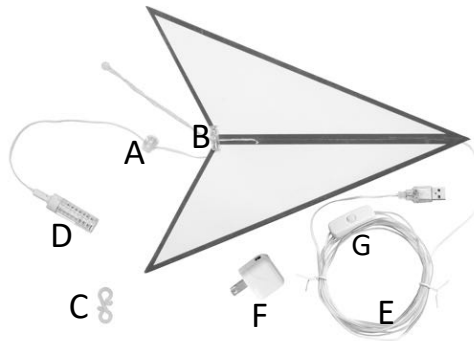

② Ensure **distance lock** on cable is set to the correct distance between lock and base

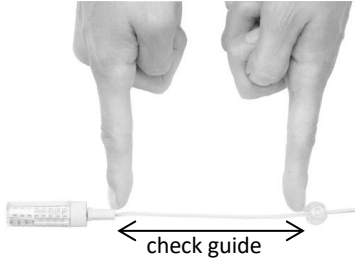

③ Gently check that the wings of the star are not stuck to one another

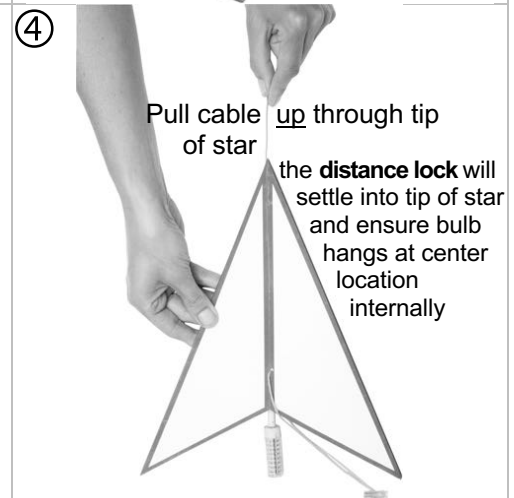

⑤ Open the wings carefully, fan them out one after the other with a flat hand inside

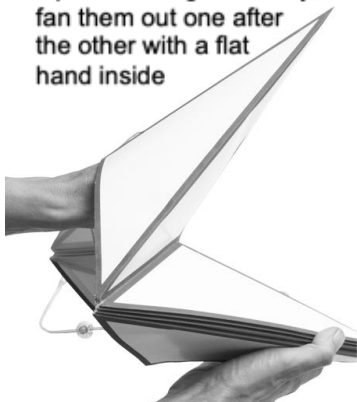

⑥ To **close** the star, pull the string and gently tighten the string lock to the **star seam**

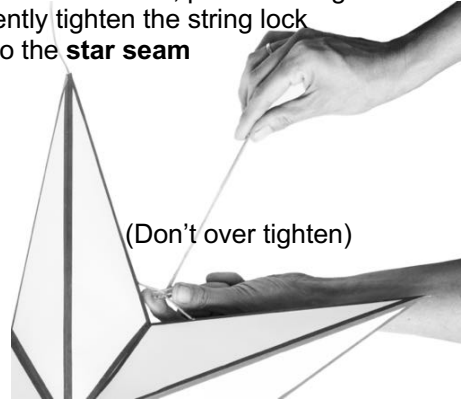

⑦ Hang the star from the provided S-Hook off the cable

To adjust hook position: undo one cable loop, move hook and redo loop

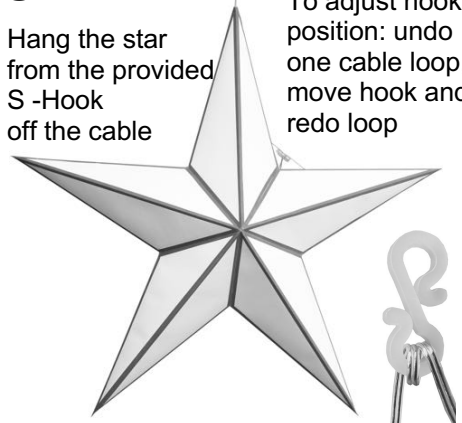

Questions? Replacement parts? Visit our support section on www.artschatz.com for help or contact us.

- ❖ Go slow! The stars are durable if handled with care.
- ❖ All stars are handmade and each may vary slightly.
- ❖ Don't over tighten the string, but ensure a snug closure of the paper wings.
- ❖ Make sure your bulb hangs centered inside at the proper distance.
- ❖ Do not plug USB cable into a computer, please use a 5V AC Adapter or a suitable 5V USB Power Bank.
- ❖ Star for inside use only, keep away from open fire.
- ❖ Keep out of reach of children, starlight is not a toy.

Technical Specifications

USB AC Adapter
 Input: 100-240V - 50-60hz
 Output: DC 5V - 1A

LED Bulb
 DC 5V 0.1A - 0.6A

Cable
 12 ft with USB Plug

Ø 9 inch

Ø 15-17 inch

Ø 18 inch

Ø 23-25 inch

Distance Guide between lock and LED base, adjust length if bulb is not centered