

nulea

M510

WIRELESS VERTICAL MOUSE

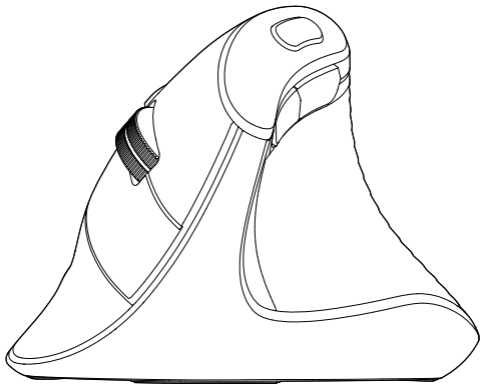

support@nulea.com
www.nulea.com

User Manual

Product Components

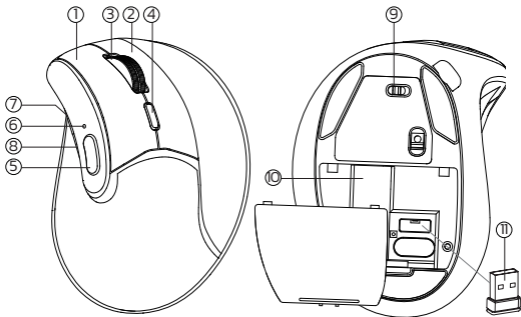

US/UK/CA

- ① Left Button
- ② Right Button
- ③ Scroll Wheel
- ④ DPI Button
- ⑤ Desktop Button
- ⑥ DPI/Low Battery Indicator
- ⑦ Forward Button
- ⑧ Back Button
- ⑨ On/Off
- ⑩ Battery Slot
(1*AA Battery Required, not included)
- ⑪ 2.4GHz USB Receiver

DE

- ① Linksknopf
- ② Rechte Taste
- ③ Scrollrad
- ④ DPI-Taste
- ⑤ Desktop-Taste
- ⑥ DPI/Low -Batterie -Indikator
- ⑦ Taste vorwärts
- ⑧ Rückasten zurück
- ⑨ Ein/Aus
- ⑩ Batterieschlitz
(1*AA -Batterie erforderlich, nicht
enthalten)
- ⑪ Modusschaltertaste

FR

- ① Bouton gauche
- ② Bouton droit
- ③ Molette de défilement
- ④ Bouton DPI
- ⑤ Bouton de bureau
- ⑥ Indicateur de batterie DPI / faible
- ⑦ Bouton avant
- ⑧ bouton de retour
- ⑨ ON / OFF
- ⑩ Slot de batterie
(Batterie 1* AA requise, non incluse)
- ⑪ Modusschaltertaste

IT

- ① Pulsante sinistro
- ② Pulsante destro
- ③ Scorri a scorrimento
- ④ Pulsante DPI
- ⑤ Pulsante desktop
- ⑥ Indicatore della batteria DPI/bassa
- ⑦ Indicatore della batteria DPI/bassa
- ⑧ Pulsante schiena
- ⑨ ON / OFF
- ⑩ Slot batteria
(Batteria 1*AA richiesta, non inclusa)
- ⑪ Ricevitore USB da 2,4 GHz

ES

- ① Botón izquierdo
- ② Botón correcto
- ③ Rueda de desplazamiento
- ④ Botón DPI
- ⑤ Botón de escritorio
- ⑥ DPI/indicador de batería baja
- ⑦ Botón de avance
- ⑧ Botón de retroceso
- ⑨ encendido/apagado
- ⑩ Ranura de la batería
(Se requiere batería de 1*AA, no incluida)
- ⑪ receptor USB de 2.4GHz

US/UK/CA

Specifications

Mouse Size	4.41 x 3.15 x 3.07 inches
Battery	Requires 1 AA battery (not included)
DPI	1000-1600-2400
Wireless Technology	2.4GHz
Sensor Technology	Optical
Transmission Distance	10 meters
Operating Voltage	1.5V
USB interface	Window® 8, Windows® 10 or higher versions Mac OS X 10.10 or higher versions Android 4.3 or higher versions

Package Contents

- 1x Wireless Vertical Mouse
- 1x 2.4GHz USB Receiver
- 1x User Manual

2.4G Connection

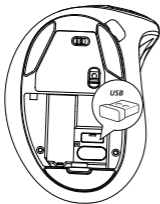

1

2

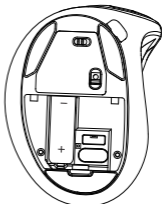

3

4

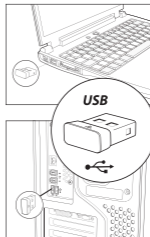
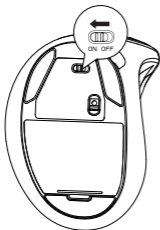

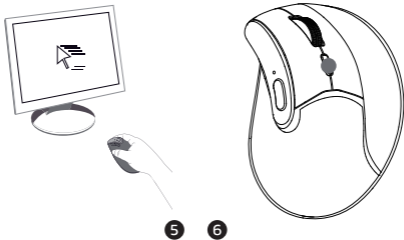

Usage Instructions

- 1 Open the mouse bottom cover and take the USB receiver out.
- 2 Insert one AA battery.
(Note: If the indicator light flashes red during mouse usage, it indicates low battery, and you need to replace the AA battery.)
- 3 Turn on the mouse.
- 4 Insert the receiver into the computer USB port.
- 5 Start using the mouse.
- 6 You can adjust the DPI by pressing the DPI button.
After pressing the DPI button, if the indicator light flashes once, it indicates DPI is set to 1000; if it flashes twice, DPI is set to 1600; if it flashes three times, DPI is set to 2400.

How Do You Wake up the Nulea Vertical Mouse?

The Nulea Vertical Mouse employs an intelligent sleep mode to safeguard the battery for extended use:

Nulea M510 Vertical Mouse goes into hibernation after 10 minutes of your last mouse use; if you need to use the mouse, you must press the button to wake it up (moving the mouse will not wake it up).

Spezifikation

Mausgröße	4.41 x 3.15 x 3.07 Zoll
Batterie	Benötigt 1 AA -Batterie (nicht enthalten)
DPI	1000-1600-2400 DPI
Drahtlose Technologie	2.4 GHz
Sensortechnologie	Optisch
Übertragungsabstand	10 Meter
Betriebsspannung	15 V
USB-Schnittstelle	Windows® 8, Windows® 10 oder höhere Versionen Mac OS X 10.10 oder höhere Versionen Android 4.3 oder höhere Versionen

Packungsinhalt

1x drahtlose vertikale Maus
1x 2.4 GHz USB -Empfänger
1x Benutzerhandbuch

2.4G-Verbindung

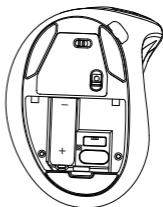
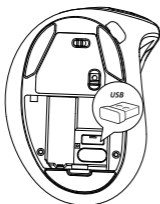

1

2

3

4

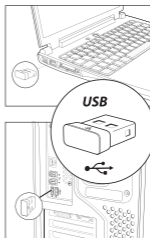
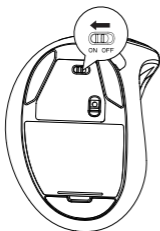

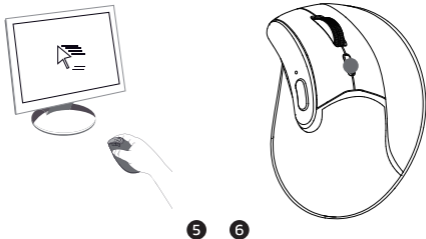

Verwendungsanweisungen

- 1 Öffnen Sie die Unterabdeckung der Maus und nehmen Sie den USB –Empfänger heraus.
- 2 Setzen Sie eine AA –Batterie ein.
(Hinweis: Wenn die Anzeigeleuchte während der Mausverwendung rot blinkt, zeigt er eine niedrige Batterie an, und Sie müssen die AA –Batterie ersetzen.)
- 3 Schalten Sie die Maus ein.
- 4 Fügen Sie den Empfänger in den USB –Anschluss ein.
- 5 Verwenden Sie die Maus.
- 6 Sie können den DPI durch Drücken der DPI –Taste einstellen.
Nach dem Drücken der DPI –Taste wird der DPI auf 1000 eingestellt. Wenn es zweimal blinkt, ist DPI auf 1600 eingestellt. Wenn es dreimal blinkt, ist DPI auf 2400 gesetzt.

Wie weckst du die nulea vertikale Maus auf?

Die vertikale Nulea –Maus verwendet einen intelligenten Schlafmodus, um die Batterie für den erweiterten Gebrauch zu schützen:

Nulea M510 Vertikale Maus geht nach 10 Minuten Ihrer letzten Mausegebrauch in den Winterschlaf. Wenn Sie die Maus verwenden müssen, müssen Sie die Taste drücken, um sie aufzuwecken (das Bewegen der Maus weckt sie nicht auf).

Spécification

Taille de la souris	4.41 x 3.15 x 3.07 pouces
Batterie	nécessite 1 batterie AA (non incluse)
DPI	1000–1600–2400 DPI
Technologie sans fil	2.4 GHz
Technologie du capteur	optique
Distance de transmission	10 mètres
Tension de fonctionnement	1.5 V
interface USB	Windows® 8, Windows® 10 ou versions supérieures Mac OS X 10.10 ou versions supérieures Android 4.3 ou versions supérieures

Contenu du colis

1x souris verticale sans fil
Récepteur USB 1X 2.4 GHz
Manuel d'utilisation 1X

Connexion 2.4G

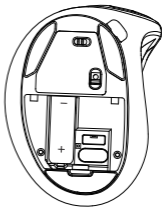
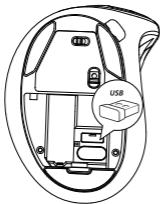

1

2

3

4

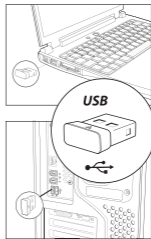
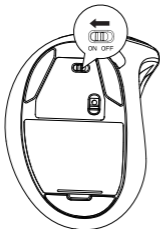



Instructions d'utilisation

- 1 Ouvrez le couvercle inférieur de la souris et retirez le récepteur USB.
- 2 Insérez une batterie AA.
(Remarque: si le voyant clignote rouge pendant l'utilisation de la souris, il indique une batterie faible et vous devez remplacer la batterie AA.)
- 3 Allumez la souris.
- 4 Insérez le récepteur dans le port USB de l'ordinateur.
- 5 Commencez à utiliser la souris.
- 6 Vous pouvez ajuster le DPI en appuyant sur le bouton DPI.
Après avoir appuyé sur le bouton DPI, si le voyant indicateur clignote une fois, il indique que DPI est réglé sur 1000; S'il clignote deux fois, DPI est réglé à 1600; S'il clignote trois fois, DPI est réglé sur 2400.

Comment réveillez-vous la souris verticale Nulea?

La souris verticale Nulea utilise un mode de sommeil intelligent pour protéger la batterie pour une utilisation prolongée:

La souris verticale Nulea M510 va en hibernation après 10 minutes de votre dernière utilisation de souris; Si vous avez besoin d'utiliser la souris, vous devez appuyer sur le bouton pour le réveiller (le déplacement de la souris ne le réveillera pas).

Specifica

Dimensione del mouse	4.41 x 3.15 x 3.07 pollici
Batteria	richiede 1 batteria AA (non inclusa)
DPI	1000-1600-2400 DPI
Tecnologia wireless	2.4 GHz
Tecnologia dei sensori	ottica
Distanza di trasmissione	10 metri
Tensione operativa	15V
Interfaccia USB	Windows® 8, Windows® 10 o versioni successive Mac OS X 10.10 o versioni successive Android 4.3 o versioni successive

Contenuto del pacco

1x mouse verticale wireless
Ricevitore USB 1x da 2.4 GHz
1x Manuale dell'utente

Connessione 2.4G

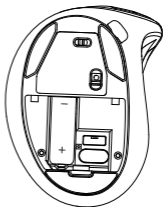
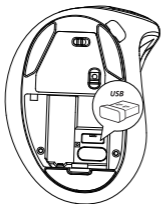

1

2

3

4

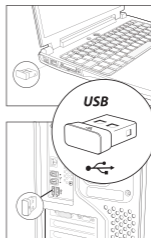
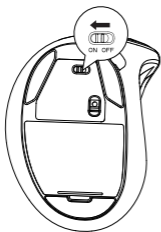



Istruzioni di utilizzo

- 1 Apri il coperchio inferiore del mouse e togli il ricevitore USB.
- 2 Inserire una batteria AA.
(Nota: se la luce indicatore lampeggia in rosso durante l'utilizzo del mouse, indica una batteria bassa e è necessario sostituire la batteria AA.)
- 3 Accendere il mouse.
- 4 Inserire il ricevitore nella porta USB del computer.
- 5 Inizia a usare il mouse.
- 6 È possibile regolare il DPI premendo il pulsante DPI.
Dopo aver premuto il pulsante DPI, se la luce dell'indicatore lampeggia una volta, indica che DPI è impostato su 1000; Se lampeggia due volte, DPI è impostato su 1600; Se lampeggia tre volte, DPI è impostato su 2400.

Come ti svegli il mouse verticale Nulea?

Il mouse verticale Nulea impiega una modalità di sonno intelligente per salvaguardare la batteria per uso esteso:

Il mouse verticale Nulea M510 va in letargo dopo 10 minuti dall'ultimo uso del mouse; Se è necessario utilizzare il mouse, è necessario premere il pulsante per svegliarlo (lo spostamento del mouse non lo sveglierà).

Especificación

Tamaño del mouse	4.41 x 3.15 x 3.07 pulgadas
Batería	requiere 1 batería AA (no incluida)
DPI	1000-1600-2400 DPI
Tecnología inalámbrica	2.4GHz
Tecnología del sensor	óptica
Distancia de transmisión	10 metros
Voltaje de funcionamiento	1.5V
interfaz USB	Window® 8, Windows® 10 o versiones superiores Mac OS X 10.10 o versiones superiores Android 4.3 o versiones superiores

contenidos del paquete

1x mouse vertical inalámbrico
Receptor USB de 1x 2.4GHz
1x Manual de usuario

Conexión 2.4G

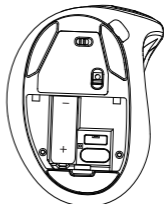
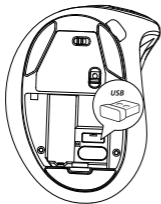

1 2

3 4

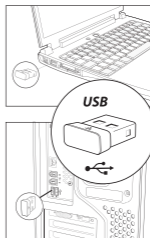
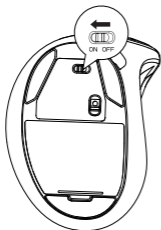



Instrucciones de uso

- 1 Abra la cubierta inferior del mouse y saque el receptor USB.
- 2 Inserte una batería AA.
(Nota: si la luz del indicador interviene rojo durante el uso del mouse, indica una batería baja y debe reemplazar la batería AA).
- 3 Encienda el mouse.
- 4 Inserte el receptor en el puerto USB de la computadora.
- 5 Inizia a usare il mouse.
- 6 Puede ajustar el DPI presionando el botón DPI.
Después de presionar el botón DPI, si la luz del indicador parpadea una vez, indica que DPI está configurado en 1000; Si parpadea dos veces, DPI se establece en 1600; Si parpadea tres veces, DPI se establece en 2400.

¿Cómo se despierta el mouse vertical de Nulea?

El mouse vertical de Nulea emplea un modo de suspensión inteligente para salvaguardar la batería para su uso extendido:
El mouse vertical Nulea M510 entra en hibernación después de 10 minutos de su último uso del mouse; Si necesita usar el mouse, debe presionar el botón para despertarlo (mover el mouse no lo despertará).

FCC Statement

Any Changes or modifications not expressly approved by the party responsible for compliance could void the user's authority to operate the equipment.

This device complies with part 15 of the FCC Rules. Operation is subject to the following two conditions: (1) This device may not cause harmful interference, and (2) this device must accept any interference received, including interference that may cause undesired operation.

FCC Radiation Exposure Statement

This equipment complies with FCC radiation exposure limits set forth for an uncontrolled environment.

Correct Disposal of This Product



(Waste Electrical & Electronic Equipment)

This Marking shown on the product or its literature, indicate that it should not be disposed with other household wastes at the end of its working life.

To prevent possible harm to the environment or human health from uncontrolled waste disposal, please separate this from other types of wastes and recycle it responsibly to promote the sustainable reuse of material resources. Household user should contact either the retailer where they purchased this product or their local government office, for details of where and how they can take this item for environmentally safe recycling.

Business users should contact their supplier and check the terms and conditions of the purchase contract. This product should not be mixed with other commercial wastes for disposal.

nulea

WORK WITH YOUR FAVORITE



Visit www.nulea.com for our 24/7 live chat or send an email to support@nulea.com for support.



UK	REP
----	-----

CET PRODUCT SERVICE LTD.
Beacon House Stokenchurch Business Park,
Ibstone Rd, Stokenchurch
High Wycombe HP14 3FE UK
Email: info.cetservice@gmail.com
Phone: +447419325266

EC	REP
----	-----

UAB Qixiang Europe
Pranciškonų g. 6-46, LT-01133 Vilnius, Lithuania
Technical Information Center
Trakehner Str. 7-9, 60487 Frankfurt am Main, Germany
Email: qixiang.europe@gmail.com
Phone: +496976895074