

INSTRUCTIONS

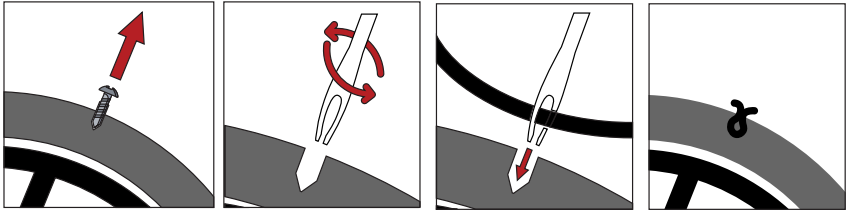

- 1** Locate source of puncture.
- 2** Remove debris or puncture source.
- 3** Select size and type of tyre plug dependent on tyre type -either black tyre plug for MTB tyres or bacon tyre plug for road tyres.
- 4** Insert tyre insertion tool into hole, turn in hole and remove.
- 5** Place tyre plug into eyelet of tyre insertion tool. The eyelet should be in the middle of the tyre plug.
- 6** Push tyre plug into hole, ensuring the ends of the tyre plug remain on the outside of the tyre.
- 7** With the tool and plug still in the tyre, turn the tool clockwise a few times to twist the tyre plug inside the tyre.
- 8** Remove the tool and ensure the tyre plug remains in the tyre.
- 9** Re-inflate the tyre to your desired pressure using a bike pump or CO2 inflator.

REGISTER YOUR WARRANTY

Your purchase comes with a lifetime warranty against manufacturer defects. To register and activate your warranty please visit:

probiketool.com/warranty

Not totally satisfied or need help?

We are committed to customer satisfaction, so if you are not happy with your purchase, please contact us at support@probiketool.com so that we can make it right. We pride ourselves in responding within 24 hours.

VIP Club

Join our VIP Club to receive coupon deals and information on our new products: probiketool.com/vip

FOLLOW US!

To keep up to date with all the latest products, news and awesome deals from PRO BIKE TOOL, sign up for our newsletter at probiketool.com, or follow us at:



[@probiketool](https://www.facebook.com/probiketool)



[@probiketool](https://www.instagram.com/probiketool)