

# PRO BIKE TOOL

## Indoor Bike Rack - 6 Bikes

### Tools Required

Drill  
Drill bit 8mm (0.3 in)  
Hammer

- a. Aluminium Rail x 2
- b. Hook Cap-Upper x 6
- c. Hook Cap-Lower x 6
- d. Hooks x 6
- e. Hook Bolt x 6
- f. Extension Bolt x 4
- g. Side Caps x 4
- h. Slot Washer x 4
- i. Cross Cap x 1 (use for extended rails only)
- j. Drills and Hooks Position Paper x 2
- k. Allen Key x 1
- l. Wood Screw x 8
- m. Socket Wrench x 1
- n. Adaptor x 2

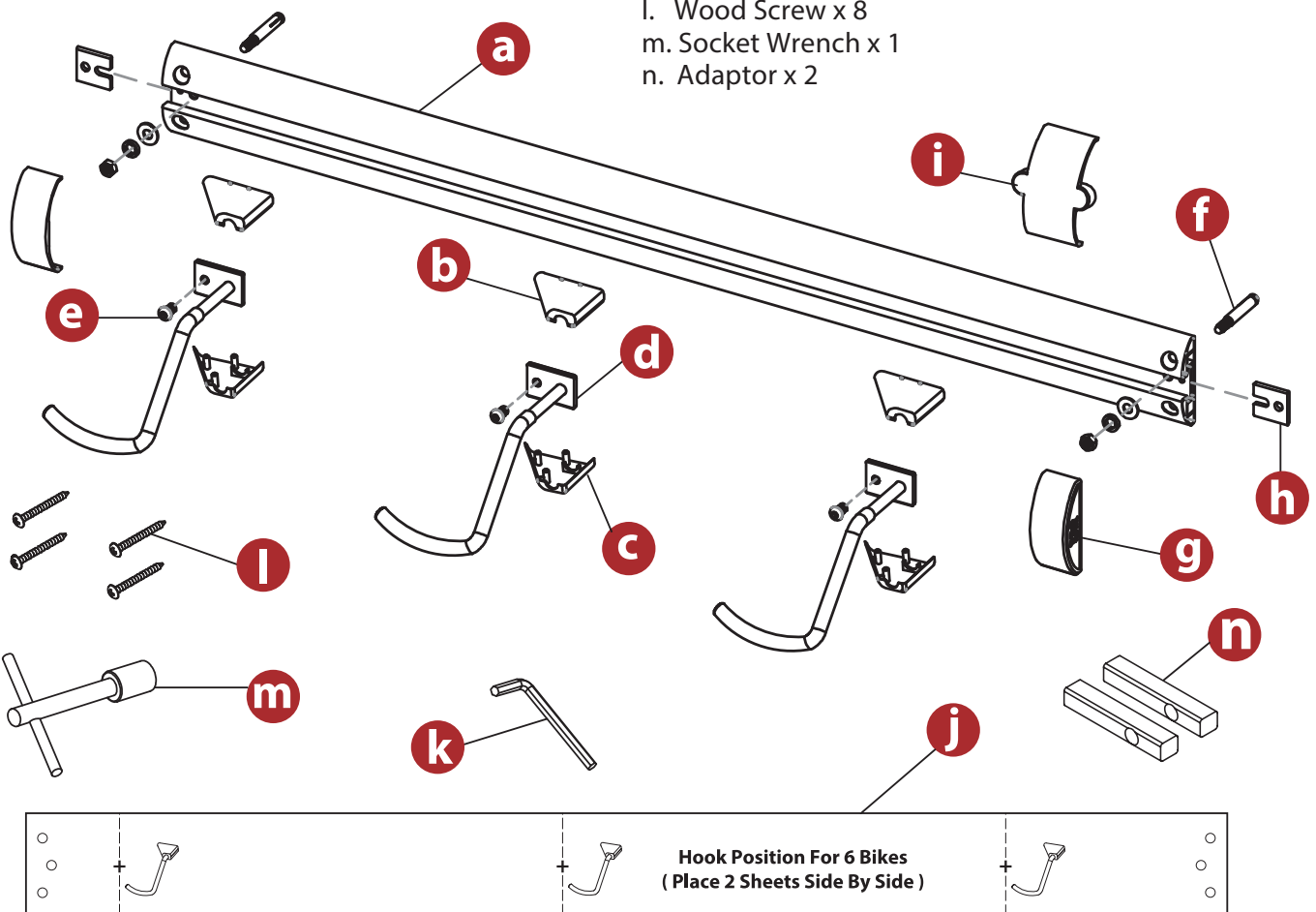

## IMPORTANT - INSTALLATION

Please adhere to the below instructions to ensure warranty is not void.

Use correct bolts or screws, expansion anchors, electric tools and drill tool bits for installation.

DO NOT install the bike wall racks on unsupported wall surfaces e.g. plasterboard wall unless there is a strong wooden stud behind it.

ONLY install the bike wall racks on a solid stud, masonry or concrete wall. The bike wall racks are designed for use

on a wall structure in good condition which is suitably robust to carry the weight of the bikes to be hung on it. It is your responsibility to ensure the racks are installed on a suitable surface. ONLY use correct wall fixings and anchors appropriate for the type of wall. Be careful to avoid any electrical, plumbing or water fittings within or behind the wall.

Sufficient expertise is required for the correct and safe installation of the bike wall racks. **Please seek professional help if required.**

# 1 Install Bike Wall Racks on Wall

Mount Bike Wall Racks on a solid stud, beam, masonry or concrete wall with correct fixings and anchors. Mount in an appropriate place where they are unlikely to cause obstruction. Determine correct height for the Bike Wall Racks, the Aluminium Rails (a) should be at least 180 cm (70.9 inches) from the ground. Please see the below installation instructions for the two different wall types.

A. Plasterboard / Dry Wall (Stud Wall) B. Masonry / Concrete Wall

---

## A. Plasterboard / Dry Wall (Stud Wall)

Attach and make level the Drills and Hooks Position Papers (j) on wall. Mark the drill holes on wall as per diagram.

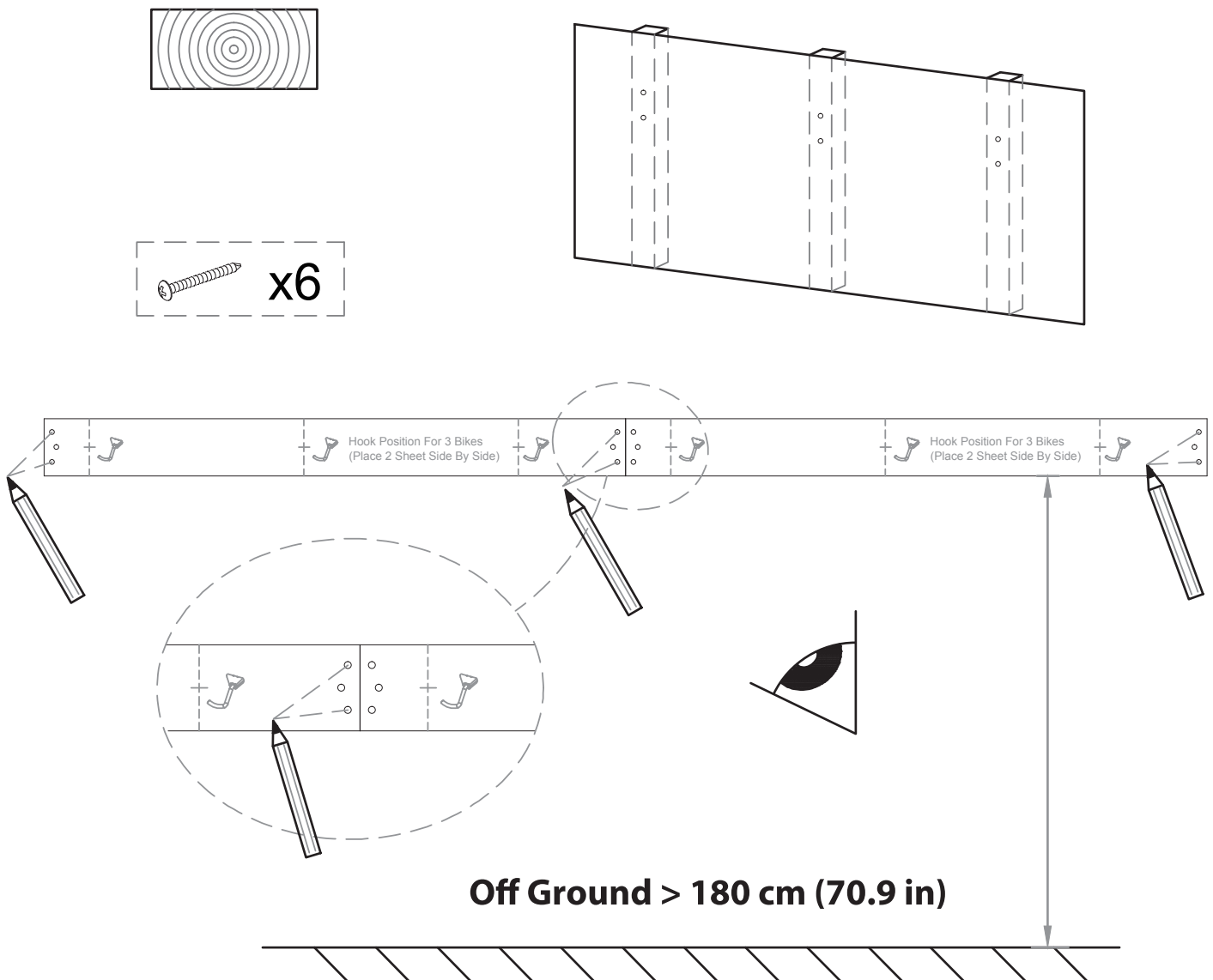

## 2 Assemble Hooks

1. Assemble hooks as per diagram.
2. Slide hooks into Aluminium Rail.
3. Position hooks in rail either using guide positioning as per positioning sheets (j) (please flip one sheet over and place side by side, as per diagram) or according to individual spacing preference.

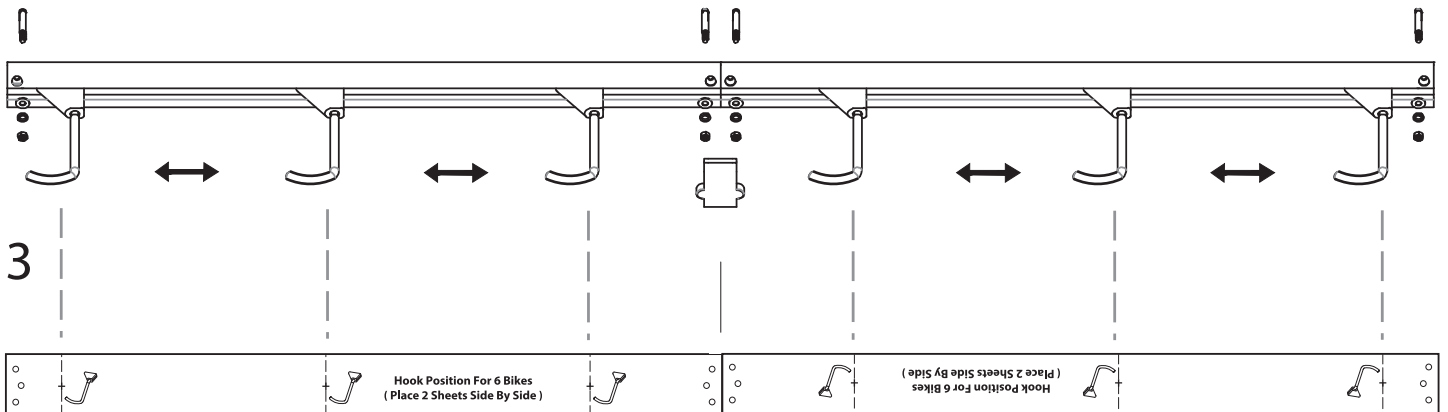
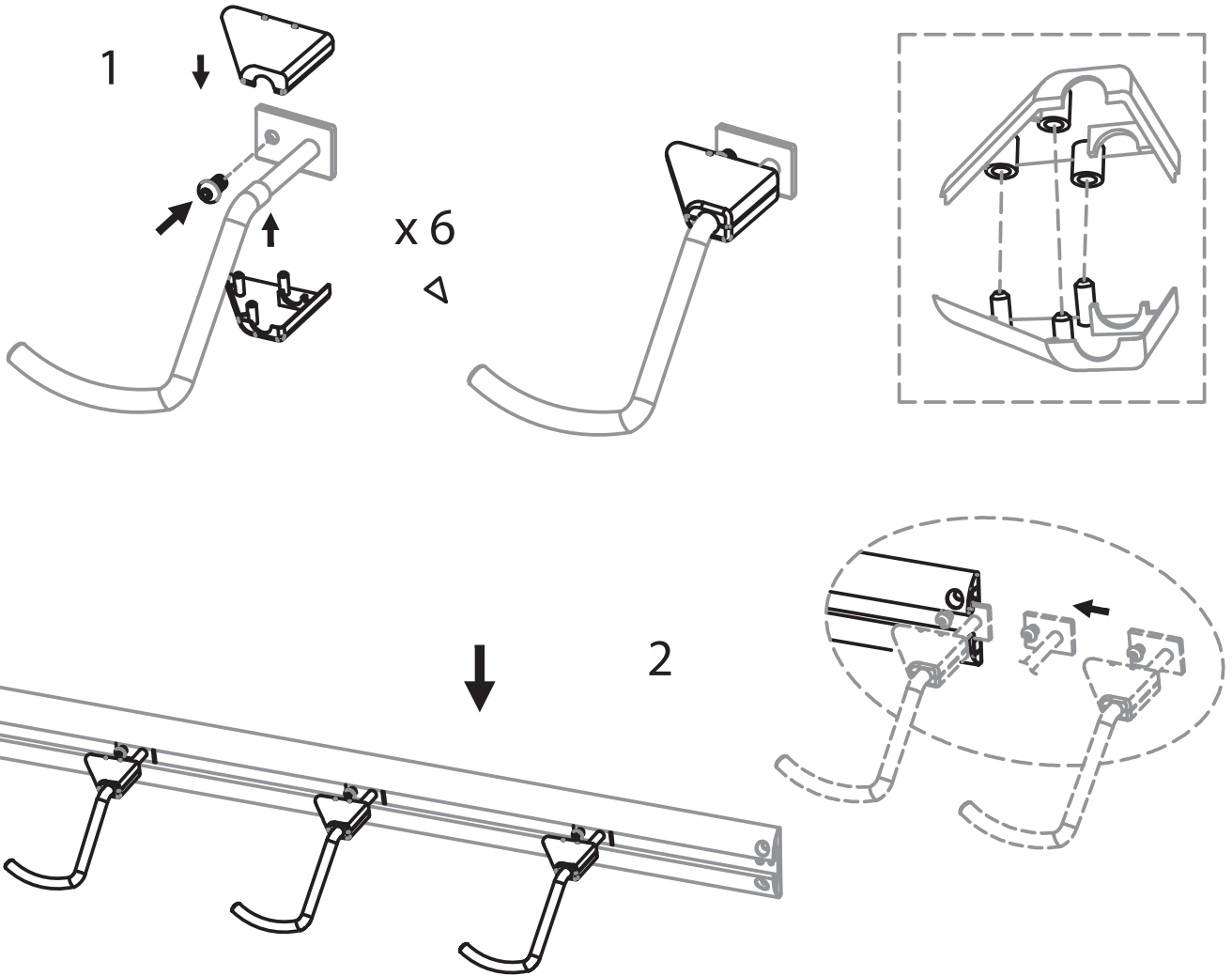

1. Insert the Adaptors (n) into one Aluminium Rail (a) as per diagram.
2. Attach the Aluminium Rail with Adaptors onto the wall. Make sure the holes are on the drill marks, then loosely screw in the 4 (No. I - IV) wood screws (I) as per diagram.
3. To connect to the other Aluminium Rail (a), slide the other Aluminium Rail (a) onto the Adaptors (n), as per diagram.
4. Fasten Aluminium Rails by screwing in all 6 (No. I - IV) screws securely.

1

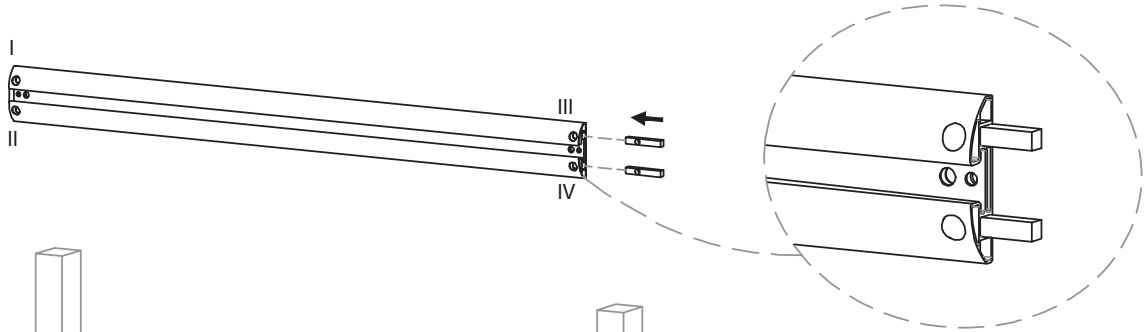

2

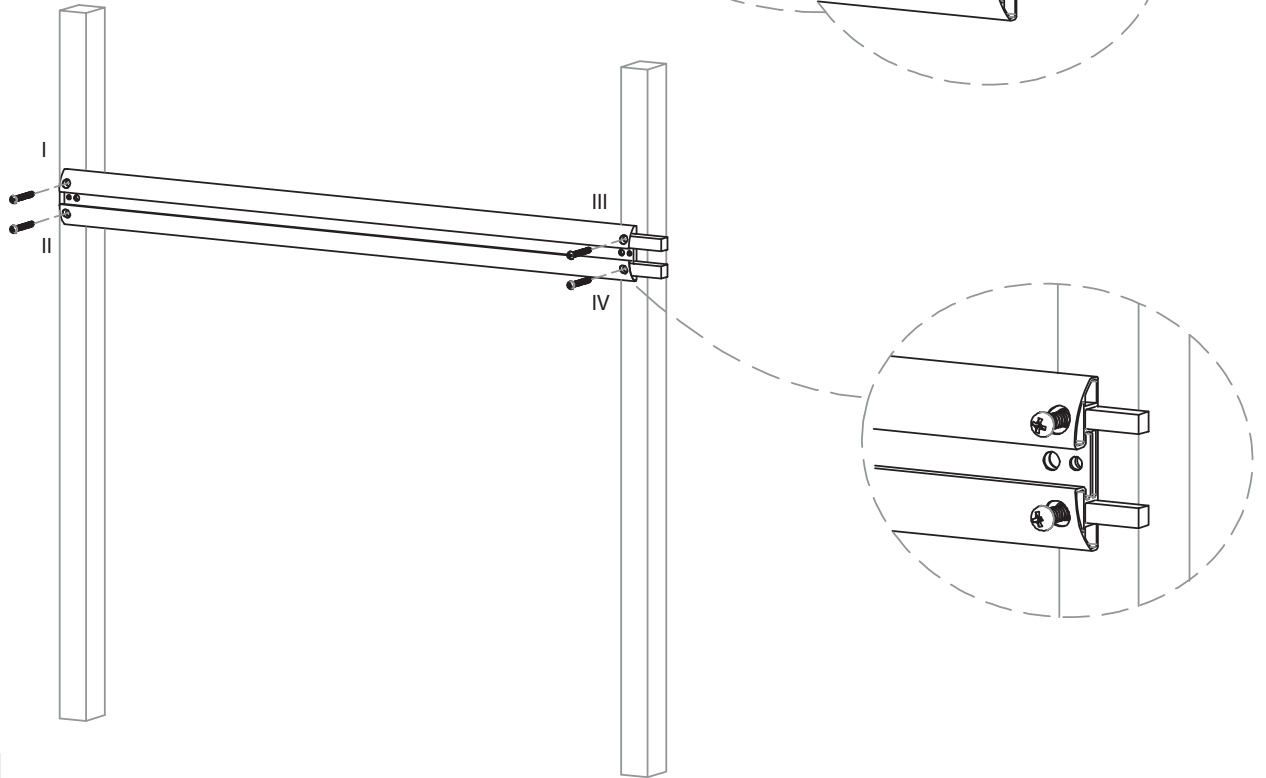

3

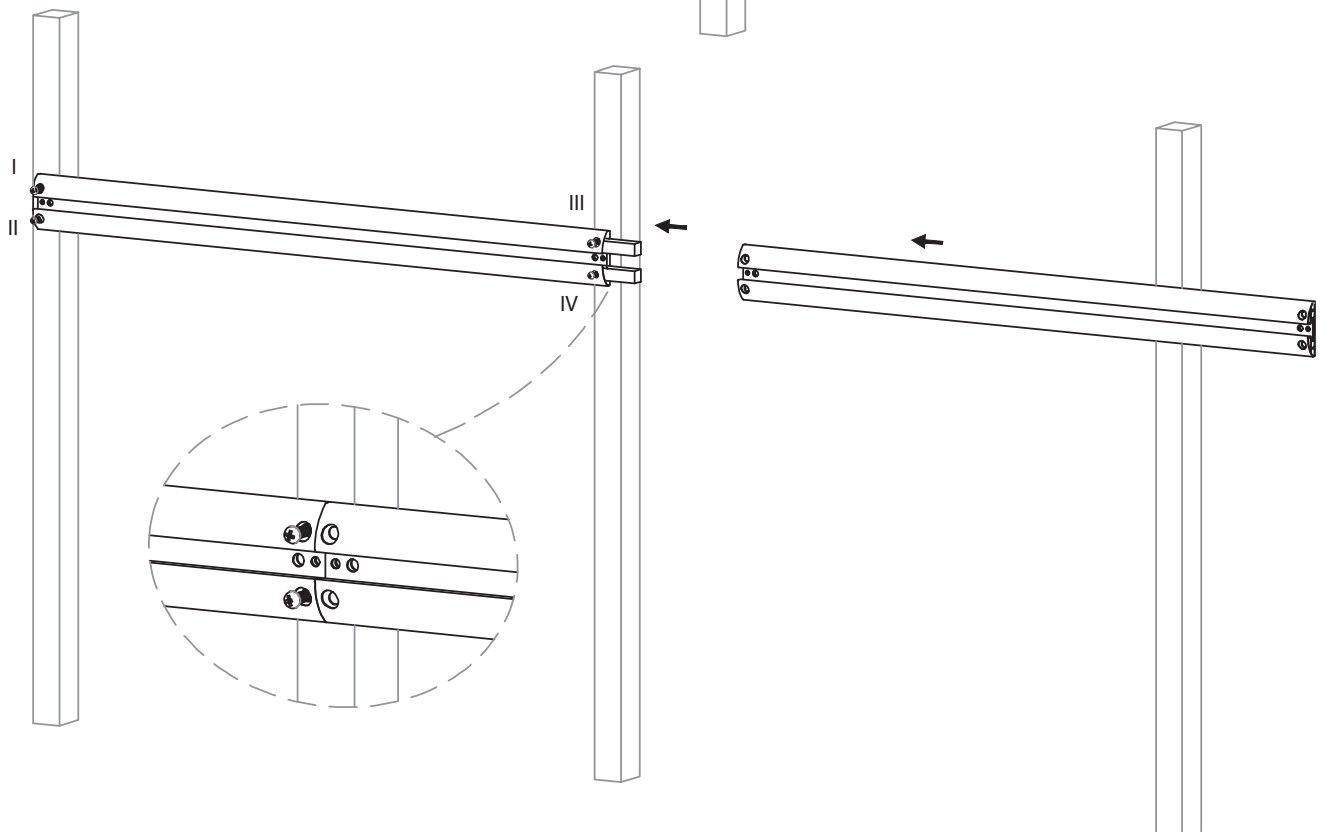

### 3 Complete Assembly

Following positioning of hooks in rail.

1. Flip over hook cover and then use Allen Key (k) to tighten hook bolts.
2. Once secured, flip back hook cover.
3. Push in hook covers into rail.
4. For both ends, insert the side caps (g) into the ends of the Aluminium Rails.
5. Clip the cross cap (i) on to the Aluminium Rails.

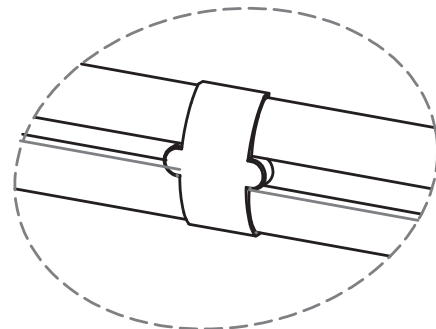
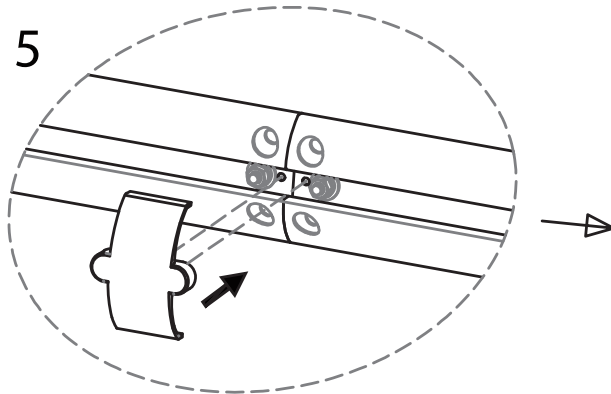
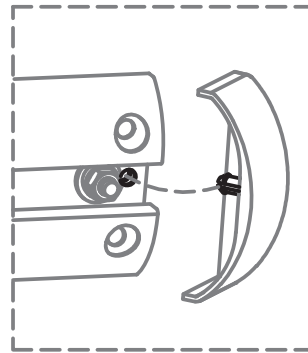
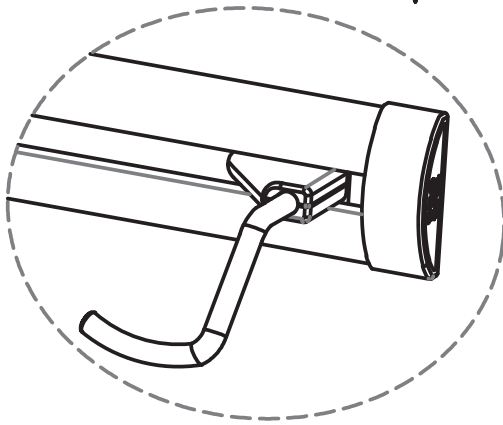
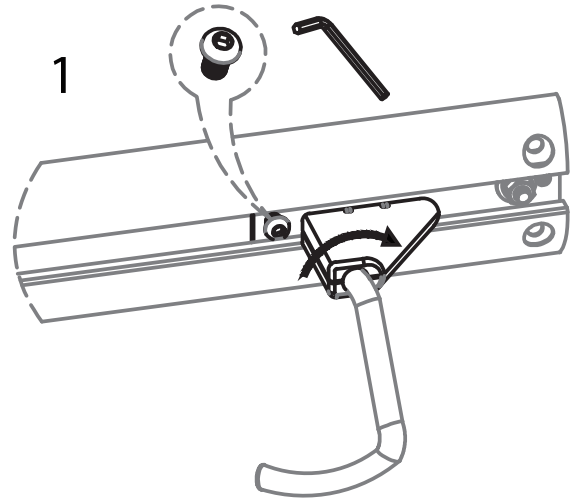
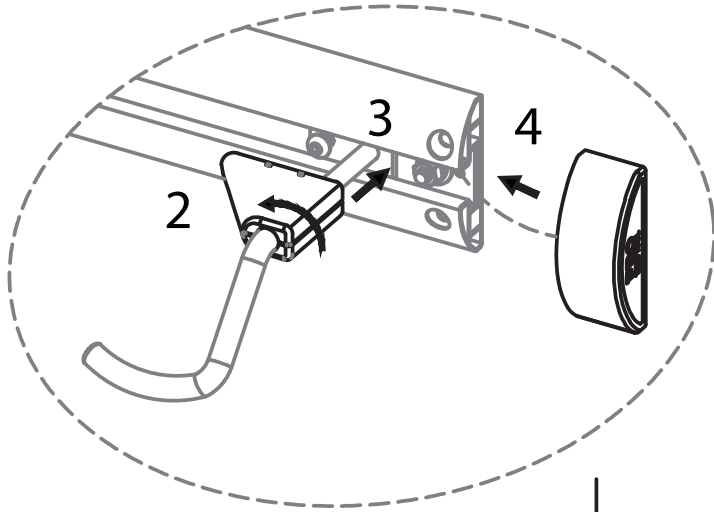

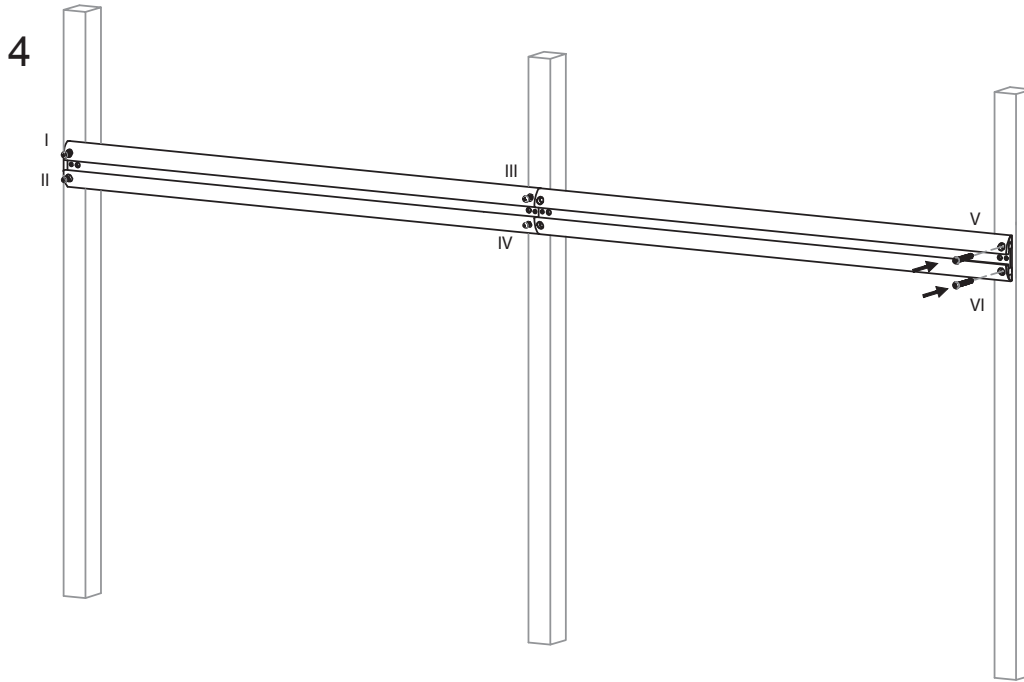

## B. Masonry / Concrete Wall

Attach and make level the Drills and Hooks Position Papers (j) on wall.  
Mark the drill holes on wall at both ends and middle as per diagram.

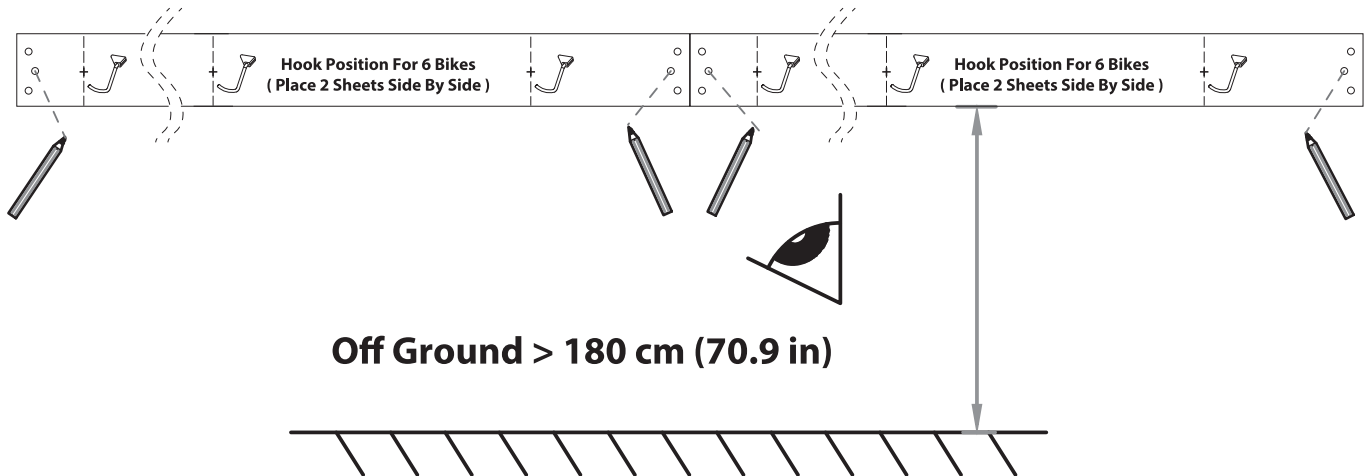

Drill holes into wall using 8 mm (0.3 in) bit. Hole depth: 35 mm (1.4 in) minimum.

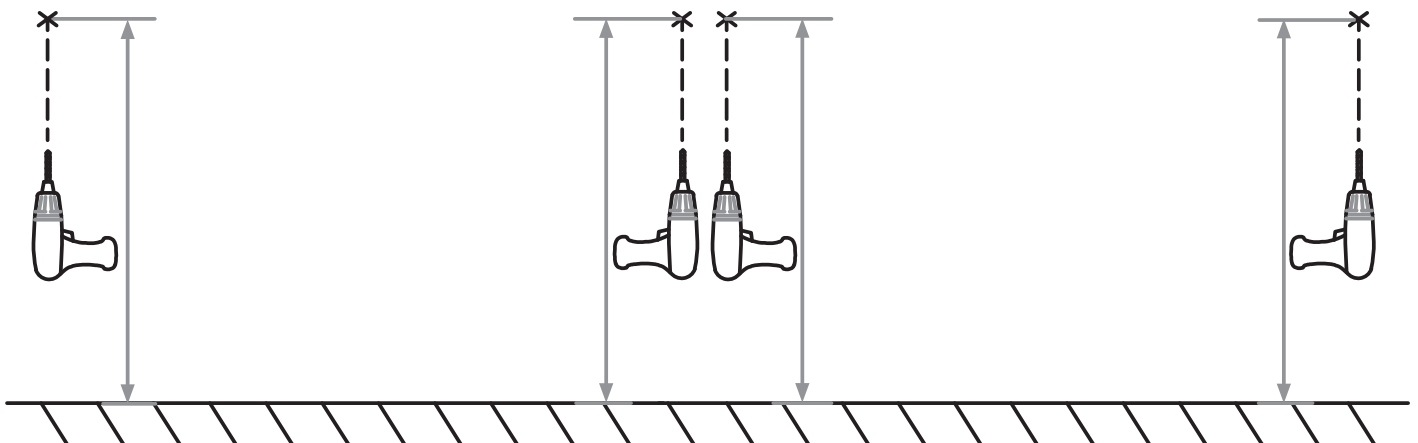

1. Knock extension bolts into holes in wall.
2. Use socket wrench (m) to unscrew nuts (counter clockwise).
3. Remove the hardware (washers and nuts).

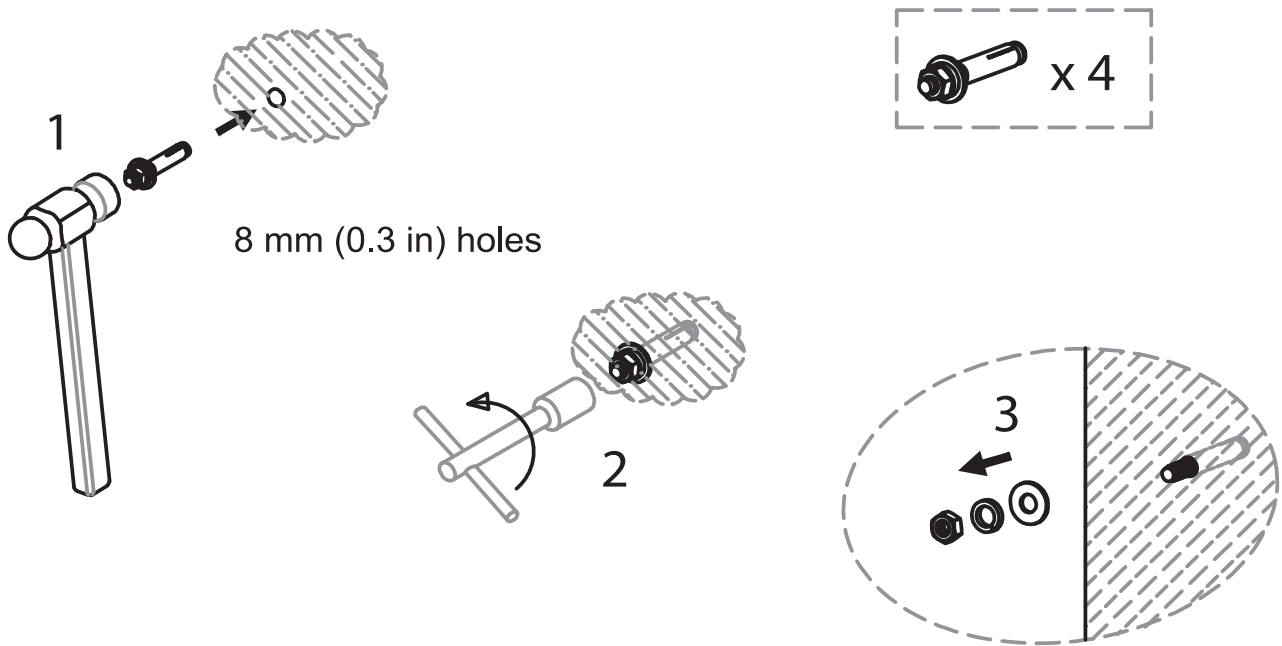

1. Mount Aluminium Rails on the extension bolts.
2. Slide in and position slot washers (h) into ends.
3. Place hardware (washers and nuts) on extension bolts.
4. Tighten rails with washers and nuts using socket wrench (m), clockwise rotation.

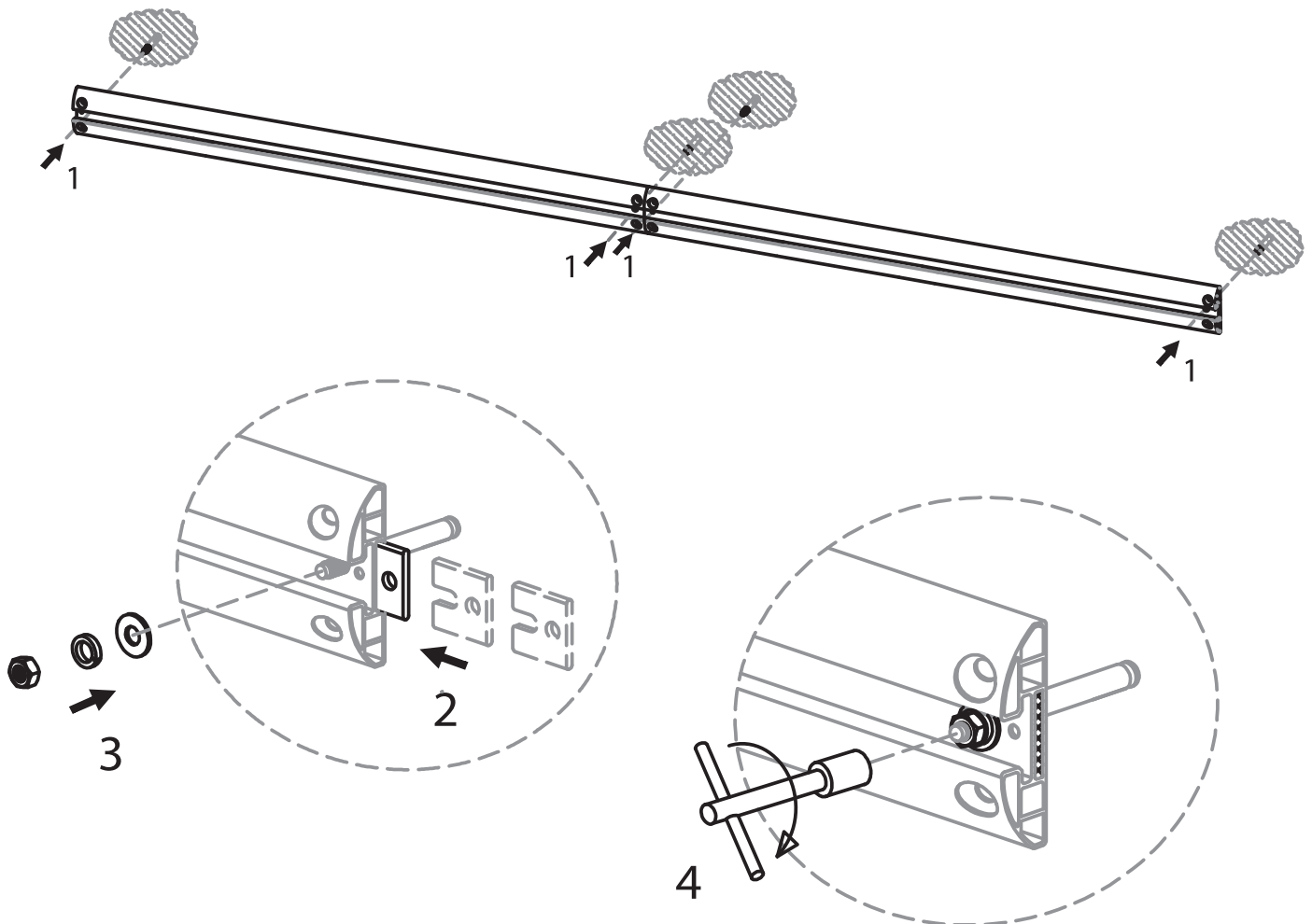

## CAUTION!

It is important that the bike wall racks and accessories are properly and securely attached to the wall according to the instructions and only used for its predetermined purpose. Inspect the bike wall racks are installed correctly before hanging a bike. Failure to check that the bike wall racks have been installed correctly can result in possible bodily harm or bicycle damage. Periodic inspections for wear and tear of the bike wall racks and accessories are required. If any of the above requirements are not complied with when installing the bike wall racks, PRO BIKE TOOL shall not be liable or otherwise responsible for any damage to goods or injuries sustained because of incorrect or inappropriate installation of the bike wall racks.

## WARNING!

The maximum weight that can be carried by the bike wall racks are specified in this instruction manual. DO NOT EXCEED the maximum allowable weight per bike to be carried by the bike wall racks. Be careful when walking around or under the bike wall racks when it is loaded to prevent bodily harm.

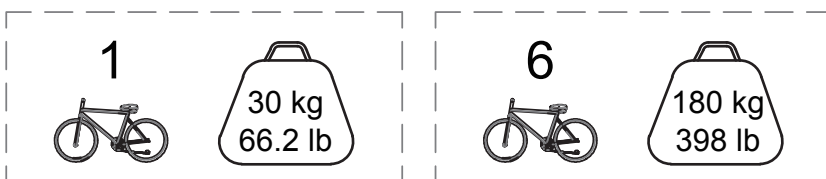

## Register your Lifetime Warranty

Your purchase comes with a lifetime warranty against manufacturer defects. To register and activate your warranty please visit : [probiketool.com/warranty](https://probiketool.com/warranty)

## Not totally satisfied or need help?

We are committed to customer satisfaction, so if you are not happy with your purchase, please contact us at [support@probiketool.com](mailto:support@probiketool.com) so that we can make it right. We pride ourselves in responding within 24 hours.

## VIP Club

Join our VIP Club to receive coupon deals and information on our new products [probiketool.com/vip](https://probiketool.com/vip)

## Follow Us!

To keep up to date with all the latest products, news and awesome deals from PRO BIKE TOOL, sign up for our newsletter at [probiketool.com](https://probiketool.com), or follow us at:



**Facebook**

[facebook.com/probiketool](https://facebook.com/probiketool)



**Instagram**

[@probiketool](https://instagram.com/probiketool)



**Twitter**

[@probiketool](https://twitter.com/probiketool)