

Solar street light introduction



Solar street light

- Road professional light distribution
- Intelligent control system
- Large capacity lithium battery
- Rechargeable in rainy days



Size	276*183*60mm		393*183*60mm		511*221*60mm		511*221*60mm		511*221*60mm		
Solar panel	Mono 6W/4.5V		Mono 10W/4.5V		Mono 15W/4.5V		Mono 30W/6V		Mono 45W/6V		
Battery	16WH		32WH		48WH		64WH		96WH		
Sensor											
Lumens	480LM		950LM		1300LM		1800LM		2200LM		
Switch	Yes		Yes		Yes		Yes		Yes		
Pole	40mm		50mm		50mm		50mm		50mm		
Setting mode	0.5h 100%		With people 1.5h 60%			10h 40%		Without people 7%			



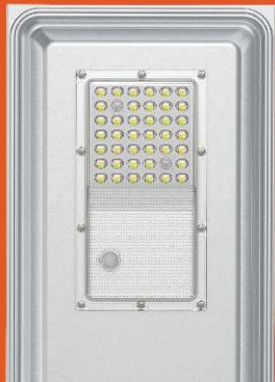
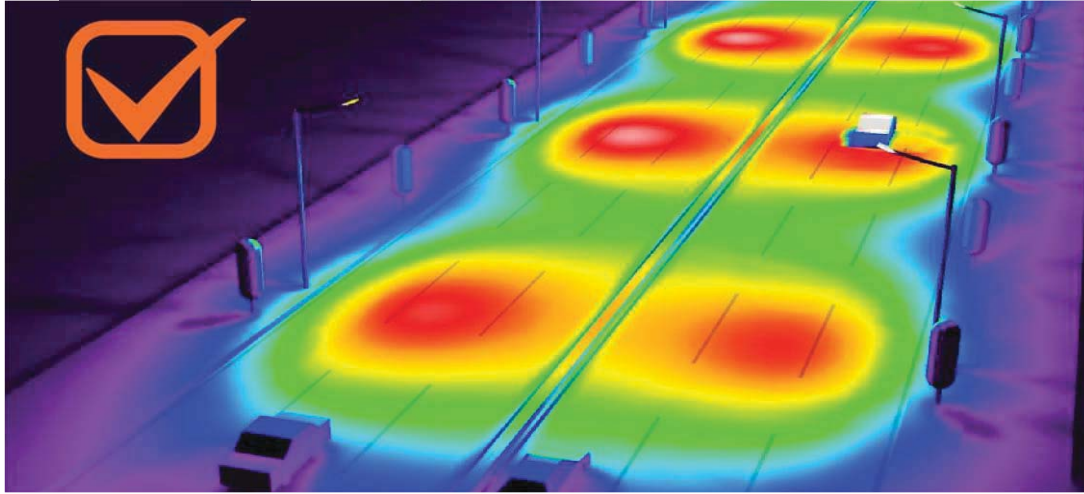

Road professional optical lens,
wide bat and bat wing light distribution design,
wide illumination range,
bright and uniform without dark areas

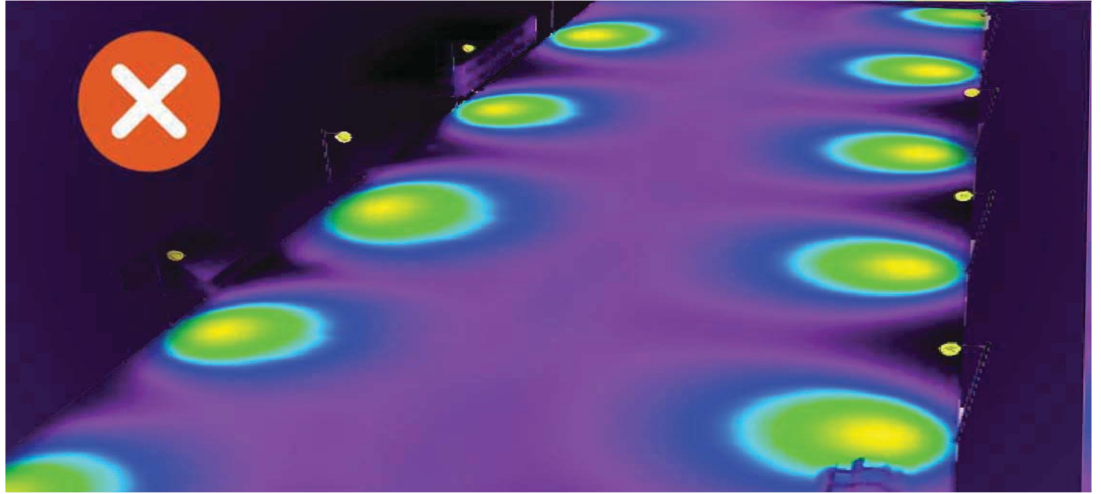

Other

Non-professional optical lens,
unreasonable light distribution,
small irradiated area, uneven illumination,
dark areas, and potential safety hazards

Comparison of real application cases

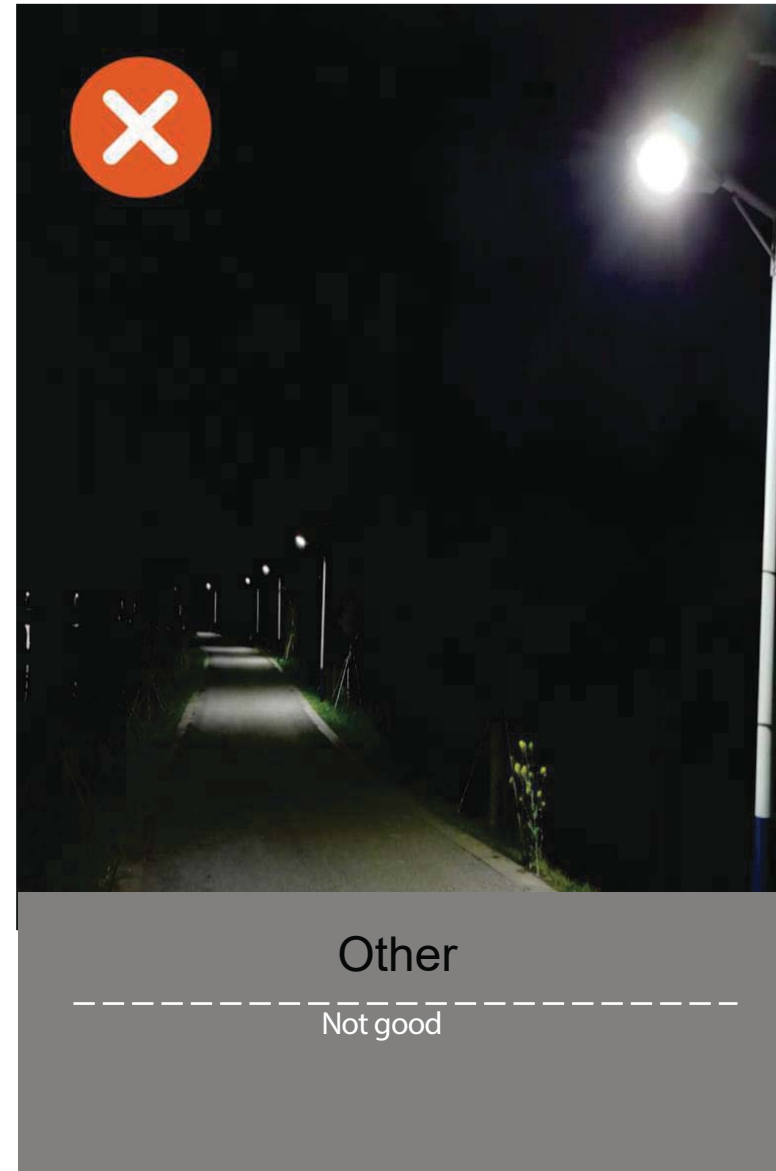
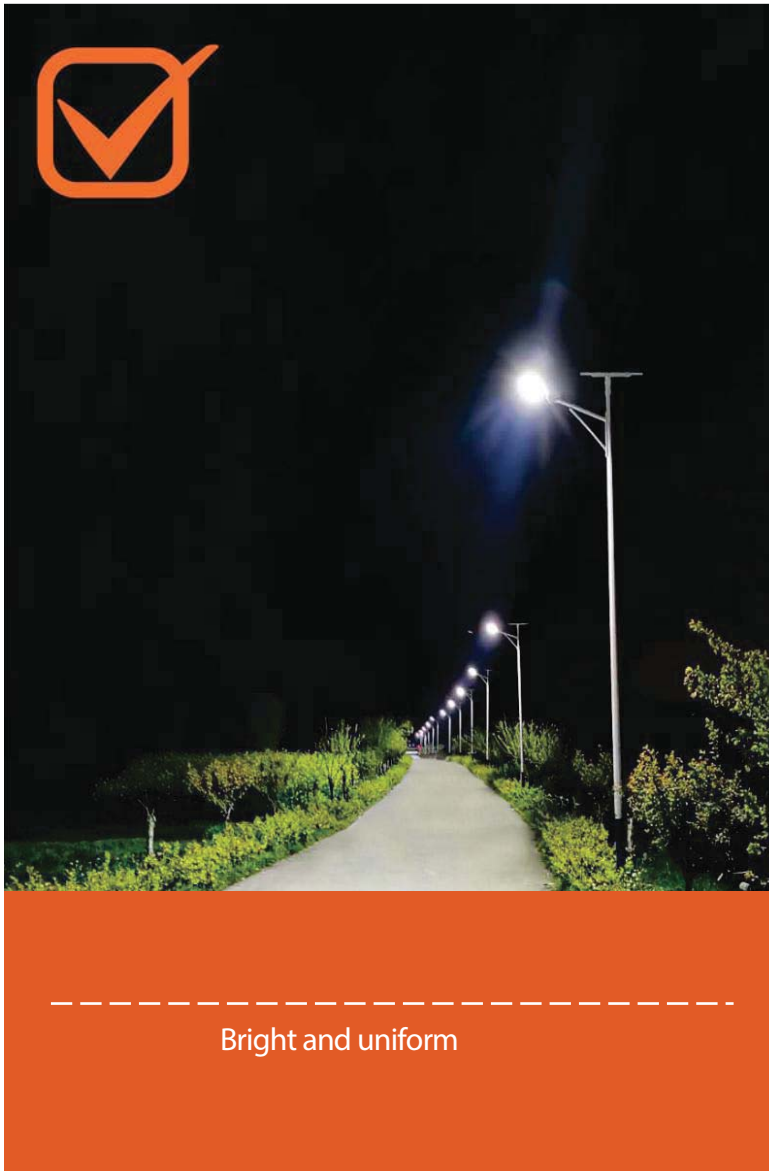

Large-capacity lithium battery, long-lasting battery life

BMS Intelligent Battery Management System

Multiple security protection, stability



Battery Compare



AT-CLX

With overcharge and overdischarge protection, large current discharge, high temperature resistance, good stability, long service life, safe and durable



Other

The number of cycles is short, the high temperature is easy to decompose, the safety and stability are poor, there is a safety hazard, and there is a risk of explosion

IP65



High-quality polysilicon plate, rechargeable in rainy days

High-conversion solar panels
can be charged in low light on cloudy and rainy days

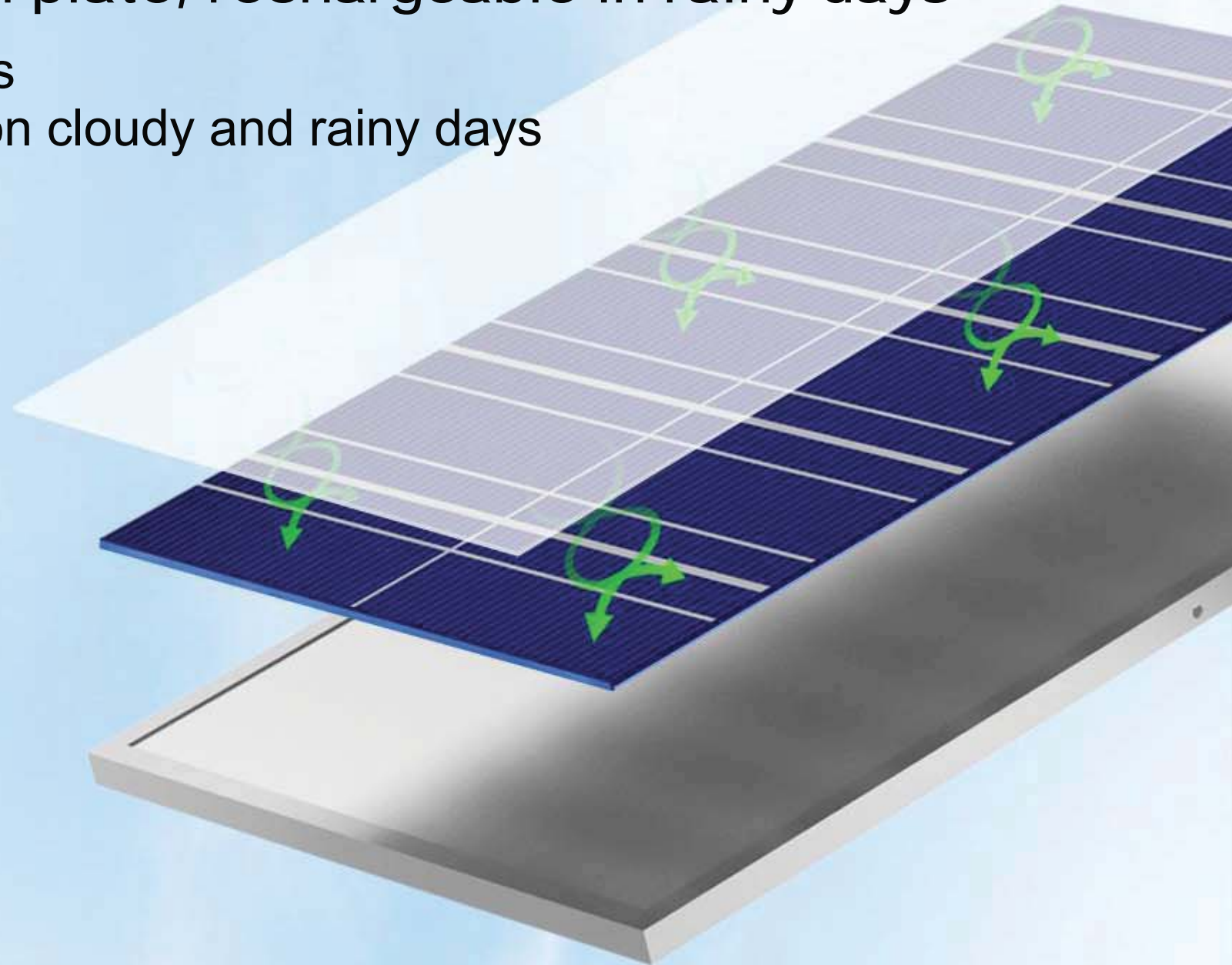

Smart lighting control system

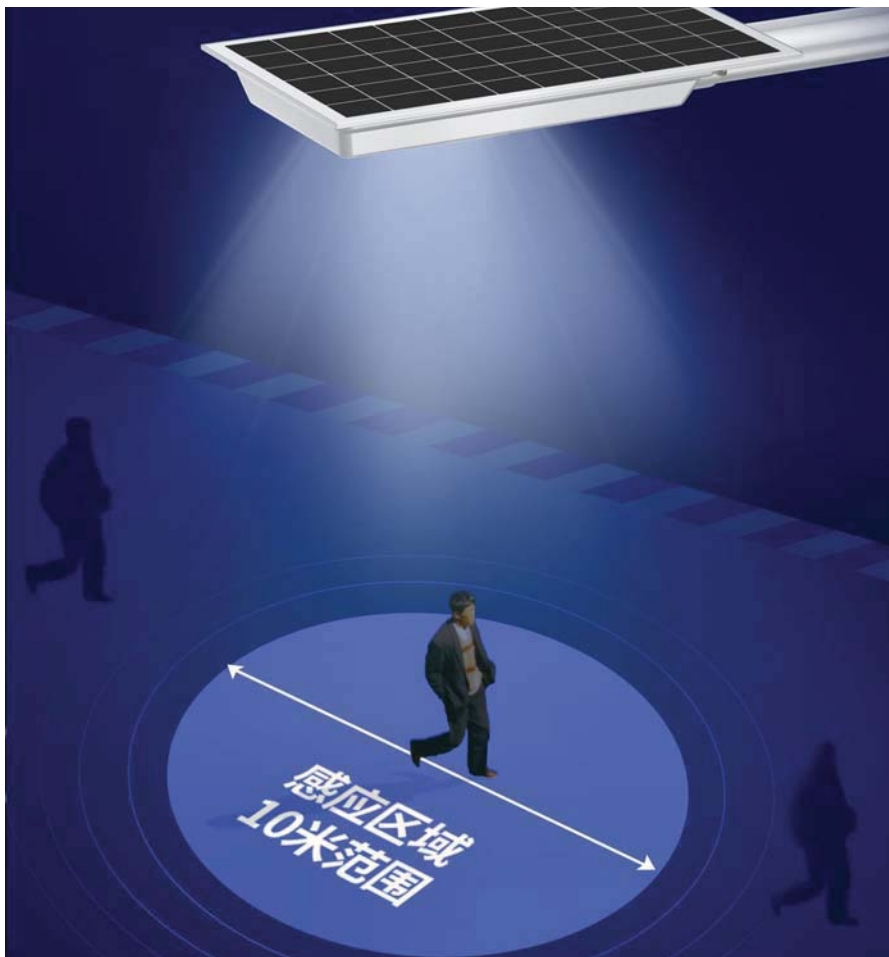

Radar sensor

When people come, the lights are bright, and people go, and the lights are dim, extending the lighting time



Day time

Intelligent identification charging



Night

Automatic light up

Light
Sensor

High Efficiency: 170lm/w



High Efficiency: 170lm/w



Multiple installation methods, flexible and convenient



Installation Notes

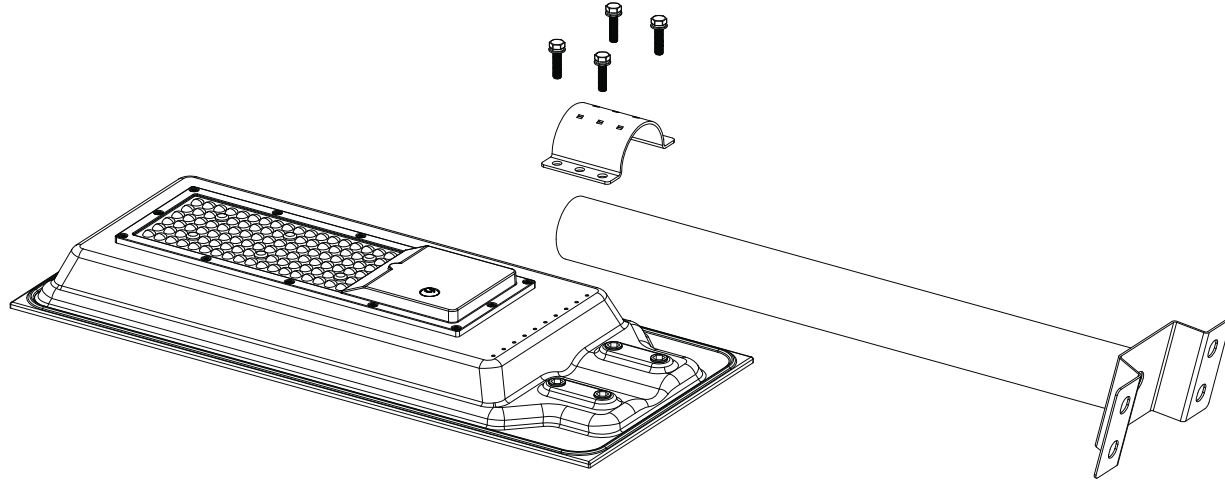

The place where this product is installed, try to ensure that the sunlight is directly on the solar panel, if there are obstructions around it, it will affect the charging effect;

When there is insufficient sunlight or continuous rainy days, the brightness and duration of the lamp will be affected;

For transportation safety, this product is only pre-charged with a part of the power before use. It is recommended to install and use after exposing to the sun for one day before use;

This lamp has a rechargeable battery, it is recommended to charge it regularly after storing it every three months, which can prolong the service life of the lamp;

Application scenario simulation solution

Courtyard application solution

Lighting simulation plan: about 25 square meters of courtyard, lamps installed on the fence, 3 meters above the ground

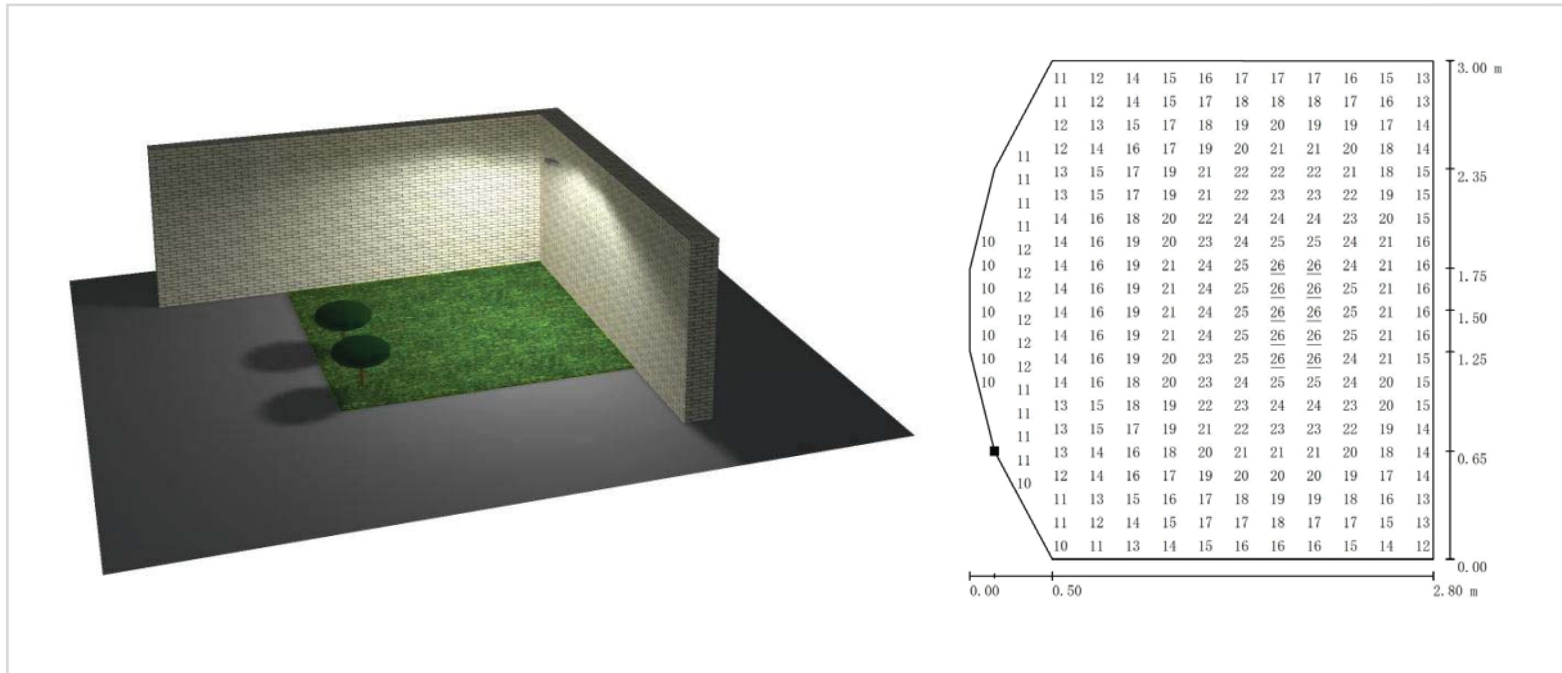

Scene type	Comparison item		Lighting standard
Private courtyard	Average illumination	18lx	> 5lx
	Illumination uniformity	0.541	--

Courtyard application solution

Lighting simulation scheme: a courtyard of about 35 square meters, with lamps installed on the fence, 3 meters above the ground

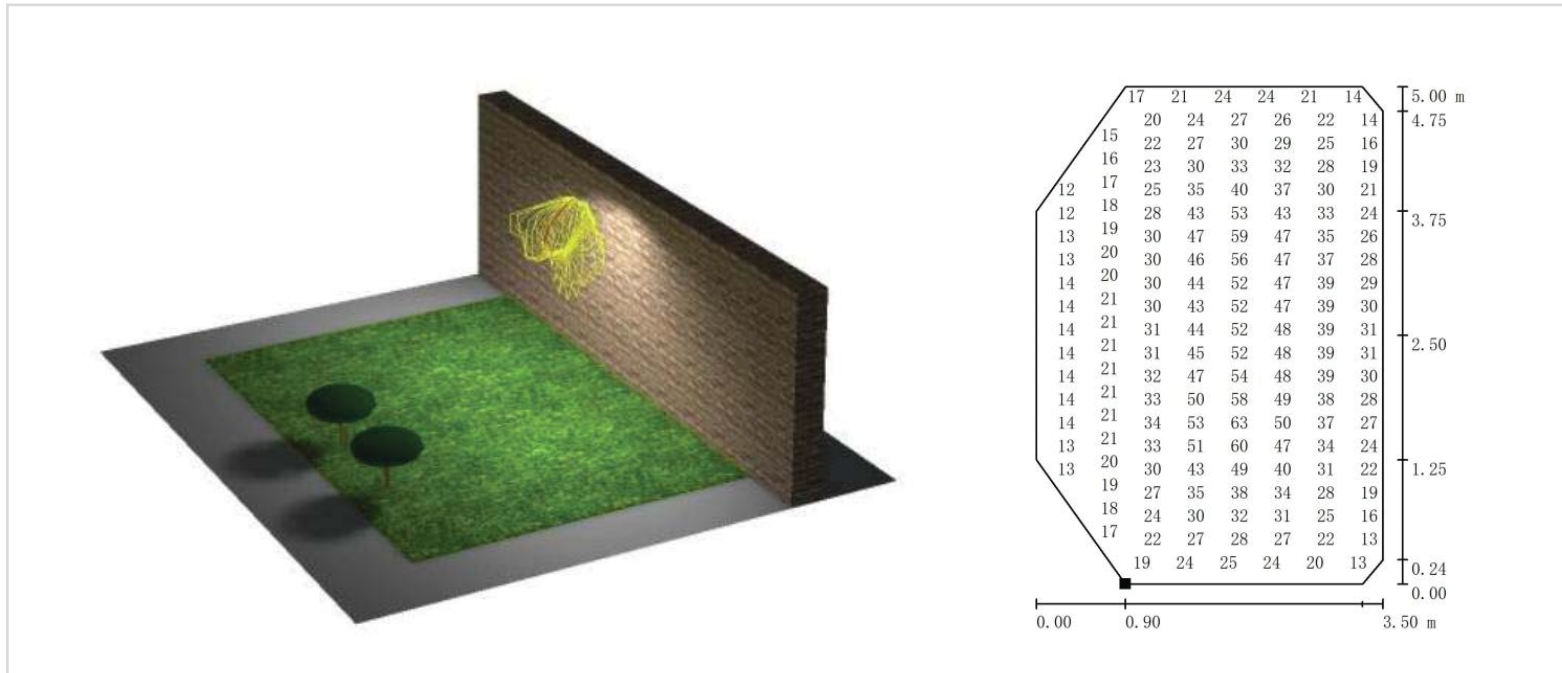

Scene type	Comparison item		Lighting standard
Private courtyard	Average illumination	30lx	> 5lx
	Illumination uniformity	0.313	--

Rural road application solutions

Lighting simulation scheme: road width 4 meters, lamp pole height 5 meters, pole spacing 15 meters, single-sided lighting

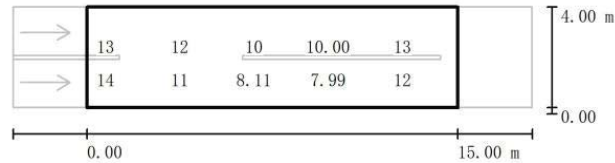
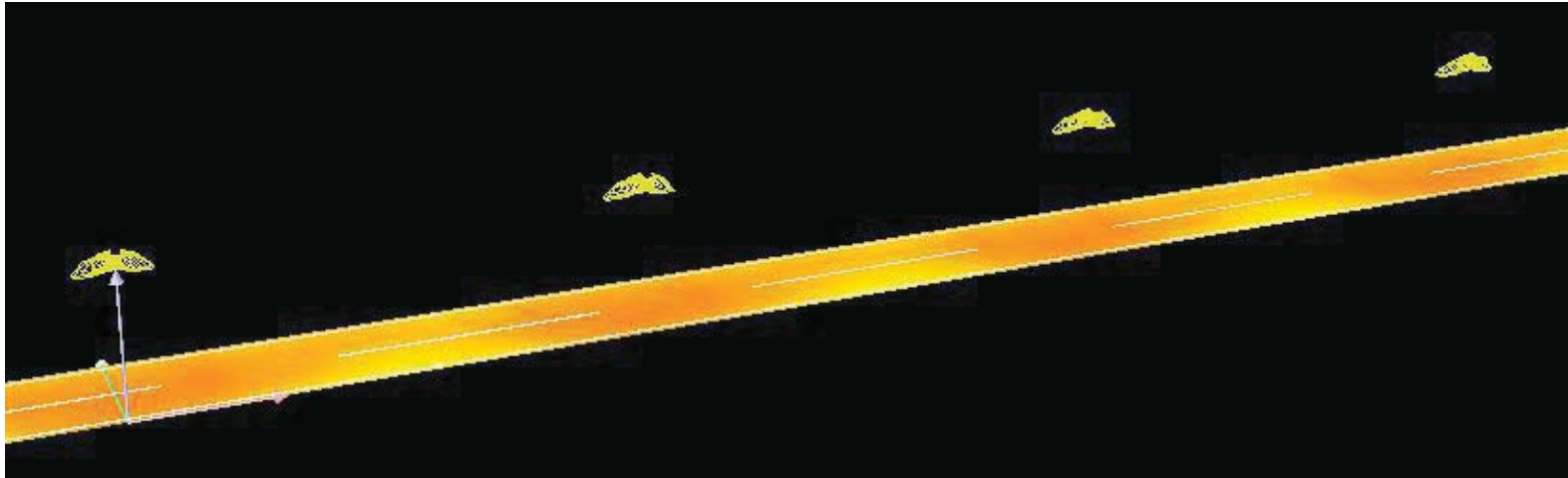

Scene type	Comparison item		Lighting standard
Rural road	Average illumination	11lx	8/10lx
	Illumination uniformity	0.572	0.3

Auxiliary Road Application Solution

Lighting simulation scheme: road width 7 meters, lamp pole height 6 meters, pole spacing 15 meters, single-sided lighting

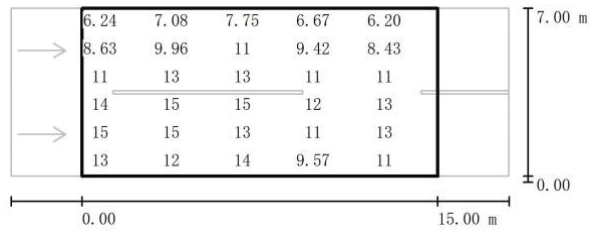
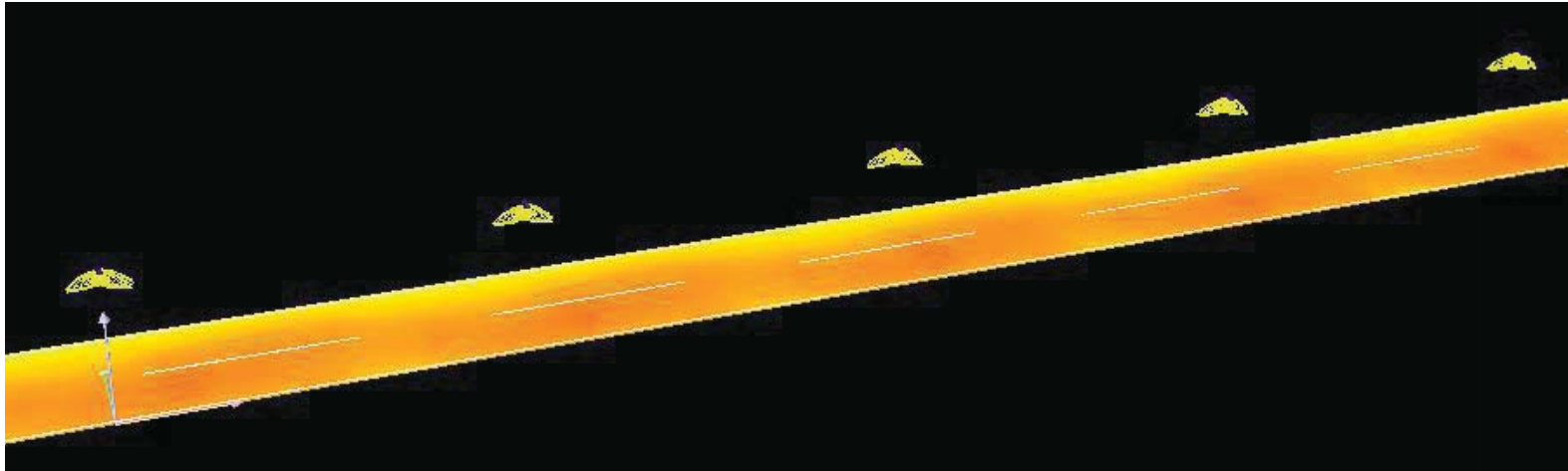

Scene type	Comparison item		Lighting standard
Auxiliary Road	Average illumination	11lx	8/10lx
	Illumination uniformity	0.541	0.3

Auxiliary Road Application Solution

Lighting simulation scheme: road width 7 meters, lamp pole height 6 meters, pole spacing 20 meters, single-sided lighting

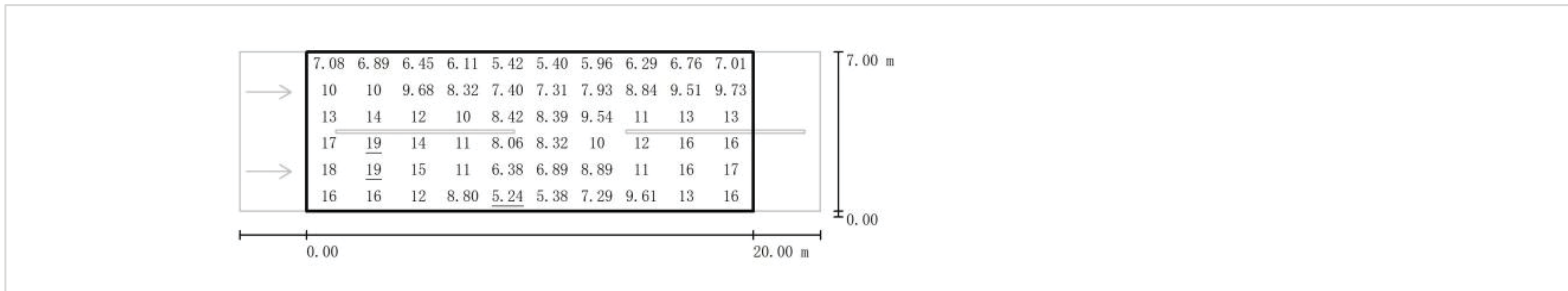
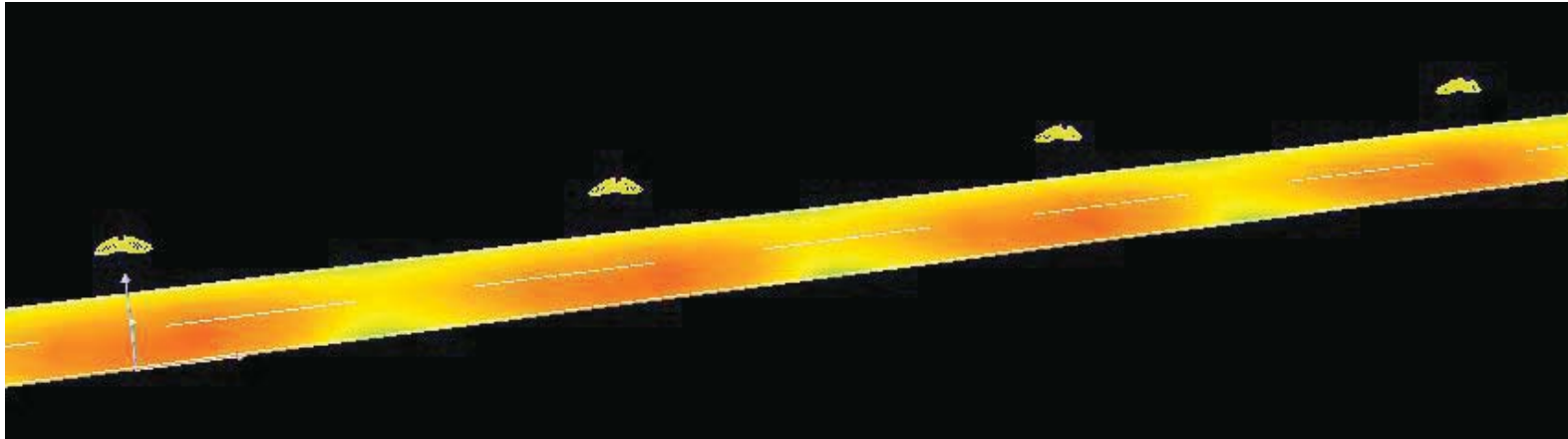

Scene type	Comparison item		Lighting standard
Auxiliary Road	Average illumination	11lx	8/10lx
	Illumination uniformity	0.494	0.3