

MANTU

The adjustable light hood

O Manto que regula a luz

This table cork lamp helps you control the amount of light in any room.

Do you prefer a more directional light or do you want it more diffuse?

Mantu allows you to change the intensity according to your needs without the hustle of having two different lamps.

Just adapt the hood and use it the way it suits you best.

Este candeeiro de mesa em cortiça ajuda a regular a intensidade de luz em qualquer espaço.

Preferes uma luz mais direccional ou pretendes uma mais difusa?

Com o Mantu podes alterar a intensidade de acordo com as tuas necessidades sem precisares de dois candeeiros diferentes.

Adapta o capuz e usa-o da forma que melhor se adaptar a ti!

—
designer

Filipe Pêgo

origin of the name

Manto (mantle in Portuguese)

origem do nome

Manto

Welcome to DEDAL world!
Made
the
Heart
Way!

www.dedal.pt

+351 210937231 | info@dedal.pt
facebook.com/Dedal | instagram.com/dedal.pt | pinterest.com/dedalPT
plus.google.com/+dedalpt | twitter.com/dedalpt

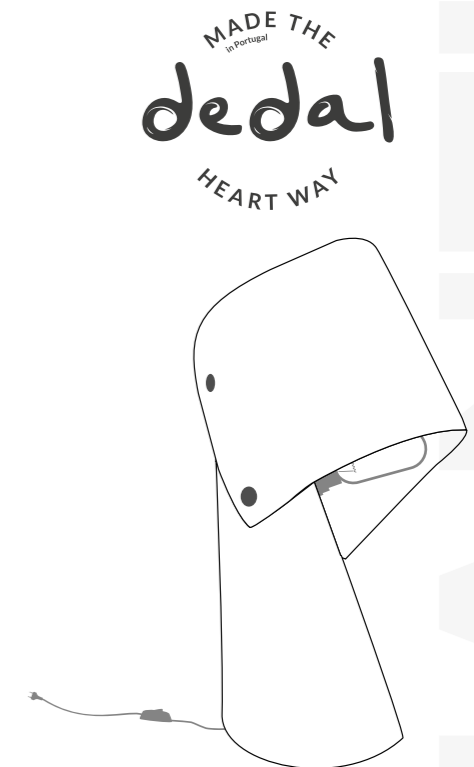

MANTU
INSTRUCTIONS
Instruções

MANTU

Assembling Guide | Guia de Montagem

dedal

INSIDE THIS PACKAGE / dentro desta caixa

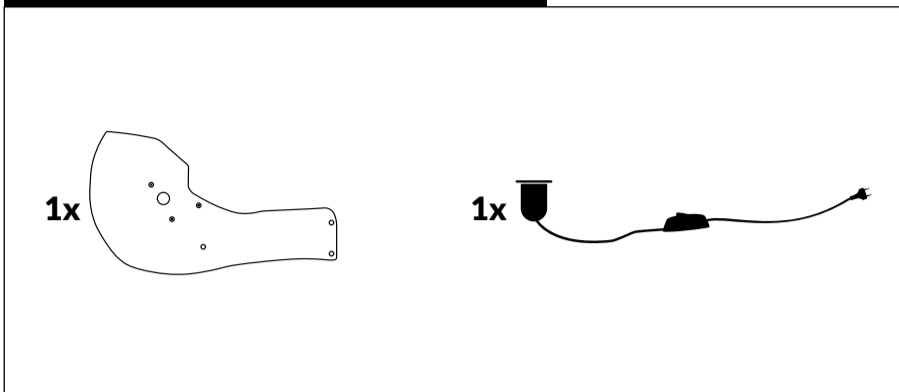

NOT INCLUDED / não incluído



1 | Assembling electrical parts Montagem parte eléctrica

1.1 - Remove the ring from the light socket by unscrewing it.

1.1- Desenroscar o anel do casquilho.

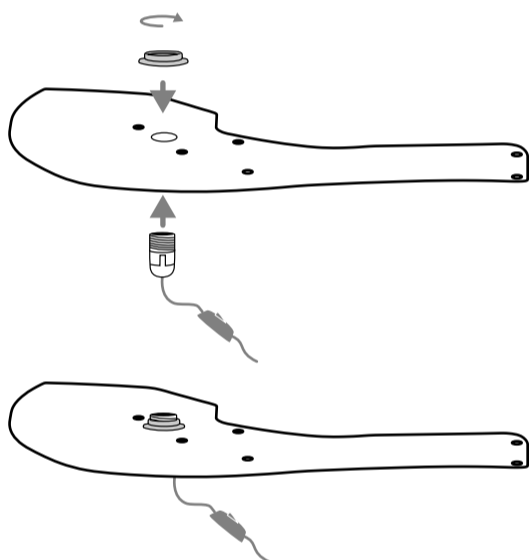
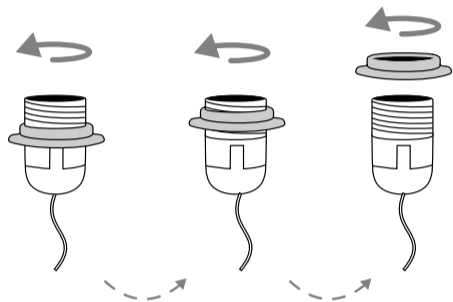

1.2 - Pass the light socket and the cord through the hole. Then, screw the ring back so that the cork is in between the bulb and the ring.

1.2 - Passar o casquilho e o fio pela furação. Depois, enroscar o anel para que a cortiça fique presa ao casquilho.

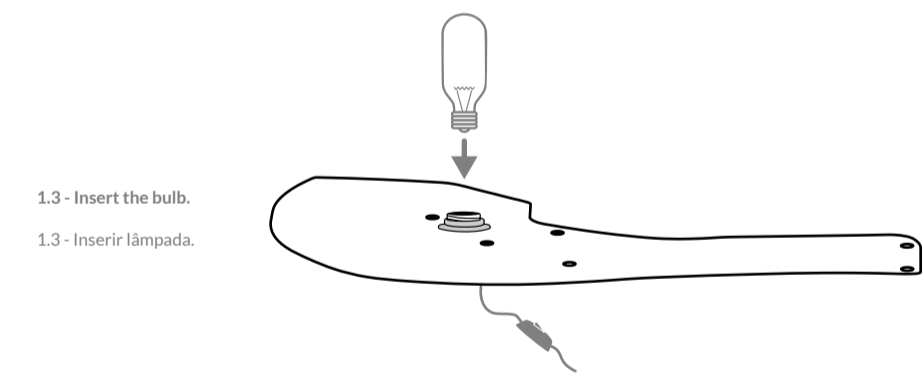

1.3 - Insert the bulb.

1.3 - Inserir lâmpada.

2 | Curl the cork and connect first button Enrolar a cortiça e ligar o primeiro botão

2.1 - Roll the cork to connect the first button, as shown below.

2.1 - Enrolar a cortiça para prender a primeira mola, como ilustrado na imagem.

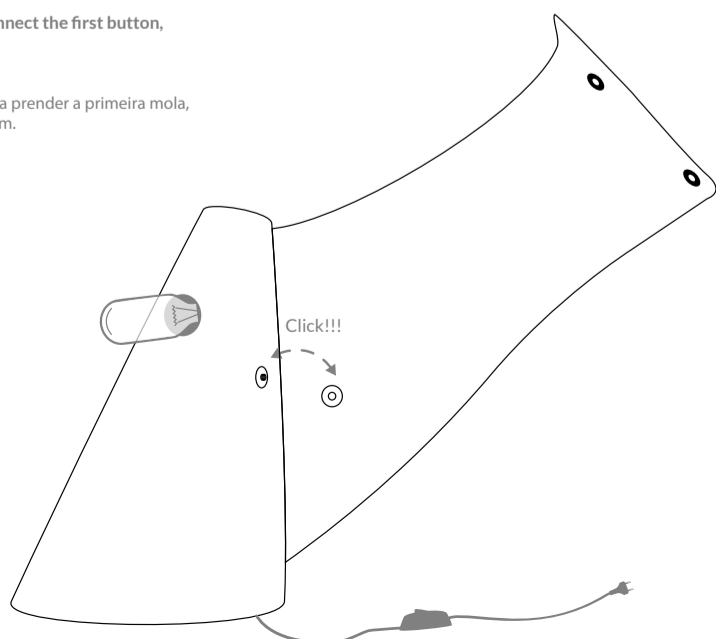

3 | Curl the cork and connect second button Enrolar a cortiça e ligar o segundo botão

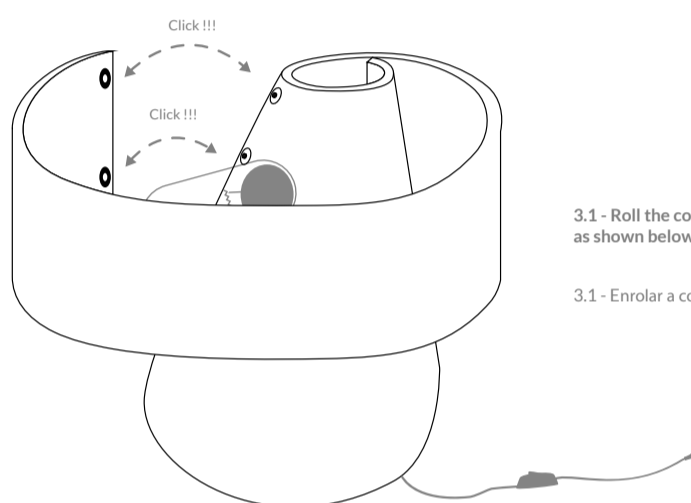

3.1 - Roll the cork to connect the second button as shown below.

3.1 - Enrolar a cortiça e fixar as restantes molas.

4 | Adjusting the light Ajustar a luz

4.1 - Connect option A or B to change light's intensity. Choose the option that suits you best.

Please disconnect the buttons gently!

4.1 - Para alterar a intensidade da luz, prenda as molas de acordo com os desenhos A ou B. Escolher a opção que melhor se adapta à luz pretendida.

Atenção: retirar as molas com cuidado!

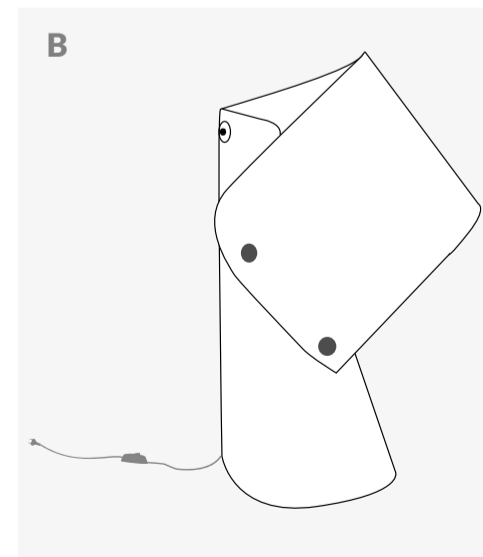
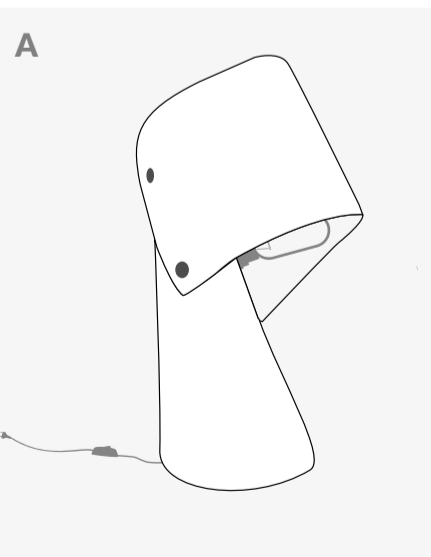
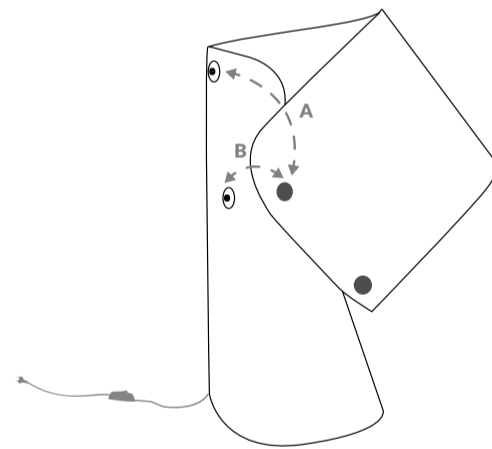

4.2 - Connect to the power socket (beware 220-240, 50 Hz).

4.2 - Ligar à corrente eléctrica (220-240, 50Hz).

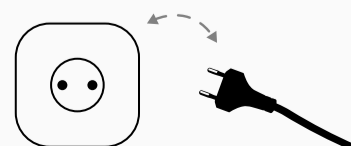

4.3 - Switch the light on.

4.3 - Ligue a luz.



MANTU

Assembling Guide | Guia de Montagem

dedal

INCLUDED / incluído

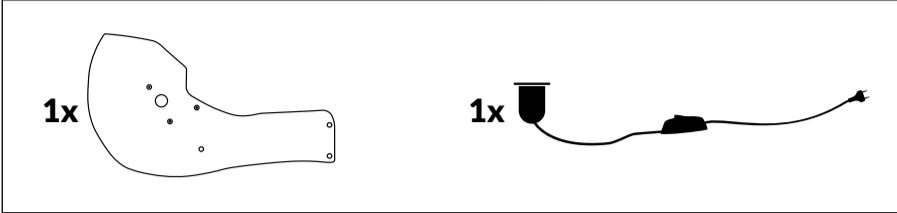

NOT INCLUDED / não incluído

1x



Lamp/Lâmpada: E27, 60W máx

1

Assembling Montagem

a - Unscrew the ring from the light socket.
Desenroscar o anel do casquilho.

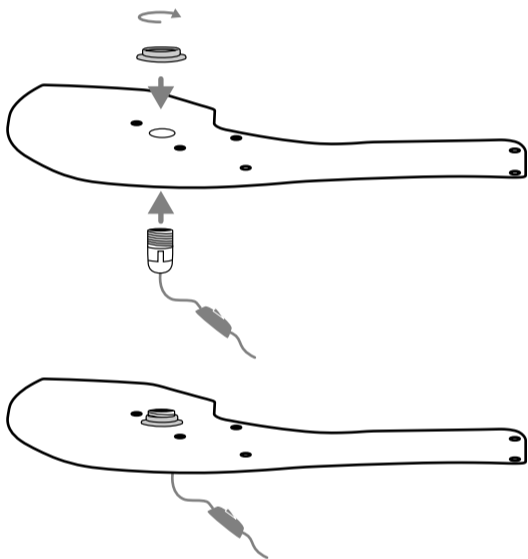

b - Pass the light socket and the cord through the hole. Screw the ring back so that the cork lays between the bulb and the ring.

Passar o casquilho e o fio pela furação. Enroscar o anel para que a cortiça fique presa ao casquilho.

c - Insert the bulb.
Inserir a lâmpada.

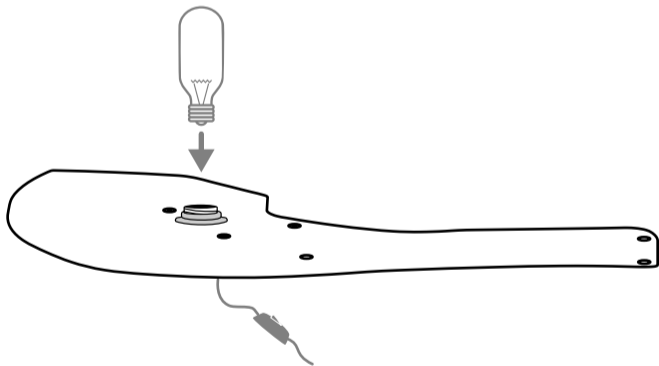

2

Curl the cork and connect the first button Enrolar a cortiça e prender a primeira mola

Roll the cork to connect the first button (see image).

Enrolar a cortiça para prender a primeira mola (ver imagem).

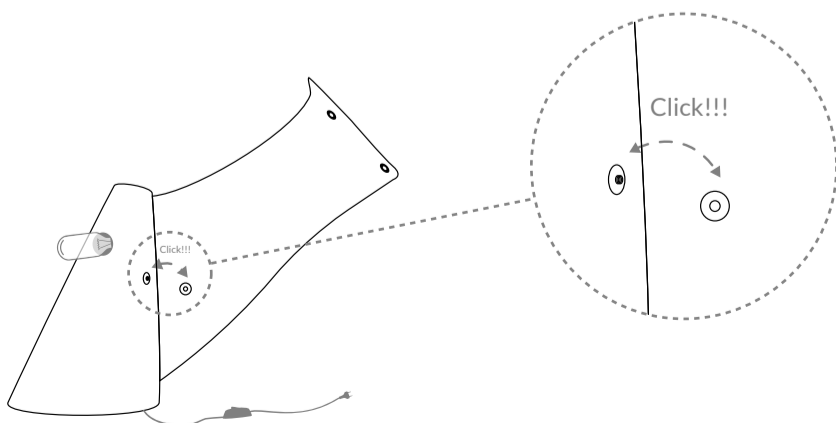

3

Curl the cork and connect the second buttons Enrolar a cortiça e prender as molas que faltam

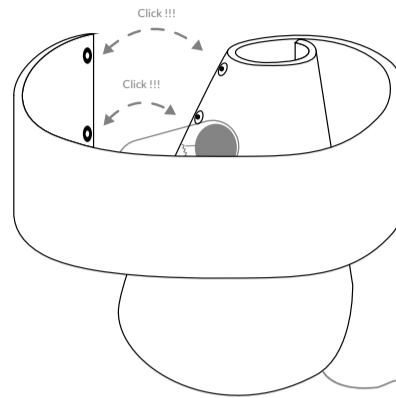

Roll the cork to connect the remaining buttons (see image).

Enrolar a cortiça e fixar as restantes molas (ver imagem).

4

Adjusting the light Ajustar a luz

Connect option A or B to change light's intensity. Choose the option that suits you best.

NOTE: Please disconnect the buttons gently!

Para alterar a intensidade da luz, prenda as molas de acordo com os desenhos A ou B. Escolher a opção que melhor se adapta à luz pretendida.

ATENÇÃO: retirar as molas com cuidado!

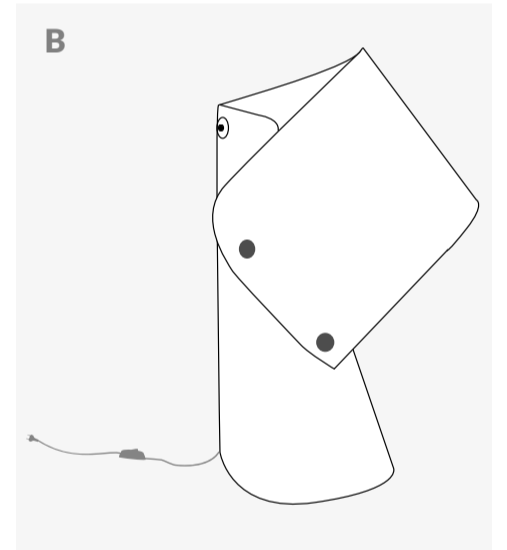
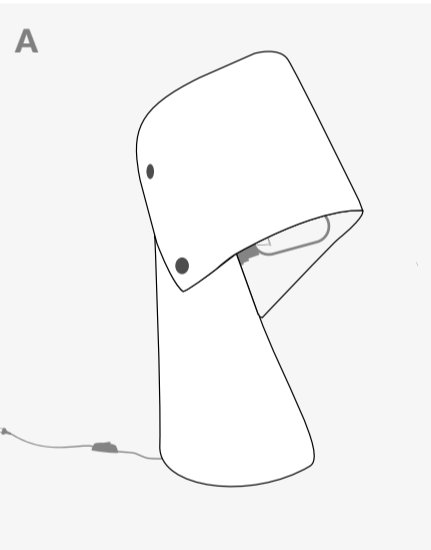
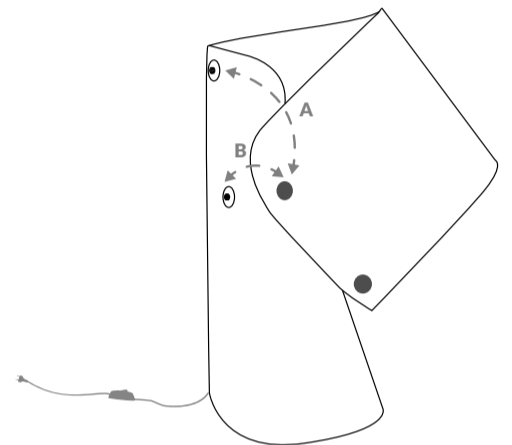

5

Adjusting the base Ajustar a base

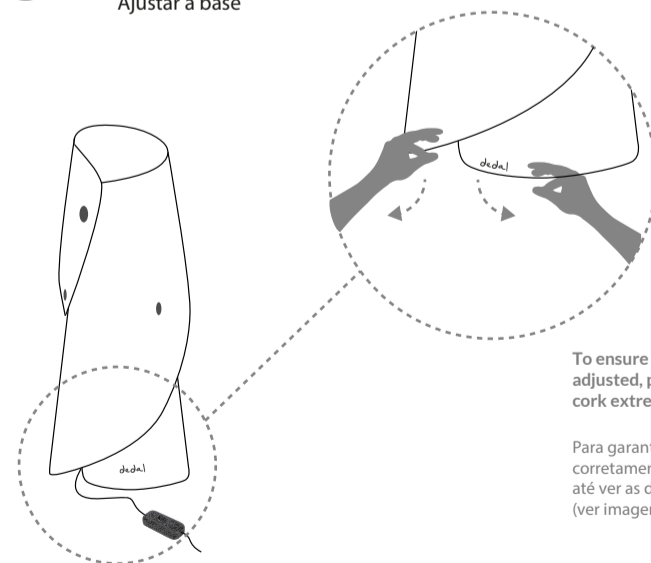

To ensure that the base is properly adjusted, pull it until you see both cork extremities (see image).

Para garantir que a base do candeeiro está corretamente ajustada, puxar a base até ver as duas extremidades da cortiça (ver imagem).

6

Connect the plug Ligue a ficha

Connect the plug (beware 220-240, 50 Hz).

Ligue a ficha à tomada (220-240, 50Hz).

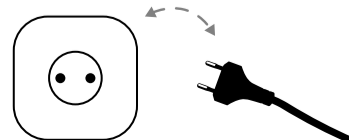

7

Switch the light on Ligue a luz

