

McKinney 4 1/2 x 4 1/2 Full Mortise Template Hinge

The global leader in door opening solutions

DO NOT SCALE
DIMENSIONS: INCHES (MM)

MACPRO®

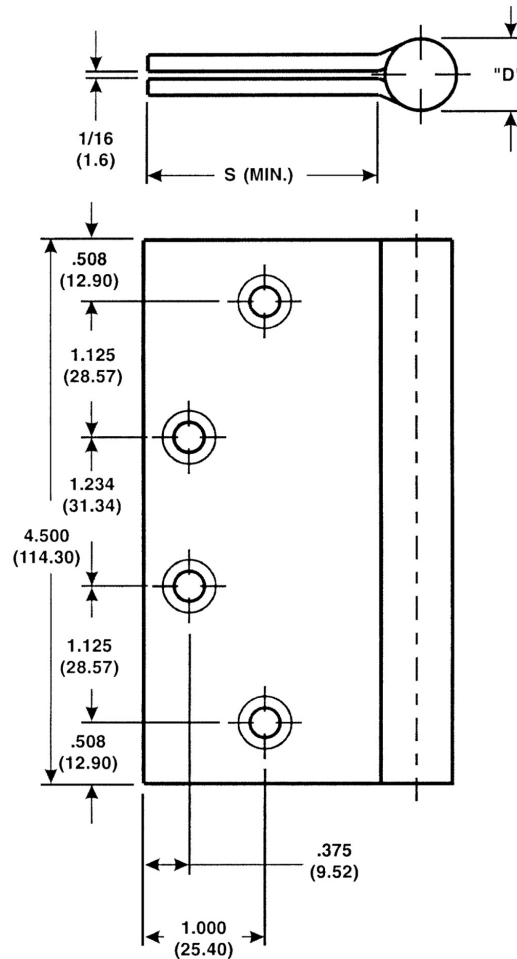

| CATALOG NUMBER | | GAUGE OF METAL | "D" OUTSIDE DIAMETER | "S" DISTANCE (SWAGE LINE) | |
|----------------|------------------------|----------------|----------------------|---------------------------|----------------|
| STEEL HINGES | STAINLESS STEEL HINGES | | | HINGE WIDTH | |
| | | | | 4 (101.6) | 4 1/2 (114.3) |
| MP79 | - | .134 (3.40) | .612 (15.53) | 1-21/32 (42.1) | 1-29/32 (48.4) |
| MPB79 | MPB91 | .134 (3.40) | .612 (15.53) | 1-21/32 (42.1) | 1-29/32 (48.4) |
| MPB68 | MPB99 | .180 (4.57) | .750 (19.03) | - | 1-27/32 (46.8) |

Template MP 030-12

Effective date:
May 15, 2012

Supersedes: All Previous

McKINNEY MacPro Template Hinges of the Catalog Numbers are made to conform to ANSI/BHMA 156.7.

Machine Screw Size:
1/2 x 12-24 F.H.

Wood Screw Size:
1 1/4 x 12 F.H.

225 Episcopal Road
Berlin CT 060377
P: 800.346.7707 | F: 800.541.1073
www.mckinneyhinge.com | dss-orders@assaabloy.com

McKinney is a brand associated with Corbin Russwin, Inc., an ASSA ABLOY Group company. Copyright © 2017, Corbin Russwin, Inc. All rights reserved. Reproduction in whole or in part without the express written permission of Corbin Russwin, Inc. is prohibited.