

# ICON FORD BRONCO SPARE TIRE CARRIER INSTRUCTIONS



THANK YOU FOR YOUR PURCHASE!



**ICON**

Handmade in Los Angeles  
California, USA

# ICON FORD BRONCO SPARE TIRE CARRIER

## Parts List

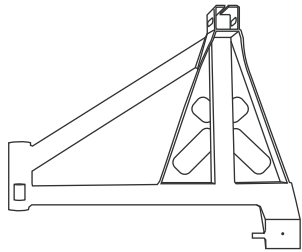

Tire Carrier

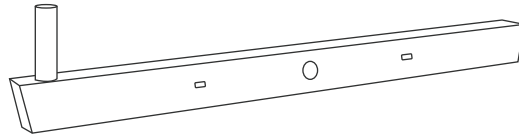

Rear Bumper

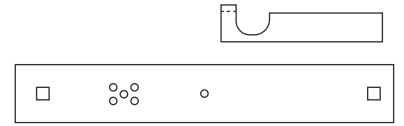

Lazer Cut Stencils

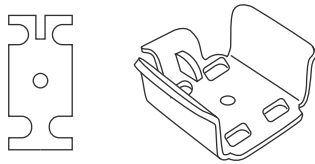

Latch Catch & Spacer

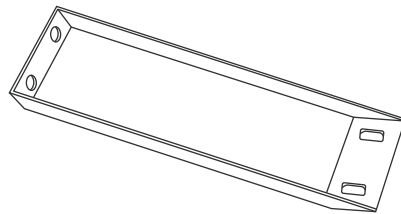

Bumper 45° Brace

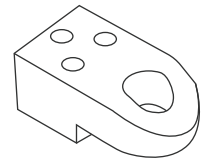

Carrier Ramp Catch

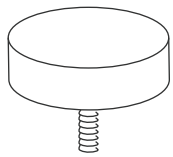

Swing Arm Cap

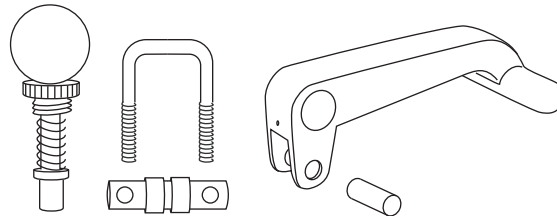

Tire Carrier Latch & Specialty Hardware

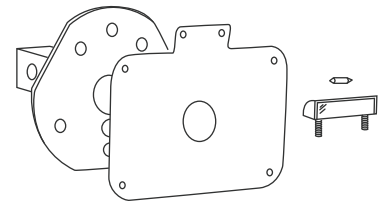

Tire/Plate Mount & Light

## Hardware List

### Bumper Hardware List

1/2-13 x 1.50 Bolt Gr8 X4  
 1/2-13 Nut Gr8 X4  
 1/2 Split Washer Gr8 X4  
 1/2 Split Washer Gr8 X4

### Bumper Brace Hardware

7/16-14 x 1.50 Bolt Gr8 X2  
 7/16-14 Nut Gr8 X4  
 7/16 Washer Gr8 X4  
 7/16 Split Washer Gr8 X4

### Latch Catch Hardware

3/8-14 x 1.50 Bolt Gr8 X4  
 3/8-14 Nut Gr8 X4  
 3/8 Split Washer Gr8 X4  
 10-24 x 1.00 Bolt SS XI  
 10-24 Nylon Lock Nut SS XI  
 3/16 Washer SS XI

### Carrier Ramp Catch Hardware

1/4-20 x 1.00 Cap Screw SS X3  
 1/4 Hi-collar Lock Washer SS X3



# ICON FORD BRONCO SPARE TIRE CARRIER

**\*Before You Drive\***

Rewire the existing license plate light on your vehicle to the new position above the plate mount using the provided light housing.



Before starting the installation, check through the supplied parts and hardware list to ensure all parts are accounted for. Before painting the unfinished parts, we recommend 1) having the studs for the tire carrier welded in from the back 2) testing fitment for your specific bolt pattern.

## INSTRUCTIONS

Remove the 4x 7/16 carriage bolts holding the stock rear bumper to the frame. We recommend 1) having a low profile ratcheting wrench 2) keeping your original carriage bolts to reinstall the bumper skin later.



Use the supplied bolts, washers, lock washer, and nut to secure the 45° brace plate to the bumper brace as seen below. Next, begin test fitting the bumper to the frame tongues. \*Note that your stock frame may need some persuasion to force the ends to fit within the bumper.

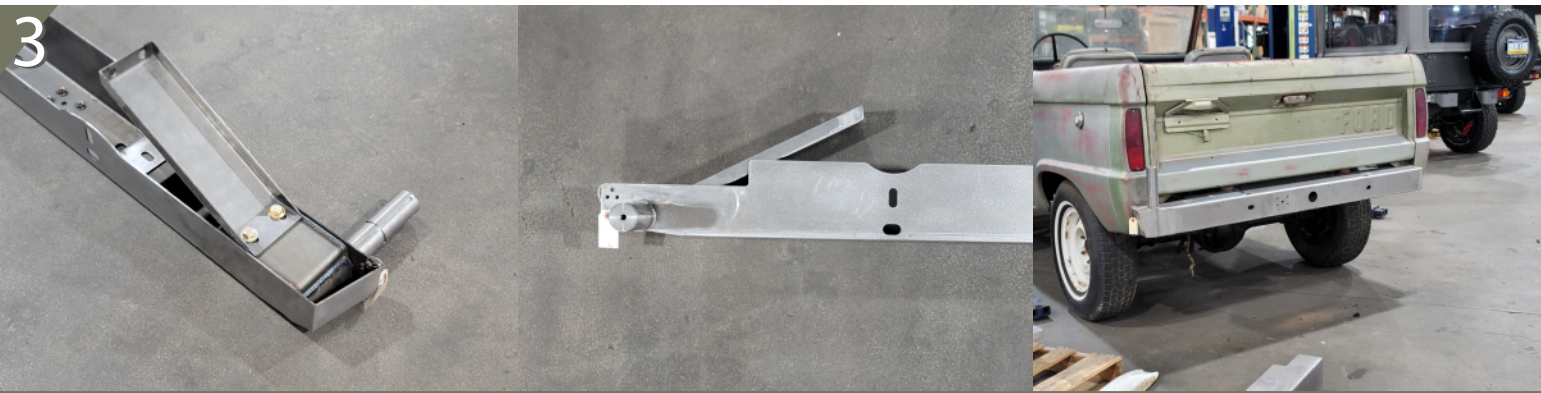



Drill X2 1/2 holes in the bottom of each frame post to fully secure the new bumper liner. Also, drill X2 7/16 holes in the side of the frame to complete the driver-side brace (using the bumper held in place as reference). Be sure to assemble hardware in the correct orientation.



Align the provided template with the stock carriage bolts. Proceed to, 1) drill out the mounting position for the latch catch 2) remove the notch for the tire rack pivot point. When completed, we recommend affixing your modified bumper to the new internal bumper, as access from the backside may be limited later.



\*Due to variances in stock bumpers' width, spare tire post needs to be adjusted accordingly. Note that the final cuts and orientation should resemble the below set of images.



Affix the latch catch system through your modified stock bumper skin using 4X 3/8-16 X 1.25 bolts, loc washers, and washers. Next, 1) place the metal spacer underneath the latch catch so that the latch sits above the grooves of the bumper skin 2) place the rubber stop with the washer seeded within.

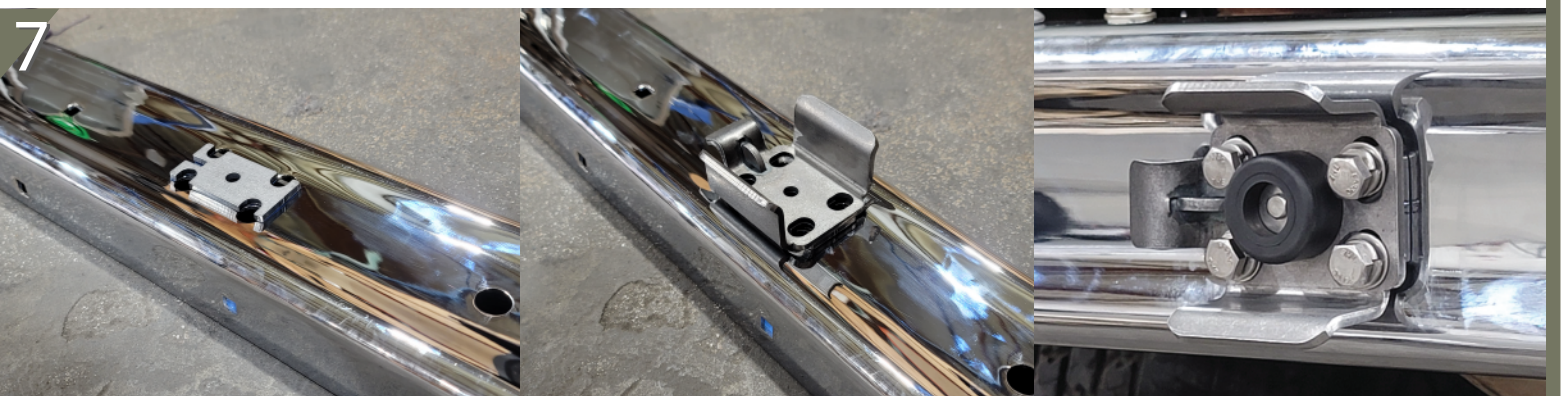



Before installing the tire gate, use sandpaper if needed to ensure the carrier and shaft fit together with no friction. When installing for the first time be sure to 1) coat both surfaces with marine grease as well as 2) use the provided Zirc fitting to install grease.

8



When preparing the tire carrier be sure to 1) tighten the knob onto the catches 2) insert the small bump stop in the front of the carrier 3) strike a dimple into the pin that secures the handle with a punch so that it holds when pressed into place.

9



When mounting the carrier be sure to 1) affix the cap 2) make any necessary adjustments to guarantee the tire carrier locks and unlocks properly. At this stage, we recommend slowly testing the range of motion of the carrier, to ensure there is no interference with nearby components.

10



When attaching the latch, be sure to place a plastic washer on the top and bottom, while also adjusting the catch to engage properly. After installing the tire carrier, be sure to check for fitment and re-tighten all the components installed thus far.

11

