



AGM-26 2 DOOR REACH-IN GLASS DOOR REFRIGERATOR

INCLUDE 3 YEAR PARTS + LABOR / 5 YEAR COMPRESSOR WARRANTY

Dimensions

Exterior Dimensions (WxDxH)	39.375" x 26.375" x 78.75"
Interior Dimensions (WxDxH)	35.375" x 21.75" x 60.375"
Capacity (cu. ft.)	26.1 cu. ft. or 739.6lbs
Unpackaged Weight	328.5 lbs
Packaging Dimensions (WxDxH)	40.875" x 27.875" x 80.125"

Construction

Exterior Material	Pre-painted steel
Interior Material	Pre-painted steel
Insulation Material	
Doors	2
Door Material	V7 Plastic Frame
Shelf Size (WxD)	15.875" x 19.375"
# Shelves	10
Shelf Load Capacity	

Cooling

Temperature Range	32° - 44.6° F
Refrigerant	R290
Maximum Ambient Temperature Rating	
Defrosting	Automatic
Temperature Display	Yes
Temperature Controller	Digital
H/P	1/3

Electrical

Voltage	115
Amps	7.5A
Hz	60
Controller	ETC1H

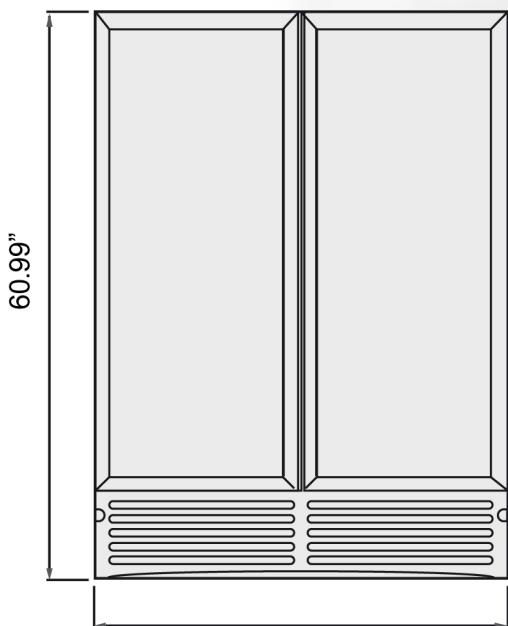

42"
Front View

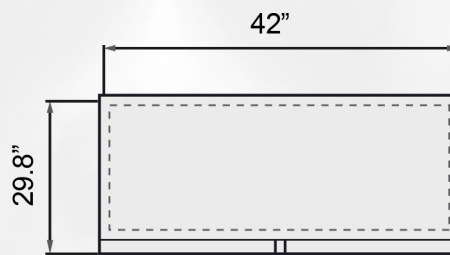

Top View

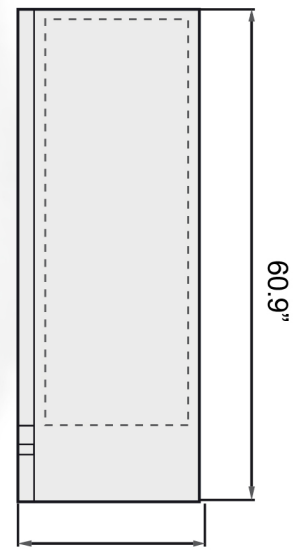

29.8"
Side View



NEMA 5-15P



DOE

