

## BIEL TOOL

Part No.	Length:	in	cm	Net Weight:	lb	kg
<b>22-000550</b>		15.1	38.3		3.3	1.5

The new Biel Tool is now one piece made out of heat treated, electro-polished, stainless steel with an extremely durable ergonomically rubber molded handle.

The Biel Tool incorporates many of the features found in the world famous Paratech 'Pry-Axe', but is much smaller and light enough to wear on a belt or carry in the pocket of a bunker coat. This is the perfect personal size multi-purpose forcible entry and rescue tool, designed for forcing doors and windows, prying and twisting hasps and locks, light overhauling, nail removal, gas shutoff, metal cutting and chopping.

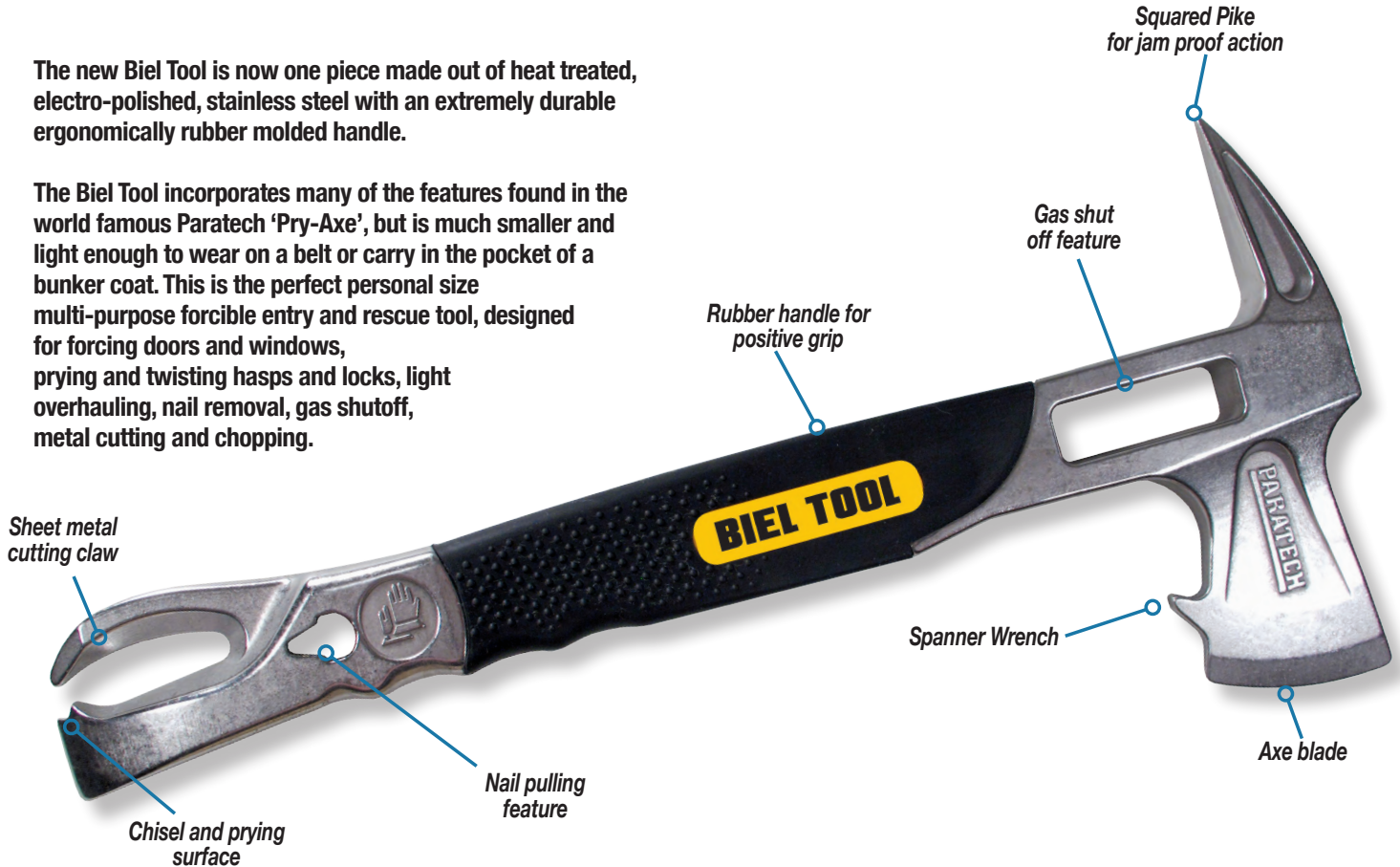

**Biel Tool and Sheath**  
 Length: 15.1 in 38.3 cm  
 Net Weight: 3.4 lb 1.5 kg  
 Part No. 22-000551



**Biel Sheath**  
 Length: 7.3 in 18.5 cm  
 Net Weight: 0.1 lb 0.05 kg  
 Part No. 22-000555



**Biel Holster**  
 Length: 16.0 in 40.6 cm  
 Net Weight: 0.5 lb 0.24 kg  
 Part No. 22-000545