

straightcurve®

# Specifications

## 9.5" Flexline™

LENGTH 85" | TOP THICKNESS 0.31"

### FINISHES

- Galvanised Steel
- Weathering Steel

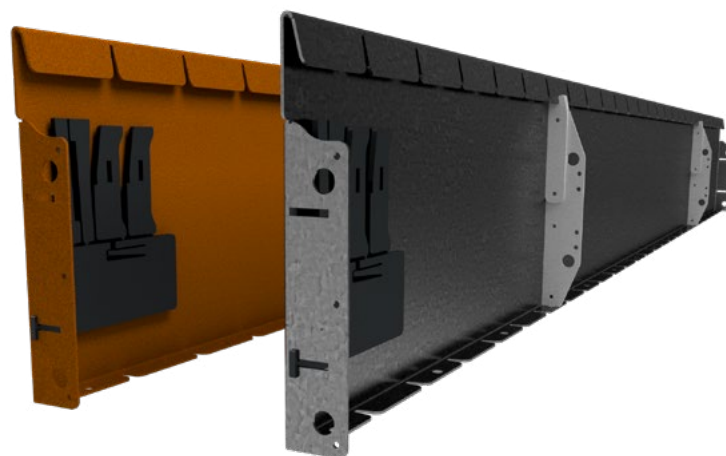

Steel plate thickness 0.08"

### SOLD AS SET INCLUDING

- 1 x joining set (2 x wedge, 2 x slider, 1 x joint bracket)
- 5 x galvanised spikes, 12" long
- 2 x bracing ribs (attached to edge)

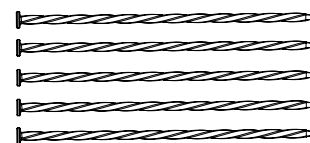
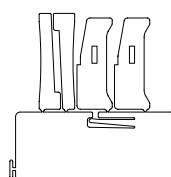

### ADDITIONAL ACCESSORIES

#### REQUIRED

- Small anchor post (2 x Tek screws 12G x 0.63")

#### OPTIONAL

- Corner piece (arm lengths: 9.5")
- Joining sleeve (6 x Tek screws 12G x 0.63")
- Universal bracing set (turnbuckle/chain/stake)

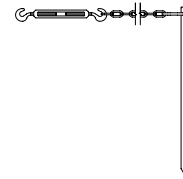
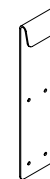
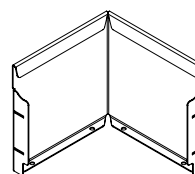

# Installation guide

## 9.5" Flexline™



### PREPARATIONS

Mark line and level or trench as required ready for install. *Note: This edge allows gentle sloping*

### CORNERS

Pre-made corners\* are available for purchase, these include the standard joining set. These can be opened or closed further with forceful bending to achieve different angle corners. You can also choose to make your own. To do this score a line down the back of the edge and create a sufficient opening (0.2-0.28") in the folded lip at the top and cut out one foot tab at the bottom with your angle grinder to allow space for bending. Bend strongly by hand; using a block of wood close to the fold to form bend against.

### STAKING THE EDGE

Anchor posts are driven in as a stake behind the edge adjacent to a bracing rib, which is then screwed onto with screws. It is recommended to use two of these per edge. If you're making a tight 1.37m diameter ring with two lengths, it is self supporting and doesn't need any anchor posts.

### HARD SURFACE FIXING

If you need to secure the edge to hard surfaces, the universal bracing set can be used. To secure to a concrete surface remove stake and use bolt down method instead (purchase bolts separately).

### JOINING SLEEVES

Shortening a length is sometimes a requirement. The Joining sleeve is used to connect the two edges when this occurs. These are fixed to the panel front with screws through the guide holes in the sleeve.

### TIP

The pre-attached bracing ribs can be moved. Knock sideways at top to dislodge then pop out from bottom and do opposite to re insert them where needed.

### STANDARD RING SIZES

Connecting edge lengths makes standard ring sizes, use join sleeve for non-standard diameters greater than 1.5m

	Lengths	Diameter
Connecting edge lengths	2	1.37m
makes standard ring sizes, use	3	2.06m
join sleeve for non-standard	4	2.75m
diameters greater than 1.5m	5	3.44m

STEP 1 - JOIN

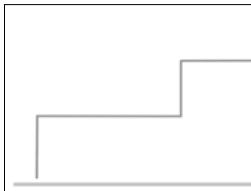

STEP 2 - FLEX

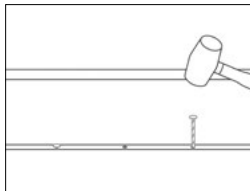

STEP 3 - PEG

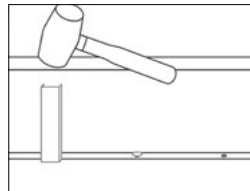

STEP 4A - STAKE (OR)

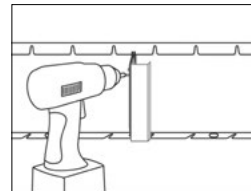

STEP 4B - BRACE

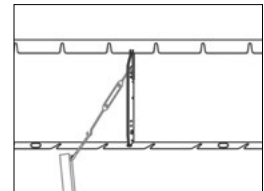

PRE-MADE CORNER\*

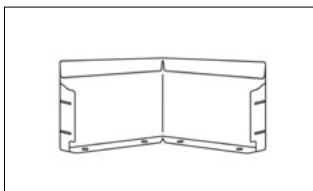

MAKE CORNER - NOTCH/SCORE WITH GRINDER

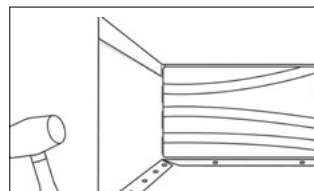
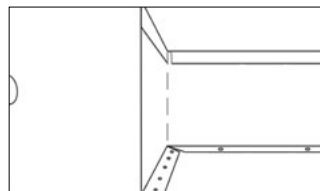

TIGHT RADIUS - STRAP

