

straightcurve®

Specifications

4" Flexline™

LENGTH 87" | TOP THICKNESS 0.31"

FINISHES

- Galvanised Steel
- Weathering Steel

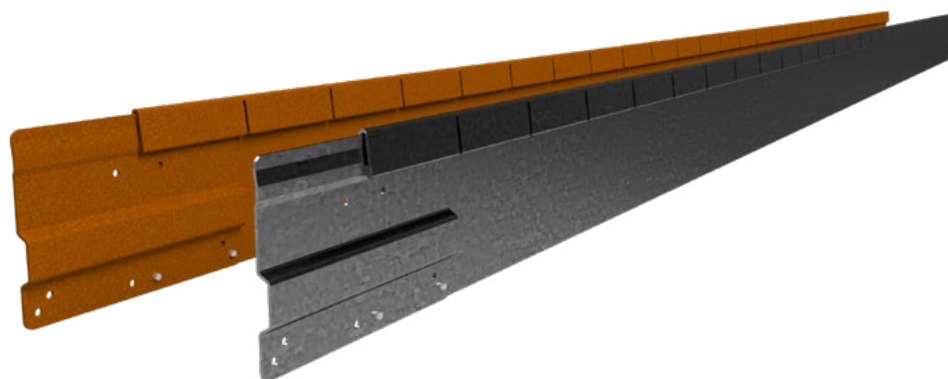

Steel plate thickness 0.06"

SOLD AS SET INCLUDING

- ✓ Connector plate (pre-attached)
- ✓ 3 x galvanised pegs

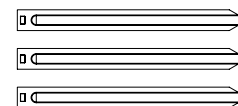
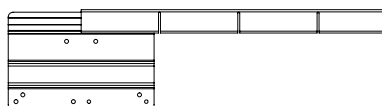

ADDITIONAL ACCESSORIES

- ✓ 20" Corner piece (bend to desired angle)
- ✓ Hard surface fixing bracket

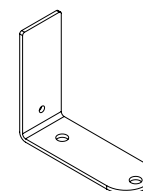
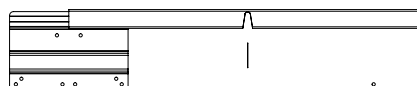

Installation guide

4" Flexline™



PREPARATIONS

Level the base before you start; compacting the base is recommended. This product can be used on a sandy base as well as on compacted roadbase.

Note: This edge allows gentle sloping

CORNERS

Standard corners are available for purchase, but you can choose to make your own. Simply score a line down the back of the edge and create a sufficient opening (0.2-0.28") in the double folded lip at the top. Bend by hand. Placing a block of wood close to the fold improves the result.

REQUIRED FIXINGS

- ☑ 2 x Tek Screws (12G x 0.63") or
- ☑ 2 x pop rivets (0.16" shaft)

HARD SURFACE FIXING

If you need to secure the edge to hard surfaces, the hard surface fixing bracket can be used. It's compatible with fixing pins or can be bolted down. (Options sold separately)

TIP

- ☑ Position whole run first to be sure it's spot on before fixing in place.
- ☑ Insert ALL fix pegs adjacent edge (3A), then work from one end to the other to fix (3B).
- ☑ One length makes a tight 28" diameter circle.

STEP 1 - JOIN

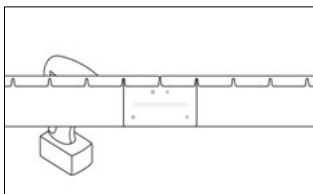

STEP 2 - FLEX

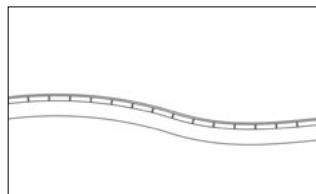

STEP 3A - PEG

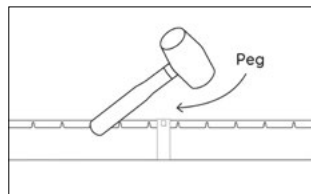

STEP 3B - FIX

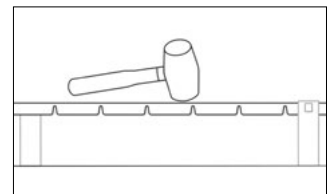

PRE-MADE CORNER

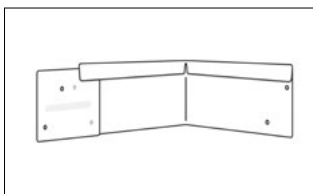

MAKE CORNER - NOTCH/SCORE WITH GRINDER

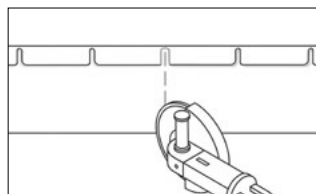

TIGHT RADIUS

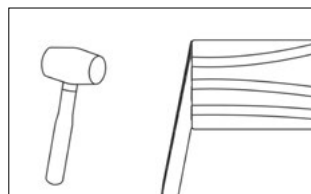

TIGHT RADIUS

